



Colours will vary as pictured in this manual.

Kids Ride-On Patrol Motorcycle

User Manual

[Revision 5.0 July 2018]

READ THIS MANUAL CAREFULLY BEFORE USE AND KEEP FOR FUTURE REFERENCE – FAILURE TO DO SO MAY RESULT IN INJURY, PROPERTY DAMAGE AND MAY VOID WARRANTY. • Products covered by this manual may vary in appearance, assembly, inclusions, specifications, description and packaging.

THE BATTERY MAY HAVE SOME CHARGE ON ARRIVAL, IT IS IMPORTANT HOWEVER THAT THE BATTERY IS CHARGED PRIOR TO USE.

Table of Contents

Safety	1
General Safety Reminders	1
Charging Safety	1
Operation Safety	2
Included Items	3
Set-Up	4
Operation	6
Functions of the Motorcycle Head	6
Drive Control	6
Fast and Slow Speed Control	7
Charging the Accumulator	7
Replacing the Fuse	8
Fuse Applications	8
Maintenance	9
Troubleshooting	10
Technical Specifications	10

Safety

General Safety Reminders

Please pay attention to following reminders for your child's safe driving experience:

- The motorcycle must be installed and adjusted by adults and make sure that children are kept away from the moving components of the motorcycle.
- This motorcycle is not suitable for children ages 36 months old and younger.
- Children's use of this motorcycle should be under the supervision of adults. Never leave children unattended while the motorcycle is being used.
- Do not make or allow the child to stand or play on the foot rest of the motorcycle.
- The accumulator must be charged by adults! Please fully-charge the battery first before using the motorcycle.
- In order to avoid accidents, injuries or risk of suffocation, please keep packaging materials such as plastic bags away from children.
- Do not use spare parts or components that are not supplied by the manufacturer.
- Install all of the batteries in the correct polarities.
- The accumulator is not a toy.
- The maximum load capacity of the motorcycle is 25kg. Please do not overload the motorcycle.
- This motorcycle is suitable for children aged 37 to 96 months only.
- The power supply terminals should be shorted out.
- The motorcycle should not be connected to power supplies that go beyond recommended power ratings.

Charging Safety

- Ensure that the accumulator has been charged for 18 hours for the first time of charging, or the accumulator will be damaged permanently, which can never be recovered.
- Plug the DC pin into the charging jack first when charging the accumulator. Then, plug the accumulator into the power socket. The motorcycle should not be used while it is still charging.
- Charge the battery in a timely manner after each hour of use. The normal charging duration is 8 – 12 hours. Do not go over 20 hours.
- The charger and accumulator may emit heat (under 60°C) while charging is taking place. This is a normal phenomenon.
- To avoid short-circuiting, the battery should not be charged if water is detected inside the connectors.
- Only use the charger and accumulator that is designed for the motorcycle in order to avoid damaging the charger and the accumulator or short-circuiting the electrical equipment.
- Charge the motorcycle at least once a month when storing it for an extended period of time.

Operation Safety

- Make sure that the accumulator has been charged for 18 hours for first time use, otherwise the accumulator will be damaged permanently, which can never be recovered.
- Make sure that all of the components have been well-mounted and tightly-connected before using the motorcycle.
- Do not operate the motorcycle in dangerous areas such as on busy streets, roads, slopes or ditches.
- Do not operate the motorcycle on roads with smooth surfaces, such as marble or tilts.
- Do not turn the Forward/Backward switch while the motorcycle is moving. Do not let your child stand on the seat.
- Never change the wire circuitry of the motorcycle or add any electrical equipment to it.
- The motorcycle will stop moving when it encounters any barriers. Please steer clear of the barrier before driving again.
- Do not use the motorcycle indoors in order to avoid damaging furniture or injuring your child.
- Cut-off the power supply if the motorcycle is not being used; remove the battery connectors if the motorcycle will not be used for a long time.

Included Items

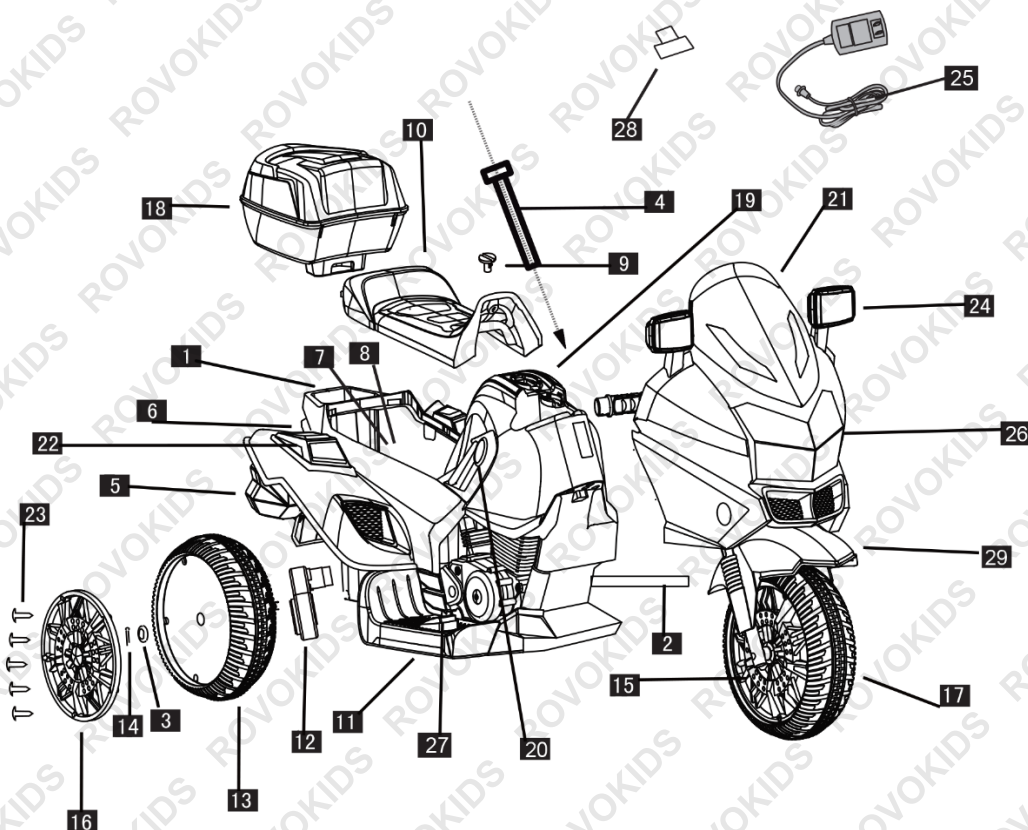

No.	Component Name	Qty.
1	Motorcycle body	1
2	Rear axle shaft	1
3	Shims	8
4	Boom screw	1
5	Exhaust pipe	2
6	Taillight shade	1
7	Accumulator	1
8	Accumulator layering	1
9	Seat knob	1
10	Seat cushion	1

No.	Component Name	Qty.
11	Foot rest	1
12	Gear case	1
13	Driving wheel	1
14	Cotter	2
15	Front wheel cover	2
16	Rear wheel cover	2
17	Front wheel	1
18	Upper and lower caps of the tool kit	1
19	Fuel tank cap	1
20	Air intake	2

No.	Component Name	Qty.
21	Wind board	1
22	Decorative lamp socket	2
23	Screw	10
24	Head alarm lamp	2
25	Charger	1
26	Head lamp	1
27	Foot switch	1
28	Nut wrench	1
29	Front fender	1

Set-Up

Video Tutorial:

[Ride-On Motorcycle Assembly](#)

1. Mount the front wheel components and the front wheel (see Pictures 1 and 2).

- Align the hole of the boom with the head at the same level with the hole at the front boom of the motorcycle body. Insert a boom screw into the two holes and secure the screw with a nut. Mount other boom screws according to the directions instructed by the arrows.
- Install the front fender at the direction instructed by the arrows until the two screw holes are aligned with each other and then secure it with the screw.
- Place the front wheel at the middle of the handlebar. Mount a shim at each sides of the front wheel. When the two holes are parallel to each other, make the front axle go through and then install a shim and a spring washer at each of the two sides of the front axle and secure with a nut.

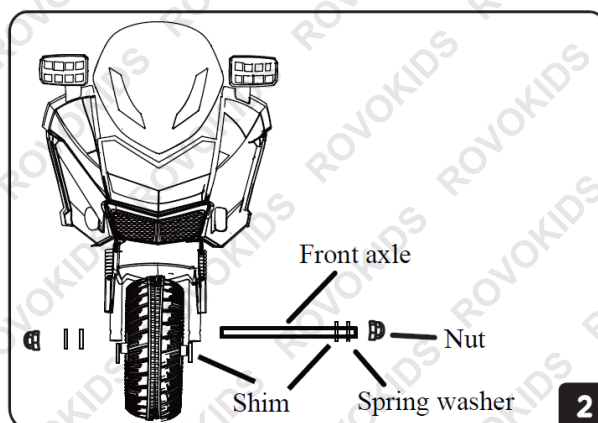
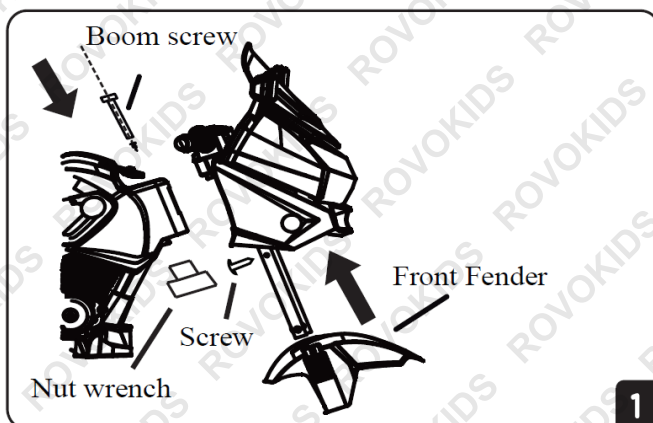

2. Mount the rear wheel (see Picture 3-1).

- Insert a shim into the rear axle from the right side and then insert the rear axle into the motorcycle body from the left side of the latter; mount the gear case onto the right side of the motorcycle.
- Mount the driving wheel (match the side where the double wedge lies with the gear case) on the right side of the motorcycle body and install a shim and a left wheel on to the left side of the motorcycle.
- Install a shim at both sides of the wheel and insert the cotter into the pore on the rear wheel axle and fix the cotter with tools.
- Align the screw hole of the wheel cap a

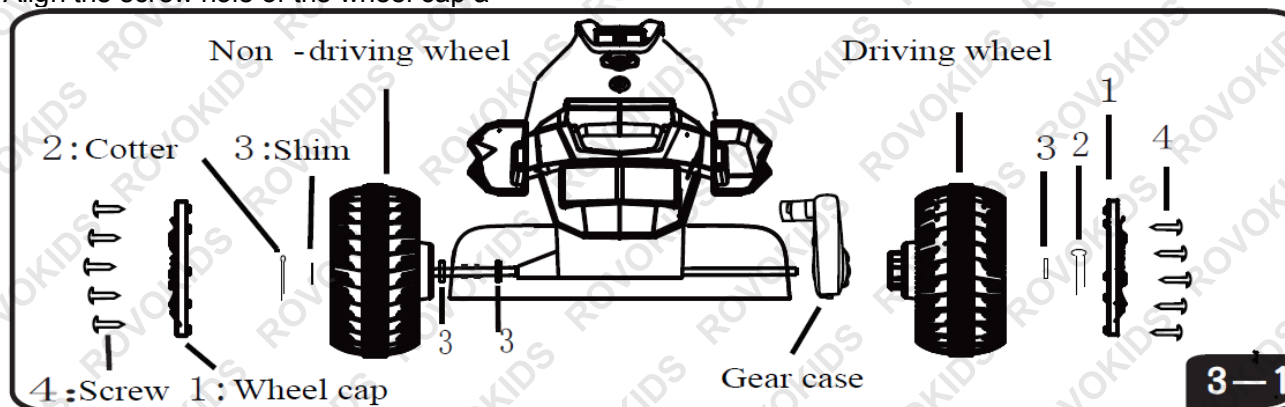

t the screw hole of the rear wheel and secure it with a screw.

3. **Mount the rear wheel** (see Picture 3-2, Optional).

- Insert the rear wheel into the motorcycle body from the left side and mount a gear case at the two sides of the motorcycle respectively. Make sure that the "L" and "R" on the gear case correspond to the "L" and "R" on the motorcycle body.
- Mount the driving wheel. Mount a shim and a cotter at both sides of the rear axle respectively and align the screw hole on the wheel cap with the screw hole on the real wheel and then secure them with screws.

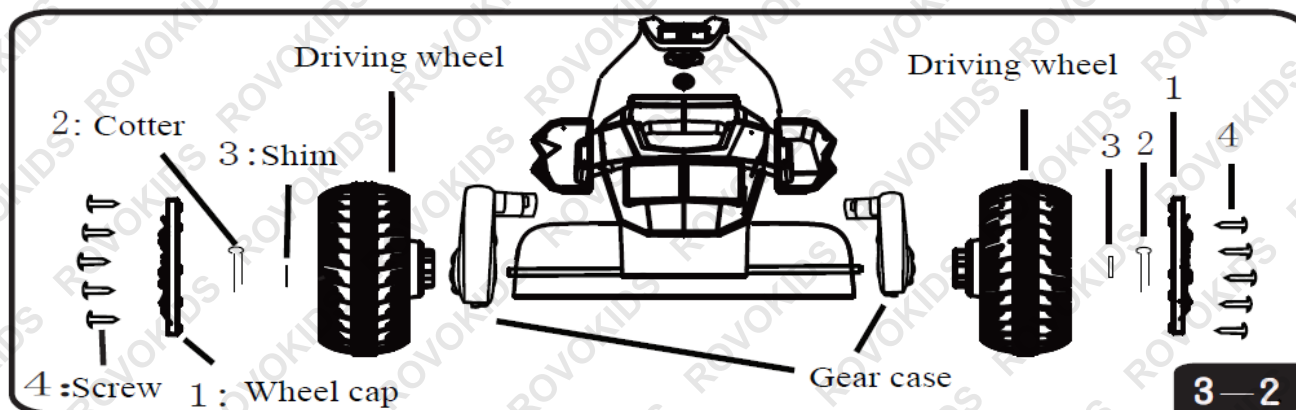

4. **Mount the tool kit** (see Picture 4).

Align the screw hole at the back cover of the tool kit with the screw hole on the motorcycle body and secure it with a screw, as instructed by the arrow. Finally, connect the power supply wire of the flash light.

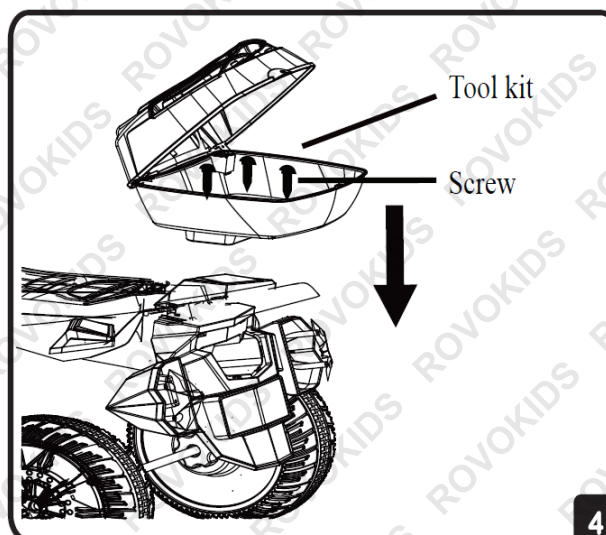

5. **Install the seat** (see Picture 5).

First, align the two snaps at the back end of the seat at the two troughs at the back end of the motorcycle body and chuck tightly. Then screw the seat lock catch to the position of "ON"; align the fixed pillar at the bottom of the seat at the fixed hold for the seat on the motorcycle body and then press down the seat and screw the lock catch to the position of "OFF" (Please install as instructed by the arrows).

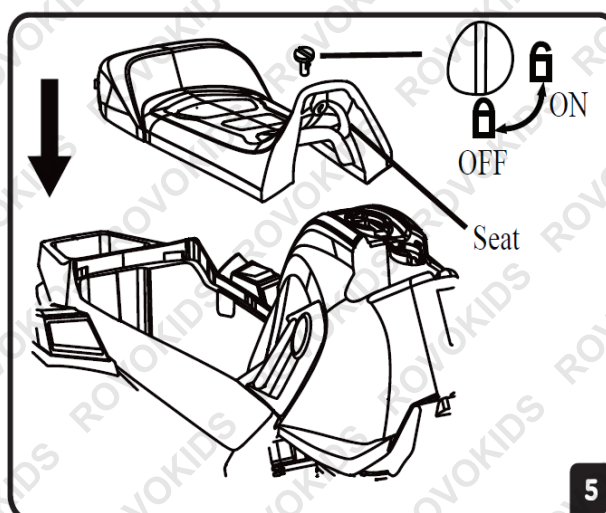

Operation

Functions of the Motorcycle Head

The motorcycle head is easy and flexible to operate. Press different buttons and you will hear different musical sound at the same time.

Optional: The front and back flash lights of the motorcycle will flash when the sounds ring out.

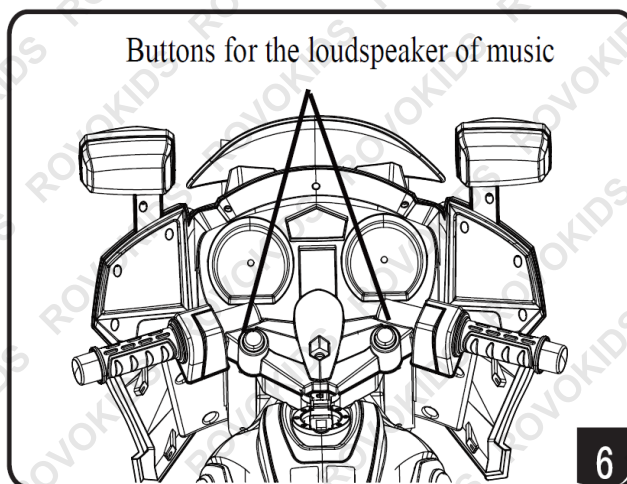

Drive Control

The child should sit properly on the seat and then turn the power switch to “ON” and the start sound rings out at the same time. Turn the switch for the flash light to “ON” and it will turn on simultaneously. Turn the Forward/Stop/Backward switch to “Forward” and press down on the foot switch. The motorcycle will then move forward. Let go of your foot from the foot switch and the motorcycle will stop. Turn the Forward/Stop/Backward switch to “Backward” and press down on the foot switch. The motorcycle will then move backwards. Let go of your foot from the foot switch and the motorcycle will stop. Place the switch on the “STOP” position. The motorcycle will then cease moving.

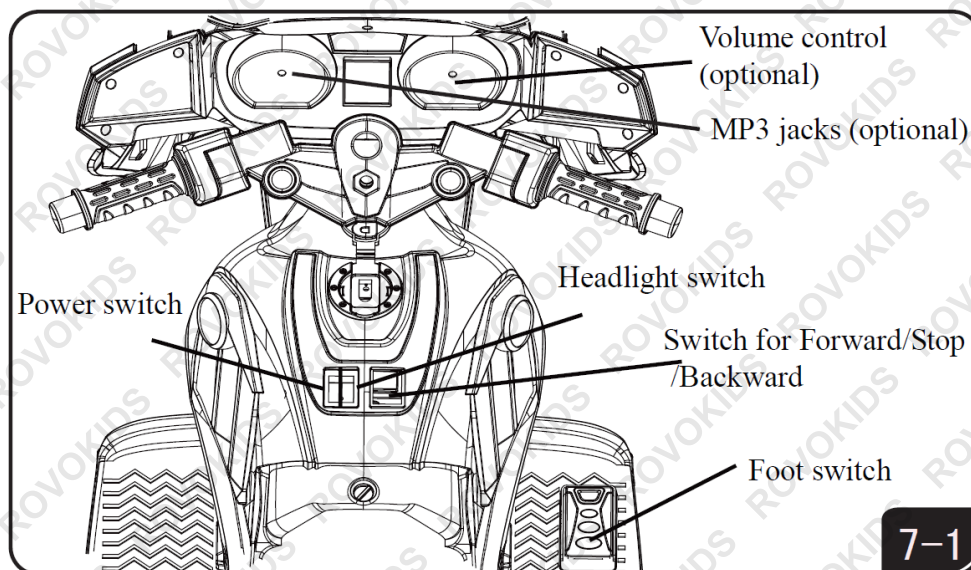

Fast and Slow Speed Control

The child should sit properly on the seat and then turn the power switch to “ON” and the start sound rings out at the same time. Turn the flash light switch to “ON” and it will turn on simultaneously.

Setting the switch on “FAST”: Turn the Forward/Stop/Backward switch to “Forward” and then press down on the foot switch. The motorcycle will then move forward with a fast speed. Let go of your foot from the foot switch; the motorcycle will then stop. Turn the switch to “Backward” and then press down on the foot switch. The motorcycle will then move backwards with a fast speed. Let go of your foot from then foot switch; the motorcycle will then stop. Turn the switch to “Stop”; the motorcycle will then cease moving.

Setting the switch on “SLOW”: Turn the Forward/Stop/Backward switch to “Forward” and press down on the foot switch. The motorcycle will then move forward with a slow speed. Let go of your foot from the foot switch; the motorcycle will then stop. Turn the switch on “Backward” and press down on the foot switch. The motorcycle will then move backward with a slow speed and until it stops. Turning the switch to “STOP” will stop the motorcycle from moving.

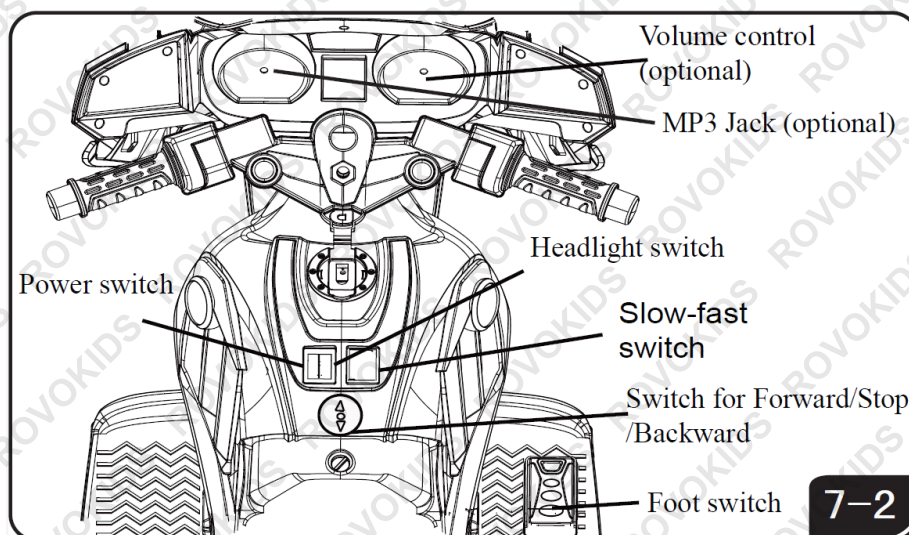

Charging the Accumulator

Charge the accumulator in a timely manner when the power supply is low. The jack for power charging lies at the very front of the motorcycle body

Note: Do not operate the motorcycle while it is still charging.

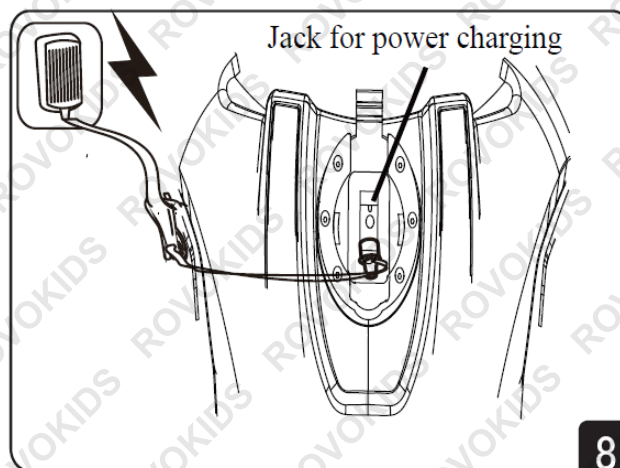

Replacing the Fuse

In case the fuse needs to be replaced, remove the fuse (it is inside the transparent fuse base under the seat) first, then open the fuse case and replace the damaged one with a new fuse. Afterwards, close the fuse case.

Note: The fuse should be rated at 20A. Please be careful of the socket when pulling out/pushing in the charger. Plug-in the charger towards the vertical direction of the socket.

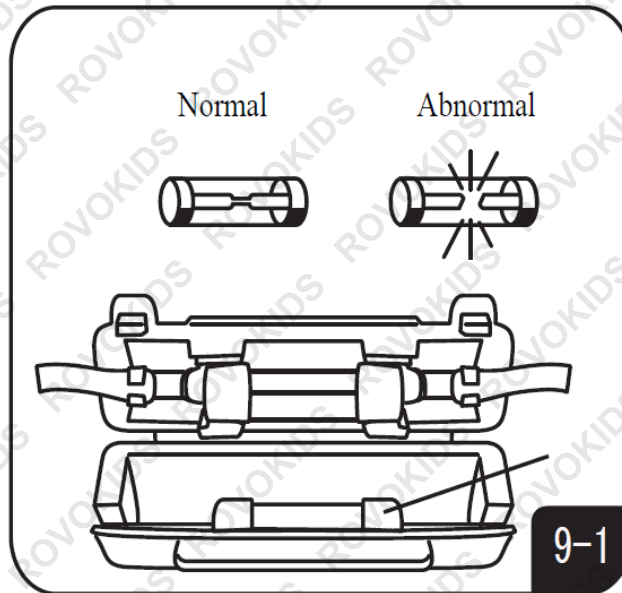

Fuse Applications

The fuse is resettable. When the current is detected to be over 15A, the power supply will be cut automatically for 5 to 10 seconds and then it will recover automatically (optional).

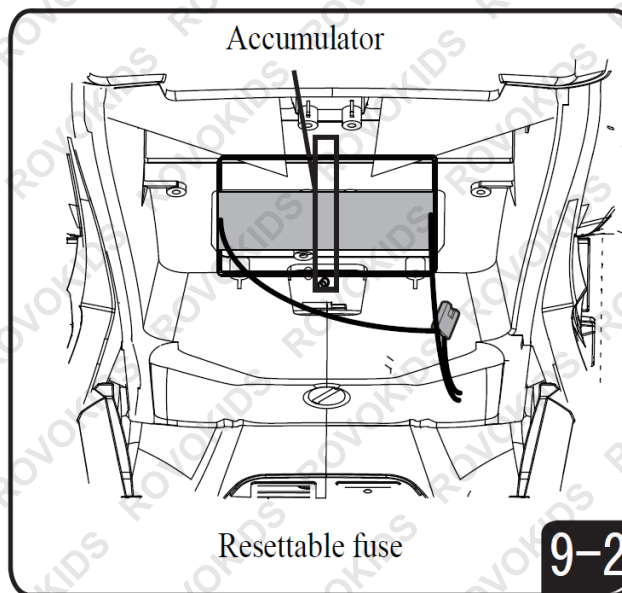

Maintenance

- Examine and maintain the motorcycle frequently in order to keep your child away from accidents and injuries.
- Make sure that all of the components are available before using the motorcycle. Contact the manufacturer or an authorised service centre if any components are missing.
- Check whether any screws are loose or any of the component is damaged at regular intervals.
- Check and confirm that all of the components are in good, working condition when you are using them.
- Clean the motorcycle at regular intervals being careful not to damage the electrical equipment.
- Refer closely to this user manual when dismantling the motorcycle in order to prevent any unnecessary damages.
- Check the product and its charger at regular intervals and make sure that the wires, socket, outer shell and other components are all in good working condition. Stop using the motorcycle if there are any damaged components. Repair any damaged parts first before re-using the motorcycle.

Troubleshooting

Symptom	Possible Cause	Possible Solution
Not moving at all when accelerating	Battery not connected	Please connect battery
	RC/TC Switch is on	Turn Switch to "Manual"
	Switched off	Turn power switch to ON
	Battery is flat	Battery has an average running usage of 1-2 hours. Please recharge battery.
	Exhausted battery life	If still does not work after 8 hours of charging the battery will need replacing
Not charging	Damaged battery	Damage to battery can occur if left on charge for over 12 hours. Please avoid this. Battery will need replacing
	Switched ON	This will not charge if unit is switch on! Please ensure unit is switched off while charging.
	Battery	If the charging indicator does not light, the battery may need replacing.
	Charger	If charging indicator does not light, the charger may need replacing.
Hi Speed is not working (if equipped)	Button is engaged/active	If a button (accelerator, sound or other) is accidentally pressed and held it, the unit will not charge. Please ensure all buttons are operating normally and nothing is jamming it.
	Driving wheels are swapped around (Left on Right and Right on Left)	Please switch over rear wheels so that Left is on the Left side and Right is on the Right side.
	Switch is on low	Please turn switch to Hi
No sound	Low battery	Please recharge battery
	Volume turned down	Please turn volume up
Forward and Reverse are switched around / Forward moves backwards and backwards moves forwards	Aux cable in MP3 port	Please remove aux cable from MP3 port
	Motorised driving wheels are swapped around (Left on Right and Right on Left)	Please switch over rear wheels so that Left is on the Left side and Right is on the Right side.

Technical Specifications

Battery	DC12V7AH
Suitable Age	3-8 Years
Max Rider Weight	25kg
Range	1-2 hours



Some experts believe that the incorrect or prolonged use of almost any product may cause serious injury or death. To help reduce your risk of serious injury or death, refer to the information below. For more information, see www.datastreamserver.com/safety

- Consult all documentation, packaging and product labelling before use. Note that some products feature documentation available online. It is recommended to print and retain the documentation.
- Before each use, check the product for loose/broken/damaged/missing parts, wear or leaks (if applicable). Never use a product with loose/broken/damaged/missing parts, wear or leaks.
- Products must be inspected and serviced (if applicable) by a qualified technician every 6 months. This is based on average residential use by persons of average size and strength, and on a property of average metropolitan size. Use beyond these recommendations may require more frequent inspections/servicing.
- Ensure that all users of the product have completed a suitable industry recognised training course before being allowed access to the product.
- The product has been supplied by a general merchandise retailer that may not be familiar with your specific application or description of application. Be sure to attain third-party approval from a qualified specialist for your application before use, regardless of any assurances from the retailer or its representatives.
- This product is not intended for use where fail-safe operation is required. As with any product (for example, automobile, computer, toaster), there is the possibility of technical issues that may require the repair or replacement of parts, or the product itself. If the possibility of such failure and the associated time it may take to rectify could in any way inconvenience the user, business or employee, or financially affect the user, business or employee, then the product is not suitable for your requirements. This product is not intended for use where incorrect operation or a failure of any kind, including but not limited to, a condition requiring product return, replacement, parts replacement or service by a technician may cause financial loss, loss of employee time or an inconvenience requiring compensation.
- If this product has been purchased in error when considering the information presented here, contact the retailer directly for details of their returns policy, if required.

