

# User manual

**JET-USA**  
PRESSURE WASHERS

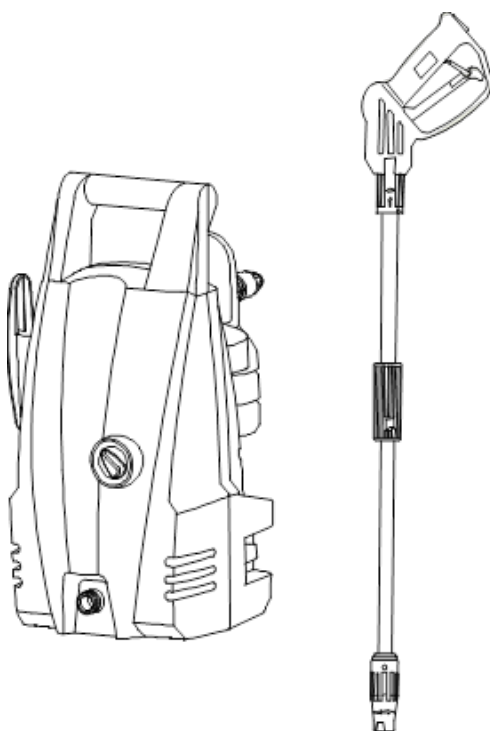

[Revision 5.0 January 2020]

**⚠ WARNING!** Read and understand all safety warnings and instructions carefully before using this machine. Failure to follow the warnings and instructions may result in electric shock, fire and/or serious injury. Save this manual for future reference.

**⚠ ATTENTION!** Products covered by this manual will vary in appearance, assembly, inclusions, description and packaging.

**⚠ NOTE!** This manual covers multiple styles of product as well as options / accessories that may not be suitable for the machine you have purchased.



# Index

Index .....	1
Safety .....	2
Parts Diagram .....	5
Assembly .....	6
The handle .....	6
Trigger Assembly (PRWELCJETA500, PRWELC450USAACAB & PRWELCJETA470) .....	7
Connecting the hoses .....	8
Operation .....	9
Before Use .....	9
Start Up .....	9
Shut Down .....	9
Nozzle selection .....	10
Turbo nozzle (if equipped) .....	10
Twist-adjustable nozzle (if equipped) .....	11
Angle to the cleaning surface .....	11
How to avoid damaging surfaces .....	11
Detergents .....	12
Detergent Application .....	12
Initial High Pressure Rinse .....	13
Final Rinse .....	13
Storage .....	13
Maintenance .....	14
Nozzle cleaning instructions .....	14
Water screen .....	14
Troubleshooting .....	15
Specifications .....	16

# Safety



It is important you read and understand the instruction manual before use and keep the manual in a safe place for future reference.



Safety precautions must be observed to reduce the risk of personal injury when operating this machine.



If you are not familiar with the safe operation / handling of this equipment, or are in any way unsure of any object of this products suitability or correct use for your application you should complete training conducted by a person or organisation qualified in safe use and training related to this product. This includes fuel / electrical handling and safety if applicable to this product or your application.

## General safety

Like all equipment this unit must be handled carefully. Exposure to fumes and gases can damage the lungs and respiratory system or cause asphyxiation. Do not expose yourself or others to danger. Do not permit others to use the equipment unless they have read this manual and are trained in its operation. Do not operate if the equipment is damaged or is in an excessively worn state. The term "equipment" in all of the warnings refers to your product be that mains, battery or fuel powered products refers to any part of the product(s) / device(s) both directly and indirectly related to its function and use.

## Work area safety

Keep work area clean and well lit. Cluttered or dark areas invite accidents. Do not operate equipment in explosive atmospheres, such as in the presence of flammable liquids, gases or dust. Engines and equipment create sparks which may ignite the dust or fumes. Keep children and bystanders away while operating equipment. Never allow children to access the equipment. Avoid operating while people, especially children or pets are nearby. To reduce the risk of injury or damage, do not allow any other persons within a radius of 5 metres of your own position.

## Personal safety

Prevent unintentional starting. Ensure equipment switches are in the off-position before connecting to power source and/or battery pack, picking up or carrying the equipment. Stay alert, watch what you are doing and use common sense when operating equipment. Do not use equipment while you are tired or under the influence of drugs, alcohol or medication. A moment of inattention while operating equipment may result in serious personal injury. Use personal protective equipment. Always wear eye protection. Protective equipment such as a respirator, non-skid safety shoes, hard hat, or hearing protection used for appropriate conditions will reduce personal injuries. Ensure the equipment is switched off before connecting a to power source, picking up or carrying the equipment. Carrying equipment with your finger on the switch or energising equipment that have the switch may invite accidents.

Remove any adjusting key or wrench before turning the equipment on. Do not overreach. Keep proper footing and balance at all times. This enables better control of the equipment in unexpected situations. If devices are provided for the connection of dust extraction and collection facilities, ensure these are connected and properly used. Use of dust collection can reduce dust-related hazards. Never touch the mains plug and the socket with wet hands. This (appliance / equipment / product) is not intended for use by persons with reduced physical, sensory or mental capabilities. Do not use the appliance when there are other persons around unless they are also wearing safety equipment. Keep packaging film away from children - risk of suffocation! The operator must use the appliance correctly. When working with the appliance, he must consider the local conditions and pay due care and attention to other persons, in particular children, who are nearby. If equipped; high pressure hoses, fixtures and couplings are important for the safety of the appliance. Only use high pressure hoses, fixtures and couplings recommended by the manufacturer. Dress properly. Do not wear loose clothing or jewellery. Keep your hair and clothing away from the work area. Loose clothes, jewellery or long hair can be caught in moving parts. You must wear

appropriate protective equipment when operating, servicing, or when in the operating area of the equipment to help protect you from serious injury, including eye injury, inhalation of toxic fumes, burns, and hearing loss. Wear protective clothing and safety goggles to protect against splash back containing water or dirt.

## Electrical safety

Electric Shock can kill. Power plugs must match the outlet. Never modify a plug in any way. Do not use any adapter plugs with earthed (grounded) equipment. Unmodified plugs and matching outlets will reduce risk of electric shock. Avoid body contact with earthed or grounded surfaces, such as pipes, radiators, ranges and refrigerators. There is an increased risk of electric shock if your body is earthed or grounded. Do not expose equipment to rain or wet conditions. Water entering equipment will increase the risk of electric shock. Do not abuse the cord. Never use the cord for carrying, pulling or unplugging the equipment. Keep cord away from heat, oil, sharp edges or moving parts. Damaged or entangled cords increase the risk of electric shock. When operating any equipment outdoors, use an extension cord suitable for outdoor use. Use of a cord suitable for outdoor use reduces the risk of electric shock. If operating equipment in a damp location is unavoidable, use a residual current device (RCD) protected supply. Use of an RCD reduces the risk of electric shock. For safety reasons, we recommend any electrical equipment that you operate be via a residual-current circuit breaker (RCD). Safety devices protect the user and must not be modified or bypassed.

## Equipment use and care

Do not force the equipment. Use the correct equipment for your application. The correct equipment will do the job better and safer at the rate for which it was designed. Do not use the equipment if the On/Off switch does not turn it on and off. Any equipment that cannot be controlled with the On/Off switch is dangerous and must be repaired. If applicable, disconnect the any plugs from a power source and/or the battery pack from the equipment before making any adjustments, changing accessories, or storing equipment. Such preventive safety

measures reduce the risk of starting the equipment accidentally. Do not allow persons unfamiliar with the equipment or these instructions to operate the equipment. Equipment is dangerous in the hands of un-trained users. Maintain equipment. Check for misalignment or binding of moving parts, breakage of parts and any other condition that may affect the equipment's operation. If damaged, have the equipment repaired before use. Many accidents are caused by poorly maintained equipment.

If applicable keep equipment properly maintained, cutting tools with sharp cutting edges are less likely to bind and are easier to control. Use the equipment and accessories etc. in accordance with these instructions, taking into account the working conditions and the work to be performed. Use of the equipment for operations different from those intended could result in a hazardous situation. Always clean dust and dirt off the equipment – do not use any grease solvents. Always keep the equipment clean. After use, the equipment and components may still be hot. Never place the equipment in any places where there are flammable materials such as dry grass, combustible gases or combustible liquids etc. Let the equipment cool before storing indoors.

## Service

Have your equipment serviced by a qualified repair person using only identical replacement parts. This will ensure that the safety of the equipment is maintained. Do not attempt any maintenance or repair work not described in this instruction manual. Have all other work performed by an authorised service person. We recommend that you have servicing and repair work carried out exclusively by an authorised service person. Before proceeding to adjust or repair the equipment; be sure to stop the equipment and detach and power source or spark plug (if equipped).

Never attempt to make adjustments while the equipment is running.

Always make adjustments with the equipment resting on a flat, clear surface. Replace any worn, damaged or removed warning labels immediately. Portable washer safety

This appliance is not intended for use by persons (including children) with reduced physical, sensory or mental capabilities, or lack of experience and knowledge, unless they have been given supervision or instruction concerning use of the appliance by a person responsible for their safety.

This product is not intended for pumping water in a home domestic application. Do not use it for corrosive, abrasive, explosive or dangerous liquids. Fluids other than water will damage the water pump and/or create a fire hazard. High pressure jets can be dangerous if subject to misuse. The jet must not be directed at persons, live electrical equipment or the appliance itself. Do not use the appliance within range of persons unless they wear protective clothing. Disconnect from the power supply before carrying out user maintenance. High pressure cleaners shall not be used by children or untrained personnel. To ensure appliance safety, use only original spare parts from the manufacturer or approved by the manufacturer. High pressure hoses, fittings and couplings are important for the safety of the appliance. Use only hoses, fittings and couplings recommended by the manufacturer.

## Automatic ON/OFF

The motor on this pressure washer does not run continuously. It only runs when the trigger of the spray gun is squeezed. After following the start-up procedures in this manual, turn the pressure washer ON and squeeze the trigger for activation. See "Operating Instruction" section in this manual for further details. The electric supply to this machine should include either a residual current device that will interrupt the supply if the leakage current to earth exceeds 30 mA or a device that will prove the earth circuit.

- ⚠ BEFORE USE!** If you are not familiar with the safe operation / handling of this equipment, or are in any way unsure of any object of this products suitability or correct use for your application you should complete training conducted by a person or organisation qualified in safe use and training related to this product. This includes fuel / electrical handling and safety if applicable to this product or your application.
- ⚠ WARNING!** Only a fully licenced electrician should perform installation or maintenance where terminals/wiring/circuit boards that may at any time be live with 240V AC electricity are accessed.



**Some experts believe the use of almost any product could cause serious injury or death. For information that may reduce your risk of serious injury or death consult the points below and additionally, the information available at [www.datastreamserver.com/safety](http://www.datastreamserver.com/safety)**

- Consult all documentation, packaging and product labelling before use. Note that some products feature online documentation which should be printed and kept with the product.
- Check product for loose/broken/damaged/missing parts, wear or leaks (if applicable) before each use. Never use a product with loose/broken/damaged/missing parts, wear or leaks (if applicable).
- Product must be inspected and serviced (if applicable) by a qualified specialist every 6 months assuming average residential use by a person of average weight and strength, above average technical aptitude, on a property matching average metropolitan specification. Intended use outside these guidelines could indicate the product is not suitable for intended use or may require more regular inspection or servicing.
- Ensure all possible users of the product have completed an industry recognised training course before being given access to the product.
- The product has been supplied by a general merchandise retailer that may not be familiar with your specific application or your description of the application. Be sure to attain third party approval for your application from a qualified specialist before use regardless of prior assurances by the retailer or it's representatives.
- This product is not intended for use where fail-safe operation is required. As with any product (take an automobile, aircraft, computer or ball point pen for example) there is always a small chance of a technical issue that needs to be repaired or may require replacement of the product or a part. If the possibility of such failure and the associated time it takes to rectify could in any situation inconvenience the user, business or employee or could financially affect the user, business or employee then the product is not suitable for your requirements. This product is not for use where incorrect operation or a failure of any kind, including but not limited to a condition requiring product return, replacement, service by a technician or replacement of parts could cause a financial loss, loss of employee time or an inconvenience requiring compensation.
- If this item has been purchased in error considering the points above simply contact the retailer directly for details of their returns policies if required.

## Parts Diagram

**⚠ ATTENTION!** Products covered by this manual will vary in appearance, assembly, inclusions, description and packaging.

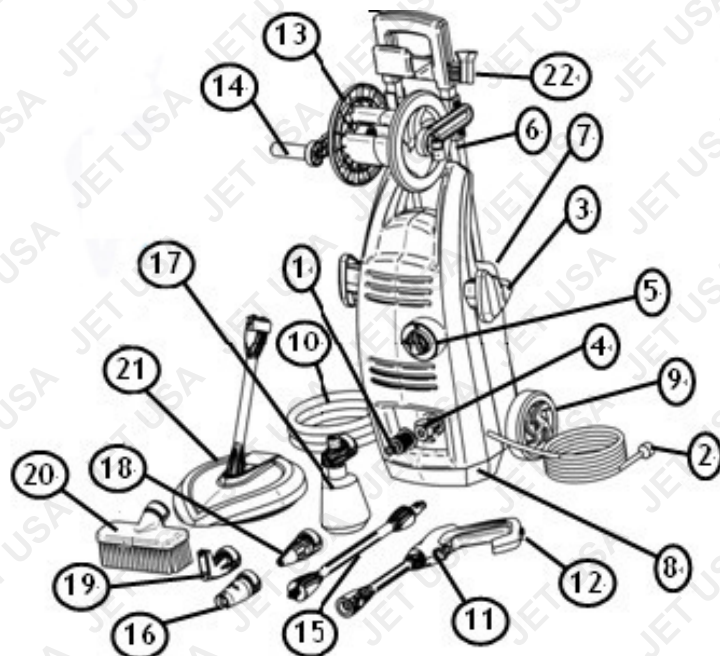

- |                          |                           |                           |
|--------------------------|---------------------------|---------------------------|
| 1. Water inlet connector | 8. Foot                   | 15. Spray Lance*          |
| 2. 240V Electrical plug  | 9. Wheel                  | 16. Adjustable Nozzle*    |
| 3. Storage hook*         | 10. High pressure hose    | 17. Detergent attachment* |
| 4. Water outlet          | 11. Trigger gun           | 18. Turbo Nozzle*         |
| 5. Power ON / OFF Switch | 12. Trigger lock          | 19. Angle Nozzle*         |
| 6. Trolley handle*       | 13. Hose reel*            | 20. Brush*                |
| 7. Nozzle storage*       | 14. Handle for hose reel* | 21. Patio Cleaner*        |

*\*Options displayed above cover a broad range of models and types of electric pressure washers. Some items may not be suitable for some models while other items may be option extras or promotional items.*



# Assembly

## The handle

**⚠ NOTE!** Some models come with handles fully assembled.

- Insert cable hook hold into the machine (figure 1a).
- Align holes on the bottom of the pressure cleaner as shown and tighten the 2 screws using a screwdriver (figure 1b).

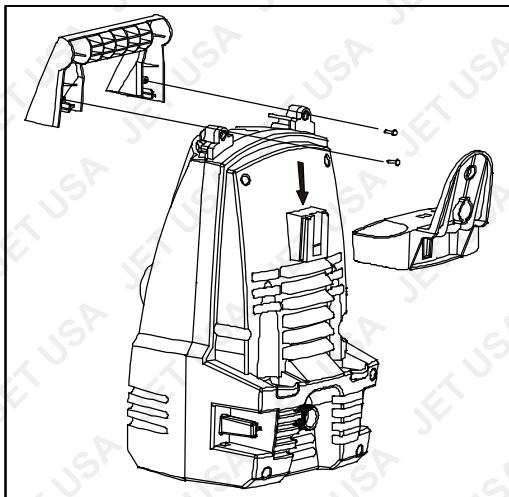

Figure 1a

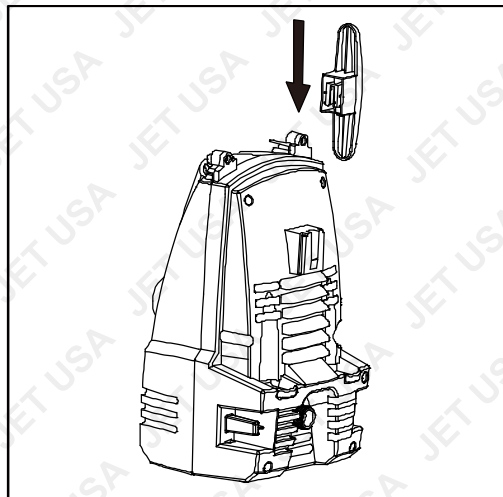
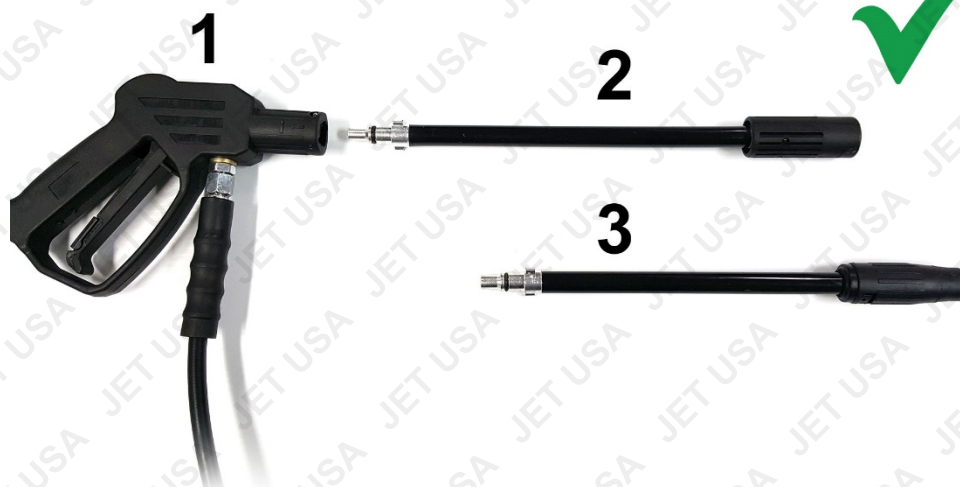

Figure 1b



*Above images apply to the RX470 model.*

**Trigger Assembly (PRWELCJETA500, PRWELC450USAACAB & PRWELCJETA470)**







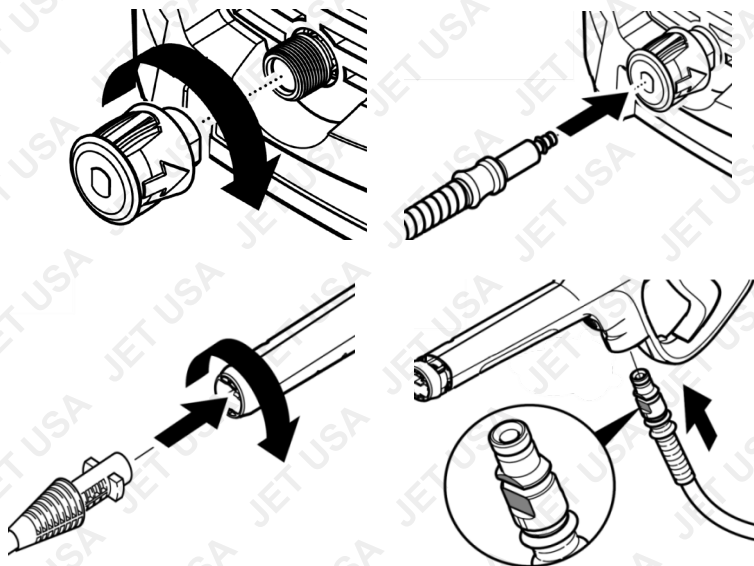

## Connecting the hoses

Most hoses are fitted with a quick connect fitting for which you only need to push until it click's into place. Threaded connections (if equipped) are right hand thread; screw them on in a clockwise direction until firmly in place. Do not over tighten or the connector could be damaged.



# Operation

-  **WARNING!** This unit is to be connected to a cold water source only.
-  **IMPORTANT!** The motor of yours pressure washer will not run until the trigger is squeezed.
-  **IMPORTANT!** Always turn off the unit's motor before turning off the unit's water supply. Serious damage could occur to the motor if the unit is run without water.
-  **WARNING!** Never disconnect the high-pressure discharge hose from the machine while the system is still pressurised. To depressurise the unit, turn off the motor, turn off the water supply and squeeze the trigger 2-3 times.

## Before Use

1. Water Inlet "Screen/filter" located behind the "water inlet connector" must be inspected regularly, so as to avoid blockage and restriction in the water supply to the pump.
2. Make sure all hoses and parts are fitted securely.

## Start Up

1. Connect the outlet hose to the washer and connect the spray gun to the outlet hose.
2. Connect nozzle and nozzle extension (if equipped).
3. Check wire mesh filter is clear of any blockage or debris.
4. Connect the water supply hose.
5. Check that the hose has no kinks in it.
6. Turn on water and check for leaks.
7. Depress trigger to allow air to be expelled though the pump and hoses, lock the trigger.
8. Plug in machine and turn power switch "ON".
9. Unlock trigger and use the pressure washer.

## Shut Down

1. Turn power switch "OFF".
2. Unplug the unit from the power source.
3. Turn off the water supply.
4. Press the trigger repeatedly of the gun to depressurise the system.
5. Disconnect the garden hose from the pressure washer.
6. Wipe all surfaces of the unit with a damp clean cloth.
7. Engage the gun safety lock.

## Nozzle selection

**⚠ NOTE!** Some portable pressure washers come with five nozzle attachments for different uses. Refer to the diagram (below) and on the pressure washer itself to see which nozzle is applicable for your purpose.



## Turbo nozzle (if equipped)

A turbo nozzle is a very effective tool that can significantly reduce cleaning time. The turbo nozzle combines the power of a narrow high impact stream and the efficiency of a 25 degree fan pattern. This swirls the narrow high impact stream into a cone shape that cleans a larger area.

**⚠ CAUTION!** A turbo nozzle uses a narrow high impact stream; only use it in applications where the cleaning surface cannot be damaged by narrow high impact spray. The turbo nozzle is NOT adjustable and cannot be used to apply detergent.



### Twist-adjustable nozzle (if equipped)

The angle of spray coming out of the lance may be adjusted on some lances by rotating the nozzle. This will vary the spray pattern from approximately a 0° narrow high impact stream to a 60° wide fan spray (Figure 2)

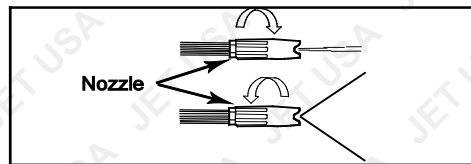

Figure 2 - Adjusting nozzle for fan pattern (not applicable on some nozzle)

A narrow stream has high impact force on the cleaning surface and results in maximum deep cleaning in a concentrated area. However, this narrow high impact spray must be used cautiously, as it may damage some surfaces (figure 3)

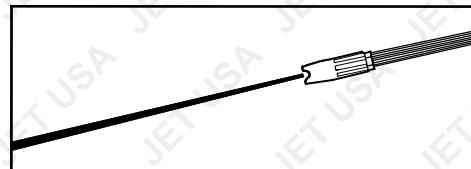

Figure 3 -Narrow high impact stream

A wide fan pattern will distribute the impact of the water over a larger area, resulting in excellent cleaning action with a reduced risk of surface damage. Large surface areas can be cleaned more quickly using a wide fan pattern (figure 4)

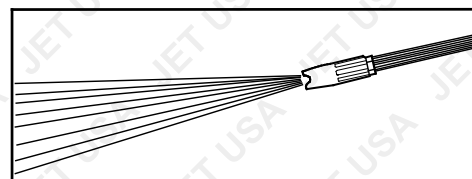

Figure 4 - Wide fan pattern.

### Angle to the cleaning surface

When spraying water against a surface, maximum impact is generated when the water strikes the surface “head on.” However, this type of impact tends to cause dirt particles to imbed in the surface, thereby preventing the desired cleaning action.

The optimum angle for spraying water against a cleaning surface is 45 degrees.

Spraying water against a surface at this angle provides for the most beneficial impact force combined with efficient removal of debris from the surface.

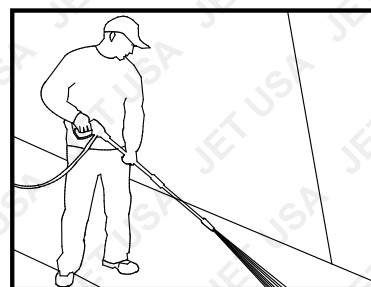

Figure 6-Optimum Angle to Cleaning Surface

### Distance from cleaning surface

Another factor that determines the impact force of the water is the distance from the spray nozzle to the cleaning surface. The impact force of the water is increased as the nozzle is moved closer to the surface.

### How to avoid damaging surfaces

Damage to cleaning surfaces occurs because the impact force of the water exceeds the durability of the surface. Never use a narrow high impact stream or a turbo/rotary nozzle on a surface that is susceptible to damage. Avoid spraying windows with a narrow high impact stream or turbo nozzle as this may cause breakage.

The recommended way to avoid damaging surfaces is as follows:

- Before triggering the gun, adjust the nozzle to a wide fan pattern.
- Place the nozzle approximately 4-5 feet from and 45 degrees to the cleaning surface, and trigger the gun.
- Vary the fan pattern spray angle and the distance to the cleaning surface until optimum cleaning efficiency is achieved without damaging the surface.



## Detergents

The use of detergents can dramatically reduce cleaning time and assist in the removal of difficult stains. Some detergents have been customised for pressure washer use on specific cleaning tasks. These detergents are approximately as thick as water. The use of thicker detergents, such as dish soap, will clog the chemical injection system and prevent the application of the detergent. The cleaning power of detergents comes from applying them to a surface and giving the chemicals time to break down the dirt and grime. Detergents work best when applied at low pressure. The combination of chemical action and high pressure rinsing is very effective. On vertical surfaces, apply the detergent starting at the bottom and work your way upward. This will prevent the detergent from sliding down and causing streaks. High pressure rinsing should also progress from the bottom to top. On particularly tough stains, it may be necessary to use a brush in combination with detergents and high pressure rinsing. The following cleaning procedure will help you to organize your cleaning task, and ensure that you achieve the most beneficial results in the shortest amount of time. Remember to use the spraying/cleaning techniques previously listed.

## Detergent Application

**⚠ IMPORTANT! Only use the instructions appropriate for model purchased.**

**⚠ NOTE! Use only detergents formulated for pressure washes.**

**⚠ NOTE! Test detergent in an inconspicuous area before use.**

For Units with Detergent Applicator Included; follow manufacturer's label directions for mixing correct concentrations of detergent to water ratio through the pressure washer is approximately 5.4% (1 part detergent to 19 parts water).

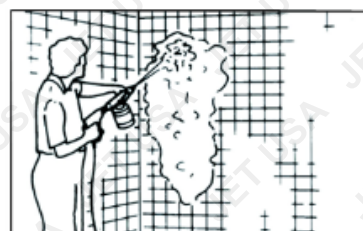
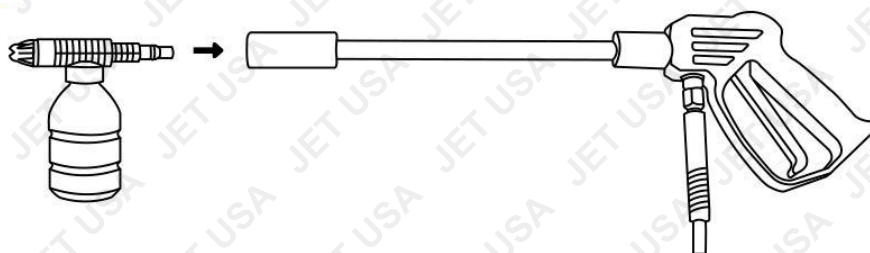

Figure 7- Detergent application

**⚠ NOTE! Some pressure washers have a built in detergent container, others have a separate gun attachment for this purpose.**

1. Unscrew to top of detergent applicator and fill applicator with detergent.
2. Replace top on applicator.
3. Remove lance from gun.
4. Attach detergent applicator to gun, if equipped (See below).



5. Apply detergent so it thoroughly covers cleaning surface. Apply from bottom to top to prevent detergent from sliding down and streaking.
6. Allow detergent to remain on the surface for a few minutes. This is a good time to use a brush to lightly scrub heavily soiled areas. Never allow detergent to dry on the cleaning surface.
7. Remove detergent applicator from gun and replace with the lance, or remove applicator from end of lance.
8. Rinse detergent from surface.

**⚠ NOTE! Flush detergent applicator with clear water following each use.**



## Initial High Pressure Rinse

Spray the cleaning surface with water to clear off any dirt or grime that may have collected on the surface. This will allow your detergent to attack the deep down dirt that has worked its way into the cleaning surface. Before triggering the gun, adjust the nozzle to a wide fan pattern and slowly adjust to the desired spray pattern. This will help you avoid applying too much concentrated spray to the surface which could cause damage.

## Final Rinse

Start final rinse from the bottom of your item and work your way upward. Make sure you thoroughly rinse the surface and that all detergent has been removed.

1. Shut down
2. Be sure all detergent is flushed from system.
3. Turn off motor.
4. Turn off water supply.
5. After motor and water supply are turned off, trigger gun to depressurize system.

 **DANGER!** Never turn water supply off before turning motor off. Serious damage could occur to the pump and/ or motor.

 **DANGER!** Never disconnect high pressure discharge hose from machine while system is pressurized. To depressurize, turn motor off, turn water supply off and squeeze gun trigger times.

## Storage

 **Do not store pressure washer outdoors or where it might freeze.**

Tips for extending the life of your pressure washer;

- Never operate unit without water.
- Pressure washer is not meant to pump hot water. Never connect to warm water supply – this will significantly reduce life of the pump.
- Using the wrong detergent other than recommended may cause damage to pump components (O-rings, etc.). This also applies to chemicals such as bleach, dish soap, etc.
- Before adjusting a nozzle's pressure (high-to-low or low-to-high) release trigger. Failure to do so will reduce life of O-rings in lance.

 **NOTE!** When the pressure washer is not being operated or is being stored more than one month, it is recommended that you turn off and disconnect the power.

# Maintenance

## Nozzle cleaning instructions

**⚠ NOTE!** A clogged or partially clogged nozzle can cause a significant reduction of water coming out of the nozzle and cause the unit to pulsate while spraying.

To clean out the nozzle:

1. Turn off and unplug unit.
2. Turn off water supply. Relieve any pressure trapped in the hose by squeezing trigger 2-3 times.
3. Separate lance from gun.
4. Rotate nozzle to the narrow stream setting. This opens up the fan blades.
5. Using included tip cleaner, or an unfolded paper clip, insert wire into the nozzle hole and move back and forth until debris is dislodged. (See image)
6. Remove additional debris by back-flushing water through the nozzle. To do this, place end of a garden hose (with water running) to end of nozzle for 30-60 seconds.

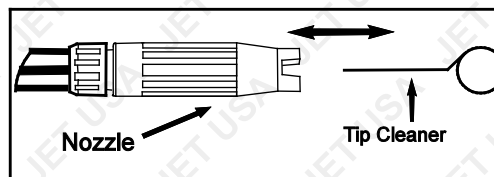

**Figure 5- Insert tip cleaner in nozzle hole and move back and forth until debris is dislodged**

## Water screen

Some pressure washers are equipped with a water inlet screen to protect the pump. If the screen is not kept clean, it will restrict the flow of water to the pressure washer and may cause damage to the pump.

- The screen is fragile so be careful when cleaning or removing it. Any foreign particles entering the pump may damage it.
- Do not operate the pressure washer without the screen in place (if originally equipped.)
- Remove the screen and back-flush to remove impurities from the screen.
- Replace afterwards immediately

# Troubleshooting

Symptom	Possible cause(s)	Corrective Action(s)
No detergent suction – units with tanks	<ol style="list-style-type: none"> <li>1. Nozzle pressure set to “high”.</li> <li>2. High pressure extension hose is too long.</li> <li>3. Injector clogged on pump.</li> </ol>	<ol style="list-style-type: none"> <li>1. Adjust nozzle to “low pressure” or replace tip with the low pressure detergent application tip.</li> <li>2. Remove high pressure extension hose or use high pressure hose shorter than 25 feet.</li> <li>3. Contact the distributor</li> </ol>
No detergent suction – units with attachable applicators	<ol style="list-style-type: none"> <li>1. Detergent applicator is clogged</li> </ol>	<ol style="list-style-type: none"> <li>1. Clean applicator with warm water.</li> <li>2. Replace the applicator.</li> </ol>
Unit begins to smoke	<ol style="list-style-type: none"> <li>1. Overheated, overloaded or damaged motor.</li> </ol>	<ol style="list-style-type: none"> <li>1. Turn off and call the dealer.</li> </ol>
Pressure washer does not start up	<ol style="list-style-type: none"> <li>1. Unit is pressurised.</li> <li>2. Plug is not well connected or electrical socket is faulty.</li> <li>3. Extension cord is too long or wire size too small.</li> <li>4. Main voltage supply is too low.</li> <li>5. Thermal safety switch has tripped.</li> </ol>	<ol style="list-style-type: none"> <li>1. Squeeze trigger on gun &amp; check for blockages.</li> <li>2. Check plug, socket and fuse.</li> <li>3. Remove extension cord.</li> <li>4. Check that main supply voltage age is adequate.</li> <li>5. Switch off motor unit and allow motor to cook down.</li> </ol>
Pump does not reach necessary pressure	<ol style="list-style-type: none"> <li>1. Water inlet filter is clogged</li> <li>2. Pump is sucking air from hose connections</li> <li>3. Nozzle is worn or not correct</li> <li>4. Unloader is clogged or Worn</li> <li>5. Valves is clogged or worn</li> </ol>	<ol style="list-style-type: none"> <li>1. Clean the water inlet filter.</li> <li>2. Check that connections and locking ring are properly tightened.</li> <li>3. Call the dealer.</li> <li>4. Call the dealer.</li> <li>5. Call the dealer.</li> </ol>
Fluctuating Pressure	<ol style="list-style-type: none"> <li>1. Pump is sucking in air.</li> <li>2. Clogged nozzle.</li> <li>3. Valves dirty, worn or stuck.</li> <li>4. Water Seals worn.</li> </ol>	<ol style="list-style-type: none"> <li>1. Check that the hoses and connections are tight.</li> <li>2. Clean with tip cleaner(see page 8)</li> <li>3. Call the dealer</li> <li>4. Call the sealer</li> </ol>
Motor stops suddenly	<ol style="list-style-type: none"> <li>1. Extension cord is too long or wire size too small.</li> <li>2. Thermal safety switch has tripped due to overheating.</li> </ol>	<ol style="list-style-type: none"> <li>1. Remove extension cord (see page 4)</li> <li>2. Check that main supply corresponds to specifications.</li> </ol>
Weak water pressure	<ol style="list-style-type: none"> <li>1. Nozzle is set to low.</li> </ol>	<ol style="list-style-type: none"> <li>1. Please check the nozzle to ensure it is set to High. If the nozzle is set to low, then the pressure will be weak.</li> </ol>

## Specifications

### PRES-ELEC-11095



Voltage: 240V / 50Hz (10 Amp Plug)  
Motor (W): 2350  
Max. Rated PSI: 3200  
Continuous rated PSI: 1800  
Flow Rate (L/min): 6.5  
Hose length (m): 5  
Detergent tank: Included  
Power Cable Length (m): 5  
Max inlet temp (°C): 50

### PRES-ELEC-13595



Voltage: 240V / 50Hz (10 Amp Plug)  
Motor (W): 1850  
Max. Rated PSI: 3200  
Continuous rated PSI: 2000  
Flow Rate (L/min): 5.7  
Hose length (m): 8  
Detergent tank: Included  
Power Cable Length (m): 5  
Max inlet temp (°C): 50  
Hose reel: Included

### PRWELC450USAACAB



Voltage: 240V / 50Hz (10 Amp Plug)  
Motor (W): 1850  
Max. Rated PSI: 2900  
Continuous rated PSI: 1600  
Flow Rate (L/min): 5  
Hose length (m): 8  
Detergent tank: Included  
Power Cable Length (m): 5  
Max inlet temp (°C): 50



### PRWELC550USAACAB



Voltage: 240V / 50Hz (10 Amp Plug)  
Motor (W): 3200  
Max. Rated PSI: 3800  
Continuous rated PSI: 2500  
Flow Rate (L/min): 8.5  
Hose length (m): 30  
Detergent tank: Included  
Power Cable Length (m): 5  
Max inlet temp (°C): 50  
Hose reel: Included

### PRSWSH-ELEC-3200WF



Voltage: 240V / 50Hz (10 Amp Plug)  
Motor (W): 3200  
Max. Rated PSI: 3800  
Continuous rated PSI: 2500  
Flow Rate (L/min): 6.8  
Hose length (m): 10  
Detergent tank: Included  
Power Cable Length (m): 5  
Max inlet temp (°C): 50  
Hose reel: Included

### PRWELCJETA470



Voltage: 240V/50HZ  
Power: 2100W  
Motor: Brush Motor (Aluminium)  
Maximum Pressure: 3100PSI (241Bar)  
Continuous Pressure: 2000PSI (138Bar)  
Flow Rate: 6.2L/min  
Max Flow Rate: 7.1L/min



## **PRWELCJETA500**



**Voltage: 240V/50HZ**  
**Motor Power: 2400W (Peak) Induction**  
**Maximum Pressure: 3500PSI (241Bar)**  
**Continuous Pressure: 2150PSI (148Bar)**  
**Rated Flow Rate: 6.5L/min**  
**Max Flow Rate: 8.2L/min**  
**Cable Length: 5m**  
**Hose Length: 8m**



**Some experts believe that the incorrect or prolonged use of almost any product may cause serious injury or death. To help reduce your risk of serious injury or death, refer to the information below. For more information, see [www.datastreamserver.com/safety](http://www.datastreamserver.com/safety)**

Consult all documentation, packaging and product labelling before use. Note that some products feature documentation available online. It is recommended to print and retain the documentation.

Before each use, check the product for loose/broken/damaged/missing parts, wear or leaks (if applicable). Never use a product with loose/broken/damaged/missing parts, wear or leaks.

Products must be inspected and serviced (if applicable) by a qualified technician every 6 months. This is based on average residential use by persons of average size and strength, and on a property of average metropolitan size. Use beyond these recommendations may require more frequent inspections/servicing.

Ensure that all users of the product have completed a suitable industry recognised training course before being allowed access to the product.

The product has been supplied by a general merchandise retailer that may not be familiar with your specific application or description of application. Be sure to attain third-party approval from a qualified specialist for your application before use, regardless of any assurances from the retailer or its representatives.

This product is not intended for use where fail-safe operation is required. As with any product (for example, automobile, computer, toaster), there is the possibility of technical issues that may require the repair or replacement of parts, or the product itself. If the possibility of such failure and the associated time it may take to rectify could in any way inconvenience the user, business or employee, or financially affect the user, business or employee, then the product is not suitable for your requirements. This product is not intended for use where incorrect operation or a failure of any kind, including but not limited to, a condition requiring product return, replacement, parts replacement or service by a technician may cause financial loss, loss of employee time or an inconvenience requiring compensation.

If this product has been purchased in error when considering the information presented here, contact the retailer directly for details of their returns policy, if required.



©2020 Jet-USA. All rights reserved. No part of this document, including descriptive content, concepts, ideas, diagrams or images may be reproduced or transmitted in any form or by any means, electronic or mechanical, including photocopying, scanning or recording, or any information storage and retrieval system, without express permission or consent from the publisher.