



**MULTI XS 25000
EXTENDED**

25 A



PROFESSIONAL BATTERY CARE

MULTI XS 25000 EXTENDED

The MULTI XS 25000 EXTENDED is the perfect workshop charger that charges quickly and easily with all qualifications to solve different battery related problems. Equipped with an extra long 6 meter cable, the charger always reaches the battery to be charged while in the vehicle. Fixed to a hook, work is made even easier by increasing flexibility in the workshop where it can be hung, for example, directly on the vehicle.

It has functions that examine and show if the battery can be charged and maintain a charge, a special reconditioning function that restores stratified and deeply discharged batteries, unique maintenance charging as well as a temperature sensor for optimised charging no matter the weather conditions. The MULTI XS 25000 EXTENDED also has a feed function enabling the battery to be disconnected from the vehicle without losing important settings.

The MULTI XS 25000 EXTENDED is a fully automatic 8-step charger that delivers 25 A to 12 V batteries from 40–500 Ah. The charger is IP44 classed (outdoor use), protects vehicle electronics, is spark free, is protected from polarity reversal and is short circuit proof. It is supplied with a 2 year warranty.

TECHNICAL DATA

CHARGING VOLTAGE	14.4/15.8/13.6 V
CHARGING CURRENT	Max 25 A
TYPE OF CHARGER	8 step, fully automatic charging cycle
TYPE OF BATTERY	12 V lead-acid batteries
BATTERY CAPACITY	40–500 Ah
INSULATION	IP44 (outdoor use)



Fully automatic for optimal charging



For all lead-acid batteries



FULLY CHARGED BATTERY /
MAINTENANCE CHARGING



Temperature sensor



Recondition of deeply discharged batteries



Use the charger as a power supply



6 m cable
CTEK Wall Hanger 300



THE SMARTEST BATTERY CHARGERS IN THE WORLD



**MULTI XS 25000
EXTENDED**

25 A

MULTI XS 25000 EXTENDED

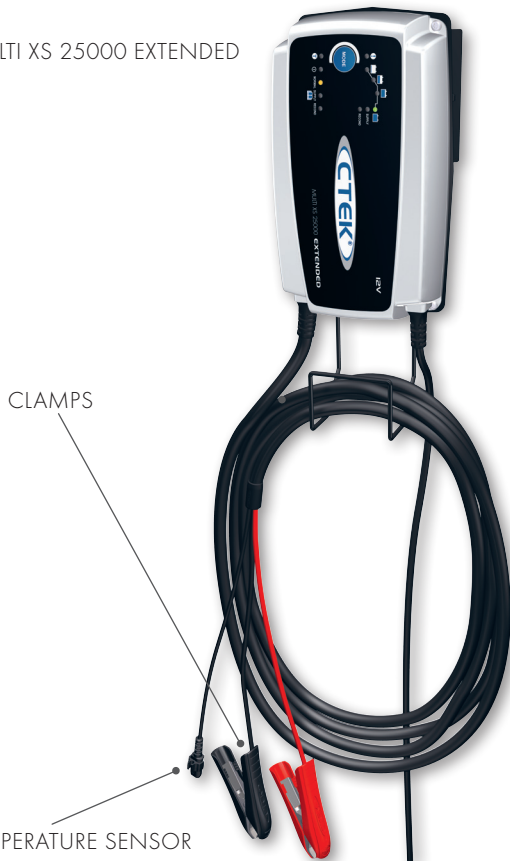

- Temperature compensated and fully automatic charging and maintenance in 8 steps maximizes battery life and performance
- Power Supply that simplifies battery replacement without losing vehicle memory
- Patented maintenance charge for a unique combination of maximized life and performance
- Recondition of deep discharged batteries
- Patented desulphation that extends the battery life
- No sparks, short-circuit proof and reverse-polarity protected for untroubled usage
- Automatic detection of end-of-life batteries that eliminates surprises

READY TO USE

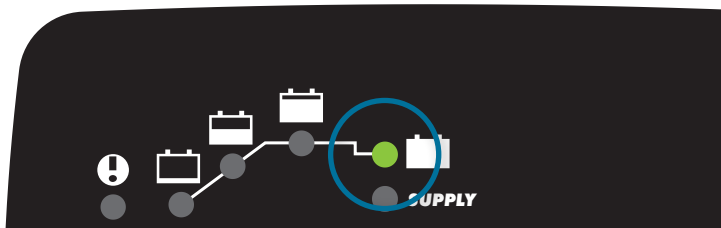

The table shows the estimated time for empty battery to 80 % charge.

BATTERY SIZE (Ah)	TIME TO 80 % CHARGED
40	1.5 h
100	3 h
200	6 h
350	16 h

CTEK CHARGING

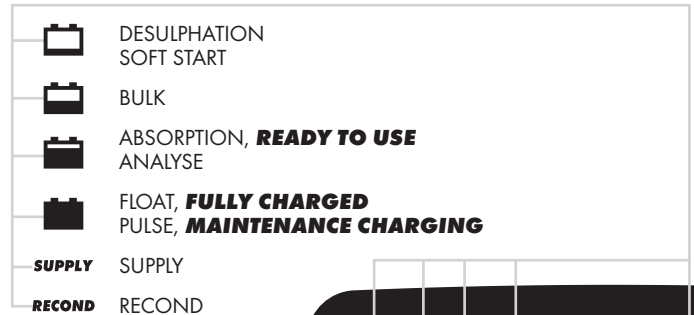

PROGRAMS

NORMAL	25 A/14.4 V
SUPPLY	25 A/13.6 V
RECOND	3 A/15.8 V

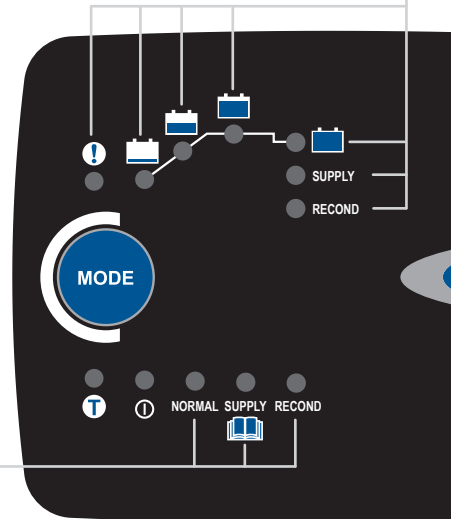

CONNECT AND CHARGE

- 1 CONNECT THE CHARGER TO THE BATTERY
- 2 CONNECT THE CHARGER TO THE WALL SOCKET
- 3 PRESS THE MODE-BUTTON TO SELECT CHARGING PROGRAM

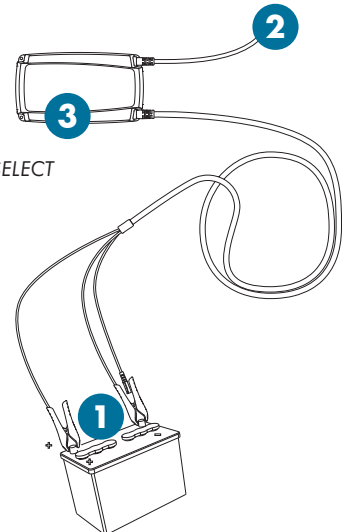

GUARANTEED QUALITY WITH CTEK

CTEK customer support is available to answer any questions related to charging and CTEK chargers. Safety, simplicity and flexibility characterizes all products and solutions developed and sold by CTEK. CTEK supply chargers to more than 60 countries throughout the world. CTEK is also a reliable OEM supplier to many of the world's most prestigious car and motorcycle manufacturers.

Contact customer support: info@ctek.com

www.ctek.com



THE SMARTEST BATTERY CHARGERS IN THE WORLD



Some experts believe the incorrect or prolonged use of almost any product could cause serious injury or death. For information that may reduce your risk of serious injury or death consult the points below and additionally, the information available at www.datastreamserver.com/safety

- Consult all documentation, packaging and product labelling before use. Note that some products feature online documentation which should be printed and kept with the product.
- Check product for loose / broken / damaged / missing parts, wear or leaks (if applicable) before each use. Never use a product with loose / broken / damaged / missing parts, wear or leaks (if applicable).
- Products must be inspected and serviced (if applicable) by a qualified specialist every 6 months assuming average residential use by a person of average weight and strength, above average technical aptitude, on a property matching average metropolitan specification. Intended use outside these guidelines could indicate the product is not suitable for intended use or may require more regular inspection or servicing.
- Ensure all possible users of the product have completed an industry recognised training course before being given access to the product.

- The product has been supplied by a general merchandise retailer that may not be familiar with your specific application or your description of the application. Be sure to attain third party approval for your application from a qualified specialist before use regardless of prior assurances by the retailer or its representatives.
- This product is not intended for use where fail-safe operation is required. As with any product (take an automobile, aircraft, computer or ball point pen for example) there is always a small chance of a technical issue that needs to be repaired or may require replacement of the product or a part. If the possibility of such failure and the associated time it takes to rectify could in any situation inconvenience the user, business or employee or could financially affect the user, business or employee then the product is not suitable for your requirements. This product is not for use where incorrect operation or a failure of any kind, including but not limited to a condition requiring product return, replacement, service by a technician or replacement of parts could cause a financial loss, loss of employee time or an inconvenience requiring compensation.
- If this item has been purchased in error considering the points above simply contact the retailer directly for details of their returns policies if required.