

Bäumr-AG



CHAINSAW SHARPENER

USER MANUAL

RETAIN THIS MANUAL FOR FUTURE REFERENCE

PLEASE READ THIS MANUAL CAREFULLY BEFORE USE

TABLE OF CONTENTS

PREFACE.....	1
PARTS.....	2
SAFETY INFORMATION.....	3
ELECTRICAL SAFETY.....	5
ASSEMBLY.....	6
GRINDING	9
Grinding depth Delimiter	10
DIMENSIONS	11
SPECIFICATIONS	14

PREFACE

Thanks for buying the Chainsaw Sharpener, another high-quality machine from our company. To get the most out of your purchase, please read the manual before use.

We ask you to please read this manual carefully beforehand in order to familiarise yourself with this product and after reading, please store this instructional manual for future reference. Failure to follow the proper protocols listed in the manual may cause personal injury to the operator or damage to equipment.

PARTS

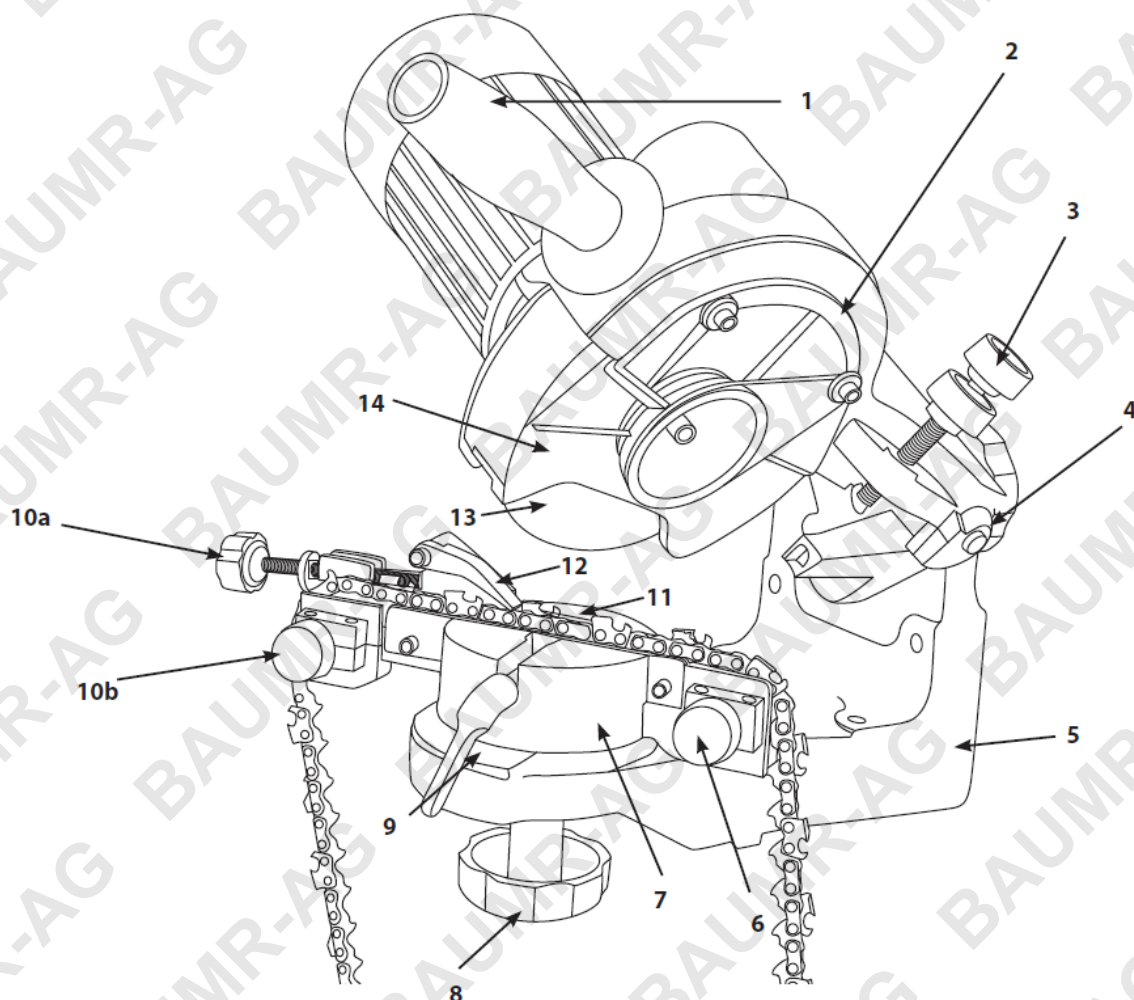

POSITION	DESCRIPTION
1	Hand Piece
2	Grinding Disk Lateral Guard
3	Depth of Grind Set Screw
4	Cutting Edge Angle Set-Up Wheel
5	Base
6	Guide Screw
7	Rotary Table

POSITION	DESCRIPTION
8	Cutting Angle Setting Wheel
9	Scale
10	Mounting Screw (10a/10b)
11	Guide Plate
12	Chain Stop
13	Grinding Disk
14	Grinding Disk Protective Enclosure

SAFETY INFORMATION



Chainsaw sharpeners can be dangerous when used improperly. Please observe basic safety precautions to eliminate risk of fire, electric shock and personal injuries.

- Familiarise yourself with the sharpener before use.
- Only use the sharpener for the application it is designed for.
- Mount the sharpener on a non-skid and level ground.
- Ensure that you stand securely and maintain your balance at all times.
- Be attentive and be careful of what you do. One moment of carelessness when using the device can result in serious injuries.
- Do not use the device when you are tired or under the influence of drugs or alcohol.
- Wear suitable work clothes!
 - Do not wear loose-fitting clothes or jewellery that can get caught in moving parts.
 - Wear gloves and slip-proof shoes.
 - Wear a hairnet if your hair is long.
- Wear protective clothing.
 - Safety goggles
 - Ear protection (sound intensity level at workplace can exceed 78 dB (A))
 - Dust mask
- Keep your workplace in an orderly condition.
- Take into consideration the environmental influences:
 - Do not use the device in moist or wet conditions.
 - Do not expose the chainsaw sharpener to rain.
 - Only work with sufficient visibility conditions. Provide good illumination.
- Never leave the machine unattended.
- Persons under the age of 18 must not operate the device.
Do not allow other people, especially children, to touch the sharpener.
Keep them away from your working area.
- Do not overload the machine!
- Only operate the machine with complete and correctly attached safety equipment.
- Do not use any grinding wheels which do not comply with the indicated characteristics of this instruction manual.
- Worn and defective grinding wheels (cracks, imbalance, chipping, etc.) must be replaced immediately.

- Switch the machine off and remove the mains plug from the socket when:
 - Carrying out repairs
 - Maintenance and cleaning
 - Storage
 - Leaving the chainsaw sharpener (even in case of short-term interruptions)
- Maintain your chainsaw sharpener with care:
 - Keep the sharpener free of oil and grease.
 - Follow the maintenance instructions and the instructions for tool exchange.
- Check the machine for possible damage:
 - Before continuing to use the machine, the protective devices must be inspected to ensure that they work perfectly for their intended function.
 - Check whether the movable parts function perfectly and do not stick or whether the parts are damaged. All parts must be properly mounted and all conditions met to ensure the flawless operation of the chainsaw sharpener.
 - Unless otherwise, indicated in the operating instructions, damaged safety devices and parts must be properly repaired by an authorised workshop.
 - Damaged or illegible safety warning labels should be replaced immediately.
 - Do not allow any tool key to be plugged in!

Before switching on, check always that wrenches and adjusting tools are removed.

- Store unused equipment in a dry, locked place out of reach of children.

ELECTRICAL SAFETY

- Long and thin connection lines will result in a potential drop.
- Plugs and coupler outlets on connection cables must be made of rubber, non-rigid PVC or other thermoplastic material of the same mechanical stability.
- The connector of the connection cable must be splash-proof.
- When running the connection line, make sure it is neither bent or stretched
- Never run the sharpener with a wet plug connection
- Wind the cable completely when using a cable drum.
- Only use the cable as it was intended.
- Protect the cable against heat, oil and sharp edges.
- Do not use the cable to pull the plug from the socket.
- Protect yourself against electric shocks. Avoid touching earthed parts (e.g. pipes, heating apparatus, cooker, fridges etc.)
- Regularly check the extension cables and replace them if they are damaged.
- Do not use any defective connection cables.
- Do not set up any provisional electrical connections.
- Never bypass protective devices or deactivate them.



The electrical connection or repairs to electrical parts of the machine must be carried out by a certified electrician or by a representative of the manufacturer.

Use only original spare parts, accessories and special accessory parts. Accidents can arise for the user through the use of other spare parts. The manufacturer is not liable for any damage or injury resulting from such action.

ASSEMBLY

The chainsaw sharpener is delivered pre-assembled. It consists of the base, on which the chain guide is located and the bearing arm with the motor and handgrip.



The assembly should be performed with the machine unplugged.

The sharpener is suited for both desk installation and wall mounting. When installing it on the desk, put the machine on the edge of the desk and screw it to the desk using the holes in the base.

When mounting on the wall, use the respective holes in the vertical part of the base (there should be a maintained distance from the wall or alternately spacers can be used to gain access to the rear set screw).

After the desk installation, fit the arm in the base by inserting the pilot pin and securing it with a hexagonal screw (Fig. 1).

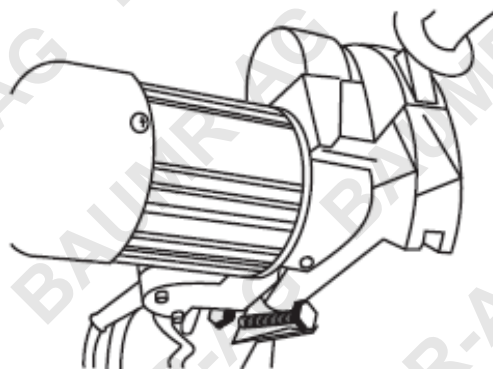
F1

It is possible to fit a washer on the rear side screw and screw the setting wheel on. (Fig. 2).

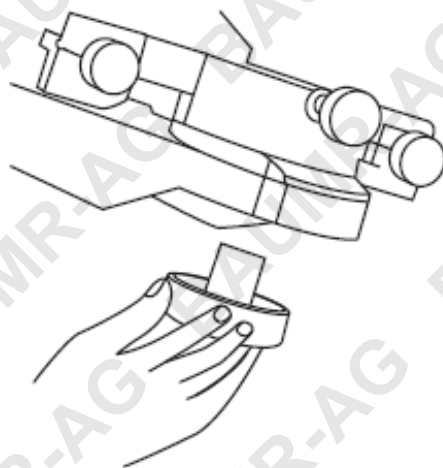
F2

Screw the supporting arm control holder on the screw in the grinding disk body. (Fig. 3).

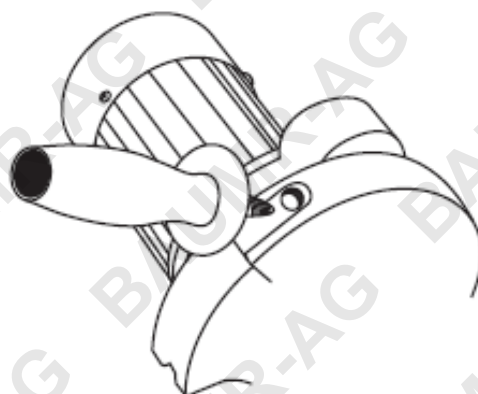
F3

Fit the grinding disk enclosure in using the supplied screws and a respective wrench. (Fig. 4).

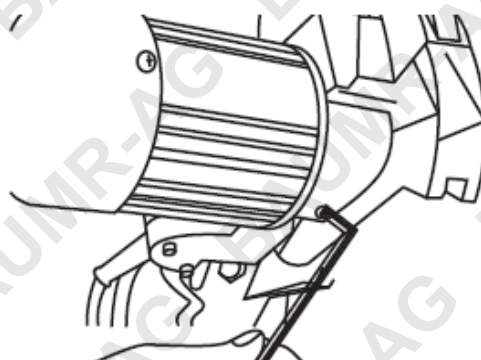
F4

When mounting on the wall, carefully mount the machine at a height of 120-130 cm from the floor to avoid working at eye height!

To be able to install the disk, unscrew the auxiliary flange. (Fig. 5).

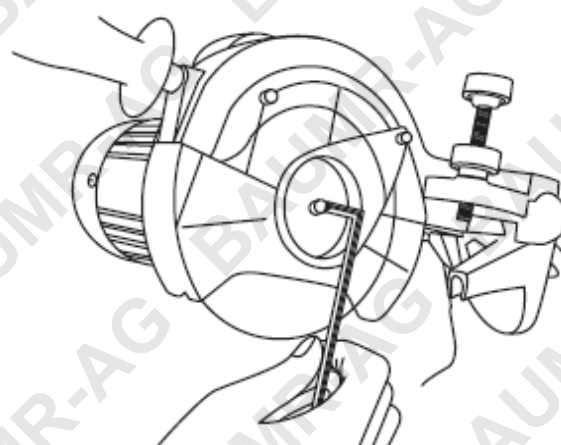
F5

After you have removed the ancillary flange, you can insert the grinding disk in the body from below. See that the ancillary flange and the disk abut against each other precisely. (Fig. 6).

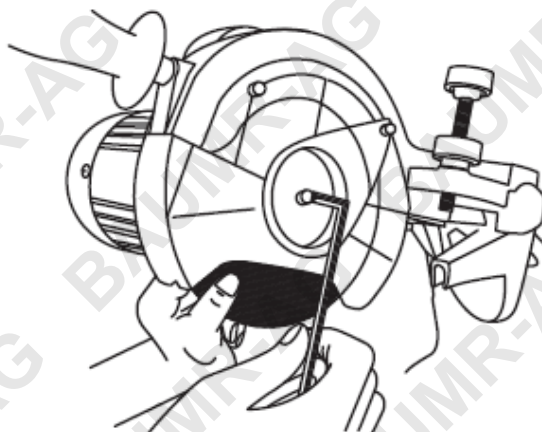
F6

Do not tighten the screws too much to avoid damaging to the disk. The grinding disk on the hub torque is 7 Nm; you can adjust it using a torque spanner. Now, the grinding disk additional guard should be fitted on (Fig. 7).

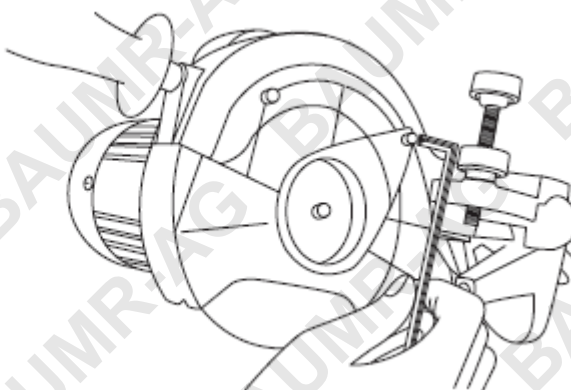
F7

Check the correct bottoming of the disk: it should not move across and lengthwise. With the grinding disk properly installed, a trial may be performed.

If the grinding disk is vibrating or shows otherwise wobbling, switch off and unplug the machine before you attempt in clearing the fault.

The machine has a zero voltage circuit breaker, which is disabled on outage and will prevent any restarting of the machine after the power supply is restored.

Using the sharpening stone and a clamping plate, it is possible to sharpen the disk to obtain the required profile.

GRINDING

Before the start of grinding, the chain should be conducted between both the attachment guides. The sharpening angle must correspond to the guide's position.

The type of chain to be sharpened can be determined using the sharpening block provided on the dimension table.

Loosen the mounting screw (10b) and place the cutting chain in the guide rail between the guide plate (Fig. 11).

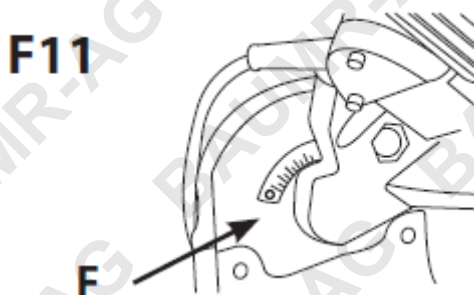

Fold the chain stop (Fig.12) down and pull the chain toward the back until the cutting link rests against the stop.

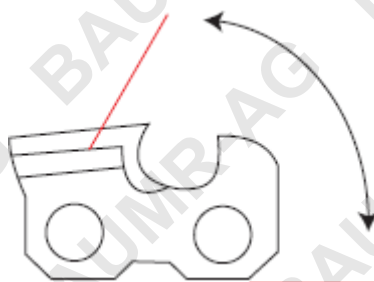

Set the top plate angle by means of the set screw (P.2, P.4); you can also use the scale to set the angle. The vice angle should be setup by the set screw.

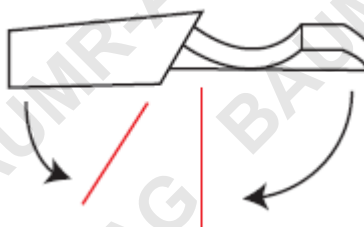

With the clamping screw adjusted and the vice angle setup (RH and LH teeth are different) and pre-set to the top plate angle, set the distance with the help of the mounting screw (10a), lead the grinding disk down to the tooth by soft pushing the supporting strut. The grinding depth may be set by the set screw (K).

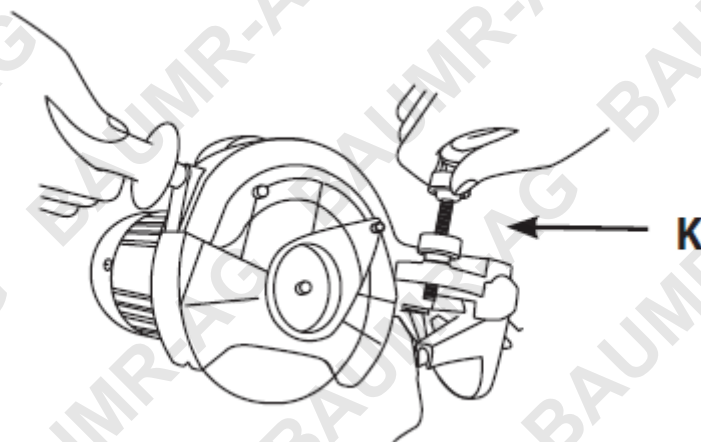

Tighten the mounting screw (10b); and after this you may switch the sharpener on. The chainsaw sharpening may be started by gently pushing on the grinding disk. Adjust the pressure as necessary. Mark the start of grinding with a piece of chalk and grind all the teeth in one direction, then turn the clamping screw, minding the angle, and grind the teeth in the opposite direction.

With worn chains, the lateral guide position should be set at an angle where the grinding disk can't touch the guide.

While operating the sharpener, avoid strong thrusting as the teeth might collide and cause excessive wear and tear of the chain.

GRINDING DEPTH DELIMITER

The size of the depth delimiter can be determined by the table on page 11.

When you are grinding the depth delimiter, the screw clamp position should always be at a rate of 0.

Set the supporting strut and holder at 90 degrees. The grind depth can be set using the set screw K.

DIMENSIONS

CHAIN PITCH	GAUGE	OREGON	STIHL	SANDVIK	CARLTON	WISE ANGLE	TOP PLATE ANGLE	TILT ANGLE	WHEEL WIDTH	DEPTH GAUGE
1/4"	0.050"/1.3mm	25AP	13RM	50K		30 °	60 °	10 °	1/8"3.2mm	0.025"/0.63mm
0.325"	0.050"/1.3mm	20LP	23RS	50JLG	K1L	25 °	60 °	10 °	1/8"3.2mm	0.025"/0.63mm
0.325"	0.058"/1.5mm	21LP	25RS	58JLG	K2L	25 °	60 °	10 °	1/8"3.2mm	0.025"/0.63mm
0.325"	0.063"/1.6mm	22LP	26RS	63JLG	K3L	25 °	60 °	10 °	1/8"3.2mm	0.025"/0.63mm
0.325"	0.050"/1.3mm	20BP	23RM	50JLG	K1C	30 °	60 °	10 °	1/8"3.2mm	0.025"/0.63mm
0.325"	0.058"/1.5mm	21BP	25RM	58JLG	K2C	30 °	60 °	10 °	1/8"3.2mm	0.025"/0.63mm
0.325"	0.063"/1.6mm	22BP	26RM	63JLG	K3C	30 °	60 °	10 °	1/8"3.2mm	0.025"/0.63mm
0.325"	0.050"/1.3mm	95VP			K1N	30 °	60 °	10 °	1/8"3.2mm	0.025"/0.63mm
0.325"	0.050"/1.3mm	95R				5 °	50 °	10 °	1/8"3.2mm	0.030"/0.76mm
0.325"	0.058"/1.5mm	M21LP				25 °	60 °	10 °	1/8"3.2mm	0.025"/0.63mm
0.325"	0.063"/1.6mm	M22LP				25 °	60 °	10 °	1/8"3.2mm	0.025"/0.63mm
3/8"	0.050"/1.3mm	72LG	33RS	50AL	A1LM	25 °	60 °	10 °	1/8"3.2mm	0.025"/0.63mm
3/8"	0.058"/1.5mm	73LG	35RS	58AL	A2LM	25 °	60 °	10 °	1/8"3.2mm- 3/16"/4.7mm	0.025"/0.63mm
3/8"	0.063"/1.6mm	75LG	36RS	63AL	A3LM	25 °	60 °	10 °	1/8"3.2mm- 3/16"/4.7mm	0.025"/0.63mm
3/8"	0.050"/1.3mm	72LP	33RS	50AG	A1L	25 °	60 °	10 °	1/8"3.2mm- 3/16"/4.7mm	0.025"/0.63mm

CHAINSAW SHARPENER

Bäumr-AG

CHAIN PITCH	GAUGE	OREGON	STIHL	SANDVIK	CARLTON	WISE ANGLE	TOP PLATE ANGLE	TILT ANGLE	WHEEL WIDTH	DEPTH GAUGE
3/8"	0.058"/1.5mm	73LP	35RS	58AG	A2L	25 °	60 °	10 °	1/8"3.2mm-3/16"/4.7mm	0.025"/0.63mm
3/8"	0.063"/1.6mm	75LP	36RS	63AG	A3L	25 °	60 °	10 °	1/8"3.2mm-3/16"/4.7mm	0.025"/0.63mm
3/8"	0.050"/1.3mm	72DP	33RMI		A1EP	35 °	60 °	0 °	1/8"3.2mm-3/16"/4.7mm	0.025"/0.63mm
3/8"	0.058"/1.5mm	73DP			A2EP	35 °	60 °	0 °	1/8"3.2mm-3/16"/4.7mm	0.025"/0.63mm
3/8"	0.063"/1.6mm	75DP	36RMI		A3EP	35 °	60 °	0 °	1/8"3.2mm-3/16"/4.7mm	0.025"/0.63mm
3/8"	0.050"/1.3mm	72RD				10 °-15 °	50 °	10 °	1/8"3.2mm-3/16"/4.7mm	0.025"/0.63mm
3/8"	0.058"/1.5mm	73RD				10 °-15 °	50 °	10 °	1/8"3.2mm-3/16"/4.7mm	0.025"/0.63mm
3/8"	0.063"/1.6mm	75RD	36RMX			10 °-15 °	50 °	10 °	1/8"3.2mm-3/16"/4.7mm	0.025"/0.63mm
3/8"	0.058"/1.5mm	M73LP				25 °	60 °	10 °	1/8"3.2mm-3/16"/4.7mm	0.025"/0.63mm
3/8"	0.063"/1.6mm	M75LP				25 °	60 °	10 °	1/8"3.2mm-3/16"/4.7mm	0.025"/0.63mm
3/8 (90)	0.043"/1.1mm	90SG	63PMN		N4C	30 °	60 °	0 °	1/8"3.2mm-3/16"/4.7mm	0.020"/0.50mm
3/8 (91)	0.050"/1.3mm	91VS	63PM	50R	N1C	30 °	60 °	0 °	1/8"3.2mm-3/16"/4.7mm	0.025"/0.63mm
3/8 (91)	0.050"/1.3mm	91VG	63PMI	50RG	NIC-BC	30°	60 °	0 °	1/8"3.2mm-3/16"/4.7mm	0.025"/0.63mm

CHAINSAW SHARPENER

Bäumr-AG

CHAIN PITCH	GAUGE	OREGON	STIHL	SANDVIK	CARLTON	WISE ANGLE	TOP PLATE ANGLE	TILT ANGLE	WHEEL WIDTH	DEPTH GAUGE
3/8 (91)	0.050"/1.3mm	91R	63PMX			5°	60 °	0 °	1/8"3.2mm- 3/16"/4.7mm	0.025"/0.63mm
0.404"	0.058"/1.5mm	581			B2LM	25°	60 °	10 °	3/16"/4.7mm	0.025"/0.63mm
0.404"	0.063"/1.6mm	591			B3LM	25°	60 °	10 °	3/16"/4.7mm	0.025"/0.63mm
0.404"	0.058"/1.5mm	26/P		58B	B2EP	35°	60 °	10 °	3/16"/4.7mm	0.030"/0.76mm
0.404"	0.063"/1.6mm	27/P	46RSE	63B	B3EP	35°	60 °	10 °	3/16"/4.7mm	0.030"/0.76mm
0.404"	0.063"/1.6mm	59AC	46RM	63BC	B3S	35°	60 °	0 °	3/16"/4.7mm	0.030"/0.76mm
0.404"	0.63"/1.6mm	27R	46RMX	63BR	B3RM10	10 °-15 °	50 °	10 °	3/16"/4.7mm	0.030"/0.76mm
0.404"	0.63"/1.6mm	16H	46RMH	HC	B3M	35°	60 °	10 °	3/16"/4.7mm	0.050"/1.27mm
0.404"	0.080"/2.0mm	18H	49RMH	2HC	B3M	35°	60 °	10 °	3/16"/4.7mm	0.050"/1.27mm
3/4"	0.122"/3.1mm	11H			G7S	35°	60 °	10 °	1/4"/6mm	0.050"/1.27mm

SPECIFICATIONS

TYPE	SH0910
OPERATING VOLTAGE	220-240V
RATED POWER	230W
MAX. POWER	Output: 350W @ 50% Duty Cycle
MAX. MOTOR RPM	3,000 RPM
MOTOR RATING P1	350W
MAX. CUTTING LENGTH	250mm
VICE CAPACITY	0.80" to 0.50"
LIGHT WATTAGE	35W
MAX. WORKING ANGLE	35 Degrees Left to Right
GRINDING DISC SIZE	145 x 3.2 x 22.3mm Arbor
APPROVALS	CE, GS, C-TICK, EMC
LWA / LPA	85/72 dB (A)
GROSS WEIGHT	8 kg
VIBRATION	3.21 m/s ²



Some experts believe the incorrect or prolonged use of almost any product could cause serious injury or death. For information that may reduce your risk of serious injury or death consult the points below and additionally, the information available at www.datastreamserver.com/safety

- Consult all documentation, packaging and product labelling before use. Note that some products feature online documentation which should be printed and kept with the product.
- Check product for loose / broken / damaged / missing parts, wear or leaks (if applicable) before each use. Never use a product with loose / broken / damaged / missing parts, wear or leaks (if applicable).
- Products must be inspected and serviced (if applicable) by a qualified specialist every 6 months assuming average residential use by a person of average weight and strength, above average technical aptitude, on a property matching average metropolitan specification. Intended use outside these guidelines could indicate the product is not suitable for intended use or may require more regular inspection or servicing.
- Ensure all possible users of the product have completed an industry recognised training course before being given access to the product.

- The product has been supplied by a general merchandise retailer that may not be familiar with your specific application or your description of the application. Be sure to attain third party approval for your application from a qualified specialist before use regardless of prior assurances by the retailer or its representatives.
- This product is not intended for use where fail-safe operation is required. As with any product (take an automobile, aircraft, computer or ball point pen for example) there is always a small chance of a technical issue that needs to be repaired or may require replacement of the product or a part. If the possibility of such failure and the associated time it takes to rectify could in any situation inconvenience the user, business or employee or could financially affect the user, business or employee then the product is not suitable for your requirements. This product is not for use where incorrect operation or a failure of any kind, including but not limited to a condition requiring product return, replacement, service by a technician or replacement of parts could cause a financial loss, loss of employee time or an inconvenience requiring compensation.
- If this item has been purchased in error considering the points above simply contact the retailer directly for details of their returns policies if required.

Bäumr-AG®
.com.au