



12V Jump Starter/Powerbank

User Manual



RETAIN THIS MANUAL FOR FUTURE REFERENCE

PLEASE READ THIS MANUAL CAREFULLY BEFORE USE

Table of Contents

PREFACE	1
PRODUCT LAYOUT	2
OPERATION GUIDANCE	3
Indicator.....	3
12V Jump Starter/Powerbank Charging Instructions.....	3
Jumpstarting the 12V Vehicle Instruction.....	3
Charging Cell Phones or Tablets Instruction.....	4
LED Flashlight.....	4
PARTS LIST	5
TECHNICAL SPECIFICATIONS	6
FAQS	7
TROUBLESHOOTING	8
TOXIC AND HARMFUL SUBSTANCES	9
WARNINGS	10
WARRANTY INFORMATION	12

Preface

Thank you for choosing the 12V Jump Starter/Powerbank! Always follow basic safety precautions when using electrical appliances. Read all instructions carefully, Please keep this instruction manual for easy reference.

Product Layout

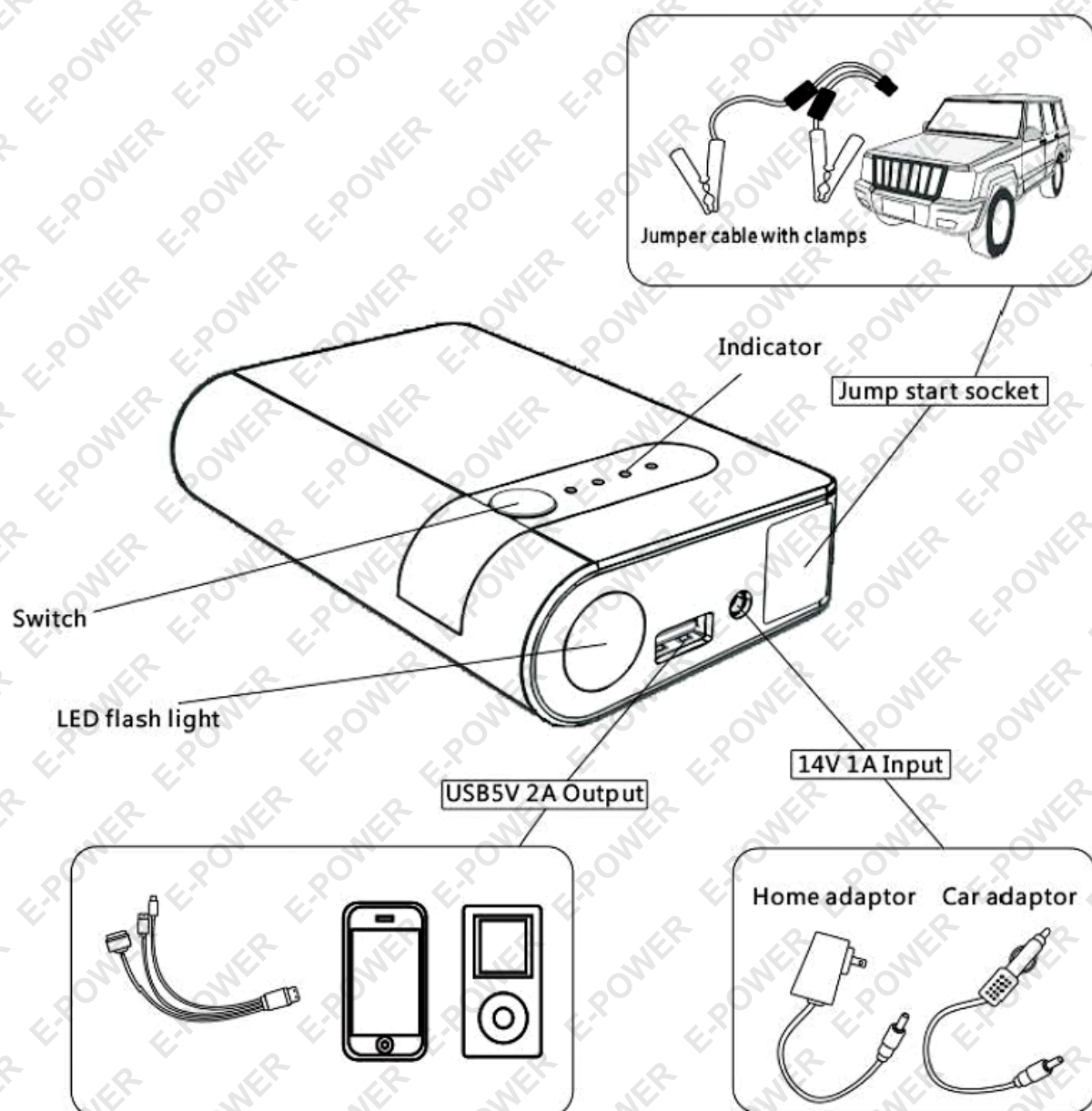

Operation Guidance

Indicator

Press the switch to check the storage level of E-POWER.

Indicator	1 Flashing	1 solid	2 solid	3 solid	4 solid
Storage Level	0%	25%	50%	75%	100%

The indicator will flash one by one during the period of charging.

Different numbers of solid indicators show different storage level of E-POWER. All indicators light off when the charging is paused or completed.

12V Jump Starter/Powerbank Charging Instructions

1. Plug the home adaptor into the universal socket.
2. Connect the 14V1A input port of the 12V Jump Starter/Powerbank to the other end of the home adaptor.

Or

1. Plug the car adaptor into the socket of the cigarette lighter.
2. Connect the 14V1A input port of the 12V Jump Starter/Powerbank to the other end of car adaptor.

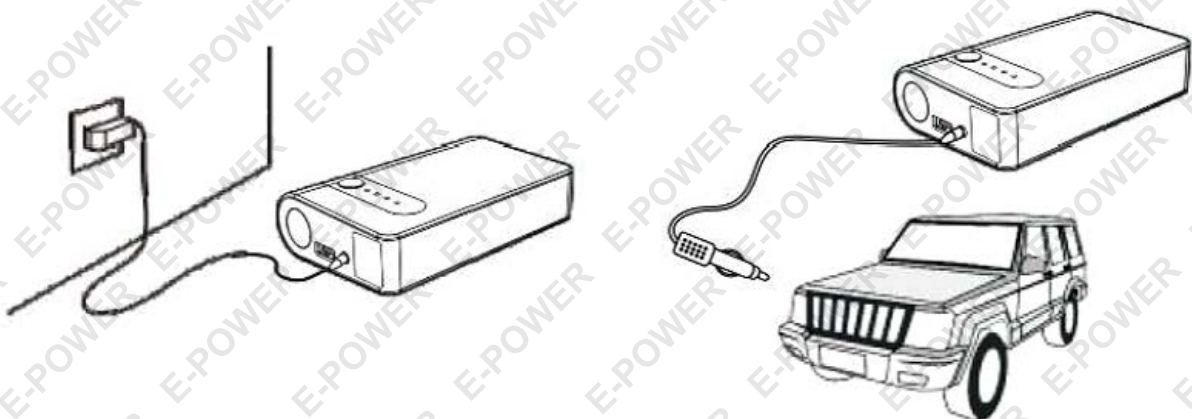

Jumpstarting the 12V Vehicle Instruction

1. Make sure that the number of indicators is not less than three.
2. Connect the RED clamp to the vehicle's battery positive (+) terminal and connect the BLACK clamp to the vehicle's battery negative (-) terminal.
3. Plug the cord of the jumper cable into the jump start socket.
4. Start the vehicle.
5. When the vehicle has started, remove the jumper cable from the E-POWER and disconnect both the RED and BLACK clamps from the vehicle battery.

6. Leave the vehicle's engine running.

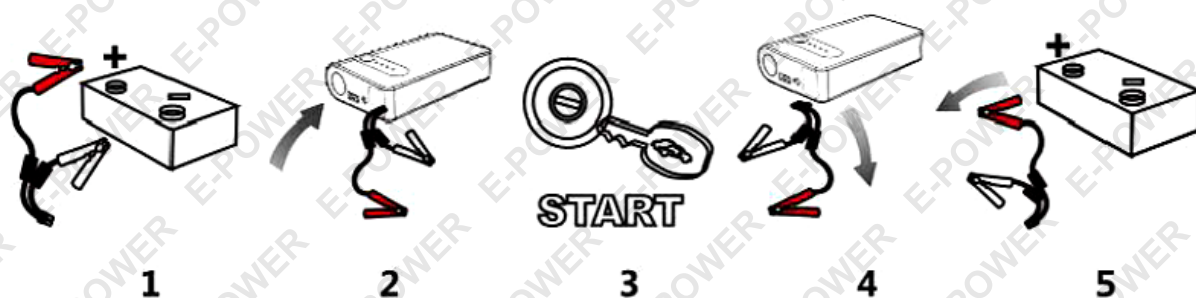

Charging Cell Phones or Tablets Instruction

1. Plug the switch cable to the USB 5V/2A output port.
2. Select the appropriate connector for your cell phone or tablet and connect it to any of them, the 12V Jump Starter/Powerbank can identify and charge the electronic device automatically. The indicators will be turned ON when the device is charging.

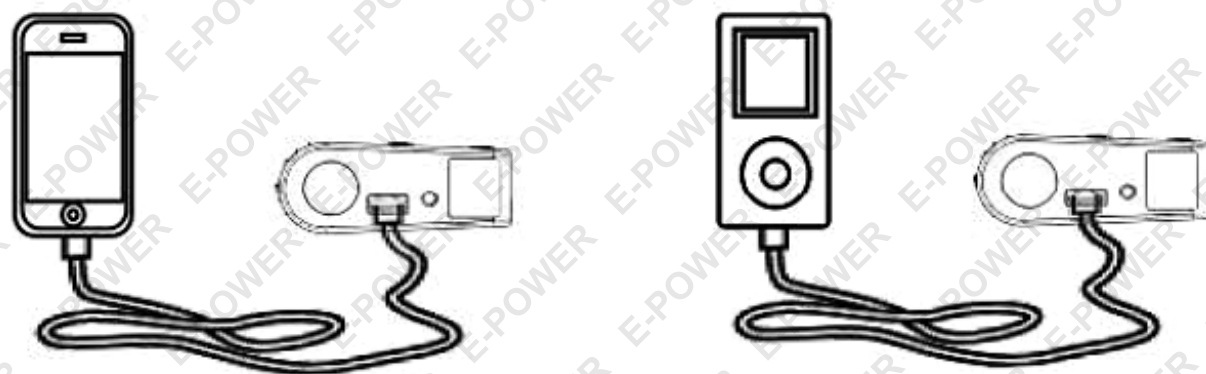

LED Flashlight

1. Press the switch for three seconds to start the LED flash light.
2. If you press the switch lightly, four modes of LED light will appear: Normal, Strobe, SOS and OFF.

Parts List

No.	Parts Name	Quantity
1	Host	1
2	Switch Cable	1
3	Home Adaptor	1

No.	Parts Name	Quantity
1	Car Adaptor	1
2	Jumper Cable with Clamps	1
3	User Manual	1

Technical Specifications

Dimension:	131 x 75 x 25mm
Weight:	300g
Output:	5V2A; 12V Jump Start
Input:	14V1A
Full Charging Time:	3 hours
Starting Current:	200A
Peak Current:	400A
Operating Temperature:	-20°C ~ 60°C

FAQs

Q: How do you turn off this appliance?

A: This appliance will power off automatically when there is no load or when charging is complete.

Q: How many times can this appliance charge my cell phone?

A: Four times, at the least.

Q: How long will this appliance fully charge my cell phone?

A: Approximately one hour.

Q: How many times can this appliance start a vehicle on a full charge?

A: Approximately 10 times.

Q: How long can the power of this appliance's battery last?

A: 6-12 months. However, we suggest that you recharge it every three months.

Troubleshooting

Finding	Cause	Remedies
No response when pressing the switch button.	A low-voltage protection for the 12V Jump Starter/Powerbank has started.	Plug the adapter into the 14V1A input port to activate.

Toxic and Harmful Substances

Composition and amount of toxic and harmful substances in the 12V Jump Starter/Powerbank

Pb	Hg	Cd	Cr(Vi)	PBB	PBDE
O	O	O	O	O	O

O: Indicates that all homogeneous materials' hazardous substances contents are below the MCV limit specified in the Standard 2002/95/EC (RoHs).

Warnings

1. Always make sure that the blue plug of the jumper cable connects with the jump start socket tightly in the 12V Jump Starter/Powerbank before jumpstarting the vehicle. Otherwise, it will affect the results, even causing the blue plug to melt.
2. Always check if the jumper clamps are well connected; check if the vehicle battery connector is rusty or dirty; clean it before jumpstarting the vehicle. DO NOT jumpstart again after 3 attempts. Otherwise, it will damage the host. Check also if your vehicle has other problems.
3. DO NOT connect the two clamps. Very dangerous!
4. DO NOT disassemble the host. Very dangerous!



Always exercise great care when using this appliance.



This appliance is not intended for use by children or persons with disabilities without proper supervision.



Do not use this appliance as a toy.



Do not allow the appliance to become wet.

Do not immerse the appliance in water.



Do not operate the appliance in flammable environments, such as those that contain flammable liquids, gases or materials.



Do not modify or disassemble the 12V Jump Starter/Powerbank. Only a qualified repair technician can repair this unit.



Do not expose the appliance to extreme heat.

Do not store the appliance in locations where the temperature may exceed 70°C.



Charge only at ambient temperatures between 0°C and 40°C.

Charge only with the charger provided with the appliance.



Under extreme conditions, battery leakage may occur. Carefully wipe the liquid off using a cloth and avoid skin contact when you notice liquid on the batteries. In case of skin or eye contact, rinse immediately with clean water and seek medical attention.



At the end of its useful life, discard the appliance with due care for the environment.

Warranty Information

1. We offer a limited warranty for this product against any defects in material and workmanship. The conditions of the warranty are as follows:
2. The warranty is only valid upon presentation of the original receipt (from dealer/retailer) by the original purchaser with the product to be repaired or replaced.
3. The warranty is void if the serial number, date of purchase and label has been removed.
4. The warranty does not cover damage or product failure resulting from normal wear and tear, physical abuse, improper installation, misuse, modification or repairs by unauthorized third parties.
5. We do not assume responsibility for any loss or damage incurred during shipment or as a result of a force majeure.
6. We are not liable for any incidental or consequential damages arising from the use or misuse of this product.
7. All warranty claims are limited to repair or replacement of the defective product and at the sole discretion of us
8. If we repair or replace the product, the product will be covered for the remaining time of the original warranty period. Repair or replacement may involve the use of reconditioned units which are equivalent in function. Replaced part or product becomes our property.
9. Consumable components such as batteries are not covered by the warranty.

The switch cables coming with the unit for testing ONLY, no commercial value, all rights reserved for the original designed company.



Overcharge and
Overdischarge Protection



Fuse Protection



Against-reverse Plug

Applied Standard : GB/T 18287-2000





Some experts believe the incorrect or prolonged use of almost any product could cause serious injury or death. For information that may reduce your risk of serious injury or death consult the points below and additionally, the information available at www.datastreamserver.com/safety

- Consult all documentation, packaging and product labelling before use. Note that some products feature online documentation which should be printed and kept with the product.
- Check product for loose / broken / damaged / missing parts, wear or leaks (if applicable) before each use. Never use a product with loose / broken / damaged / missing parts, wear or leaks (if applicable).
- Products must be inspected and serviced (if applicable) by a qualified specialist every 6 months assuming average residential use by a person of average weight and strength, above average technical aptitude, on a property matching average metropolitan specification. Intended use outside these guidelines could indicate the product is not suitable for intended use or may require more regular inspection or servicing.
- Ensure all possible users of the product have completed an industry recognised training course before being given access to the product.

- The product has been supplied by a general merchandise retailer that may not be familiar with your specific application or your description of the application. Be sure to attain third party approval for your application from a qualified specialist before use regardless of prior assurances by the retailer or its representatives.
- This product is not intended for use where fail-safe operation is required. As with any product (take an automobile, aircraft, computer or ball point pen for example) there is always a small chance of a technical issue that needs to be repaired or may require replacement of the product or a part. If the possibility of such failure and the associated time it takes to rectify could in any situation inconvenience the user, business or employee or could financially affect the user, business or employee then the product is not suitable for your requirements. This product is not for use where incorrect operation or a failure of any kind, including but not limited to a condition requiring product return, replacement, service by a technician or replacement of parts could cause a financial loss, loss of employee time or an inconvenience requiring compensation.
- If this item has been purchased in error considering the points above simply contact the retailer directly for details of their returns policies if required.