



JH5000E

JH6000E

JH8000F

JH9500F

JH12000F

JH13000F



Easy Off-Roading Adventure Starts from Our Winch





Thank you for purchasing JH8000F/JH9500F/JH12000F/JH13000F electric winch from us. Please read and understand this winch manual instruction before installing and using your winch.

General Description

Each winch is equipped with a series wound motor and is designed for intermittent duty general use. Please be noted your winch are not designing to be used in industrial or hoisting applications, winch manufacturer goes not warrant it to be suitable for such usage. Free spool clutch is operated by a sliding ring gear winch disengages the gear box to allow the steel cable be pulled out without using electric power. Two pieces of suspension bars could reduce backlash and snarling when pulling out the wire rope.

SAFETY PRECAUTIONS

Warning! Observe safety precautions for personal safety and the safety of others. Improper equipment operation may cause personal injury and equipment damage.

Read the following carefully before attempting to operate your winch and keep the instructions for future reference.

Dress Properly:

1. Don't wear loose clothing or jewellery. They can be caught in moving parts. Wear leather gloves when handling winch cable. Do not handle cable with bare hands as broken wires can cause injuries. Non-skid footwear is recommended. Protective hair covering to contain long hair.

Keep a Safe Distance:

2. Ensure that all persons stand well clear of winch cable and load during winch operation, 1.5 times the cable length recommended. If a cable pulls loose or breaks under load it can lash back and cause serious personal injury or death. Don't step over the cable. All visitors and onlookers should be kept away from the work area. Keep proper footing and balance at all times.

Don't Abuse the Cord:

3. Never carry your winch by the cord or yank it to disconnect it from the receptacle. Keep cord from heat, oil and sharp edges.

Don't Overwork the Winch:

4. If the motor becomes uncomfortably hot to touch, stop and let it cool down for a few minutes. Don't maintain power to the winch if the motor stalls. Don't exceed maximum line pull ratings shown in tables. Shock loads must exceed these ratings.

Avoid Unintentional Starting:

5. Winch clutch should be disengaged when not in use and fully engaged when in usage.

Check Damaged Parts:

6. Before using the winch, you should check your winch and its spare parts carefully. Any part that is damaged should be properly repaired or replaced by an authorized service center.

Repair Your Winch:

When repairing, using only identical replacement parts or it may cause considerable danger for the user.

Re-spool the Cable

Leather gloves must be worn while re-spooling. To re-spool correctly, it is necessary to keep a slight load on the cable. Hold the cable with one hand and the remote control switch with the other. Start as far back and in the centre as you can. Walk up keeping load on the cable as the winch is powered in. Do not allow the cable to loop through your hand and do not approach the winch too closely. Turn off the winch and repeat the procedure until all the cable except 1 m is in. Disconnect the remote control switch and finish spooling in cable by rotating the drum by hand with clutch disengaged. On hidden winches, spool in cable under power but keep hands clear. Warning: The use of any other accessory or attachment other than those recommended in the instruction manual may present a risk of personal injury.

WINCH OPERATION WARNINGS

Read the following carefully before attempting to operate your winch and keep the instructions for future reference. The uneven spooling of cable, while pulling a load, is not a problem, unless there is a cable pile up on the end of the drum. If this happens reverse the winch to relieve the load and move your anchor point further to the centre to the centre of the vehicle. After the job is done you can un-spool and rewind for a neat lay of the cable. Store the remote control switch inside your vehicle where it will not become damaged, inspect it before you plug it in. When ready to begin spooling in, plug in remote control switch with clutch disengaged, do not engage clutch with motor running. Never connect the hook back to the cable. This causes cable damage. Always use a sling or chain of suitable strength. Observe your winch while winching, if possible while standing at a safe distance. Stop the winching process every meter or so to assure the cable is not pulling up in one corner. Jamming the cable can break your winch. Do not attach tow hooks to winch mounting apparatus. They must be attached to vehicle frame. The usage of a snatch block will aid recovery operations by providing a doubling of the winch capacity and a halving of the winching speed, and the means to, maintain a direct line pull to the centre of rollers. When double loading during stationary winching, the winch hook should be attached to the chassis of the vehicle. Ensure rated "D" or bow shackles are used in conjunction with an approved tree trunk protector to provide a safe anchor point. When extending winch cable, ensure that at least five wraps of cable remain on drum at all times. Failure to do this could result in the cable parting from the drum under load. Serious personal injury or property damage may result. All winches are provided with a red cable marking to identify that 5 cable wraps remain on the winch drum when this mark

For further information please contact the nearest winch distributor.

Winch Exploded Drawing and Pat List

| Part # | Description | Qty |
|--------|-------------------------------------|-----|
| 1 | Tandem motor | 1 |
| 2 | Screws with six angles inside m8*25 | 4 |
| 3 | Winch bearing | 2 |
| 4 | Brake equipment | 1 |
| 5 | Fixed connected pole | 2 |
| 6 | Electrical control box | 1 |
| 7 | Winch | 1 |
| 8 | Screws with six angles inside m4*15 | 10 |
| 9 | Gear box | 1 |
| 10 | Planet gear 1 general equipment | 1 |
| 11 | Planet gear 2 general equipment | 1 |
| 12 | Planet gear 3 general equipment | 1 |

| Part # | Description | Qty |
|--------|---------------------------------------|-----|
| 13 | Connected gear 4 | 1 |
| 14 | Inside gear | 1 |
| 15 | Packing of gear box | 1 |
| 16 | Handle equipment | 1 |
| 17 | Oiled bearing | 1 |
| 18 | Steel cap | 1 |
| 19 | Flat behind the gear box | 1 |
| 20 | Screws with six angles inside m4*30 | 10 |
| 21 | Block-rope stent of general equipment | 1 |
| 22 | Sheep hook | 1 |
| 23 | Switch equipment | 1 |
| 24 | Power line | 1 |

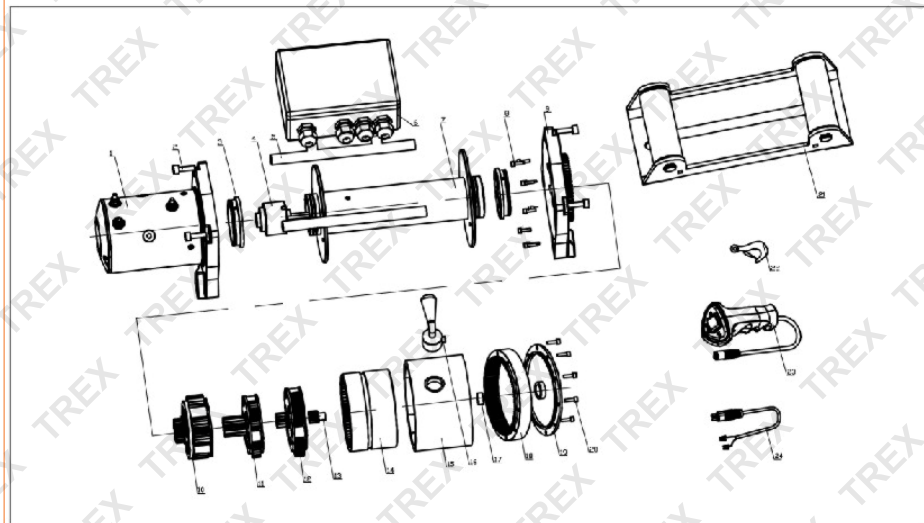

For further information please contact the nearest winch distributor.

appears at the rollers. No recovery should be attempted beyond this marking. Since the greatest pulling power is achieved on the innermost layer of your winch, it is desirable to pull off as much line as you can for heavy pulls (you must leave at least 5 wraps minimum on the drum-red cable). If this is not practical use a snatch block and double line arrangement. Draping a heavy blanket or similar object over the extended winch cable is recommended as it will dampen any back lash should a failure occur. Neat, tight spooling avoids cable binding, which is caused when a load is applied and the cable is pinched between the others. If this happens, alternatively power the winch in and out. Do not attempt to work bound cable under load, free by hand. Apply blocks to wheels when vehicles are on incline. Battery: Be sure that the battery is in good condition. Avoid contact with battery acid or other contaminants. Always wear eye protection when around a battery. Have the engines running when using the winch, to avoid flattening the battery. Winch Cable: Be sure that the cable is in good condition and is attached properly. Do not use the winch if cable is frayed. Do not move the vehicle to pull a load. Do not replace the cable with a cable of lesser strength. The life of the cable is directly related to the usage and care it receives. Following its first and subsequent uses, a cable must be wound on to the drum under a load of at least 500lbs/226kgs or the wraps will draw into the inner wraps and severely damage the cable during winching. The first winch use should be a familiarization runs while in a relaxed, non-recovery situation. Spool out the cable until the red cable mark appears about five wraps on the drum, then rewind the cable on to the drum under a load of 500lbs/226kgs or more. This will slightly tension and stretch the new cable and create a tight cable wrap around the drum. Failure to do so may result in cable damage and reduced cable life. When the cable is replaced, be sure to apply locktite, or an equal compound, to the cable clamp thread. Tighten the clamp screw properly but do not over tighten. The locktite will prevent loosening of the screw in arduous conditions. Loctite 7471 primer and 222 thread locker are recommended. Do not attempt to exceed the pulling limits of this winch. Do not drive your vehicle to assist the winch in any way. Vehicle movement in combination with winch operation may overload the cable, the winch itself will cause damaging shock loads. Shock loads while winching is dangerous! A shock load occurs when an increased force is suddenly applied to the cable. A vehicle rolling back on a slack cable may induce a damaging shock load. The winches shown in this manual are solely for vehicle and boat mounted, non-industrial applications. Do not use winch in hoisting applications due to required hoist safety factors and features. Do not use the winch to lift, support and transport personnel. Note: When the steel cable turns to be rusty, we hereby suggest you stop using that. When one of the steel cable is broken, we also advise you quit this steel cable.

WINCH INSTALLATION

MOUNTING YOUR WINCH

How to Mount Electric Winch on Your Vehicles?

- The winch is to be mounted into a suitable steel mounting frame using the 4 point foot mounting system in either a horizontal or vertical plane.
- It's very important that the winch shall be mounted on a flat surface so that the three sections (motor, drum and gear housing) are properly aligned.
- Before commencing installation, you should ensure the mounting facility being used is capable of withstanding the winches rated capacity. The fitment of winches and a frontal protection system may affect the triggering of SRS air bags. Check that the mounting system has been tested and approved for winch fitment in airbag equipped vehicle. Winch mounting frames and frontal protection systems are suggested to suit most popular vehicles. Winch frames are packaged with detailed fitting instructions. Should you wish to manufacture your own mounting plate the dimensions below will assist. A steel mount plate 6mm thick is recommended. Fasteners should be steel high tensile grade 5 or better. A poorly designed mount may void warranty. The winch should be secured to the mounting with 3/8" UNC X 1-14" stainless steel bolts and spring washers provided. The roller fairlead is to be mounted so as to guide the rope onto the drum evenly.

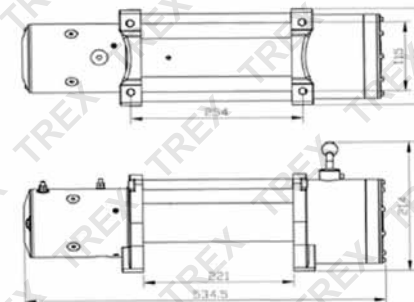

For further information please contact the nearest winch distributor.



CABLE INSTALLATION

ELECTRICAL CONNECTION

Pay close attention to proper electrical cable connection as follows (refer to diagram 1) Short red cable (B') connecting to the red terminal (B) of the motor. Short black cable with yellow jacket (C') connecting to the yellow terminal (C) of the motor. Short black cable with yellow jacket (D') connecting to the black terminal (D) of the motor. Thin black cable (A') connecting to bottom terminal (A) of the motor. Long black cable (1.8m), one terminal (A') connecting to the bottom terminal (A) of the motor, and the other terminal negative (-) connecting to negative (-) terminal of battery. Long red cable positive (+) to positive (+) terminal of battery.



SUGGESTION:

The best way to get acquainted with how your winch operates is to make a few test runs before you actually need to use it. Plan your test in advance. Remember you can hear your winch as well as you can see it operate. Get to recognize the sound of light steady pull, a heavy pull, and sounds caused by load jerking or shifting. Soon you will gain confidence in operating your winch and its use will become second nature to you.

For further information please contact the nearest winch distributor.



| | |
|---------------------------|-----------------------|
| Performance Voltage | DC 12V / 24V |
| Rated Pull (Single Line) | 13000 lbs(5 898kgs) |
| Motor | 3.5KW, Series Wound |
| Gear Reduction Ratio | 202:1 |
| Gear Train | 3 Stage Planetary |
| Remote Control Cable | 3m |
| Clutch | Sliding Ring Gear |
| Breaking Action | Automatic In-The Drum |
| Drum Size | Ø 64mm*222.5mm |
| Steel Wire Rope | Ø 8.8mm*24m |
| Fairlead | 4-way Roller Fairlead |
| Battery Leads | 1.8m |
| Overall dimensions | 560*160*218mm |
| Wireless Remote Control | Optional |
| N.W / G.W | 38/40kgs(1PCS) |
| Shipping Carton Size | 61*35*27cm(1CTN) |

JH13000F

| | | | | | | |
|---------------|------------|-------------|--------------|--------------|---------------|---------------|
| Line Pull | LBS KGS | NO. LADE | 6000 2722 | 8000 3629 | 10000 4532 | 13000 5898 |
| Line Speed | FT/MIN | 25.5 | 8.8 | 7 | 5.9 | 4.2 |
| | M/MIN | 7.75 | 2.7 | 2.15 | 1.8 | 1.2 |
| Motor Current | AMP | 70 | 285 | 365 | 435 | 380 |

JH13000F

| Layer of Cable | | 1 | 2 | 3 | 4 |
|---------------------------|-------|-------|------|------|------|
| Rated Line Pull per Layer | 13000 | 13000 | 7964 | 6591 | 5632 |
| | 5898 | 5898 | 3601 | 2987 | 2552 |
| Cumulative Cable Capacity | 16 | 16 | 42 | 72 | 94 |
| | 5 | 5 | 12 | 21 | 28 |

For further information please contact the nearest winch distributor.



JH12000F

| | |
|---------------------------|---------------------------|
| Performance Voltage | DC 12V / 24V |
| Rated Pull (Single Line) | JH12000F (5444kgs) |
| Motor | 4.5KW, Series Wound |
| Gear Reduction Ratio | 265:1 |
| Gear Train | 3 Stage Planetary |
| Remote Control Cable | 3m |
| Clutch | Sliding Ring Gear |
| Breaking Action | Automatic In-The Drum |
| Drum Size | Ø 64mm*222.5mm |
| Steel Wire Rope | Ø 9.5mm*24m |
| Fairlead | 4-way Roller Fairlead |
| Battery Leads | 1.8m |
| Overall dimensions | 560*160*218mm |
| Wireless Remote Control | Optional |
| N.W / G.W | 40/42kgs(1PCS) |
| Shipping Carton Size | 61*35*27cm(1CTN) |

JH12000F

| | | | | | | |
|---------------|--------|------|------|------|-------|-------|
| Line Pull | LBS | NO. | 6000 | 8000 | 10000 | 12000 |
| | KGS | LADE | 2722 | 3629 | 4532 | 5440 |
| Line Speed | FT/MIN | 21.3 | 7.9 | 6.5 | 5.8 | 4.4 |
| | M/MIN | 6.5 | 2.4 | 2 | 1.75 | 1.35 |
| Motor Current | AMP | 65 | 230 | 280 | 355 | 400 |

JH12000F

| Layer of Cable | | 1 | 2 | 3 | 4 |
|---------------------------|-----|-------|------|------|------|
| Rated Line Pull per Layer | LBS | 12000 | 9210 | 8030 | 6894 |
| | KGS | 5440 | 4170 | 3640 | 3125 |
| Cumulative Cable Capacity | LBS | 17 | 41 | 71 | 82 |
| | AMP | 4.8 | 12 | 21 | 25 |

For further information please contact the nearest winch distributor.



OPERATING:

Ensure the vehicle is secure by applying the parking brake or chocking the wheels. Pull out the inch cable the desired length and connect to an anchor point. The winch clutch allows rapid uncoiling of the cable for hooking into the load or anchor point. The shifter tab located on the gear housing of the winch operates the clutch as follows:

- To disengage the clutch, move the clutch shifter tab to the "OUT" position. Cable may not be free spooled off the drum.
- To engage the clutch, move the clutch shifter tab into the "IN" position. The winch is now ready for pulling. Recheck all cable rigging before proceeding. Plug in the winch hand control. It is recommended that the winching operation takes place from the driver's position to ensure safe operation. To commence winching operation, start vehicle engine, select neutral in transmission, maintain engine speed at idle. Operate the remote control switch to IN or OUT until the vehicle has been retrieved. Regularly check the winch to ensure cable is winding onto the drum evenly.

Note:

Never winch with your vehicle in gear or in park, which would damage your vehicle's transmission. Never wrap the cable around the object and hook onto the cable itself. This can cause damage to the object being pulled, and kink or fray the cable. Keep hands, clothing, hair and jewellery clear of the drum area and cable when winching. Never use the winch if the cable frayed, kinked or damaged. Never allow anyone to stand near the cable, or in line with the cable behind the winch while it is under power. If the cable should slip or brake, it can suddenly whip back towards the winch, causing a hazard for anyone in the area. Always stand well to the side while winching. Don't leave the switch plugged in when winch is not in usage. Check the winch carefully and thoroughly before operating.

MAINTENANCE

It is highly recommended that the winch be used regularly (once a month). Simply power the cable out 15m, free spool 5m and then power back in. This will keep all components in good working condition so that the winch can be relied on when needed. Contact your authorized outlet for technical assistance and repairs.

SPARE PARTS:

A comprehensive range of spare parts is available. Please kindly contact the distributor on the end cover or the local retailer.

WINCH CAPACITY

This winch has capacity of 8000lbs/9500lbs/10000lbs/12000lbs. Pulling capacity is reduced as the incline increases. Recommended safe loads for various inclines are listed in the table below:

| Rated Line Pull | 10% | 20% | 40% | 60% | 80% | 100% |
|-----------------|-------|-------|-------|-------|-------|-------|
| JH5000E | 17588 | 11905 | 7543 | 5824 | 4979 | 4499 |
| JH6000E | 30151 | 20408 | 12931 | 9983 | 8535 | 7712 |
| JH8000F | 42670 | 28900 | 18275 | 14110 | 12070 | 10880 |
| JH9500F | 47690 | 32300 | 20425 | 15770 | 13490 | 12160 |
| JH10000F | 47739 | 32313 | 20474 | 15833 | 13515 | 12211 |
| JH12000F | 60240 | 40800 | 25800 | 19920 | 17040 | 15360 |

Note:

- This guide is recommended for average vehicle rolling loads. Some applications may require a larger winch than indicated.
- The weight of winch could pull perpendicular to the ground with a single on the first layer of cable on the drum
- A 10% grade is a rise of one meter in ten meter.
- Winch is not intended as a load securing device.

NOTE: THE SAFETY PRECAUTIONS AND INSTRUCTIONS DISCUSSED IN THIS MANUAL CAN'T COVER ALL POSSIBLE CONDITIONS AND SITUATIONS THAT MAY OCCUR. IT MUST BE UNDERSTOOD BY THE OPERATOR THAT COMMON SENSE AND CAUTION ARE FACTORS, WHICH CANNOT BE BUILT INTO THIS PRODUCT, BUT MUST BE APPLIED BY THE OPERATOR.

For further information please contact the nearest winch distributor.

JH8000F

| | |
|---------------------------|-----------------------|
| Performance Voltage | DC 12V / 24V |
| Rated Pull (Single Line) | 8000lbs(3629kgs) |
| Motor | 2.8KW, Series Wound |
| Gear Reduction Ratio | 265:1 |
| Gear Train | 3 Stage Planetary |
| Remote Control Cable | 3m |
| Clutch | Sliding Ring Gear |
| Breaking Action | Automatic In-The Drum |
| Drum Size | Ø 64mm*222.5mm |
| Steel Wire Rope | Ø 8.3mm*26m |
| Fairlead | 4-way Roller Fairlead |
| Battery Leads | 1.8m |
| Overall dimensions | 560*160*218mm |
| Wireless Remote Control | Optional |
| N.W / G.W | 36/38kgs(1PCS) |
| Shipping Carton Size | 61*35*27cm(1CTN) |

JH8000F

| Line Pull | LBS | NO. | 2000 | 4000 | 6000 | 8000 |
|---------------|--------|------|------|------|------|------|
| | KGS | LADE | 907 | 1814 | 2722 | 3629 |
| Line Speed | FT/MIN | 28.2 | 15.4 | 11.5 | 9.2 | 7.7 |
| | M/MIN | 8.6 | 4.7 | 3.5 | 2.8 | 2.35 |
| Motor Current | AMP | 70 | 160 | 240 | 310 | 390 |

JH8000F

| Layer of Cable | | 1 | 2 | 3 | 4 |
|---------------------------|-----|------|------|------|------|
| | LBS | 8000 | 6900 | 5845 | 5100 |
| Rated Line Pull per Layer | KGS | 3629 | 3130 | 2650 | 2310 |
| | LBS | 16 | 42 | 72 | 94 |
| Cumulative Cable Capacity | AMP | 5 | 12 | 21 | 28 |

For further information please contact the nearest winch distributor.

JH9500F

| | |
|---------------------------|-----------------------|
| Performance Voltage | DC 12V / 24V |
| Rated Pull (Single Line) | 9500lbs(4310kgs) |
| Motor | 3.2KW, Series Wound |
| Gear Reduction Ratio | 265:1 |
| Gear Train | 3 Stage Planetary |
| Remote Control Cable | 3m |
| Clutch | Sliding Ring Gear |
| Breaking Action | Automatic In-The Drum |
| Drum Size | Ø 64mm*222.5mm |
| Steel Wire Rope | Ø 8.3mm*26m |
| Fairlead | 4-way Roller Fairlead |
| Battery Leads | 1.8m |
| Overall dimensions | 560*160*218mm |
| Wireless Remote Control | Optional |
| N.W / G.W | 37/39kgs(1PCS) |
| Shipping Carton Size | 61*35*27cm(1CTN) |

JH9500F

| Line Pull | LBS | NO. | 4000 | 6000 | 8000 | 9500 |
|---------------|--------|------|------|------|------|------|
| | KGS | LADE | 1814 | 2722 | 3629 | 4300 |
| Line Speed | FT/MIN | 27 | 11.7 | 9.36 | 7.7 | 7 |
| | M/MIN | 7.5 | 3.25 | 2.6 | 2.15 | 1.95 |
| Motor Current | AMP | 70 | 210 | 280 | 350 | 415 |

JH9500F

| Layer of Cable | | 1 | 2 | 3 | 4 |
|---------------------------|-----|------|------|------|------|
| Rated Line Pull per Layer | LBS | 9500 | 7700 | 6500 | 5700 |
| | KGS | 4300 | 3480 | 2940 | 2580 |
| Cumulative Cable Capacity | LBS | 16 | 42 | 72 | 94 |
| | AMP | 5 | 12 | 21 | 28 |

For further information please contact the nearest winch distributor.



Some experts believe the incorrect or prolonged use of almost any product could cause serious injury or death. For information that may reduce your risk of serious injury or death consult the points below and additionally, the information available at www.datastreamserver.com/safety

- Consult all documentation, packaging and product labelling before use. Note that some products feature online documentation which should be printed and kept with the product.
- Check product for loose / broken / damaged / missing parts, wear or leaks (if applicable) before each use. Never use a product with loose / broken / damaged / missing parts, wear or leaks (if applicable).
- Products must be inspected and serviced (if applicable) by a qualified specialist every 6 months assuming average residential use by a person of average weight and strength, above average technical aptitude, on a property matching average metropolitan specification. Intended use outside these guidelines could indicate the product is not suitable for intended use or may require more regular inspection or servicing.
- Ensure all possible users of the product have completed an industry recognised training course before being given access to the product.

- The product has been supplied by a general merchandise retailer that may not be familiar with your specific application or your description of the application. Be sure to attain third party approval for your application from a qualified specialist before use regardless of prior assurances by the retailer or its representatives.
- This product is not intended for use where fail-safe operation is required. As with any product (take an automobile, aircraft, computer or ball point pen for example) there is always a small chance of a technical issue that needs to be repaired or may require replacement of the product or a part. If the possibility of such failure and the associated time it takes to rectify could in any situation inconvenience the user, business or employee or could financially affect the user, business or employee then the product is not suitable for your requirements. This product is not for use where incorrect operation or a failure of any kind, including but not limited to a condition requiring product return, replacement, service by a technician or replacement of parts could cause a financial loss, loss of employee time or an inconvenience requiring compensation.
- If this item has been purchased in error considering the points above simply contact the retailer directly for details of their returns policies if required.