



# Electric Car Polisher - A180

## User Manual

[Revision 1.0 March 2017]



---

READ THIS MANUAL CAREFULLY BEFORE USE – FAILURE TO DO SO MAY RESULT IN INJURY, PROPERTY DAMAGE AND MAY VOID WARRANTY. • KEEP THIS MANUAL FOR FUTURE REFERENCE. • Products covered by this manual may vary in appearance, assembly, inclusions, specifications, description and packaging.

---

# Safety

Safety messages are designed to alert you to possible dangers or hazards that could cause death, injury or equipment or property damage if not understood or followed. Safety messages have the following symbols:

 <p>You <b>WILL</b> be <b>KILLED</b> or <b>SERIOUSLY INJURED</b> if you do not follow instructions.</p>	 <p>You <b>CAN</b> be <b>KILLED</b> or <b>SERIOUSLY INJURED</b> if you do not follow instructions.</p>	 <p>You <b>CAN</b> be <b>INJURED</b> if you do not follow instructions or equipment damage may occur.</p>
--	---	--

It is important that you read and understand the instruction manual before use and keep the manual in a safe place for future reference. Safety information presented here is generic in nature – some advice may not be applicable to every piece of equipment.

All safety precautions must be observed to reduce the risk of personal injury when operating the equipment.

The term “equipment” refers to your product, be it electrical mains, battery or petrol engine powered.

**IMPORTANT** – Handle the equipment safely and carefully.

**BEFORE USE** - If you are not familiar with the safe operation/handling of this equipment, or are in any way unsure of any aspect of suitability or correct use it for your application, you should complete training conducted by a person or organization qualified in safe use and operation of this equipment, including fuel/electrical handling and safety.

## WARNINGS

- Read all safety warnings and all instructions. Failure to follow warnings and instructions may result in electric shock, fire and/or serious injury.
- Never run a combustion engine in confined areas.
- Do not operate the equipment in flammable or explosive environments, such as in the presence of flammable liquids, gases or dust. Engine and equipment may create sparks or heat that may ignite vapours, dust etc.
- Keep clear of moving parts.
- This equipment may be a potential source of electric shock if misused.
- Do not operate the equipment if it is damaged, malfunctioning or is in an excessively worn state.
- Do not allow others to use the equipment unless they have read this manual and are adequately trained.
- When using the equipment, basic safety precautions detailed here must always be followed to reduce the risk of fire, electric shock, personal injury and material damage.
- When wiring electrically powered equipment, follow all electrical and safety codes.
- Ensure all power sources conform to equipment voltage requirements and are disconnected before connecting equipment.

## General Work Area Safety

Work areas should be clean and well lit.

Do not operate the equipment if bystanders, animals etc. are within operating range of the equipment or the general work area.

## Personal Safety

Keep packaging away from children - risk of suffocation! Operators must use the equipment correctly. When using the equipment, consider conditions and pay due care to persons and property.

Prevent unintentional starting of the equipment - ensure equipment and power source switches are in the OFF position before connecting or moving the equipment. Do not carry equipment with hands/fingers touching any controls. Remove any tools or other items that are not a part of the equipment from it before starting or switching on.

Stay alert and use common sense when operating equipment. Do not overreach. Keep proper footing and balance at all times. Do not use equipment when tired or under the influence of drugs, alcohol or medication. This equipment is not intended for use by persons with reduced physical, sensory or mental capabilities.

You must wear appropriate protective equipment when operating, servicing, or when in the operating area of the equipment to help protect from serious injury, including eye injury, inhalation of toxic fumes, burns, and hearing loss. Always wear eye protection. Protective equipment such as respirators, non-skid safety shoes, hard hat, hearing protection etc. should be used for appropriate conditions. Other people nearby should also wear appropriate personal protective equipment. Do not wear loose clothing or jewellery, which can be caught in moving parts. Keep hair and clothing away from the equipment.

If devices are provided for the connection of dust extraction and collection facilities, ensure these are connected and properly used. Use of dust collection can reduce dust-related hazards.

## General Equipment Use and Care

Do not force the equipment. Use the correct equipment for your application. The correct equipment will perform better and be safer within its design parameters. Do not use the equipment if the ON/OFF switch malfunctions – any equipment that cannot be controlled with the ON/OFF switch is dangerous and must be repaired.

Use the equipment and accessories etc. in accordance with these instructions, taking into account working conditions and the work to be performed. Using the equipment for operations different from those intended could result in hazardous situations.

Before use, inspect the equipment for misalignment or binding of moving parts, loose components, damage or any other condition that may affect its operation. If damaged, have the equipment repaired by an authorized service centre or technician before use.

Always keep the equipment and accessories (cutting tools, nozzles, bits etc) properly maintained. Keep the equipment, controls and handles dry and free from dirt, oil and grease.

Store the equipment out of reach of children or untrained persons. To avoid burns or fire hazards, let the equipment cool completely before transporting or storing. Never place the equipment in places where there are flammable materials, combustible gases or combustible liquids etc.

The equipment is not weatherproof, and should not be stored in direct sunlight, at high ambient temperatures or locations that are damp or very humid.

## Product Use and Care

### WARNINGS

- Before using the tool, inspect the polishing disc for any damage. Do not use the disc if it is cracked, ripped or damaged.
- During use, always hold the tool firmly with both hands.
- Keep the tool away from moving and rotating parts.
- Ensure that the tool is not in contact with the work piece before switching on.
- Do not leave the tool unattended while it is running.
- Do not touch the work piece immediately after operation to reduce the risk of burns.
- When using an extension cord, ensure that it is double-insulated and suitable for this tool.



# Table of Contents

**Safety** ..... 2

**Parts Identification** ..... 4

**Assembly** ..... 5

**Operation** ..... 6

**Maintenance** ..... 7

    Polishing Disc and Pads ..... 7

    Motor Brushes ..... 7

**Specifications** ..... 8

## Parts Identification



No.	Description
1	Polisher
2	Handle
3	Polishing Disc
4	Polishing Pad
5	Case

No.	Description
6	Fasteners / Tools: 2 M10x20 Screw 2 Motor Brush (spare – for technician use) 8mm Allen Key



# Assembly

1. Slide the handle (A) over the front of the tool – it can be positioned to the left or right – install it in the position most comfortable for you. Ensure the plastic tabs (B) engage with the corresponding slots in the tool body – it may be necessary to pull up one side of the handle slightly in order to get the tab into the slot.
2. Use the 2 M10x20 (C) screws to secure the handle. Tighten (rotate right) the screws firmly using the supplied Allen key.

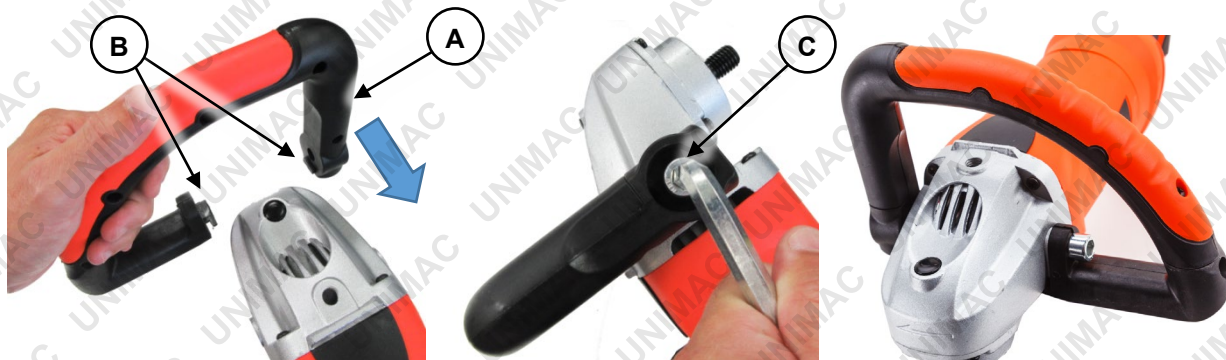

3. Attach the polishing disc (D) to the tool spindle (E) and tighten (rotate right) firmly by hand. To prevent the spindle from turning, press and hold the spindle lock button (F) when tightening the disc.

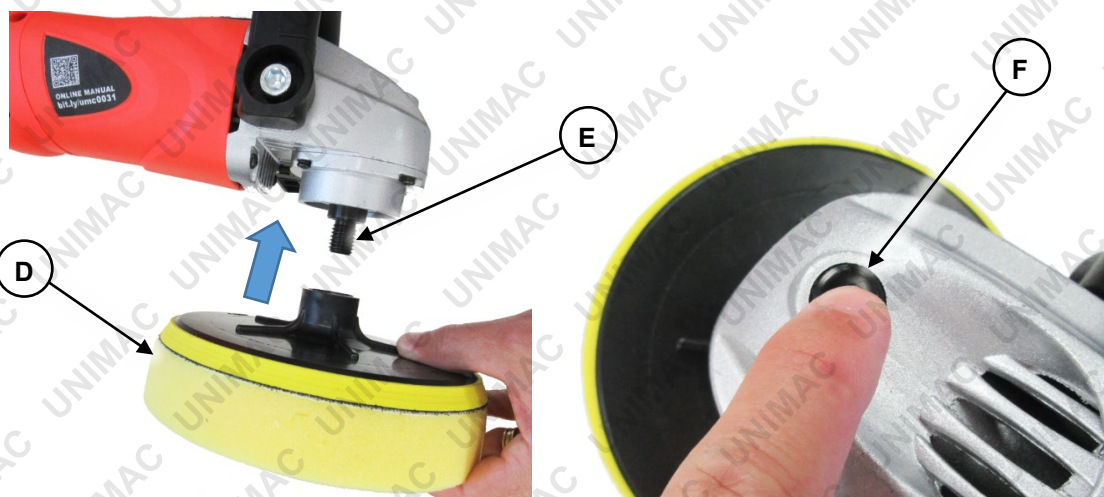

4. Pull the polishing pad (G) evenly over the polishing disc and secure it by pulling the draw-string (H) until tight, then knot it. It is recommended to tuck the knot / loose draw-string under the edge of the pad.



# Operation



Before using the tool, inspect the polishing disc for any damage. Do not use the disc if it is cracked, ripped or damaged. • During use, always hold the tool firmly with both hands. • Keep the tool away from moving and rotating parts. • Ensure that the tool is not in contact with the work piece before switching on. • Do not leave the tool unattended while it is running. • Do not touch the work piece immediately after operation to reduce the risk of burns.

1. To activate the tool, press the safety button (A), then squeeze the ON / OFF trigger (B). Once the tool is running, it is no longer necessary to press the safety button, however, the trigger must remain squeezed to keep the tool running.
2. Rotate the speed control dial (C) as required to set the spindle speed (range = 1000 ("1") to 3000 ("6") RPM).

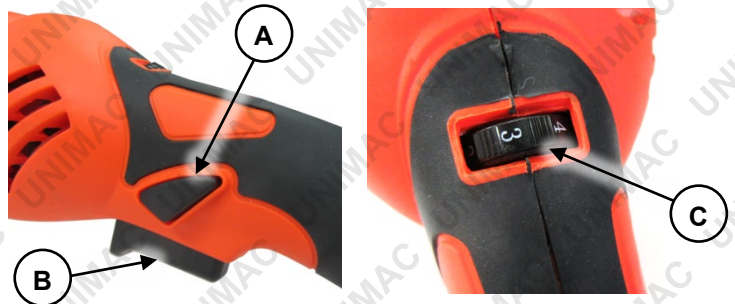

For best results, use the correct type of polishing compound and follow the manufacturer's directions for use. Do not apply undue pressure when polishing and keep the tool moving over the work-piece in smooth, circular motions.

## Motor Brush Status

The tool is equipped with a "brush status indicator". When the indicator illuminates green, the motor brushes are functional. If the indicator illuminates red, the [motor brushes will require replacing](#). If the tool is used with worn motor brushes, the power may be reduced, operation is erratic or the tool may not run at all.





# Maintenance



Always disconnect mains electrical power from the tool before performing any maintenance activities. • Do not have the tool running during inspection and maintenance. • The tool should be cool enough to touch before performing maintenance activities. • Some maintenance activities described may be beyond the scope of some users. For procedures that you are not comfortable with or have the tools or experience for, have the unit serviced by a service centre or qualified technician.

## Polishing Disc and Pads

Ensure that the polishing disc and pads are in good condition before using them. If any parts become damaged or worn, replace them. Clean the disc and pad after use and store them so they do not become contaminated with dirt etc.

## Motor Brushes

The electric motor uses 2 carbon "brushes" in order to function. The brushes wear as a result of use – this is normal, and some tools may come with replacement brushes. If the brushes are allowed to wear past the acceptable limit, the motor may produce less power, operate intermittently, or not operate at all. Always replace both brushes at the same time. To replace the motor brushes:

1. Remove the 6 screws (rotate left) securing the two sides of the tool handle, then carefully pull the handle pieces apart. The motor brushes (A) are located on either side of the tool, near the main body.
2. Disconnect the brush wire (B) from its connector.
3. Move the end of the brush spring (C) so it rests on the edge of the brush holder, then pull the brush (A) out. If the end of the spring drops into the holder you will need to pull it up and out using a suitable tool in order to install the new brush.
4. Slide the new brush down into the holder and secure it by resting the end of the brush spring on top of it.
5. Connect the brush wire to the connector.

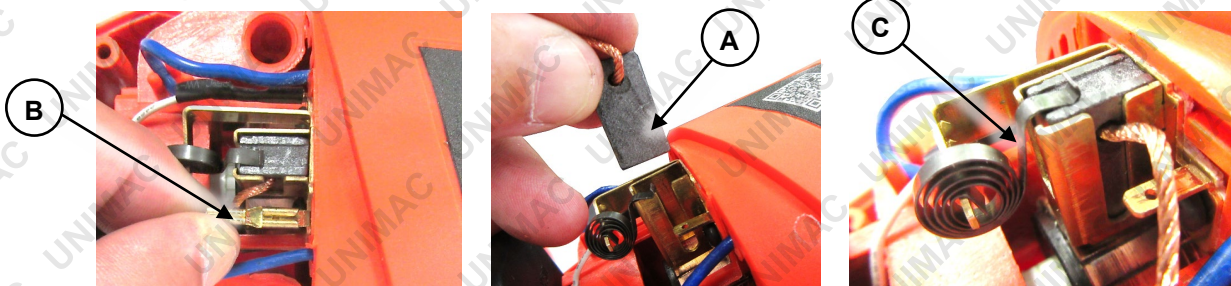

6. Carefully bring the two sides of the handle together, ensuring no wires or components are caught between the two sections and that all internal parts are in their original positions.
7. Secure the handle pieces together using the 6 screws.

# Specifications

<b>Electrical Requirements</b>	240VAC / 50Hz
<b>Spindle Speed</b>	1000 to 3000RPM
<b>Polisher Diameter</b>	180mm





**Some experts believe that the incorrect or prolonged use of almost any product may cause serious injury or death. To help reduce your risk of serious injury or death, refer to the information below. For more information, see [www.datastreamserver.com/safety](http://www.datastreamserver.com/safety)**

- |   |   |
|---|---|
| <ul style="list-style-type: none"> <li>▪ Consult all documentation, packaging and product labelling before use. Note that some products feature documentation available online. It is recommended to print and retain the documentation.</li> <li>▪ Before each use, check the product for loose/broken/damaged/missing parts, wear or leaks (if applicable). Never use a product with loose/broken/damaged/missing parts, wear or leaks.</li> <li>▪ Products must be inspected and serviced (if applicable) by a qualified technician every 6 months. This is based on average residential use by persons of average size and strength, and on a property of average metropolitan size. Use beyond these recommendations may require more frequent inspections/servicing.</li> <li>▪ Ensure that all users of the product have completed a suitable industry recognised training course before being allowed access to the product.</li> </ul> | <ul style="list-style-type: none"> <li>▪ The product has been supplied by a general merchandise retailer that may not be familiar with your specific application or description of application. Be sure to attain third-party approval from a qualified specialist for your application before use, regardless of any assurances from the retailer or its representatives.</li> <li>▪ This product is not intended for use where fail-safe operation is required. As with any product (for example, automobile, computer, toaster), there is the possibility of technical issues that may require the repair or replacement of parts, or the product itself. If the possibility of such failure and the associated time it may take to rectify could in any way inconvenience the user, business or employee, or financially affect the user, business or employee, then the product is not suitable for your requirements. This product is not intended for use where incorrect operation or a failure of any kind, including but not limited to, a condition requiring product return, replacement, parts replacement or service by a technician may cause financial loss, loss of employee time or an inconvenience requiring compensation.</li> <li>▪ If this product has been purchased in error when considering the information presented here, contact the retailer directly for details of their returns policy, if required.</li> </ul> |
|---|---|



©2017 Unimac. All rights reserved. No part of this document, including descriptive content, concepts, ideas, diagrams or images may be reproduced or transmitted in any form or by any means, electronic or mechanical, including photocopying, scanning or recording, or any information storage and retrieval system, without express permission or consent from the publisher.