



# Rolling Tool Box / Stool

## User Guide

[Revision 1.0 March 2017]

### Safety

Read and understand this user guide before using the equipment. Retain the user guide for future reference.

**Any damage or equipment failure due to incorrect usage is not covered by warranty.**

- Do not modify or use the tool for any other purpose than that it is designed for.
- Keep work areas clean, well lit and well ventilated.
- Do not operate the equipment if it is damaged, malfunctioning or is in an excessively worn state.
- This equipment must be used on flat, level and stable surfaces only. Do not use if it is unsteady.
- Stay alert and use common sense when operating equipment. Do not overreach. Keep proper footing and balance at all times. Do not use equipment when tired or under the influence of drugs, alcohol or medication. This equipment is not intended for use by persons with reduced physical, sensory or mental capabilities.
- Do not exceed the maximum weight capacities.
- This equipment is for domestic use only.



### Parts Identification

- 1 Stool Pad (1)
- 2 Frame (2)
- 3 Side Tray (2)
- 4 Castor / Side Tray Frame (2)
- 5 M6x10 Bolt (2)
- 6 Tool Shelf (1)
- 7 M6x30 Bolt (8)
- 8 Tube Cap (4)
- 9 Castor (4)
- 10 M8x40 Bolt (4)
- 11 M8 Acorn Nut (8)
- 12 M8 Washer (12)
- 13 Cabinet / Drawer Assembly (1)
- 14 Sleeve Nut (4)
- 15 M8x16 Bolt (4)
- 16 M8x35 Bolt (4)
- 17 Support bar (2)
- 18 Tray Strap (2)
- 19 M6x25 Bolt (4)

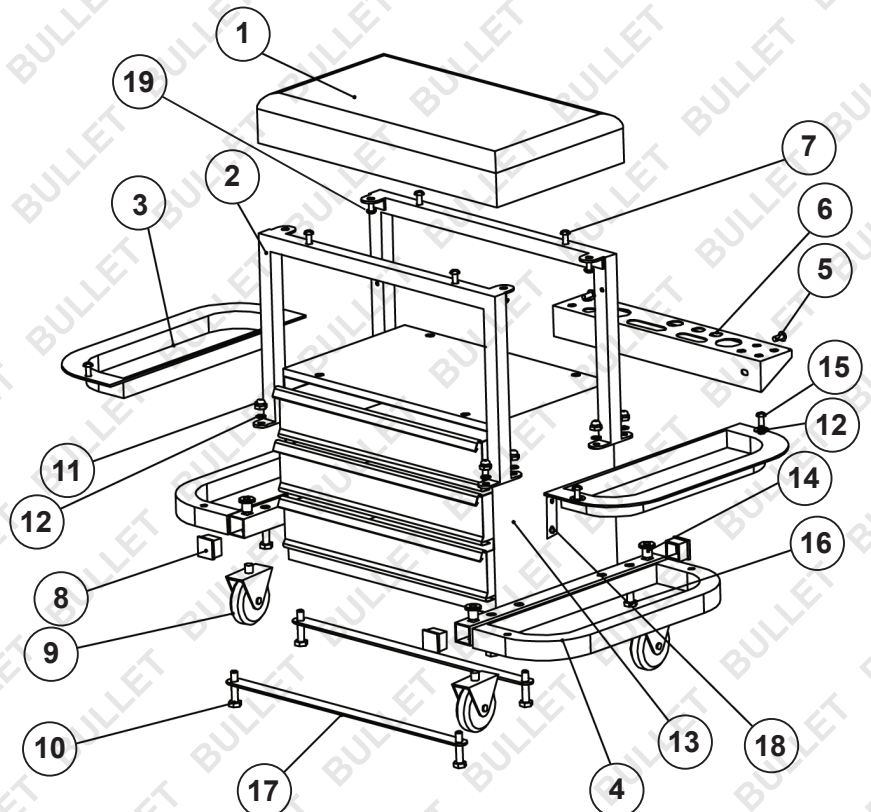

## Assembly

**Note:** Ensure that all parts are included and are in good condition before assembly. • Some parts may come pre-assembled. • Tools, not supplied, may be required for assembly.

1. Assemble the 4 castors (A) to the underside of the 2 castor / side tray frames (B), then secure with 4 sleeve nuts (C). Use an Allen key to tighten the nuts.

2. Assemble the 2 castor / side tray frame assemblies (D) and 2 support bars (E) to the cabinet / drawer assembly (F). Attach the parts by inserting M8x40 bolts (G) from the underside of the support bars, through the *inner* mounting holes of the castor / side tray frame assemblies, then through the *inner* mounting holes of the cabinet / drawer assembly. Secure the parts using M8 washers (H) and M8 acorn nuts (I). Use suitable spanners to tighten the fasteners.

3. Insert M8x35 bolts (J) from the underside of the castor side tray assemblies (D), *outer* mounting holes, then through the *outer* mounting holes of the cabinet / drawer assembly (F). Secure the parts using M8 washers (H) and M8 acorn nuts (I). Use suitable spanners to tighten the fasteners.

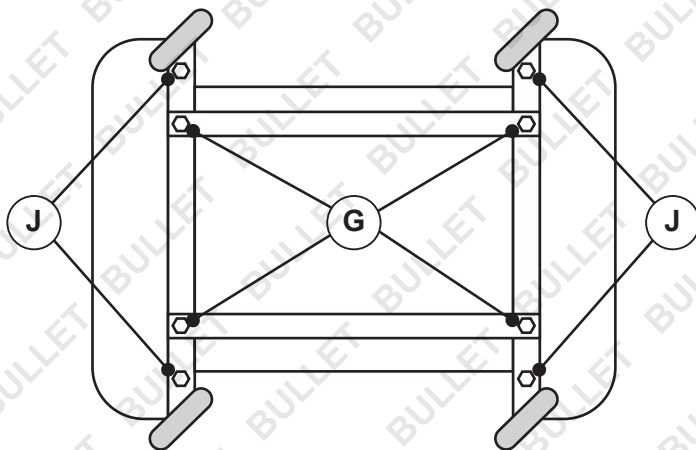

4. Assemble the tool shelf (K) to the rear of the cabinet using 2 M6x10 bolts (L). Use a suitable spanner to tighten the fasteners.

Assembly is complete and the product is ready for use. Be sure not to exceed the maximum rated weights. When not using the side trays, fold them up and secure them to the cabinet sides with the straps.

## Care and Maintenance

Periodically check that all fasteners are tight. • Clean using a soft cloth and suitable cleaner (do not use solvents or abrasives, particularly on the seat).

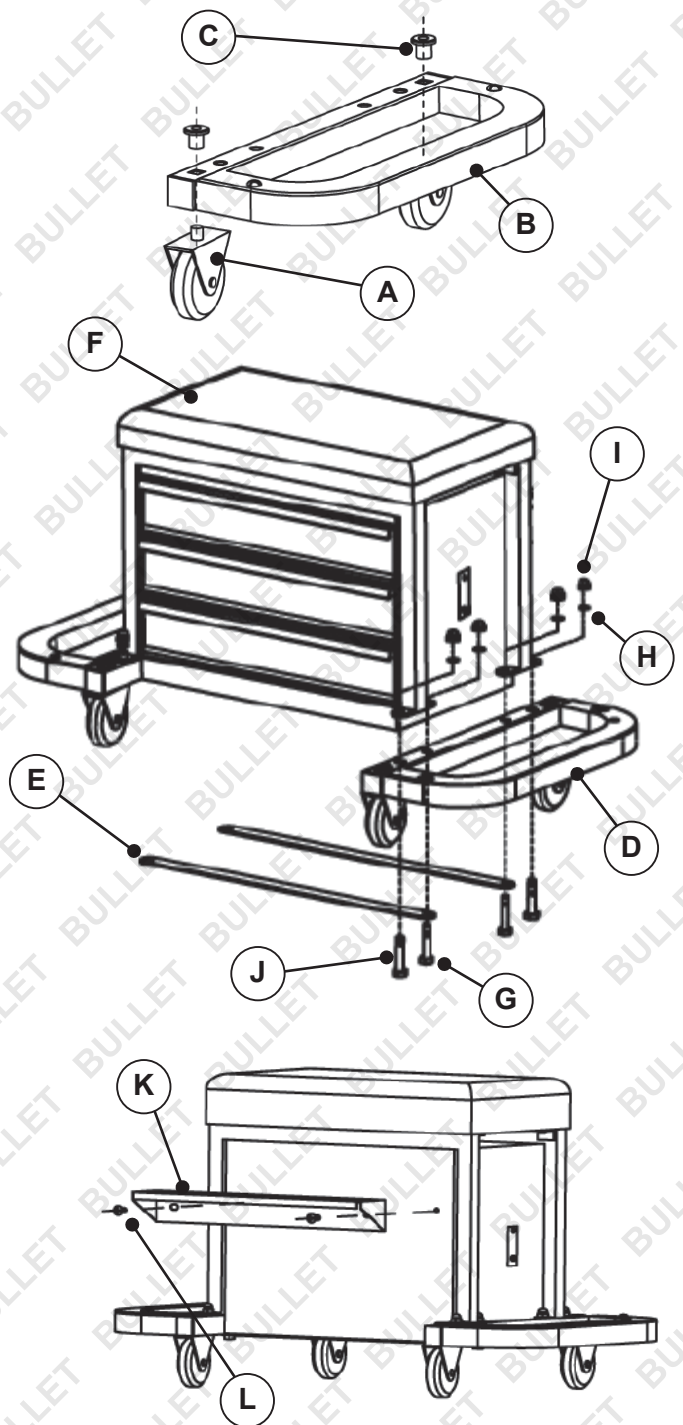



**Some experts believe that the incorrect or prolonged use of almost any product may cause serious injury or death. To help reduce your risk of serious injury or death, refer to the information below. For more information, see [www.datastreamserver.com/safety](http://www.datastreamserver.com/safety)**

- Consult all documentation, packaging and product labelling before use. Note that some products feature documentation available online. It is recommended to print and retain the documentation.
  - Before each use, check the product for loose/broken/damaged/missing parts, wear or leaks (if applicable). Never use a product with loose/broken/damaged/missing parts, wear or leaks.
  - Products must be inspected and serviced (if applicable) by a qualified technician every 6 months. This is based on average residential use by persons of average size and strength, and on a property of average metropolitan size. Use beyond these recommendations may require more frequent inspections/servicing.
  - Ensure that all users of the product have completed a suitable industry recognised training course before being allowed access to the product.
  - If this product has been purchased in error when considering the information presented here, contact the retailer directly for details of their returns policy, if required.
- The product has been supplied by a general merchandise retailer that may not be familiar with your specific application or description of application. Be sure to attain third-party approval from a qualified specialist for your application before use, regardless of any assurances from the retailer or its representatives.
  - This product is not intended for use where fail-safe operation is required. As with any product (for example, automobile, computer, toaster), there is the possibility of technical issues that may require the repair or replacement of parts, or the product itself. If the possibility of such failure and the associated time it may take to rectify could in any way inconvenience the user, business or employee, or financially affect the user, business or employee, then the product is not suitable for your requirements. This product is not intended for use where incorrect operation or a failure of any kind, including but not limited to, a condition requiring product return, replacement, parts replacement or service by a technician may cause financial loss, loss of employee time or an inconvenience requiring compensation.



©2018 Bullet. All rights reserved. No part of this document, including descriptive content, concepts, ideas, diagrams or images may be reproduced or transmitted in any form or by any means, electronic or mechanical, including photocopying, scanning or recording, or any information storage and retrieval system, without express permission or consent from the publisher.