

# **USER MANUAL** 65cc Gasoline Tiller

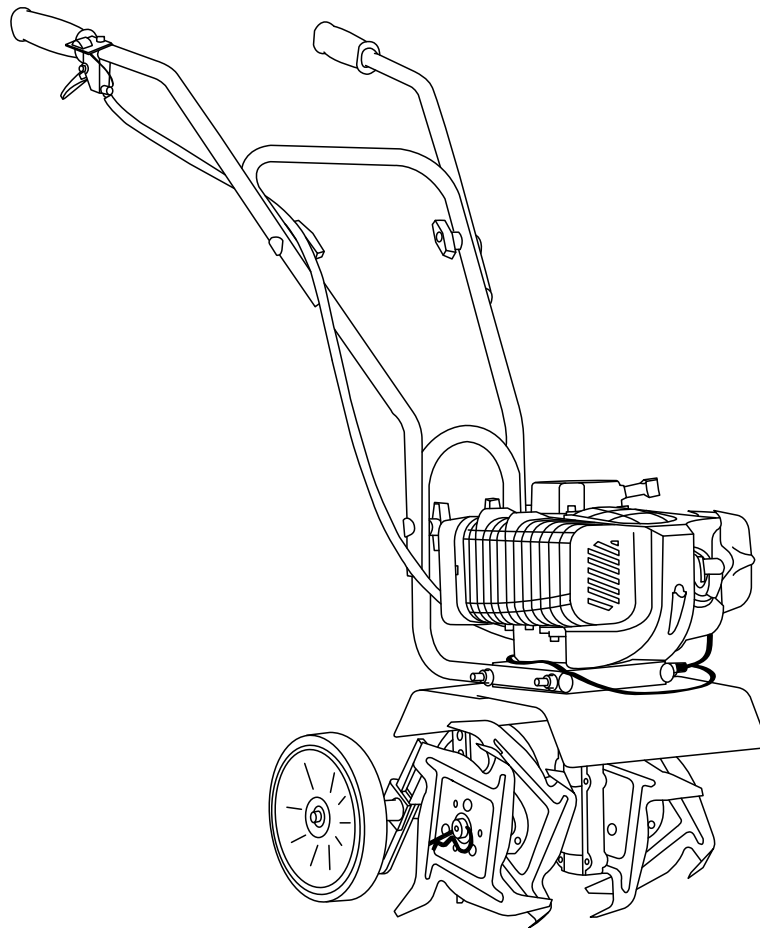

**READ AND FOLLOW ALL INSTRUCTIONS IN THIS MANUAL BEFORE  
ATTEMPTING TO OPERATE THE TILLER**

# TABLE OF CONTENTS

<b>PREFACE</b> .....	pg 3
<b>PARTS</b> .....	pg 4
<b>SAFETY</b> .....	pg 5
<b>ASSEMBLY INSTRUCTIONS</b> .....	pg 9
<b>OPERATION</b> .....	pg 11
<b>MAINTENANCE AND STORAGE</b> .....	pg 12
<b>SPECIFICATIONS</b> .....	pg 13

---

# PREFACE

Thanks for buying the 65cc Gasoline Tiller another high-quality machine from our company.

To get the most out of your purchase, please read the manual before using the tiller

We ask you to please read this manual carefully beforehand in order to familiarise yourself with this product and after reading, please store this instructional manual for future reference. Failure to follow the proper protocols listed in the manual may cause personal injury to the operator or damage to equipment.

# PARTS

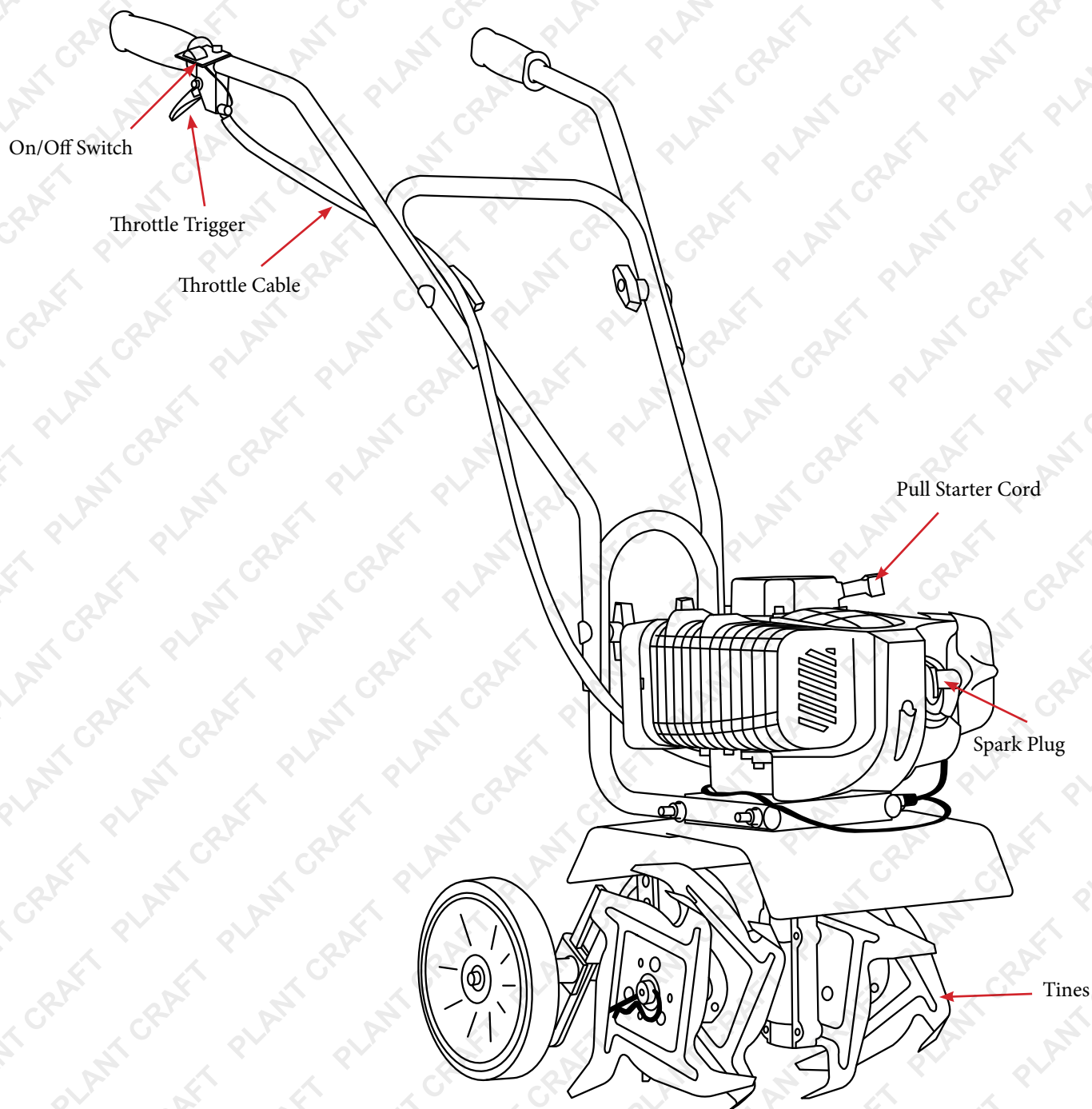

# SAFETY

## IMPORTANT SAFETY PRECAUTIONS

- Accurate assembly and safe and effective use of the rototiller is the owner's responsibility.
- Read and follow all safety instructions.
- Carefully follow all assembly instructions.
- Ensure that anyone who uses the tiller must read the manual and be familiar with all controls and safety precautions.
- Operate the tiller according to the safety instructions and recommendations outlined here.
- Your tiller is equipped with a safety device that enables you to stop the wheels and tines in an emergency.
- Learn how to safely control the tiller at all times.
- Do not allow children to operate this rototiller. Keep small children away from the area being tilled. Do not allow adults to operate the tiller without proper instruction.

## PREPARATION

- Dress appropriately when operating the tiller. Always wear sturdy footwear. Never wear sandals, sneakers or open shoes and never operate the tiller with bare feet. Do not wear loose clothing that might get caught in moving parts.
- Carefully inspect the area to be tilled and remove all foreign objects. Do not till above underground water lines, gas lines, electric cables or pipes. Do not operate the tiller in soil with large rocks and foreign objects which can damage the equipment.
- Disengage all clutches and leave all control levers in the neutral position before starting the engine.
- Handle fuel with care; it is highly flammable:
  - a) Use an approved fuel container
  - b) Never add fuel to a running engine or hot engine
  - c) Fill the fuel tank outdoors with extreme care. Never fill the fuel tank indoors.
  - d) Replace the gasoline cap securely and clean up spilled fuel before restarting



Never attempt to make any adjustments while the engine is running.

## OPERATION



Engine is shipped from the factory without oil. You must add engine oil before starting the engine.



The right and left sides of your rototiller are determined from the operating position as you face the direction of forward travel.

- Never operate the tiller without guards, covers and hoods in place.
- Be extremely cautious when operating in reverse. Take extra care to avoid slipping or falling, and keep hands and feet clear of tines.
- Use extreme caution when operating on or crossing gravel drives, walks or roads. Stay alert for hidden hazards or traffic.
- After striking a foreign object, stop the engine, remove the wire from the spark plug, thoroughly inspect the tiller for any damage and repair the damage before restarting and operating the tiller.
- If vegetation clogs the tines, raise the handlebars to elevate the lines and run the tiller in *reverse*. If this does not clean chopped vegetation from the tines, **stop the engine and disconnect the spark plug wire** before removing vegetation by hand.
- The engine muffler will be hot from operation. Do not touch it with bare skin or a severe burn may result.
- If the unit should start to vibrate abnormally, stop the engine and check immediately for the cause. Vibration is generally a sign of trouble.
- Do not run the engine indoors; exhaust fumes are deadly.
- Do not overload the machine capacity by attempting to fill too deep at too fast a rate.
- Never operate the machine at high transport speeds on slippery surfaces. Look behind and use care when backing.
- Never allow bystanders near the unit.
- Use only attachments and accessories approved by the manufacturer of the tiller.
- Never operate the tiller without good visibility or light.
- Be careful when tilling in hard ground. The tines may catch in the ground and propel the tiller backwards. If this occurs, let go of the handlebars and do not restrain the machine.
- Take all possible precautions when leaving the machine unattended. Disengage all control levers, stop the engine, wait for all moving parts to stop and make certain guards and shields in place.
- When leaving the operating position for any reason
  - a) shut off the engine
  - b) wait for all moving parts to stop

## **MAINTENANCE AND STORAGE**

- Keep machine, attachments and accessories in safe working condition.
- Check shear bolts, engine mounting bolts and other bolts at frequent intervals for proper tightness to be sure the equipment is in safe working condition.
- To prevent accidental starting, always disconnect and secure the spark plug wire from the spark plug before performing tiller maintenance.
- Allow the muffler to cool before storing in any building.
- Always refer to the manual for important detail if the tiller is to be stored for an extended period.



## FUEL SAFETY



Use unleaded or quality leaded petrol.

The lowest recommended octane rating is 90. If you run the engine on petrol with a lower octane rating than 90 so-called knocking can occur. The knocking means that there is a markedly increased engine temperature which can cause a serious engine breakdown.

### Two-Stroke Oil

Use high quality two-stroke oil intended for air cooled engines.

Mixing ratio: 1:33(3%)-1:25(4%).

Never use two-stroke oil intended for water cooled outboard motor oil.

Never use oil intended for four-stroke engines.

### Mixture

- Always mix petrol and oil in a clean container intended for petrol.
- Always start by filling half the quantity of petrol required.
- Mix (shake) the fuel mixture. Fill the remaining quantity of petrol.
- Mix (shake) the fuel mixture carefully before filling in the machine's fuel tank.
- Do not mix fuel for more than approximately 2 months use.
- If the trimmer is not used for a long period of time, the fuel tank should be emptied and cleaned.
- Clean around the fuel cap. Contamination in the tank can disrupt operations.
- Ensure that the fuel is well mixed by shaking the container before filling the tank.
- Keep the handles free from oil and fuel.
- Do not smoke while mixing fuel or filling tank.
- Do not mix fuel in an enclosed room or near open flames.
- Always assure adequate ventilation.
- Always mix and store the fuel in a properly marked container that is approved by local codes and ordinances for such usage.
- Never remove the fuel tank cap while the engine is running.
- When refueling, be sure to stop the engine and confirm that it is cooled down..
- Never refuel when the engine is running or hot. When gasoline spills, be sure to wipe it up to completely dispose of those materials before starting the engine.



# ASSEMBLY INSTRUCTIONS

Attach the push handle tines and drag the stake to match the photos below.

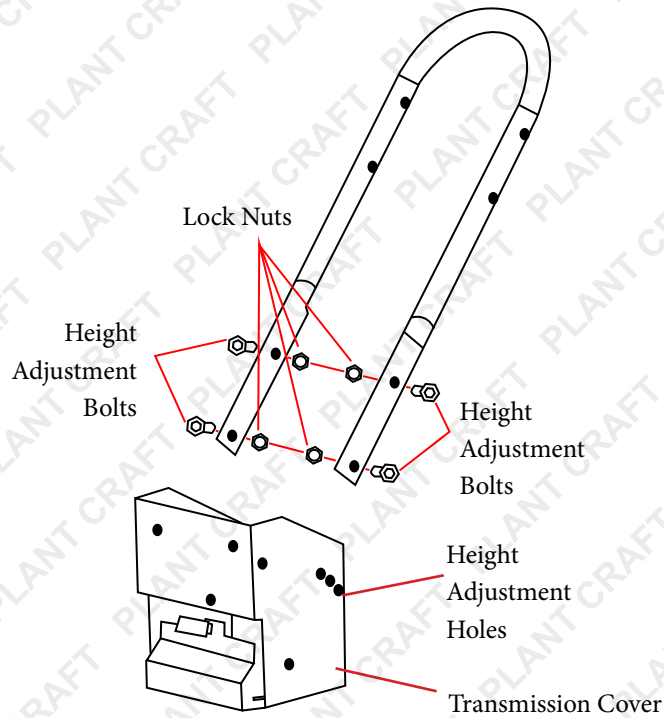

## ATTACHING THE HANDLE BAR TO THE TILLER

1. Attach the handle bar to the tiller
2. Attach fastness nuts on each bolt
3. Tighten all the nuts

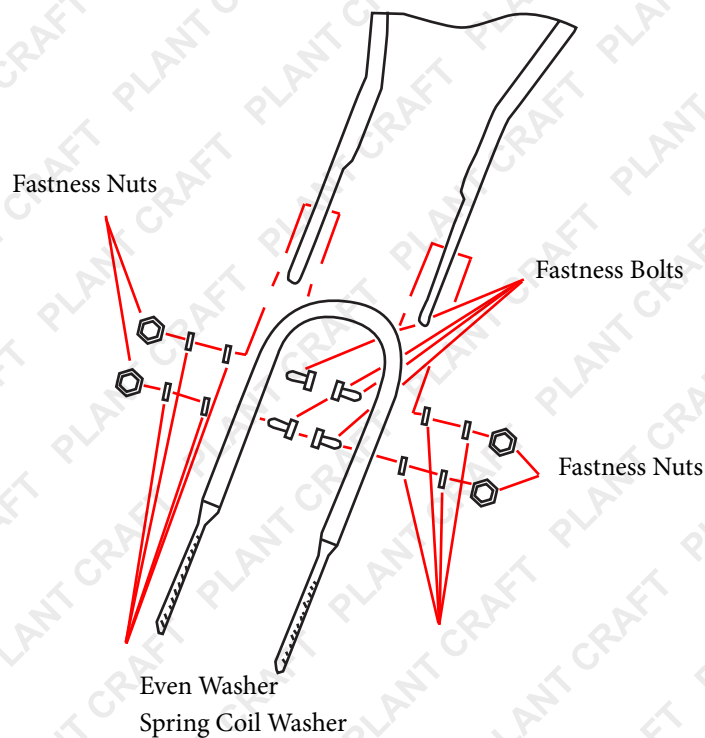

Loading Pin

Tine

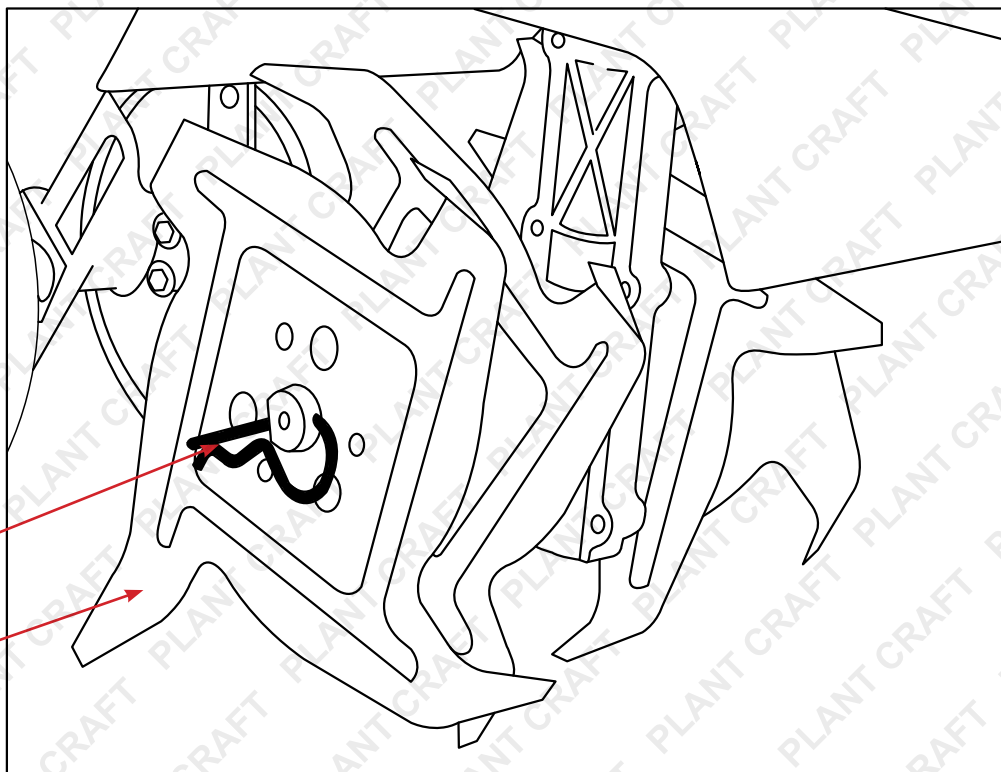

Wheels

Level/  
Support Spike

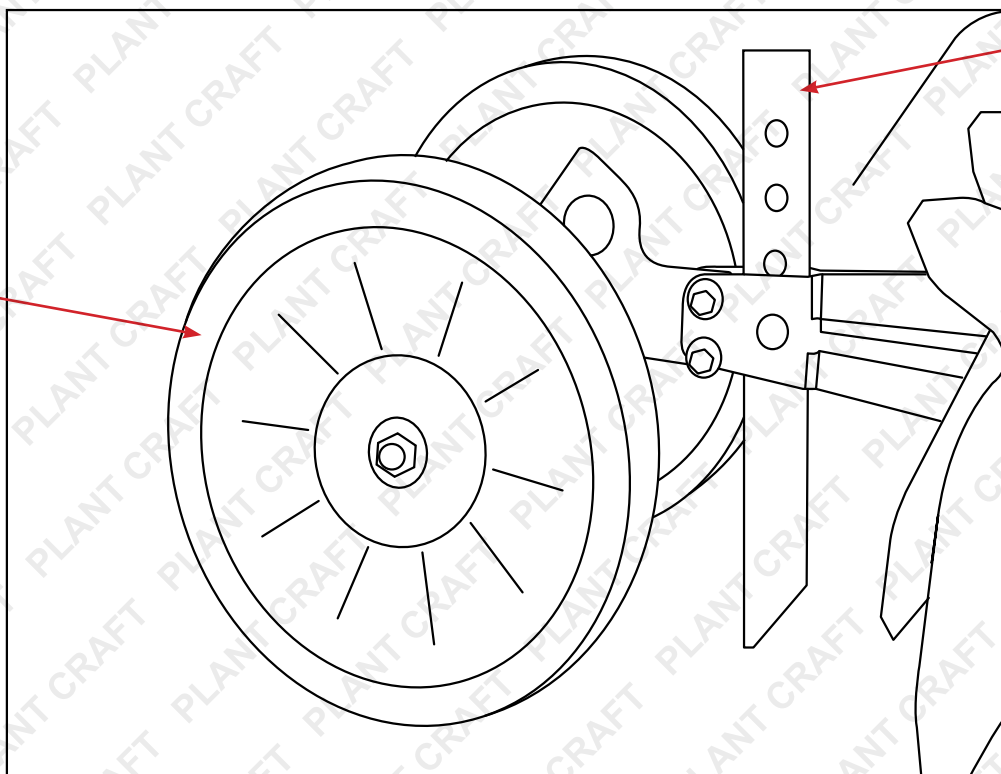

# OPERATION

## PRE-START INSPECTION



Gasoline is highly flammable and must be handled with care. Never fill the tank when the engine is hot or running. Always move outdoors to fill the tank.



Wheels must always be locked in the tilling position when the engine is running. Do not operate the tiller with the wheel lockouts unlocked. Always set the wheels in tilling position before starting the engine.



Always put the depth regulator lever in the transport position before starting the engine. The tines should clear the ground.

- Make sure all safety guards are in place and all nuts and bolts are secure.
- Check the fuel supply. Fill the fuel tank no closer than 1 inch from the top of the tank to provide space for expansion.
- Be sure the spark plug wire is attached and the spark plug is tightened securely.
- Check the position of the wheels.
- Check the depth regulator lever position.
- Examine underneath and around the engine for signs of oil or oil leaks.
- Inspect fuel hoses for tightness and fuel seepage.
- Look for signs of engine damage.
- Remove excessive debris from the muffler area and recoil starter.

## START-UP

The controls required to start and run the rototiller are located on the engine and are marked “choke” and “throttle”.

1. Move the choke lever to the starting position (cold engine only).
2. Switch the engine on/off switch to “on.”
3. Pull the starter cord until the engine starts. Apply some throttle if necessary.
4. When the engine starts, gradually move the choke lever to the “no choke” position and increase.



Engine and surrounding parts become extremely hot during normal use and can cause serious burns if touched before the engine has cooled. Allow the engine to cool completely before touching these hot surfaces.

## OPERATING SPEED

For normal tilling, hold the throttle to operate the engine at a high speed.

## TILLING

Adjust the depth regulator lever to the desired tilling depth.

Raise the depth regulator lever up one hole at a time, testing the tiller operation after each raise. Raising the depth regulator lever too high can result in loss of control of the tiller.

# MAINTENANCE AND STORAGE

Keeping the tiller in top running condition will prolong the tiller's life and help it to obtain optimum performance .

To help you properly care for the rototiller, the following pages include a maintenance schedule, routine inspection procedures and simple maintenance procedures using basic hand tools. Other service tasks that are more difficult or require special tools are best handled by professionals and are normally performed by a qualified mechanic.

- Good maintenance is your responsibility, poor maintenance is an invitation for trouble.
- Follow good shop practices.
- Keep the service area clean and dry.
- Be sure electrical outlets and tools are properly grounded.
- Use adequate light for the job at hand.
- Make sure the engine is off before you begin any maintenance or repairs. This will eliminate several potential hazards.
- Carbon monoxide poisoning can occur from engine exhaust in closed buildings.
- Be sure there is adequate ventilation whenever you operate the engine.
- Never operate the engine in a closed building.
- Let the engine and exhaust system cool before touching.
- To reduce the possibility of fire or explosions, be careful when working around gasoline. Use only a nonflammable solvent, not gasoline, to clean parts. Keep cigarettes, sparks and flames away.
- Frequently check tiller tines. They should be free of nicks and cracks and securely fastened in place.
- Periodically tighten all bolts, nuts, screws and check that all pins are properly installed to make sure the unit is safe to operate.

# SPECIFICATIONS

Tilling Scope (4 Blade / 6 Blade)	300mm / 400mm
Tilling Depth	150mm
Engine Type	2 Stroke
Starting System	Recoil
Displacement	65cc
Fuel-Oil Ratio	25:1
RPM	9000RPM
Fuel Volume	1.2L



**Some experts believe the incorrect or prolonged use of almost any product could cause serious injury or death. For information that may reduce your risk of serious injury or death consult the points below and additionally, the information available at [www.datastreamserver.com/safety](http://www.datastreamserver.com/safety)**

- Consult all documentation, packaging and product labelling before use. Note that some products feature online documentation which should be printed and kept with the product.
- Check product for loose / broken / damaged / missing parts, wear or leaks (if applicable) before each use. Never use a product with loose / broken / damaged / missing parts, wear or leaks (if applicable).
- Products must be inspected and serviced (if applicable) by a qualified specialist every 6 months assuming average residential use by a person of average weight and strength, above average technical aptitude, on a property matching average metropolitan specification. Intended use outside these guidelines could indicate the product is not suitable for intended use or may require more regular inspection or servicing.
- Ensure all possible users of the product have completed an industry recognised training course before being given access to the product.

- The product has been supplied by a general merchandise retailer that may not be familiar with your specific application or your description of the application. Be sure to attain third party approval for your application from a qualified specialist before use regardless of prior assurances by the retailer or its representatives.
- This product is not intended for use where fail-safe operation is required. As with any product (take an automobile, aircraft, computer or ball point pen for example) there is always a small chance of a technical issue that needs to be repaired or may require replacement of the product or a part. If the possibility of such failure and the associated time it takes to rectify could in any situation inconvenience the user, business or employee or could financially affect the user, business or employee then the product is not suitable for your requirements. This product is not for use where incorrect operation or a failure of any kind, including but not limited to a condition requiring product return, replacement, service by a technician or replacement of parts could cause a financial loss, loss of employee time or an inconvenience requiring compensation.
- If this item has been purchased in error considering the points above simply contact the retailer directly for details of their returns policies if required.