

# Instruction Menu

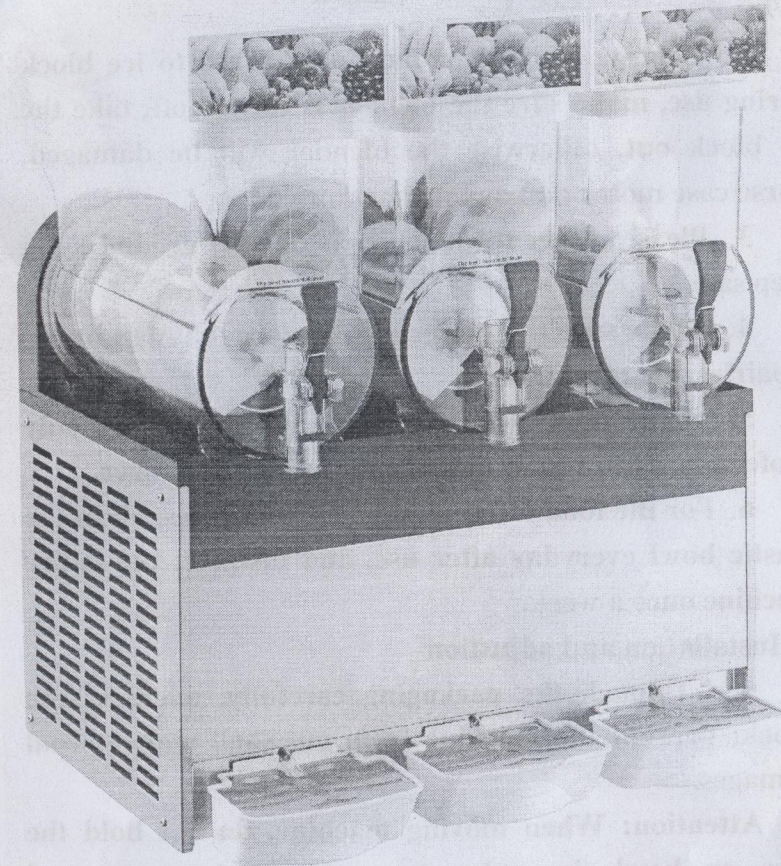

## A. Safety Precautions

Please read the following content before use the machine.

### Precautions:

1. Ensure the power supply is matching the machine specification, working voltage deviation no more than 10%.
2. If large amount of the liquid turns to ice block during use, make sure the blender is turned off, take the ice block out, otherwise the blender will be damaged, worse case motor damage will be caused.
3. Please ensure the machine is reliably grounding to keep safe.
4. Make sure the power is off before maintaining or repairing the machine.
5. If the power cable is damaged, make sure only professional can repair and change in case of danger.
6. For the food safety standards, we suggest clean the plastic bowl everyday after use, and disinfect the entire machine once a week.

## B. Installation and adjustment

1. Unpack the packaging carefully, avoid severe shock; prevent the machine from out shell and internal damages.

**Attention:** When moving machine, do not hold the tape or bowl, in order to avoid displacement and breakage.

2. Place the machine in a dry area, avoid direct sunlight and other heat. Keep at least 150mm space away from machine for cooling. Also machine has to be placed horizontal position.

3. Ensure the power supply is matching the machine specification. Install correct socket, electric current  $\geq 10A$ , and make sure the ground terminal grounding effectively.

4. Do not insert more than 15L of drinking material into the bowl before put the lid on.

**Attention:** The sugar content has to no lower than 13% of the drinking material, otherwise slush wouldn't be made properly, worse case motor will be damaged.

5. Power on, turn on the main switch, then fan starts and blender starts. Turn the "snow freeze" switch on, compressor starts then machine starts refrigeration. Meanwhile adjust the knob switch onto one of the mode (I-IV) which corresponds to one of the bowl. When knob switch places at 0, the corresponding bowl stops refrigeration, but the other bowl should still working and so as the both blenders. When both knob switches place at 0, refrigeration stops, compressors stops, but blender still working. 3 bowls machine works accordingly.

When machine works down to the desired temperature, compressor will stop automatically. As compressor will start again automatically when the temperature rising above desired temperature. So it's normal when machine makes slight noise.

**Attention: Do not put both knob switches onto 0, otherwise refrigeration will not start.**

### C. Making Slush:

Connect with power and turn on it. Turn on the "snow freeze" switch, the compressor will begin to work. The machine will start to refrigerating. The knob switch will be placed on "I---IV" (one of the level) and each knob is corresponding with one of the bowl.

When the knob switch is on "0" level, the bowl that is connected with it will stop working and another bowl is go on working. When the two knobs are placed on "0" level and the two bowls will stop refrigerating at the same time, compressor stop working meanwhile.

The three bowls machine performance is same with 2 bowls machine. The "mixer1", "mixer2", "mixer3" are corresponding with each bowl's blender. When the refrigerating begin to work and the blender that is connected with it must be working at the same time. Or it will lead to much ice on the bowl and the machine will be damaged.

When the machine need to be cleaning, please turn off the refrigerating and turn on the blender working only. The residual iced drink will melt completely

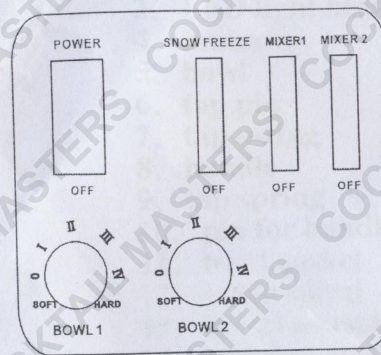

2bowl machine

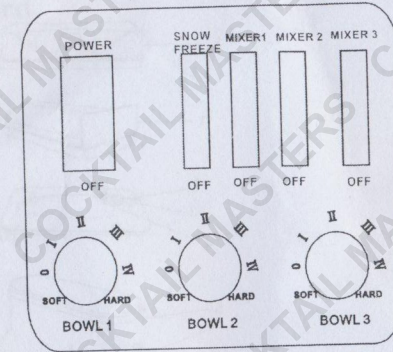

3bowl machine

### D. Slush softness adjuation

The Knob switches can adjust the slush softness. Each knob switch is corresponding to each bowl. When switch place on level I, the slush contents most percentage of water, so this level is the softest level. When switch place on level IV, slush content the least water, so this level is the hardest level. User can use this knob switch to reach desired slush softness.

E. If the machine is with lighting system, the LED lights will be turned on when the lights cable is connected. Disconnect the cable when the lighting is not needed. The lighting voltage is 12V, harmless.

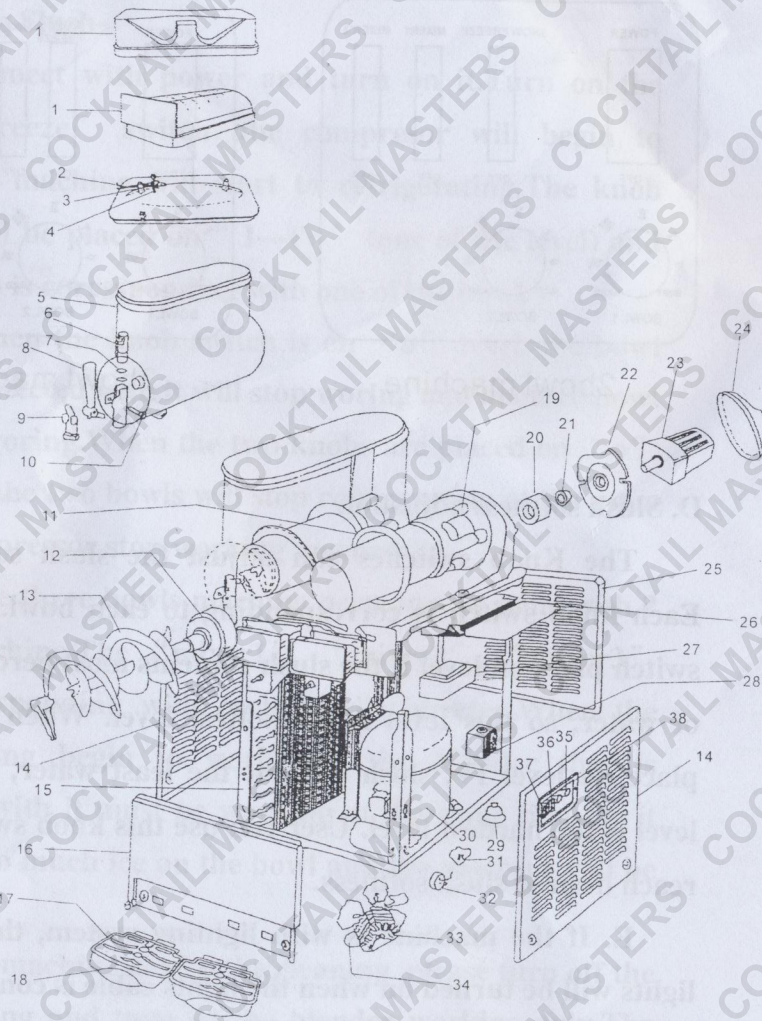

1. cover
2. LED light
3. LED light breadboard
4. innercap
5. bowl
6. tap pin
7. tap o-ring
8. handle
9. tap spring
10. pin for handle fixing
11. bowl gasket
12. inner spiral
13. spiral assembly
14. stainless steel side panel
15. condenser
16. stainless steel front panel
17. grate for drip tray
18. drip tray
19. complete evaporator
20. magnet for inner spiral
21. copper bush for motor fixing
22. plastics motor panel
23. motor
24. cover for motor
25. stainless steel back panel
26. base for control panel
27. control panel
28. electrovalve
29. gasket for compressor supporter
30. compressor
31. compressor start capacitor
32. overload protectors
33. motor
34. fan
35. soft-hard switch
36. mixing switch
37. main power switch
38. swith box



**Some experts believe the incorrect or prolonged use of almost any product could cause serious injury or death. For information that may reduce your risk of serious injury or death consult the points below and additionally, the information available at [www.datastreamserver.com/safety](http://www.datastreamserver.com/safety)**

- Consult all documentation, packaging and product labelling before use. Note that some products feature online documentation which should be printed and kept with the product.
- Check product for loose / broken / damaged / missing parts, wear or leaks (if applicable) before each use. Never use a product with loose / broken / damaged / missing parts, wear or leaks (if applicable).
- Products must be inspected and serviced (if applicable) by a qualified specialist every 6 months assuming average residential use by a person of average weight and strength, above average technical aptitude, on a property matching average metropolitan specification. Intended use outside these guidelines could indicate the product is not suitable for intended use or may require more regular inspection or servicing.
- Ensure all possible users of the product have completed an industry recognised training course before being given access to the product.

- The product has been supplied by a general merchandise retailer that may not be familiar with your specific application or your description of the application. Be sure to attain third party approval for your application from a qualified specialist before use regardless of prior assurances by the retailer or its representatives.
- This product is not intended for use where fail-safe operation is required. As with any product (take an automobile, aircraft, computer or ball point pen for example) there is always a small chance of a technical issue that needs to be repaired or may require replacement of the product or a part. If the possibility of such failure and the associated time it takes to rectify could in any situation inconvenience the user, business or employee or could financially affect the user, business or employee then the product is not suitable for your requirements. This product is not for use where incorrect operation or a failure of any kind, including but not limited to a condition requiring product return, replacement, service by a technician or replacement of parts could cause a financial loss, loss of employee time or an inconvenience requiring compensation.
- If this item has been purchased in error considering the points above simply contact the retailer directly for details of their returns policies if required.

