

Owner’s Manual

SELF – ADJUSTING
LASER LEVEL



CAUTION: Before using this Laser Level, read this Manual and follow all its Safety Rules and Operating Instructions.

- Assembly
- Features / Controls
- Adjustments
- Operation

CARTON CONTENTS

1. Self Adjusting Laser Level.....
2. Laser Level Base (arrives detached)...
3. Telescoping Tripod.....
4. Laser Enhancing Goggles.....
5. Blow Molded Case.....
6. Hook and Strap Attachment (optional)

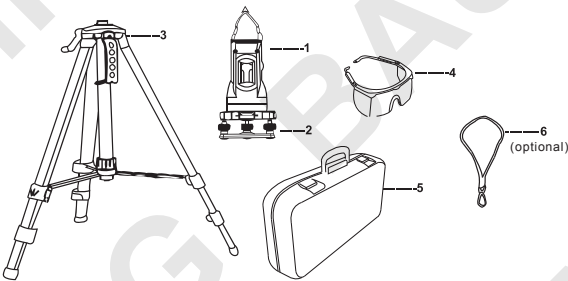

SPECIFICATIONS

Horizontal Accuracy: $\pm 0.5\text{mm/m}$

Vertical Accuracy: $\pm 0.5\text{mm/m}$

Wavelength of Laser: 635nm

Power of Laser: $\leq 1\text{mW}$

Self Leveling Scope: $\pm 4^\circ$

Power Supply: 2 AA' Batteries 3 V

Operative Distance: $\leq 5\text{m}$

Length of Laser Level: 7.5"

Tripod Measures: 17" when fully closed and 46" when fully expanded

Hook & Strap Length: 24"

Symbol Key:
V..... Volts
mW..... Milliwatts
nm..... Wavelength.....
..... In nanometers
mm/m..... Millimeters/Meters

CONTROLS

1. Laser Aperture (**NEVER** Stare into the Laser)
2. Horizontal Laser Button
3. Vertical Laser Button
4. Pendulum Unlock/Lock
5. Laser Level Base Adjusting Screws
6. Bubble Levels (one on each side of the Laser Level)
7. Tripod Securing Clips
8. Triangular Loop for Hook & Strap
9. Center Pole Locking Collar

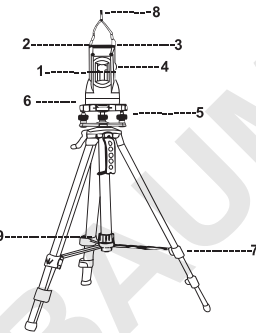

WARNING

DO NOT allow children to handle the level. All onlookers should be kept away from the work area. Do not stare at the laser beam. The high energy is extremely harmful to your eyes. Never point a laser beam at anyone's face.

SAFETY INSTRUCTIONS

WARNING

Working Safely with this Self-Adjusting Laser Level is only possible when all of the instructions are read completely and strictly followed.

- **DO NOT** operate the laser in explosive atmospheres, such as in the presence of flammable liquids, gasses, or dust.
- **DO NOT** use optical tools such as a telescope or transit to view the laser beam. Serious eye injury could result.
- **DO NOT** place the laser in a position which may cause anyone to intentionally or unintentionally stare into the laser beam. Serious eye injury could result.
- **DO NOT** operate the laser around children or allow children to operate the laser. Serious eye injury could result.
- **DO NOT** remove or deface warning labels. Removing labels increases the risk of exposure to radiation.
- The use in combination with other optical instruments, manipulations, or use in applications other than described here can lead to dangerous laser outputs.
- **DO NOT** disassemble the laser. Disassembling the laser will void all warranties on the product. Do not modify the product in any way. Modifying the tool may result in Hazardous Laser Radiation Exposure.
- Make sure the Pendulum Locking Switch on the Laser Level is in the LOCK position when in storage or not in use to prevent damage to the Pendulum.
- When using the Laser Level, make sure you position the laser securely. Damage to the laser or serious injury could result if the laser falls.
- The included Laser Enhancing Glasses are NOT intended for use as eye protection. NEVER stare at the laser or point it at anyone.
- **DO NOT STARE INTO THE LASER BEAM AT ANY TIME.**
- **DO NOT** direct the laser beam at any other person.
- **DO NOT** allow children to operate the Laser Level.

ASSEMBLY / ADJUSTMENTS

LASER LEVEL OPTIONS

The Self-Adjusting Laser Level can be used with the Tripod, the Hook & Strap Attachment, or on its' own. To determine which is the best method for you, read the following instructions.

WARNING

DO NOT stare at the laser beam. Failure to follow this warning could result in serious injury.

1. Using the Laser Level on the Tripod will allow a raised height between 22" and 52" from the ground. This is ideal for hanging pictures, wallpaper, chair rail, windows, etc. For complete instructions on setting up the Tripod see "Using the Tripod."
2. To use the Laser Level under 22" in height, set the Laser Level on a relatively level surface on or close to the ground. Or, raise to the desired height by using additional support, such as a book or box underneath the Laser Level.
3. For heights above 52", use the Laser Level with the Hook & strap Attachment. For complete instructions see "Using the Hook & Strap Attachment."

LASER LEVEL FEATURES

Please read all instructions before using the Laser Level or any of its components. **WARNING: DO NOT stare into the laser beam. NEVER point the laser beam at anyone's face.**

1. The Self-Adjusting Laser Level Projects bright, accurate laser beams in three different ways:
 - a. Horizontal (Level) Beam
 - b. Vertical (Plumb) Beam
 - c. Cross Hair (Both Horizontal and Vertical) Beam
2. The Laser Level is equipped with a locking switch for the inner pendulum. ALWAYS keep the switch in the "LOCK" position when traveling or when not in use. This protects the inner pendulum from damage.
3. The Laser Level Base has three adjusting screws and two bubble levels. Adjust screws up or down to center the bubble levels.
4. The Laser Level also includes a marked 360° rotating base for incremental movement.

USING THE LASER LEVEL

Level and plumb from floor to ceiling with this Self-Leveling Laser Level. Please read and follow all instructions before using the Self-Adjusting Laser Level.

WARNING

DO NOT stare at the laser beam. Failure to follow this warning could result in serious injury.

The Laser Level is a precise alignment tool which projects a vertical (plumb) line and/or horizontal (level) line at the press of a button.

1. Attach the triangular metal Laser Level Base to the Laser Level by aligning the three brass Adjusting Screws to the holes in the bottom of the Laser Level. Turn each brass screw clockwise several times until the screw is at least halfway through the plastic housing.
2. Set the unit on a flat and smooth surface. The self-leveling range of the instrument is within $\pm 4^\circ$.
3. The adjusting screws on the Laser Level Base should all be approx. set at the same height.
4. If the unit appears to be level, proceed. If it is not relatively level, adjust the screws to bring the bubbles on the two bubble levels on the laser base to be near or within the lines.
5. Remove the "Red" Lock Protector. Unlock the pendulum.
6. To turn on the Horizontal, Vertical, or both Laser Beam functions, press the buttons located on the top of the Laser Level. Press the forward button for a Horizontal Beam, the back button for Vertical Beam, or both buttons for Cross Hair Beam.
7. The lines on the projected surface will automatically self-level.

USING THE TRIPOD

The included Tripod allows the Laser Level to be adjusted 22" from the floor to approx. 52" when completely extended.

1. To set up the Tripod Base, simply pull the legs outward. Secure the Tripod legs by tightening the Center Pole Locking Collar (see #9 in "Main Features/Controls"). At its' lowest setting, the Tripod raises the Laser Level to 22" from the floor.
2. Attach the Laser Level to the Tripod by screwing it on to the Tripod Neck.
3. To extend the legs of the Tripod, release one or both clamps on each leg and lengthen them by pulling to the desired height. Secure the legs in their expanded position by closing the leg clamps.

ASSEMBLY / ADJUSTMENTS Cont'd...

USING THE TRIPOD Cont'd...

For additional extension, loosen the small black knob on the side of the Tripod and turn the handle clockwise to raise the Tripod Neck. Secure the Tripod Neck at the desired height by tightening the small black knob. At its highest setting the Tripod raises the Laser Level to approx. 52" from the floor.

4. Make sure the Tripod is set on relatively level surface. If the surface is extremely uneven, adjust the tripod legs and the screws on the Laser Level Base to create a relatively level surface. Note: The Self-Leveling Feature will compensate for $\pm 4^\circ$.

USING THE HOOK & STRAP ATTACHMENT

The included Hook & Strap Attachment allows the Laser Level to be adjusted while hanging from an above location. Use the Hook & Strap when a Laser Line above 52" is needed. The included Strap is 24" long with 10" of adjustable Velcro strips.

WARNING

DO NOT stare at the laser beam. Failure to follow this warning could result in serious injury.

1. Attach the Hook & Strap to the Laser Level Triangular Loop.
2. Hang the Laser Level Strap from a high location such as a drop ceiling, or wood beam.
3. Secure the Strap into place with the 10" adjustable Velcro strips. The Laser Level can be raised or lowered within the length of the strips for added flexibility.
4. When the Hook & Strap is secured into place, you can begin using the Laser Level. The Self-Leveling feature will automatically level the Laser Line. No manual adjustments are needed.

BATTERY REPLACEMENT

The Self-Adjusting Laser Level includes 2 AA' Batteries when purchased. It is important to replace the batteries if you notice the Laser is not working or becoming dim.

1. Locate the battery compartment on the back of the Laser Level.
2. Open the compartment cover by pressing down on the tab.
3. Remove old batteries and replace with 2 working AA' Batteries in the correct + and - positions.

MAINTENANCE AND STORAGE

To ensure a long working life for the Self-Adjusting Laser Level and components, be sure to follow all instructions regarding proper Safety, Maintenance, and Storage.

1. Use only mild soap and a damp cloth to clean the tool.
2. Never let any liquid get inside the tool.
3. Never immerse any part of the tool in liquid.
4. When not in use, store the Self-Adjusting Laser Level and all components in the included Blow Molded Case. Using the case for storage will help protect the Laser Level and components from damage. Store in a cool, dry place away from extremes in heat or cold.
5. Always keep the Pendulum Locking Switch in the "LOCK" position when in storage or not in use to prevent damage to the Pendulum.



Some experts believe the incorrect or prolonged use of almost any product could cause serious injury or death. For information that may reduce your risk of serious injury or death consult the points below and additionally, the information available at www.datastreamserver.com/safety

- Consult all documentation, packaging and product labelling before use. Note that some products feature online documentation which should be printed and kept with the product.
- Check product for loose / broken / damaged / missing parts, wear or leaks (if applicable) before each use. Never use a product with loose / broken / damaged / missing parts, wear or leaks (if applicable).
- Products must be inspected and serviced (if applicable) by a qualified specialist every 6 months assuming average residential use by a person of average weight and strength, above average technical aptitude, on a property matching average metropolitan specification. Intended use outside these guidelines could indicate the product is not suitable for intended use or may require more regular inspection or servicing.
- Ensure all possible users of the product have completed an industry recognised training course before being given access to the product.

- The product has been supplied by a general merchandise retailer that may not be familiar with your specific application or your description of the application. Be sure to attain third party approval for your application from a qualified specialist before use regardless of prior assurances by the retailer or its representatives.
- This product is not intended for use where fail-safe operation is required. As with any product (take an automobile, aircraft, computer or ball point pen for example) there is always a small chance of a technical issue that needs to be repaired or may require replacement of the product or a part. If the possibility of such failure and the associated time it takes to rectify could in any situation inconvenience the user, business or employee or could financially affect the user, business or employee then the product is not suitable for your requirements. This product is not for use where incorrect operation or a failure of any kind, including but not limited to a condition requiring product return, replacement, service by a technician or replacement of parts could cause a financial loss, loss of employee time or an inconvenience requiring compensation.
- If this item has been purchased in error considering the points above simply contact the retailer directly for details of their returns policies if required.