



# User Manual

©2018 Jet USA



# Table of Contents

**Safety.....3**

**Pressure Washer Parts.....5**

**Getting Started .....6**

    Automatic On/Off.....6

    Bleeding the Gun .....6

**Operating Instructions .....6**

    Shut Down .....6

    Nozzle Uses.....7

    Using Detergent.....7

**Maintenance .....7**

    Connections.....7

    Nozzle.....7

**Storage .....8**

**Troubleshooting.....8**

**Specifications.....9**

# Safety

We ask you to please read this manual carefully beforehand in order to familiarise yourself with this product and after reading, please store this instructional manual for future reference. Failure to follow the proper protocols listed in the manual may cause personal injury to the operator or damage to equipment.

The symbol  is used throughout this manual to denote that failure to understand and follow the associated warning or information may be consequential to your personal safety.

- The machine is designed for very specific applications. Do not modify or use it for any application other than for which it is designed.
- Never operate when there is:
  - A noticeable change in motor speed.
  - A noticeable loss of pressure.
  - Smoke or flames present.
  - Excessive vibration.
  - Rain or inclement weather.
- The pressure washer is for outdoor use only.
- Do not use in enclosed spaces.
- All equipment must be placed on a firm, level and stable surface.
- Keep the pressure washer clean and free of oil, mud and dirt.
- Prior to starting the pressure washer in cold weather, be sure that ice has not formed in any part of the equipment.
- Wear safety goggles while operating.
- Never directly spray the hose at people or animals.
- Never allow children to operate the pressure washer at any time.
- Disconnect the machine from the electrical supply when not in use, to prevent accidental starting, or prior to detaching the high pressure hose.
- To prevent accidental discharge, the spray gun should be secured by locking the trigger when not in use.
- Do not run the pressure washer for more than two minutes without depressing the trigger or damage to the pump may result.
- Test the pressure washer on a small inconspicuous area first. Some surfaces can be damaged by high water spray such as paint which can be removed with sufficient pressure.

## Hose Safety

- Use both hands to control the wand.
- Do not touch the nozzle or water spray while operating. Water spray must never be directed towards any electric wiring or directly towards the pressure washer.
- Only approved hoses and nozzles should be used.
- The trigger gun must not be jammed in position during operation.
- Never tie knots or kink the high-pressure hose. Do not use damaged high-pressure hoses.
- All hose connections must be properly sealed.

### **Thermal Relief Valve**

A thermal relief valve is provided to protect the pump from overheating if the spray gun is closed for an extended length of time or the nozzle becomes obstructed. However, it is only intended to be used as a backup system and every effort should be made to ensure that you pull the spray gun trigger to allow water flow so that there are no blockages in the system.

### **Safety Latch**

To prevent accidental discharge of high-pressure water, the safety latch on the trigger should be engaged whenever the pressure washer is not in use.

# Pressure Washer Parts

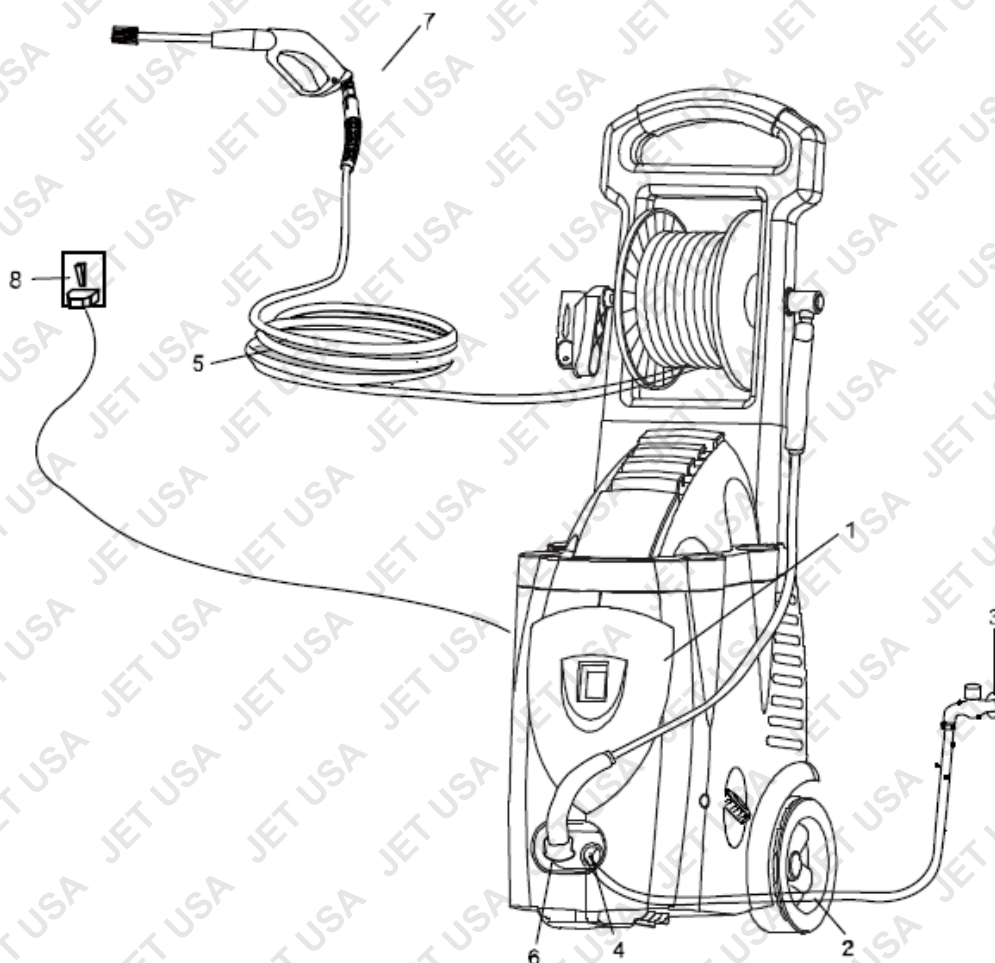

No.	Part
1.	Pressure Cleaner
2.	Water Supply Hose (Not Included)
3.	Water Connection
4.	Water Inlet
5.	High Pressure Tube
6.	Water Outlet
7.	Spray Gun
8.	Power Supply

# Getting Started

## Automatic On/Off

The motor on this pressure washer does not run continuously. It only runs when the trigger of the spray gun is squeezed. After following the start-up procedures in this manual, turn the pressure washer on and squeeze the trigger for activation.

The pump on your pressure washer will often improve performance after a break-in period of several hours.

## Bleeding the Gun

It is very important to bleed the gun before using the pressure washer. Squeeze the trigger to allow any air that is trapped inside of the unit and hose to escape. Continue to squeeze the trigger until a steady stream of water comes from the nozzle (this process may take several minutes).

# Operating Instructions



This unit is to be connected to a cold water source only.

The motor runs only when the trigger is squeezed.

1. Connect the outlet hose to the washer and connect the spray gun to the outlet hose.
2. Connect the nozzle and nozzle extension.
3. Check that the gauze filter is clear of any blockage.
4. Connect the water supply hose.
5. Check that the hose has no kinks in it.
6. Turn on the water and check for leaks.
7. Depress the trigger to allow air to be expelled through the pump and hoses, then lock the trigger.
8. Connect the machine to the electrical supply and switch the machine ON.
9. Unlock the trigger and use the pressure washer.

## Shut Down

1. Switch the machine OFF (place switch to the off position).
2. Unplug the unit from the power source.
3. Turn off the water supply.
4. Press the trigger of the gun to depressurise the system.
5. Disconnect the garden hose from the pressure washer.
6. Wipe all surfaces of the unit with a damp clean cloth.
7. Engage the gun safety lock.



**ALWAYS** switch the machine OFF before turning off the water supply. Serious damage could occur to the motor if the unit is run without water.



**NEVER** disconnect the high-pressure discharge hose from the machine while the system is still pressurised. To depressurise the unit, turn off the motor, turn off the water supply and squeeze the trigger 2-3 times.

## Nozzle Uses

The Electric Pressure Washer comes with five nozzle attachments for different uses. Please refer to the image below and on the pressure washer itself to see which nozzle is applicable for your purpose.



## Using Detergent

1. Add detergent to the container.
2. Set the Adjustable Spray Wand at low pressure position (see image to the right).
3. Trigger gun to spray detergent.

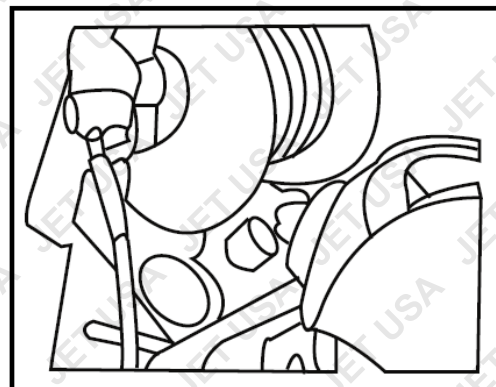

## Maintenance

### Connections

The connections on the pressure washer hoses, gun and spray wand should be cleaned regularly and lubricated with the manufacturer's recommended grease to prevent leakage and damage to the O-rings.

### Nozzle

Obstructions to the nozzle will cause the pump pressure to be too high. If the nozzle is obstructed, clean it immediately.

A nozzle cleaner must only be used when the spray wand is disconnected from the gun or personal injury could occur.

1. Turn off the pressure washer.
2. Separate the wand from the gun.
3. Clear the nozzle with a small rigid piece of wire such as a paper clip.
4. Flush the nozzle backwards with water.

5. Reconnect the wand to the gun.

Restart the pressure washer and depress the trigger on the spray gun. If the nozzle is still partially blocked or plugged, repeat above instructions 1-4.

If the previous procedure does not clear the nozzle, replace the nozzle.

## Storage

If you must store your pressure washer in a location where the temperature is below freezing, you can minimise the chance of damage to your washer with the following instructions.

1. Stop the pressure washer and detach the supply hose and the high-pressure hose. Squeeze the trigger of the discharge gun to drain all water from the wand and hose.
2. Restart the pressure washer and let it run briefly (about 5 seconds) until water no longer discharges from the high pressure outlet.

## Troubleshooting

Fault	Probable Cause	Repair
Pressure washer isn't working	Plug is not connected or electric socket is faulty	Check plug and socket
	Main voltage is insufficient and lower than the minimum requirement	Check that the main voltage is adequate
	Thermal safety switch has tripped	Switch off the unit and let the motor cool for a few minutes
Fluctuating Pressure	Pump is sucking air	Check that hoses and connections are airtight
	Valves are dirty, worn or stuck	Clean and replace
	Pump seals are worn out	Clean and replace
Water leaking from the pump	Seals are worn out	Check and replace
The motor stops suddenly	Thermal safety switch has tripped due to overheating	Check that the main voltage corresponds to specifications Switch off the unit and let it cool for a few minutes
	Water inlet filter is clogged	Clean the water inlet filter
The pump doesn't reach the necessary pressure	Pump sucking air from connections or hoses	Check that all supply connections are tight
	Suction/delivery valves are clogged or worn out	Check that the water feeding hose is not leaking
	Unloaded valve is stuck	Clear or replace valves
	Lance nozzle is incorrect or worn out	Check and replace

# Specifications

<b>Electrical Requirements</b>	240V / 50HZ
<b>Motor</b>	3200W (Peak) Induction
<b>Maximum Pressure</b>	3800PSI (262Bar)
<b>Continuous Pressure</b>	2500PSI (170Bar)
<b>Rated Flow Rate</b>	6.8L/min
<b>Max. Flow Rate</b>	8.5L/min
<b>Hose Length</b>	10m reel + 20m coiled
<b>Detergent Bottle</b>	1.0L
<b>Maximum Water Temperature</b>	50°C
<b>Power Cable Length</b>	5m
<b>Dimension</b>	1010 x 375x 365mm
<b>Weight</b>	27kg



**Some experts believe the incorrect or prolonged use of almost any product could cause serious injury or death. For information that may reduce your risk of serious injury or death, consult the points below and additionally, the information available at [www.datastreamserver.com/safety](http://www.datastreamserver.com/safety)**

- |   |  |
|---|--|
| <ul style="list-style-type: none"> <li>• Consult all documentation, packaging and product labelling before use. Note that some products feature online documentation which should be printed and kept with the product.</li> <li>• Check product for loose / broken / damaged / missing parts, wear or leaks (if applicable) before each use. Never use a product with loose / broken / damaged / missing parts, wear or leaks (if applicable).</li> <li>• Products must be inspected and serviced (if applicable) by a qualified specialist every 6 months assuming average residential use by a person of average weight and strength, above average technical aptitude, on a property matching average metropolitan specification. Intended use outside these guidelines could indicate the product is not suitable for intended use or may require more regular inspection or servicing.</li> <li>• Ensure all possible users of the product have completed an industry recognized training course before being given access to the product.</li> </ul> | <ul style="list-style-type: none"> <li>• The product has been supplied by a general merchandise retailer that may not be familiar with your specific application or your description of the application. Be sure to attain third-party approval for your application from a qualified specialist before use regardless of prior assurances by the retailer or its representatives.</li> <li>• This product is not intended for use where fail-safe operation is required. As with any product (take an automobile, aircraft, computer or ball point pen for example), there is always a small chance of technical issues that needs to be repaired or may require replacement of the product or a part. If the possibility of such failure and the associated time it takes to rectify could in any situation inconvenience the user, business or employee then the product is not suitable for your requirements. This product is not for use where incorrect operation or a failure of any kind, including but not limited to a condition requiring product return, replacement, service by a technician or replacement of parts could cause a financial loss, loss of employee time or an inconvenience requiring compensation.</li> <li>• If this item has been purchased in error after considering the points above, simply contact the retailer directly for details of their returns policy, if required.</li> </ul> |
|---|--|



©2018 Jet USA. All rights reserved. No part of this document, including descriptive content, concepts, ideas, diagrams or images may be reproduced or transmitted in any form or by any means, electronic or mechanical, including photocopying, scanning or recording, or any information storage and retrieval system, without express permission or consent from the publisher.