



100psi Pneumatic 2 in 1 Nailer

User Manual

[Revision 2.0 April 2017]

READ THIS MANUAL CAREFULLY BEFORE USE AND KEEP FOR FUTURE REFERENCE – FAILURE TO DO SO MAY RESULT IN INJURY, PROPERTY DAMAGE AND MAY VOID WARRANTY. • Products covered by this manual may vary in appearance, assembly, inclusions, specifications, description and packaging.

TABLE OF CONTENTS

IMPORTANT SAFETY INSTRUCTIONS	2
PRODUCT SPECIFICATIONS	4
OPERATING INSTRUCTIONS	4
Foreword	4
Power Source	4
Preparing the Tool	5
USING THE TOOL	6
Clearing a Jammed Fastener	7
MAINTENANCE	8
Clean and Inspect Daily	8
Service and Repairs	8
TROUBLESHOOTING	8
IN THE BOX	9
EXPLODED DRAWING OF PARTS	10
PARTS LIST	11

IMPORTANT SAFETY INSTRUCTIONS

ENSURE THAT NO PART OF ANY HUMAN, ANIMAL OR CLOTHING IS PLACED IN/NEAR THE AREA WHERE NAILS ARE FIRED OUT OF THE GUN, REGARDLESS OF WHETHER YOU THINK THE GUN IS EMPTY OR LOADED WITH NAILS.

When using pneumatic tools, basic safety precautions should always be followed to reduce the risk of personal injury. Please make certain that the person who is going to use this equipment carefully reads and understands these instructions before starting operations.

READ AND FOLLOW ALL INSTRUCTIONS.

There are certain applications for which this tool was designed. It is strongly recommended that this tool NOT be modified and /or used for any application other than for which it was designed.

1. USE SAFETY GLASSES

To prevent eye injuries, the tool operator and all persons in the work area must wear safety glasses with permanently-attached, rigid, plastic side shields. These safety glasses must conform to ANSI Z87.1 requirements (approved glasses have "Z87" printed or stamped on them). See Figure 1.

2. WEAR EAR PROTECTION to safeguard against possible hearing loss. See Figure 1.

3. OPERATOR AND BYSTANDERS SHOULD WEAR HARD HATS to safeguard against possible injuries. See Figure 1.

4. USE CLEAN, DRY, REGULATED compressed air at 70 to 120 PSI, (4.8 to 8.3 BAR). See Figure 2.

5. DO NOT CONNECT TOOL to pressure which potentially exceeds 200 PSI (13.8BAR)

6. ONLY USE AIR HOSE THAT IS RATED for a maximum working pressure of 150 PSI or 150% of the maximum system pressure, whichever is greater.

7. NEVER USE OXYGEN, CARBON DIOXIDE, combustible gases or any other bottled gas as a power source for this tool: explosion and serious personal injury could result. See Figure 3.

8. CONNECT TOOL TO AIR SUPPLY HOSE with a coupling that removes all pressure from the tool when the coupling is disconnected. See Figure 4.

9. DISCONNECT TOOL FROM AIR SUPPLY HOSE before doing tool maintenance, clearing a jammed fastener, leaving the work area, moving tool to another location, handing the tool to another person, or making adjustments. See Figure 5.

10. NEVER USE A TOOL that is leaking air, has missing or damaged parts, or requires repair. Make sure that all screws and caps are securely tightened.

11. DO NOT USE TOOL WITHOUT SAFETY WARNING LABEL. If label is missing, damaged or unreadable, contact your Service Centre for a replacement. See Figure 6.

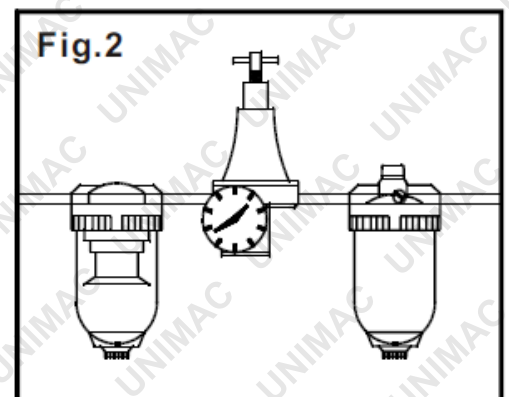
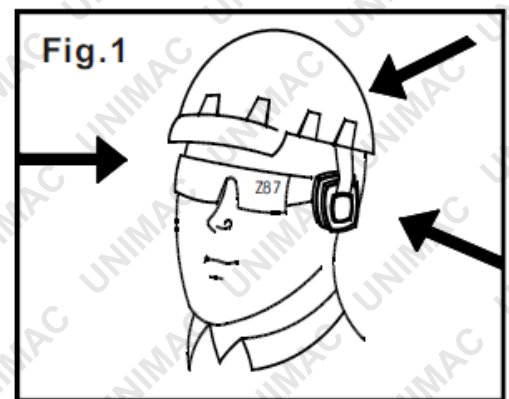

100PSI PNEUMATIC 2 IN 1 NAILER

12. USE ONLY RECOMMENDED PARTS AND FASTENERS.

13. **REMOVE ALL FASTENERS** from tool before connecting to air supply. The tool's driving mechanism may cycle when tool is connected to the air supply. See Figure 7.
14. **ALWAYS ASSUME THE TOOL CONTAINS FASTENERS.** Keep the tool pointed away from yourself and others at all times. Do not play around with the tool. Respect the tool as a working implement. See Figure 8.
15. **USE THE Mallet TO RACK THE WOOD STRIP, NOT THE NAILER.** See Figure 9.
16. **DO NOT USE THE METAL END OF THE Mallet TO STRIKE THE PLUNGER.** Use the rubber capped end
17. **FIRE FASTENERS INTO WORK SURFACE ONLY.** Never fire into materials that are too hard to penetrate.
18. **DO NOT DRIVE FASTENERS** on top of other fasteners. The fasteners can ricochet, causing personal injuries. See Figure 10.

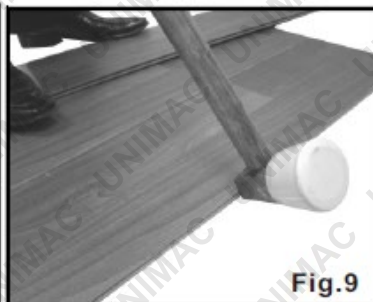
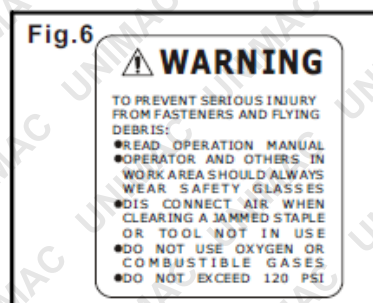
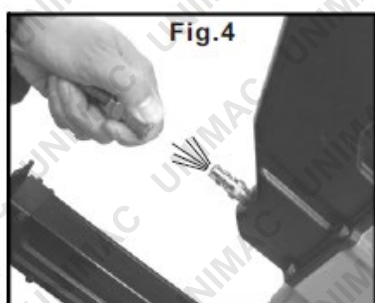

PRODUCT SPECIFICATIONS

MAXIMUM OPERATING AIR PRESSURE	100psi
MINIMUM OPERATING AIR PRESSURE	60psi
STAPLE CAPACITY	92
STAPLE LENGTH RANGE	25mm - 50mm (1" - 2")
STAPLE SIZE	15 - ½" Gauge
L-SHAPED NAIL CAPACITY	100
L-SHAPED NAIL LENGTH RANGE	37mm - 50mm (1 - ½" - 2")
L-SHAPED NAIL SIZE	16 Gauge
AIR INLET	¼" NPT
AIR CONSUMPTION	4.5 CFM
NET WEIGHT	11kg
CE, UL AND AUSTRALIAN C-TICK CERTIFICATIONS	

OPERATING INSTRUCTIONS

FOREWORD

This nailer is a heavy duty, 2 in 1 pneumatic flooring nailer. It is designed to install tongue and groove hardwood flooring with L-shaped nails or staples. Flooring in thicknesses of 1/2, 5/8, 3/4, and 25/32 can be installed using 1 - ½" and 2" length nails respectively.

POWER SOURCE

This tool is designed to operate on clean, dry, compressed air at regulated pressures between 70 and 120 PSI (Pounds per Square Inch). The preferred system would include a filter, a pressure regulator, and an automatic oiler located as close to the tool as possible (within 15 feet is ideal).

All compressed air contains moisture and other contaminants that are detrimental to internal components of the tool. An airline filter will remove most of these contaminants and significantly prolong the life of the tool. If an in-line oiler is not available, place 10 to 15 drops of Air Tool Oil into the tool's air inlet at the beginning of each workday.

IMPORTANT: Do not over lubricate the Nailer; excess oil mist or drops will be vented with spent air when over lubricated. Excess oil could stain the wood flooring, walls or furnishings. Dry-fire the nailer, without nails, to purge excess oil, before you begin nailing.

The tool is equipped with a ¼ male "quick connector". The tool must always be connected to the air supply with a coupling such that all pressure is removed from the tool when the coupling is disconnected.

WARNING: All airline components (hoses, connectors, filters, regulators, etc.) must have a minimum working pressure rating of 150 PSI (10.3BAR) or 150% of maximum system potential, whichever is higher.

100PSI PNEUMATIC 2 IN 1 NAILER

Do not connect this tool to a system with maximum potential.

Only connect tool to air supply with a coupling that will release all pressure from the tool when disconnected.

Disconnect tool from air supply before performing maintenance, clearing a jammed fastener, leaving the work area, handing the tool to another person, or making adjustments.

PREPARING THE TOOL

1. After reading and understanding this entire manual, connect tool to air supply. (See Figure 12).

WARNING: Keep tool pointed away from yourself and others at all times.

Always connect tool to air supply before loading fasteners.

Always wear Z87 approved safety glasses and hearing protection when preparing or operating the tool.

Never use a tool that leaks air or needs repair.

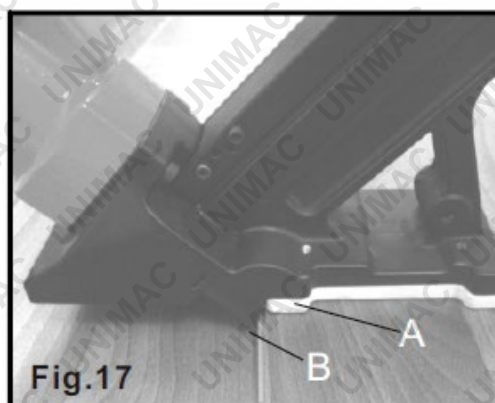

100PSI PNEUMATIC 2 IN 1 NAILER

2. Pull the movable magazine to up lock place. See Figure 13.
3. Put the strip of L-shaped nail or staple into fixed magazine. See Figure 14 and Figure 15.
4. Push the movable magazine forward until it is locked in place. See Figure 16.

USING THE TOOL

Complete all steps of [Preparing the Tool](#) before using the tool.

Position and closely fit the flooring strip with the mallet together. Position the tool on the tongued edge of the flooring strip (see Figure 17), aligning the driver guide against the front of the flooring strip.

Strike the rubber cap with the rubber mallet. The tool will then drive the staple or cleat at the correct 45 degree angle as shown in Figures 18 – 21. The proper length of flooring nail to use with various thicknesses of flooring is also shown in Figures 18 – 21.

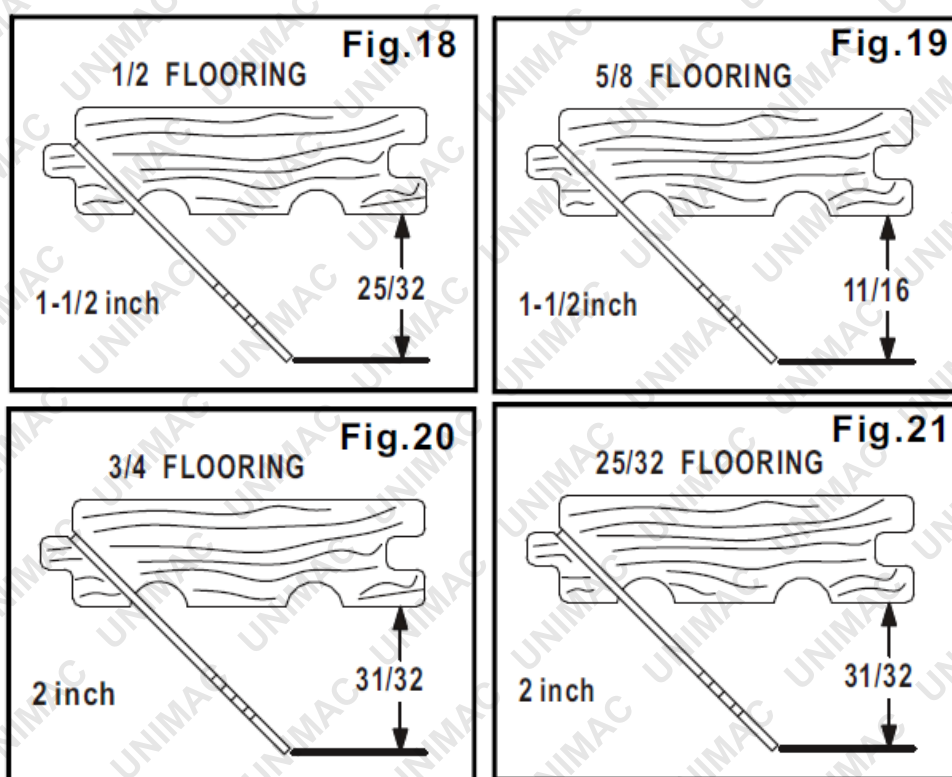

It is not necessary to hit the rubber cap hard to activate it. Never hit the tool with excessive force, as this will damage the tool.

DO NOT USE THE METAL END OF THE Mallet TO STRIKE THE RUBBER CAP; use the rubber end only.

NOTE: WHEN USING TOOL TO INSTALL PRE-FINISHED FLOORING

- This floor nailer was designed for installing both unfinished and pre-finished hardwood flooring. Care must be used however when installing pre-finished flooring to ensure that the finish is not damaged by the tool. It is recommended that the tool be inspected for damage, especially the base plate (A) (see Figure 17) and tested on a sample section to be certain that the tool and the technique used do not mar the finish. This procedure should be followed before each job due to variations in flooring and was designed for installing both unfinished and tool conditions.

100PSI PNEUMATIC 2 IN 1 NAILER

WARNING: Keep tool pointed in a safe direction at all times.

WARNING: Never attempt to drive a fastener into material that is too hard, the fastener can ricochet causing personal Injury.

WARNING: Disconnect tool from air supply before performing maintenance, clearing a jammed fastener, leaving the work area, moving tool to another location, handing the tool to another person or making adjustments.

CLEARING A JAMMED FASTENER

1. **CAUTION:** Disconnect tool from air supply. See Figure 22.
2. Remove any remaining fasteners from the nailer.
 - a. Pull the movable magazine to lock it in place. See Figure 23.
 - b. Remove any remaining fasteners from the nailer. See Figure 24.
3. Use the hex wrench to remove the three screws (A). See Figure 25.
4. Slide out the Driver Guide Plate and Gate assembly. See Figure 26.
5. Pull the Driver Guide Plate and Gate assembly apart and remove the Jammed Fastener. See Figure 27.
6. Replace the Driver Guide Plate and Gate with three screws.

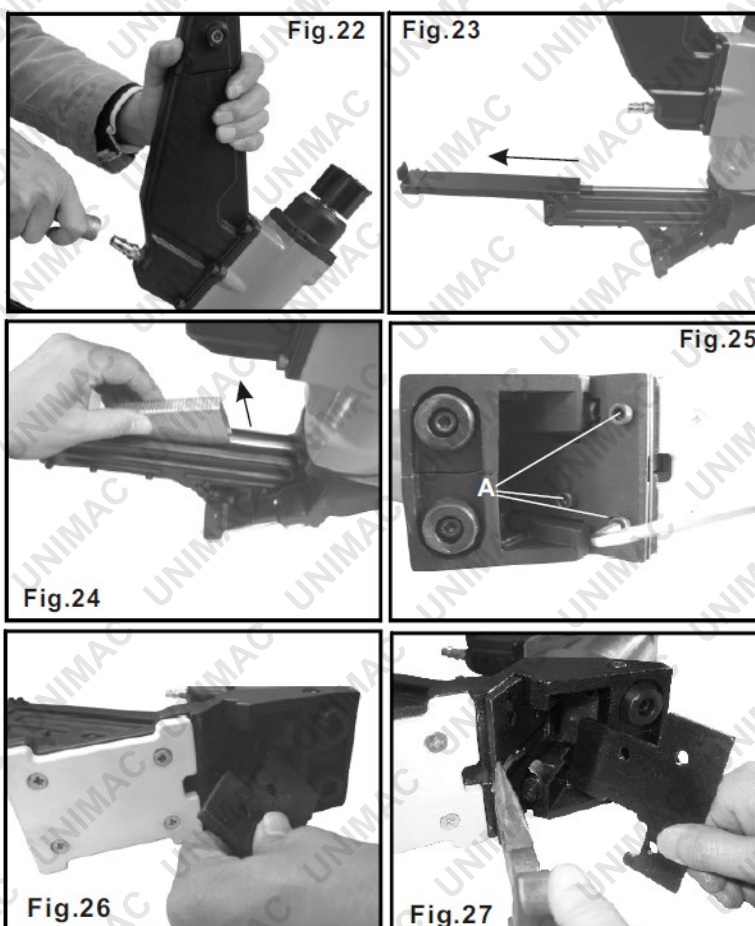

MAINTENANCE

CLEAN AND INSPECT DAILY

CAUTION: Disconnect tool from air supply before cleaning and inspection. Correct all problems before putting the tool back into use.

Wipe tool clean and inspect for wear or damage. Use non-flammable cleaning solutions to wipe exterior of tool only if necessary. **DO NOT SOAK** tool with cleaning solutions. Such solutions can damage internal parts.

Inspect mechanism to assure that the system is complete and functional; no loose or missing parts, no binding or sticking parts.

Keep all screws tight. Loose screws can cause personal injury and can damage tool.

If tool is used without an in-line oiler, place 10 or 15 drops of Air Tool Oil into the air inlet of the tool at the beginning of each workday.

IMPORTANT: Do not over-lubricate the nailer. Excess oil mist or drops will be vented with spent air when over-lubricated. Excess oil could stain materials. Purge excess oil first before you begin nailing.

SERVICE AND REPAIRS

All quality tools eventually require servicing or replacement of parts due to wear from normal use. Some user serviceable components are described in the [Troubleshooting](#) Section. All repairs must be done by a qualified person or service centre.

TROUBLESHOOTING

CAUTION: Disconnect tool from the air supply first before performing any troubleshooting procedures.

PROBLEMS	CAUSES	POSSIBLE SOLUTIONS
Air is leaking near the top of the tool.	<ul style="list-style-type: none"> Loose screws. Worn or damaged O-rings/seals. 	<ul style="list-style-type: none"> Tighten the screws. Install the "OVERHAUL" Maintenance Kit.
Tool does nothing or is operating sluggishly.	<ul style="list-style-type: none"> Inadequate air supply. Inadequate lubrication. Worn or damaged O-ring/seals. 	<ul style="list-style-type: none"> Verify that there is adequate air supply. Put 10 to 15 drops of oil into the air inlet. Install "DRIVER" Maintenance Kit. Install "OVERHAUL" Maintenance Kit.
Air is leaking near the bottom of the tool.	<ul style="list-style-type: none"> Loose screws. Worn or damaged O-rings or bumper. 	<ul style="list-style-type: none"> Tighten screws. Install "OVERHAUL" Maintenance Kit.
Tool is jamming frequently.	<ul style="list-style-type: none"> Incorrect fasteners. 	<ul style="list-style-type: none"> Verify for approved fasteners of correct size.

100PSI PNEUMATIC 2 IN 1 NAILER

PROBLEMS	CAUSES	POSSIBLE SOLUTIONS
	<ul style="list-style-type: none"> ▪ Damaged fasteners. ▪ Magazine or nose screws loose. ▪ Magazine is dirty. ▪ Pusher spring damaged. ▪ Driver is worn or damaged. 	<ul style="list-style-type: none"> ▪ Replace with undamaged fasteners. ▪ Tighten screws. ▪ Clean magazine. ▪ Replace spring. ▪ Install "DRIVER" Maintenance Kit.
Other problems		<ul style="list-style-type: none"> ▪ Contact your local service centre.

IN THE BOX

When unpacking, check to make sure that all the parts are included. If any parts are missing or broken, please contact the seller.

1X 2 in 1 UNIMAC Nailer/Stapler

1X S3 Hex Key

1X S4 Hex Key

1X S5 Hex Key

1X Wrench

1X Mallet

1X Base plate

1X Air tool oil

EXPLODED DRAWING OF PARTS

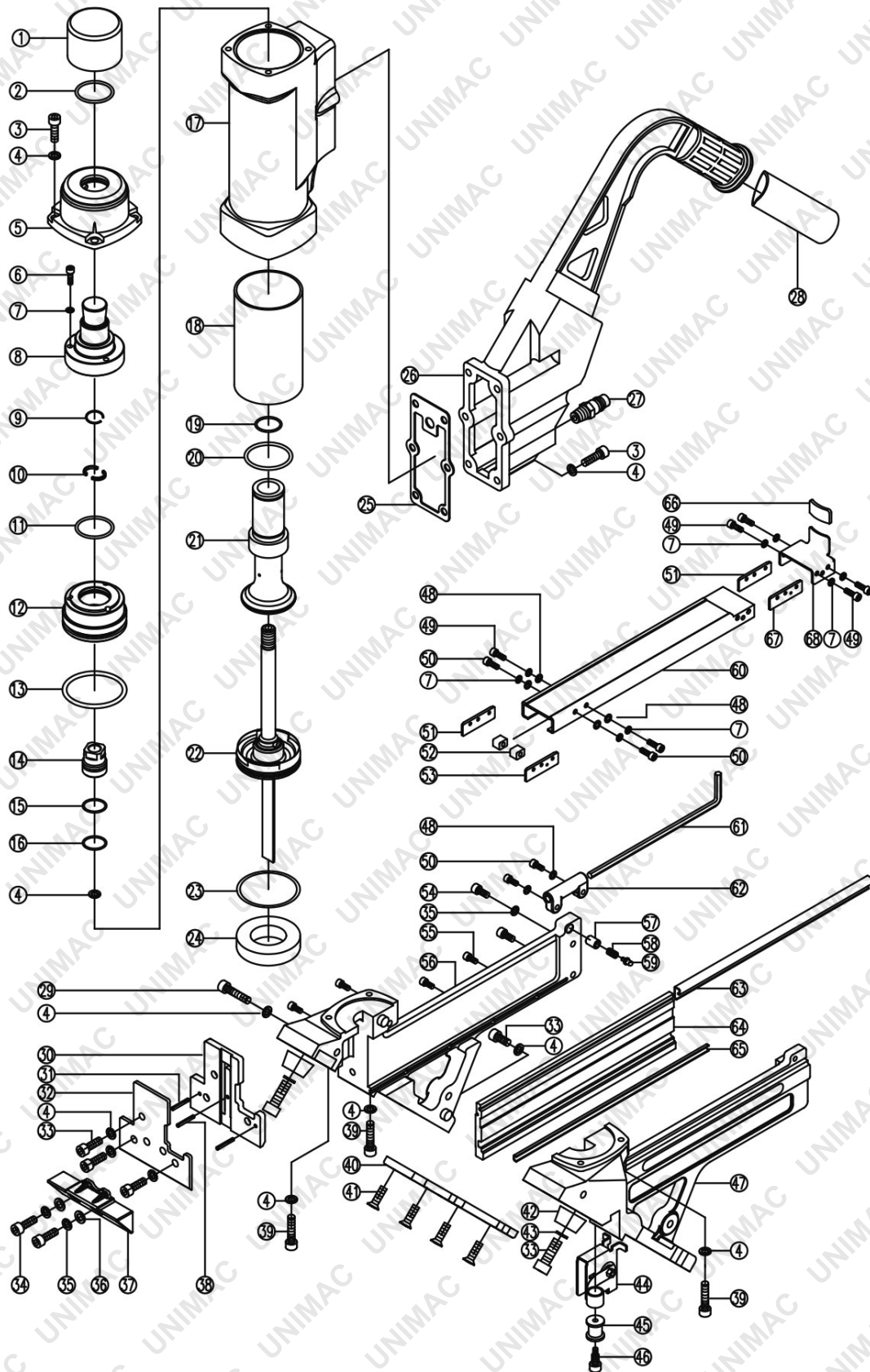

PARTS LIST

ITEM	DESCRIPTION
1	Rubber cap
2	O-ring 30.3 x 2.65
3	Screw
4	Spring washer
5	Cylinder cap
6	Screw
7	Spring washer
8	Actuator part A
9	Snap ring
10	Half block
11	O-ring 33.3 x 2.65
12	Actuator part B
13	O-ring 57.4 x 3.5
14	Plunger
15	O-ring 21 x 2
16	O-ring 14.2 x 2.5
17	Body
18	Cylinder
19	O-ring 17.5 x 2.6
20	O-ring 38.5 x 4.5
21	Poppet
22	Piston assembly
23	O-ring 58.7 x 3.5
24	Bumper
25	Seal
26	Arm
27	Air plug
28	Sleeve
29	Screw
30	Guide body
31	Pin
32	Front plate
33	Screw
34	Screw

ITEM	DESCRIPTION
35	Spring washer
36	Washer
37	Protect block
38	Pin
39	Screw
40	Base plate
41	Screw
42	Pad
43	Washer
44	Feeder assembly
45	Spring bracket
46	Screw
47	Fixed magazine A
48	Washer
49	Screw
50	Screw
51	Plate
52	Limit nut
53	Stopped plate A
54	Screw
55	Screw
56	Fixed magazine B
57	Bushing
58	Spring
59	Pin
60	Movable magazine
61	Hex key
62	Sheath
63	Rail A
64	Oriented plate
65	Rail B
66	Sleeve
67	Stopped plate B
68	Pull handle



Some experts believe that the incorrect or prolonged use of almost any product may cause serious injury or death. To help reduce your risk of serious injury or death, refer to the information below. For more information, see www.datastreamserver.com/safety

- | | |
|---|---|
| <ul style="list-style-type: none"> ▪ Consult all documentation, packaging and product labelling before use. Note that some products feature documentation available online. It is recommended to print and retain the documentation. ▪ Before each use, check the product for loose/broken/damaged/missing parts, wear or leaks (if applicable). Never use a product with loose/broken/damaged/missing parts, wear or leaks. ▪ Products must be inspected and serviced (if applicable) by a qualified technician every 6 months. This is based on average residential use by persons of average size and strength, and on a property of average metropolitan size. Use beyond these recommendations may require more frequent inspections/servicing. ▪ Ensure that all users of the product have completed a suitable industry recognised training course before being allowed access to the product. | <ul style="list-style-type: none"> ▪ The product has been supplied by a general merchandise retailer that may not be familiar with your specific application or description of application. Be sure to attain third-party approval from a qualified specialist for your application before use, regardless of any assurances from the retailer or its representatives. ▪ This product is not intended for use where fail-safe operation is required. As with any product (for example, automobile, computer, toaster), there is the possibility of technical issues that may require the repair or replacement of parts, or the product itself. If the possibility of such failure and the associated time it may take to rectify could in any way inconvenience the user, business or employee, or financially affect the user, business or employee, then the product is not suitable for your requirements. This product is not intended for use where incorrect operation or a failure of any kind, including but not limited to, a condition requiring product return, replacement, parts replacement or service by a technician may cause financial loss, loss of employee time or an inconvenience requiring compensation. ▪ If this product has been purchased in error when considering the information presented here, contact the retailer directly for details of their returns policy, if required. |
|---|---|



©2017 Unimac. All rights reserved. No part of this document, including descriptive content, concepts, ideas, diagrams or images may be reproduced or transmitted in any form or by any means, electronic or mechanical, including photocopying, scanning or recording, or any information storage and retrieval system, without express permission or consent from the publisher.