

Bäumr-AG

TORNADO SERIES

660EX	670EX
690SX	700SX
760SX	770SX
890SX	880SX

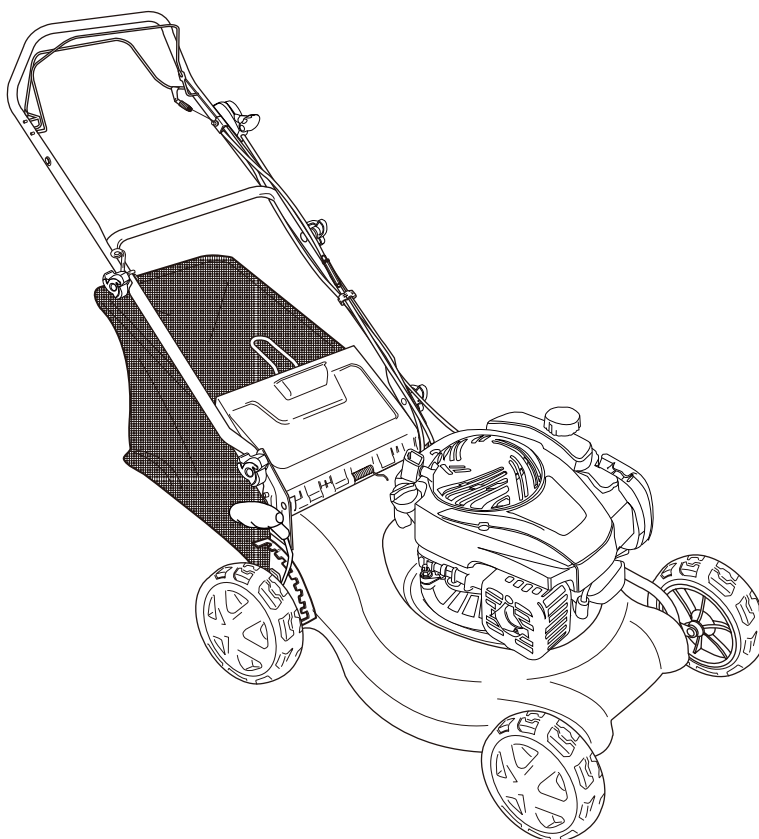

SAFETY AND OPERATING MANUAL

THIS PRODUCT IS NOT FOR PROFESSIONAL USE
WARNING! Read the instructions before using the product.





Read the safety warnings before use

EASY STARTING GUIDE

CONNECT HANDLE BARS

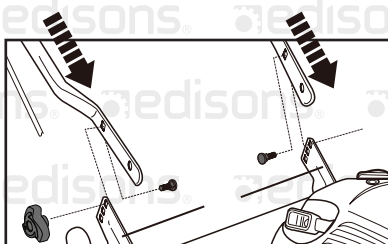

Tighten using the knobs and ensure the wires are on the upper side of the handle bars.

FOLD BLADES OUTWARDS



IMPORTANT! Pull the blades to the right as the blade is very sharp on one side.

ADD ENGINE OIL



Fill on a flat surface to the indicated level.

ADD FUEL



Fill with clean, fresh Unleaded Petrol (Minimum 95+) on a level surface.

CHOKE

If equipped –move choke to “cold” position.

PRIMER

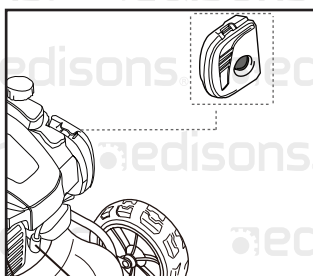

Use the primer (if equipped) when starting the product with a cold engine.

BRAKE BAR

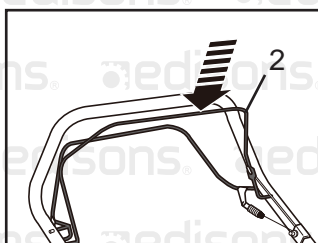

Push the brake bar (2) (if equipped) down towards the handle and hold it in position when starting.

RECOIL STARTER

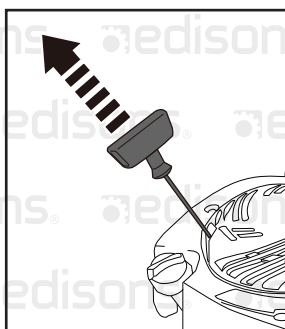

Pull on the handle to start the engine.

DRIVE BAR

Pull the drive bar (3) (if equipped) up towards the handle to engage self-propel feature (if equipped).

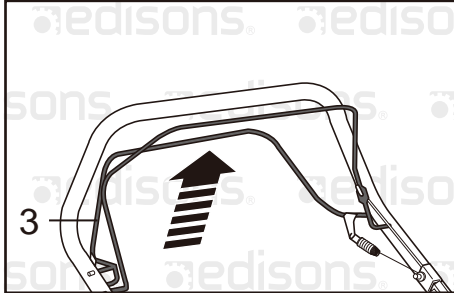

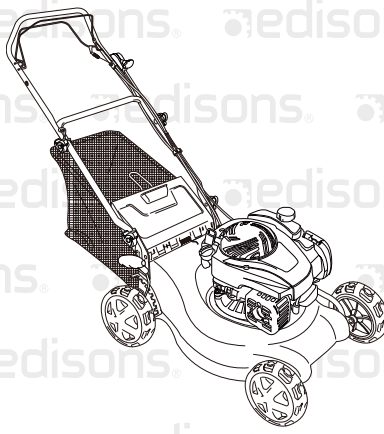

INTRODUCTION

Congratulations on your purchase of this product. This product should give you reliable service but for your peace of mind this product does carry a 1 year guarantee, the terms of which are detailed below.

If this product develops a fault within the guarantee period contact your retailer.

Please retain this handbook in case you need to refer to safety, care or guarantee information in the future.

CONTENTS

Introduction	2
Safety warnings	3
Product description	12
Technical data	14
Intended use	16
Set up	16
Product functions	22
Operation instructions	26
Maintenance and care	28
Trouble shooting	32
Guarantee	35
Declaration of conformity	36

SAFETY WARNINGS

1. This product is not intended for use by persons (including children) with reduced physical, sensory or mental capabilities, or lack of experience and knowledge, unless they have been given supervision or instruction concerning use of the product by a person responsible for their safety.
2. Children should be supervised to ensure that they do not play with the product.

Petrol powered lawnmowers safety warnings

IMPORTANT READ CAREFULLY BEFORE USE.

KEEP FOR FUTURE REFERENCE.

1. Training

1. Read the instructions carefully. Be familiar with the controls and the proper use of the product.
2. Never allow children or people unfamiliar with these instructions to use the product. Local regulations can restrict the age of the operator.
3. Never mow while people, especially children, or pets are nearby.
4. Keep in mind that the operator or user is responsible for accidents or hazards occurring to other people or their property.

2. Preparation

1. While mowing, always wear substantial footwear and long trousers. Do not operate the product when barefoot or wearing open sandals.
2. Thoroughly inspect the area where the product is to be used and remove all objects which can be thrown by the product.
3. **WARNING - Petrol is highly flammable.**

Store fuel in containers specifically designed for this purpose.

Refuel outdoors only and do not smoke while refuelling.

Add fuel before starting the engine. Never remove the cap of the fuel tank or add petrol while the engine is running or when the engine is hot.

If petrol is spilled, do not attempt to start the engine but move the product away from the area of spillage and avoid creating any source of ignition until petrol vapours have dissipated.

Replace all fuel tank and container caps securely.

4. Replace faulty silencers.
5. Before using, always visually inspect to see that the cutting devices, cutting device bolts and cutter assembly are not worn or damaged. Replace worn or damaged cutting devices and bolts in sets to preserve balance.
6. On multi-bladed machines, take care as rotating one cutting device can cause other cutting devices to rotate.
7. CAUTION! Do not touch rotating cutting device.

3. Operation

1. Do not operate the engine in a confined space where dangerous carbon monoxide fumes can collect.
2. Mow only in daylight or in good artificial light.
3. Avoid operating the product in wet grass, where feasible.
4. Always be sure of your footing on slopes.
5. Walk, never run.
6. Mow across the face of slopes, never up and down.
7. Exercise extreme caution when changing direction on slopes.
8. Do not mow excessively steep slopes.
9. Use extreme caution when reversing or pulling the product towards you.
10. Stop the cutting device(s) if the product has to be tilted for transportation when crossing surfaces other than grass, and when transporting the product to and from the area to be mowed.
11. Never operate the product with defective guards, or without safety devices, for example deflectors and/or grass catchers, in place.
12. Do not change the engine governor settings or overspeed the engine.
13. Disengage all cutting device and drive clutches before starting the engine.
14. Start the engine or switch on the engine carefully according to instructions and with feet well away from the cutting device(s).

15. Do not tilt the product when starting the engine or switching on the engine, except if the product has to be tilted for starting. In this case, do not tilt it more than absolutely necessary and lift only the part which is away from the operator.
16. Do not start the engine when standing in front of the discharge chute.
17. Do not put hands or feet near or under rotating parts. Keep clear of the discharge opening at all times.
18. Never pick up or carry a product while the engine is running.
19. Stop the engine and disconnect the spark plug connector, make sure that all moving parts have come to a complete stop and, where a key is fitted remove the key:
 - before clearing blockages or unclogging chute,
 - before checking, cleaning or working on the product,
 - after striking a foreign object. Inspect the product for damage • and make repairs before restarting and operating the product,
 - if the product starts to vibrate abnormally (check immediately).
20. Stop the engine and disconnect the spark plug connector, make sure that all moving parts have come to a complete stop and, where a key is fitted remove the key:
 - whenever you leave the product,
 - before refuelling.
21. Reduce the throttle setting during engine shut down and, if the engine is provided with a shut-off valve, turn the fuel off at the conclusion of mowing.
22. Go slow when using a trailing seat.
23. Never touch the exhaust, exhaust guard or cooling fins when the engine is hot.
24. Never carelessly touch the product, you can burn yourself. While the product is in operation or shortly thereafter, its parts such as the exhaust pipe, engine, and other surfaces are extremely hot! Pay attention to the markings on the product.
25. Make sure that the air intake of the combustion engine is clear. Keep the air intake free of dust, dirt particles, gases and fumes. Keep hands and feet away from the cutting device at all times and especially when switching on the engine.

4. Maintenance and storage

1. Follow the maintenance and repair instructions for this product. Never carry out any modifications of the product. Never change the preset rotary speed or the engine and product settings. Information about maintenance and repair is provided in this user manual.
2. Keep all nuts, bolts and screws tight to be sure the product is in safe working condition.
3. Never store the product with petrol in the tank inside a building where fumes can reach an open flame or spark.
4. Allow the engine to cool before storing in any enclosure.
5. Keep the engine, silencer and petrol storage area free of grass, leaves, or excessive grease to reduce the fire hazard.
6. Check the grass catcher frequently for wear or deterioration.
7. Replace worn or damaged parts for safety.
8. If the fuel tank has to be drained, this should be done outdoors.
9. Wear strong work gloves when removing and re-assembling the cutting device.
10. Always replace worn or faulty parts with the genuine parts.

5. Fuel handling

1. Always switch the product off and let it cool down, before refuelling it. Petrol is highly flammable. Never smoke when you are refuelling the product. Do not refuel the product, if there is an open fire in the vicinity!
2. Always use suitable aids such as funnels and filler necks. Do not spill any fuel on the product or its exhaust system. There is a risk of ignition. However, if fuel should be spilled, then you must remove it carefully from all parts of the product. Any residue which may be present must be completely removed, before the product is operated!
3. Exhaust gases and fuel fumes are noxious. Fuel fumes can ignite. Never use the product in environments where there is a risk of explosion.
4. Never breathe in any fuel fumes, when you are refuelling the product. Never fill the tank in enclosed spaces, such as basements or sheds. There is a risk of poisoning and explosion!
5. Avoid skin contact with petrol.

6. Do not eat or drink, while you are refuelling the product. If you have swallowed petrol or oil, or if petrol or oil has got into your eyes, then seek medical advice immediately.
7. Close the tank lid immediately after filling the tank. Make sure that it is properly closed.
8. Never use the product without an air filter.

6. Vibration and noise reduction

To reduce the impact of noise and vibration emission, limit the time of operation, use low-vibration and low-noise operating modes as well as wear personal protective equipment.

Take the following points into account to minimize the vibration and noise exposure risks:

1. Only use the product as intended by its design and these instructions.
2. Ensure that the product is in good condition and well maintained.
3. Use correct application tools for the product and ensure they in good condition.
4. Keep tight grip on the handles/gripping surface.
5. Maintain this product in accordance with these instructions and keep it well lubricated (where appropriate).
6. Plan your work schedule to spread any high vibration tool use across a longer period of time.
7. Wear ear protection.

7. Emergency

Familiarise yourself with the use of this product by means of this instruction manual. Memorise the safety directions and follow them to the letter. This will help to prevent risks and hazards.

1. **Always be alert when using this product, so that you can recognise and handle risks early.** Fast intervention can prevent serious injury and damage to property.
2. **Stop the engine and disconnect the spark plug connector if there are malfunctions.** Have the product checked by a qualified professional and repaired, if necessary, before you operate it again.
3. **In case of fire stop the engine and disconnect the spark plug connector.**

Take fire-extinguishing measures immediately if the product switch is no longer accessible.



WARNING! Never use water to extinguish a product on fire. Burning fuel must be extinguished with special extinguishing agents! We recommend that you keep a suitable fire extinguisher within reach in your work area!

8. Residual risks

Even if you are operating this product in accordance with all the safety requirements, potential risks of injury and damage remain. The following dangers can arise in connection with the structure and design of this product:

1. Health defects resulting from vibration emission if the product is being used over long periods of time or not adequately managed and properly maintained.
2. Injuries and damage to property due to broken application tools or the sudden impact of hidden objects during use.
3. Danger of injury and property damage caused by flying objects.
4. Burns, if touching hot surfaces.



WARNING! This product produces an electromagnetic field during operation! This field may under some circumstances interfere with active or passive medical implants! To reduce the risk of serious or fatal injury, we recommend persons with medical implants to consult their doctor and the medical implant manufacturer before operating this product!

9. Symbols

On the product, the rating label and within these instructions you will find among others the following symbols and abbreviations. Familiarise yourself with them to reduce hazards like personal injuries and damage to property.

kW	Kilowatt
cm ³	Cubic centimetre
min ⁻¹	per minute
mm	Millimetre
kg	Kilogram

dB(A)

Decibel (A-rated)

m/s²

Metres per second squared

l

Litre



Lock / to tighten or secure



Unlock / to loosen



Caution / Warning.



Read the instruction manual.



Wear hearing protection.



Wear eye protection.



Wear respiratory protection.



Wear protective gloves.



Wear safety footwear.



Wear tight-fitted protective clothes.



Do not expose to rain or wet conditions.



Open flames in the work area, around the product and in the vicinity of flammable materials are prohibited!



Do not smoke in the work area, around the product and in the vicinity of flammable materials!



Risk of fire / flammable materials



Hot surface, do not touch. High temperatures on the product's surfaces and structural parts that could cause burns, if they are touched. The product can also stay hot for a longer period of time after operation!



This product produces noxious exhaust fumes. If the product is used improperly, these fumes can lead to poisoning, a loss of consciousness or death!



Only refuel unleaded petrol!



Add engine oil



Check and refill oil.



Switch the engine off while you are refilling the tanks!



Switch the product off and disconnect the spark plug connector before assembly, cleaning, adjustments, maintenance, storage and transportation.



Mow across the face of slopes, never up and down.



Inspect the area where the product is to be used and remove all objects which can be thrown by the product.

If objects are hidden while operating stop the engine and remove the object.

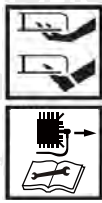

Keep hands and feet away from sharp rotating parts – danger of injury! When cleaning, repairing, or inspecting, make certain the cutting device and all mowing parts have stopped. Disconnect the spark plug cap, and keep the cap away from the plug to prevent accidental starting.



Cutting device continues to rotate after the product is switched off. Wait until all machine components have completely stopped before touching the product.



Pay special attention when working on the cutting device!



Objects thrown by the product could hit the user or other bystanders. Always ensure that other people and pets remain at a safe distance from the product when it is in operation. In general, children must not come near the area where the product is.



Maximum speed



Minimum speed



Engine manual start; Recoil starter



Guaranteed sound power level value in dB



The product complies with the applicable European directives and an evaluation method of conformity for these directives was done.



PRODUCT DESCRIPTION

(Appearance may differ slightly)

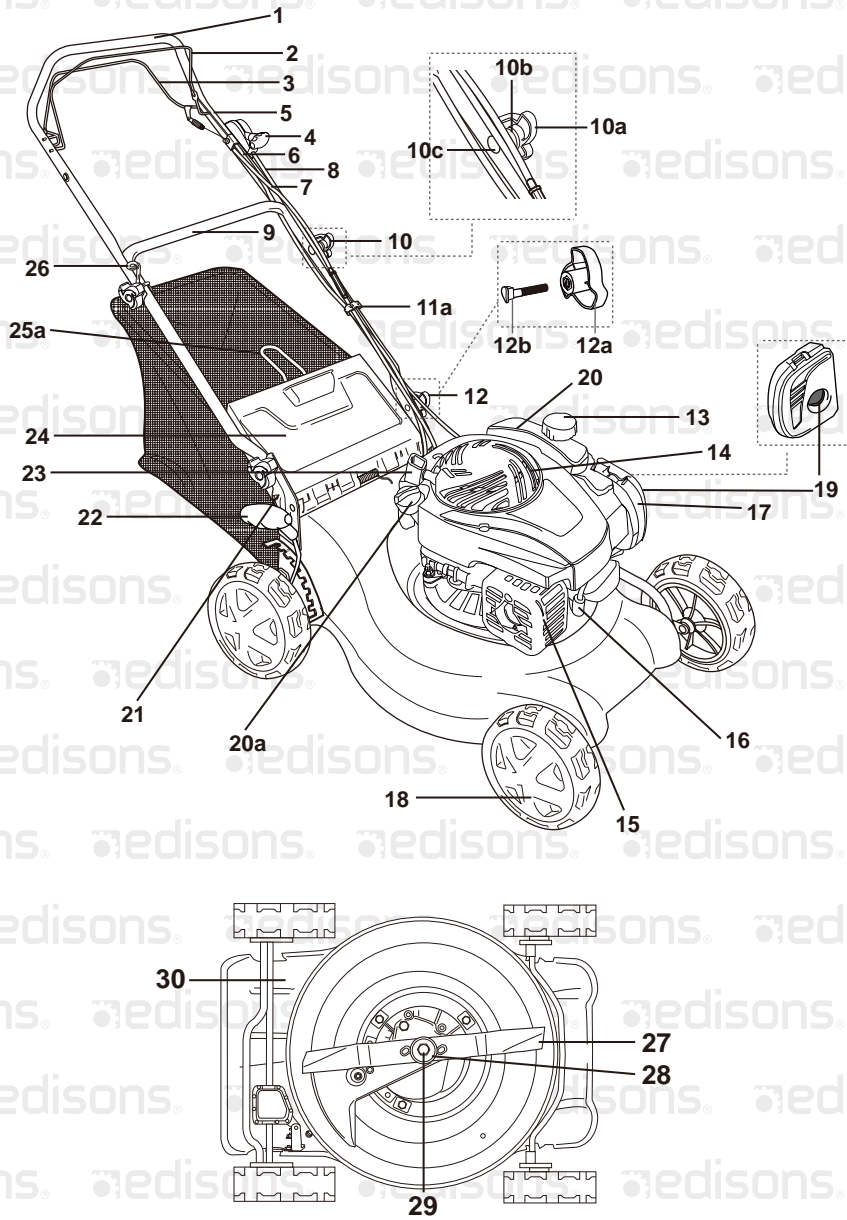

1.	Handle
2.	Brake bar
3.	Drive bar
4.	Throttle lever
5.	Upper handle bar
6.	Brake wire
7.	Drive wire
8.	Throttle wire
9.	Lower handle bar
10.	Mounting set (x 2) a. Knob b. Washer c. Bolt
11.	Wire clip (x 2), pre-assembled a. triplex clip
12.	Mounting set (x 2) a. Knob b. Bolt
13.	Oil tank cap
14.	Air vents
15.	Muffler
16.	Spark plug connector
17.	Air filter case
18.	Wheel
19.	Primer
20.	Fuel tank a. Cap

21.	Handle support
22.	Lever for cutting height adjustment
23.	Recoil starter handle
24.	Deflector guard
25.	Grass catcher
a.	Handle
26.	Rope guide
27.	Cutting device (blade)
28.	Locking flange
29.	Hex bolt
30.	Rear discharge chute

INTENDED USE

The product is intended for mowing grass in domestic gardens only. It must not be used to mow unusually high, dry or wet grass, e.g. pasture grass; for shredding leaves or mulching.

For safety reasons it is essential to read the entire instruction manual before first operation and to observe all the instructions therein.

This product is intended for private domestic use only, not for any commercial trade use. It must not be used for any purposes other than those described.

SET UP

1. Unpack



NOTE: The product is heavy, ask another person for assistance if required.

1. Unpack all parts and lay them on a flat, stable surface.
2. Remove all packing materials and shipping devices if applicable.
3. Make sure the delivery contents are complete and free of any damage. If you find that parts are missing or show damage do not use the product but contact your dealer. Using an incomplete or damaged product represents a hazard to people and property.
4. Ensure that you have all the accessories and tools needed for assembly and operation. This also includes suitable personal protective equipment.



WARNING! The product must be fully assembled before operation! Do not use a product that is only partly assembled or assembled with damaged parts!



Follow the assembly instructions step-by-step and use the pictures provided as a visual guide to easily assemble the product!

Disconnect the spark plug connector (16) from the spark plug!



NOTE: Take care of small parts that are removed during assembly or when making adjustments. Keep them secure to avoid loss.

2. Handle bars

1. Remove the mounting sets **(12)** from the handle support **(21)** and keep them handy.
2. Ensure that the locking knobs **(10a)** are loose and unfold the upper **(5)** and lower handle bar **(9)**.
3. Make sure the wires **(6, 7, 8)** run on the upper side of the handle bars **(5, 9)**.
4. Lay the upper **(5)** and lower handle bar **(9)** on a stable, even surface. Tighten the locking knobs **(10a)**.
5. Align the lower handle bar **(9)** with the support **(21)**. Make sure the holes in the lower handle bar are aligned with those in the support (Fig. 1).

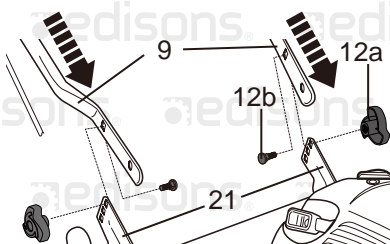

IMPORTANT

Blades

If your mower features the Cross Cut (four blade design) pull them to the right to the outward position (the left side of the blade is very sharp). (Fig. 1a)

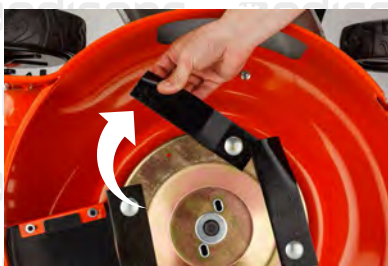

Fig. 1b

6. For handle height adjustment there are three holes in the support. Secure the lower handle bar with the mounting sets **(12)** according to your handle bar

height preference (Fig. 2).

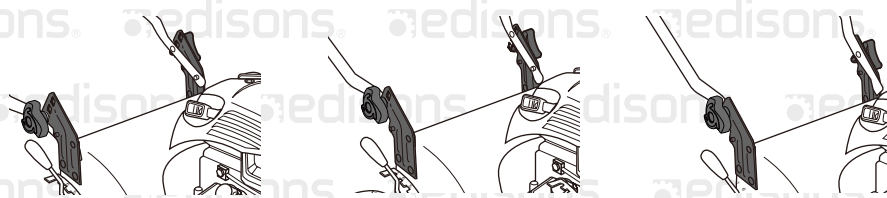

Fig. 2

7. Fix the wires **(6, 7, 8)** with the wire clips **(11a, 11b)** to the lower handle bar **(9)** (Fig. 3).

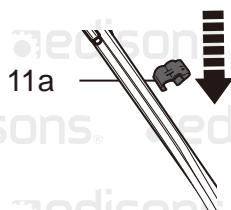

Fig. 3

8. Grass catcher

- Open the deflector guard **(24)** hold it in position and align the hooks on the grass catcher **(25)** with the support to hang it onto it (Fig. 4).

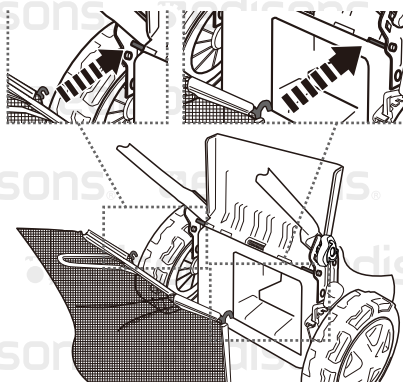

Fig. 4

9. Fuel and engine oil

This product is equipped with a 4-stroke engine. Before operation you have to add proper fuel and engine oil.



WARNING! This product contains an instruction manual of the engine. It is important to read and understand these instructions of the engine and the equipment.

SAVE THESE ORIGINAL INSTRUCTIONS FOR FUTURE REFERENCE.

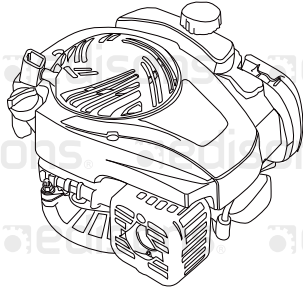

Fig. 5

1. Place the product on a stable, level surface. We recommend laying a non-flammable sheet under the product.
2. Use proper funnels. Avoid spilling and overfilling the tanks.



WARNING! Fuel and oil are highly inflammable! Fumes will explode if lit! Ensure that there are no naked flames around the product! Do not smoke while filling fuel and oil!



3. Always dispose fuel, used oil and objects contaminated with them in accordance with local regulations.

Fuel



WARNING! This product is not supplied with fuel! Before operating this product it is essential to fill it with fuel!



1. Always use clean, fresh unleaded petrol. Purchase fuel in quantities that can be used within 30 days.
2. Never mix oil with petrol. Avoid getting dirt, dust or water in the fuel tank.
3. Unscrew and remove the fuel tank cap (20a).
4. Add correct fuel into the tank. Leave a minimum 5 mm of space between the top of the fuel and the inside edge of the tank to allow for expansion (Fig. 6).

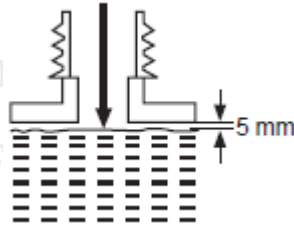

Fig. 6



NOTE: Petrol deteriorates over time. It may be difficult to start the engine if you use petrol which has been kept for more than 30 days.

Towards the end of the season, it is advisable to put only as much fuel in the tank as you need for each use, since it should be completely used up before storing the product.

Always empty the fuel tank when storing the product for over 30 days.

5. Wipe any spilled fuel with a soft cloth and reattach the fuel tank cap (20a).

Engine oil



WARNING! This product is not supplied with oil. However, for manufacturing reasons it is possible that a small quantity may be in the engine! Before operating this product it is essential to fill it with proper oil (see "Technical specifications")!



1. Unscrew and remove the oil tank cap (13).
2. Gradually add good-quality engine oil. Allow the oil to settle.
3. Check the oil level frequently while filling. Wipe the oil dipstick clean; refit and tighten the filler cap and then remove it again. The oil level must be between

the “**ADD**” and “**FULL**” marking. Add more oil if necessary. Do not overfill (Fig. 7).

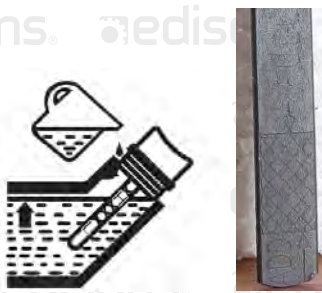

Fig. 7

4. Wipe spilled oil with a soft cloth and reattach the oil tank cap (13).

PRODUCT FUNCTIONS

1. Grass catcher

Always attach the grass catcher when using this product.

Emptying

Empty the grass catcher (25) frequently during use. Do not wait until it is completely full. We recommend emptying it when it is half full.



NOTE: A full grass catcher will reduce the performance of this product.

1. Lift the rear deflector guard (24) and pull the grass catcher (25) off the rods to remove it.
2. Empty the grass clippings onto a compost heap.
3. Re-fit the grass catcher (25) to the product.



WARNING! Do not attempt to use the product without the grass catcher attached when collecting grass – danger of flying objects!

Switch the engine off and wait that the blade had come to a complete stop before removing the grass catcher!

2. Cutting height adjustment

Adjust the cutting height according to the needs of your lawn. The cutting height depends on the kind of lawn and its actual height. When mowing high grass, start with the maximum cutting height and make a second cut with lower cutting height.

1. Pull the lever (22) towards the wheel, then move it forward or backward to adjust the cutting height (Fig. 8).

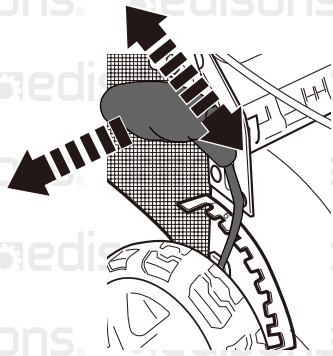

Fig. 8



WARNING! Ensure that the lever engages between two of the prongs!

3. Primer

Use the primer (19) when starting the product with cold engine (Fig. 9).

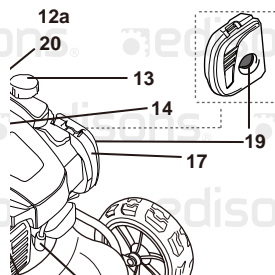

Fig. 9

4. Recoil starter

The recoil starter handle (23) is positioned at the rear of the engine.

1. Slowly pull on the recoil starter handle (23) and fit it into the rope guide (26) on the right hand side of the upper handle (5) during operation (Fig. 10). Do not remove the recoil starter from the rope guide.

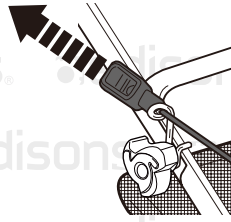

Fig. 10

2. Pull on the recoil starter handle (23) to start the engine (Fig. 11).

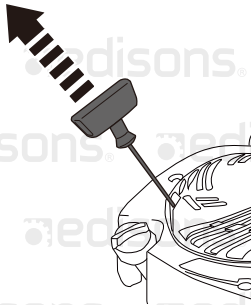

Fig. 11



WARNING! Never twist the starter rope around your hand! Only pull on the handle!



WARNING! Do not suddenly release the recoil starter handle! Allow the rope to return slowly and in a controlled manner each time it is pulled!

5. Brake bar

1. Pull the brake bar (2) towards the handle (1) and hold it in position when starting the engine. Keep it squeezed during operation (Fig. 12).
2. Release the brake bar (2) to stop the engine.

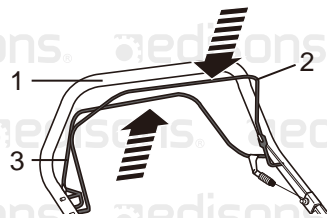

Fig. 12

6. Drive bar (self-propelled function IF EQUIPPED)

Use the self-propelled function as assistance during operation; the rear wheels are automatically driven by the engine; you do not need to push the product manually.

1. Pull the drive bar **(3)** towards the handle **(1)** to engage the wheels.
2. Release the drive bar **(3)** to disengage the wheels.

7. Throttle lever

The throttle lever **(4)** is located on the left side of the upper handle bar **(5)**. It is used to control the engine speed.

1. Move the throttle lever **(4)** downward for starting (Fig. 13).
2. Move the throttle lever **(4)** upward to run position  (middle position of throttle control) (Fig. 14).

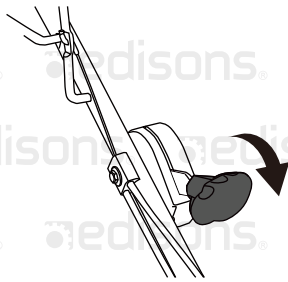

Fig. 13

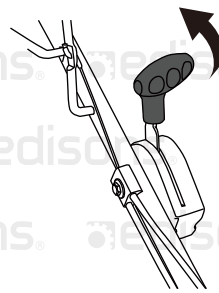

Fig. 14

OPERATION INSTRUCTIONS

1. General

1. Check the product as well as accessories for damage before each use. Do not use the product if it is damaged or shows wear.
2. Double check that accessories or application tools are properly fixed.
3. Check the fuel and oil level, refill if necessary.
4. Always push the product on its handle. Keep the handle dry and free from lubricant to ensure safe support.
5. Ensure that the air vents are always unobstructed and clear. Clean them if necessary with a soft brush. Blocked air vents may lead to overheating and damage the product.
6. Switch the product off immediately if you are disturbed while working by other people entering the working area. Always let the product come to complete stop before putting it down.
7. Do not overwork yourself. Take regular breaks to ensure you can concentrate on the work and have full control over the product.



WARNING! In some countries regulations define at what time of the day and on what special days products are allowed to be used and what restrictions apply! Ask your community for detailed information and observe the regulations in order to preserve a peaceful neighbourhood and avoid committing administrative offences! (not applicable for UK)

2. Starting/Stopping

Cold start

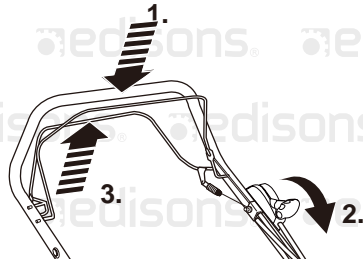



Fig. 15

1. Stand behind the handle **(1)**.
2. Press the primer **(19)** three times.
3. Pull the brake bar **(2)** against the handle **(1)**, hold it in position during operation (Fig. 15, 1.).
4. Move the throttle lever **(4)** downward to the start position (Fig. 15, 2.).
5. Pull the recoil starter **(23)** lightly until you feel resistance then pull it quickly until the engine starts.
6. Pull the drive bar **(3)** towards the handle **(1)** to use the self-propelled function for assistance if required (Fig. 15, 3.).

Warm start

1. Stand behind the handle **(1)**.
2. Pull the brake bar **(2)** against the handle **(1)**, hold it in position during operation (Fig. 15, 1.).
3. Move the throttle lever **(4)** downward to the start position (Fig. 15, 2.).
4. Pull the recoil starter **(23)** lightly until you feel resistance then pull it quickly until the engine starts.
5. Pull the drive bar **(3)** towards the handle **(1)** to use the self-propelled function for assistance if required (Fig. 15, 3.).

Stopping

1. Release the drive bar **(3)** to stop the self-propelled function.
2. Move the throttle lever upward to idle speed position  (Fig. 16). Let the engine run at idle speed for 10-15 seconds.

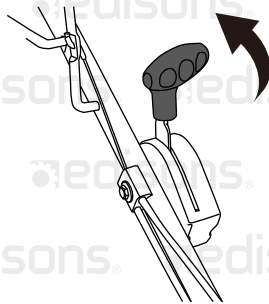

Fig. 16

3. Release the brake bar **(2)** to stop the engine.

3. Mowing

1. Make sure that the lawn is clear of stones, sticks, wire or other objects that could damage the product or its engine.
2. Do not cut wet grass because it tends to stick to the underbody of the product, preventing the proper discharge of grass clippings, and it could also cause you to slip and fall.
3. Never cut off more than one-third of the total length of the grass for a healthy lawn. In the autumn, lawns should only be cut as long as there is growth.
4. Slowly push the product forward. You may want to use the self-propelled function for assistance.
5. Mow in slight overlapping rows. The most effective pattern for mowing lawns is straight lines along one of the sides. This will keep the rows even and ensures that all the lawn is cut without missing any spots (Fig. 17).

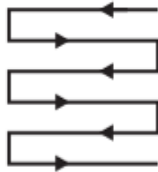

Fig. 17

6. Circle around flower beds. When reaching a flower bed in the middle of the lawn, cut a row or two around the circumference of the bed.
7. Pay special attention when changing direction.
8. Empty the grass catcher regularly.



WARNING! If the product strikes a foreign object stop the engine! Disconnect the spark plug connector, let the product cool down and thoroughly inspect the product for damage! Have any damage repaired before restarting!

Extensive vibration of the product during operation is an indication of damage! The product should be promptly inspected and repaired!

4. After use

1. Switch the product off, disconnect the spark plug connector and let it cool down.
2. Check, clean and store the product as described below.

MAINTENANCE AND CARE



WARNING! Always switch the product off, disconnect the spark plug connector and let the product cool down before performing inspection, maintenance and cleaning work!



1. Keep the product clean. Remove debris from it after each use and before storage.
2. Regular and proper cleaning will help ensure safe use and prolong the life of the product.
3. Inspect the product before each use for worn and damaged parts. Do not operate it if you find broken and worn parts.



WARNING! Only perform repairs and maintenance work according to these instructions! All further works must be performed by a qualified specialist!

1. General cleaning

1. Clean the product with a slightly damp cloth and mild soap. Use a brush for areas that are hard to reach.
2. In particular clean the air vents **(14)** after every use with a cloth and brush.
3. Remove stubborn dirt with high pressure air (max. 3 bar).



NOTE: Do not use chemical, alkaline, abrasive or other aggressive detergents or disinfectants to clean this product as they might be harmful to its surfaces.

4. Check for any damage and wear. Repair damages in accordance with this instruction manual or take it to an authorised service centre before using the product again.

2. Underbody and cutting device



WARNING! Wear safety gloves when working on the cutting device and close to it! Use proper tools to remove debris, e. g. a wooden stick! Never use your bare hands!



Always use original spare parts for replacement. The cutting device must be replaced by an identification no. ref. 65112-000041A. Do not attach any other type of cutting device!

The replacement of the cutting device should be done by a qualified specialist! Rework or sharpening blades is not recommended unless it is done by a repair service or a similarly qualified specialist!



NOTE: We strongly recommend jacking the product up when performing inspection and work on the cutting device. Avoid tilting the product in order to prevent fuel and oil leakages.

1. Keep the underbody and cutting device **(27)** clean and free of debris. Remove clippings from the discharge chute **(30)**.
2. Check all nuts and bolts periodically for tightness before operation. After prolonged use, especially in sandy soil conditions, the cutting device will become worn and lose some of the original shape. The cutting efficiency will be reduced and the cutting device should be replaced.
3. Keep the cutting device **(27)** sharp to ensure a good cutting performance. Replace a worn or damaged cutting device with a new one of the same type or have it sharpened by a qualified specialist.

3. Grass catcher

1. Inspect the grass catcher **(25)** before each use. Do not use it if you find any damage.
2. Clean the grass catcher **(25)** after operation using water and mild soap.
3. Let the grass catcher dry thoroughly before storing to avoid mildew.

4. Wires

Check the performance of the wires **(6, 7, 8)** before each use. Ask a qualified specialist to adjust it if necessary.



WARNING! Do not use the product with defective or loose wires!

5. Repair

This product does not contain any parts that can be repaired by the consumer. Contact an authorised service centre or a similarly qualified person to have it checked and repaired.

6. Storage

1. Clean the product as described above.
2. Store the product and its accessories in a dry, frost-free place.
3. Always store the product in a place that is inaccessible to children. The ideal storage temperature is between 10 and 30°C.
4. We recommend using the original package for storage or covering the product with a suitable cloth or enclosure to protect it against dust.
5. Empty the tank if you are not going to use the product for an extended period of time (more than 3 months) and before storing it for the winter.

7. Transportation

1. Switch the product off and disconnect the spark plug connector before transporting it anywhere.

2. Attach transportation guards, if applicable.
3. Always transport the product by its handle.
4. Protect the product from any heavy impact or strong vibrations which may occur during transportation in vehicles.
5. Secure the product to prevent it from slipping or falling over, loss of fuel, damage and injury.

8. Environmental protection

1. Old products are potentially recyclable and do not, therefore, belong in your household rubbish. You are requested to assist us and our contribution to saving resources and protecting the environment by handing in this appliance at an equipped collection centre (if there is one available).
2. Petrol, oil, used oil, mixtures of oil and petrol and objects contaminated with oil, e.g. cleaning cloths; do not belong with household waste. Dispose of oil-contaminated items in accordance with the local guidelines and hand them in at recycling centres
3. The product comes in a package that protects it against damage during shipping. Keep the package until you are sure that all parts have been delivered and the product is function properly. Recycle the package afterwards.

TROUBLE SHOOTING

Suspected malfunctions are often due to causes that the user can fix themselves. Therefore check the product using this section. In most cases the problem can be solved quickly.



WARNING! Only perform the steps described within these instructions! All further inspection, maintenance and repair work must be performed by an authorised service centre or a similarly qualified specialist if you cannot solve the problem yourself!

Problem	Possible cause	Solution
1. Engine does not start	1.1. Not enough fuel in fuel tank	1.1. Add fuel
	1.2. Primer has been not pressed at cold start	1.2. Press the primer and restart

	1.3. Primer has been pressed at warm start 1.4. Spark plug is wet 1.5. Spark plug is damaged 1.6. Spark plug connector lose	1.3. Dry spark plug 1.4. Dry spark plug 1.5. Replace spark plug 1.6. Attach properly
2. Engine stops	2.1. Not enough fuel in fuel tank 2.2. Cutting device is blocked	2.1. Add fuel 2.2. Remove blockage
3. Unsatisfactory result	3.1 Cutting device dull	3.1 Sharpen or replace the cutting device
	3.2 Cutting material exceeds capacity	3.2 Only cut materials acc. to the capacity of the product.
	3.3 Cutting height is incorrect	3.3 Adjust cutting height
4. Excessive vibration/noise or exhaust	4.1. Cutting device is dull/damaged 4.2. Bolts/nuts are loosen 4.3. Petrol/oil is incorrect	4.1. Replace with a new one 4.2. Tighten bolts/nuts 4.3. Empty out unused petrol/oil and refill with the correct petrol/oil



Some experts believe the incorrect or prolonged use of almost any product could cause serious injury or death. For information that may reduce your risk of serious injury or death consult the points below and additionally, the information available at www.datastreamserver.com/safety

- Consult all documentation, packaging and product labelling before use. Note that some products feature online documentation which should be printed and kept with the product.
- Check product for loose / broken / damaged / missing parts, wear or leaks (if applicable) before each use. Never use a product with loose / broken / damaged / missing parts, wear or leaks (if applicable).
- Products must be inspected and serviced (if applicable) by a qualified specialist every 6 months assuming average residential use by a person of average weight and strength, above average technical aptitude, on a property matching average metropolitan specification. Intended use outside these guidelines could indicate the product is not suitable for intended use or may require more regular inspection or servicing.
- Ensure all possible users of the product have completed an industry recognised training course before being given access to the product.

- The product has been supplied by a general merchandise retailer that may not be familiar with your specific application or your description of the application. Be sure to attain third party approval for your application from a qualified specialist before use regardless of prior assurances by the retailer or its representatives.
- This product is not intended for use where fail-safe operation is required. As with any product (take an automobile, aircraft, computer or ball point pen for example) there is always a small chance of a technical issue that needs to be repaired or may require replacement of the product or a part. If the possibility of such failure and the associated time it takes to rectify could in any situation inconvenience the user, business or employee or could financially affect the user, business or employee then the product is not suitable for your requirements. This product is not for use where incorrect operation or a failure of any kind, including but not limited to a condition requiring product return, replacement, service by a technician or replacement of parts could cause a financial loss, loss of employee time or an inconvenience requiring compensation.
- If this item has been purchased in error considering the points above simply contact the retailer directly for details of their returns policies if required.

Bäumr-AG®
.com.au