

PLANT[®]CRAFT Poly Dump Cart Assembly Guide

Note: Tools required for assembly: Large flat head screwdriver and suitable spanners.

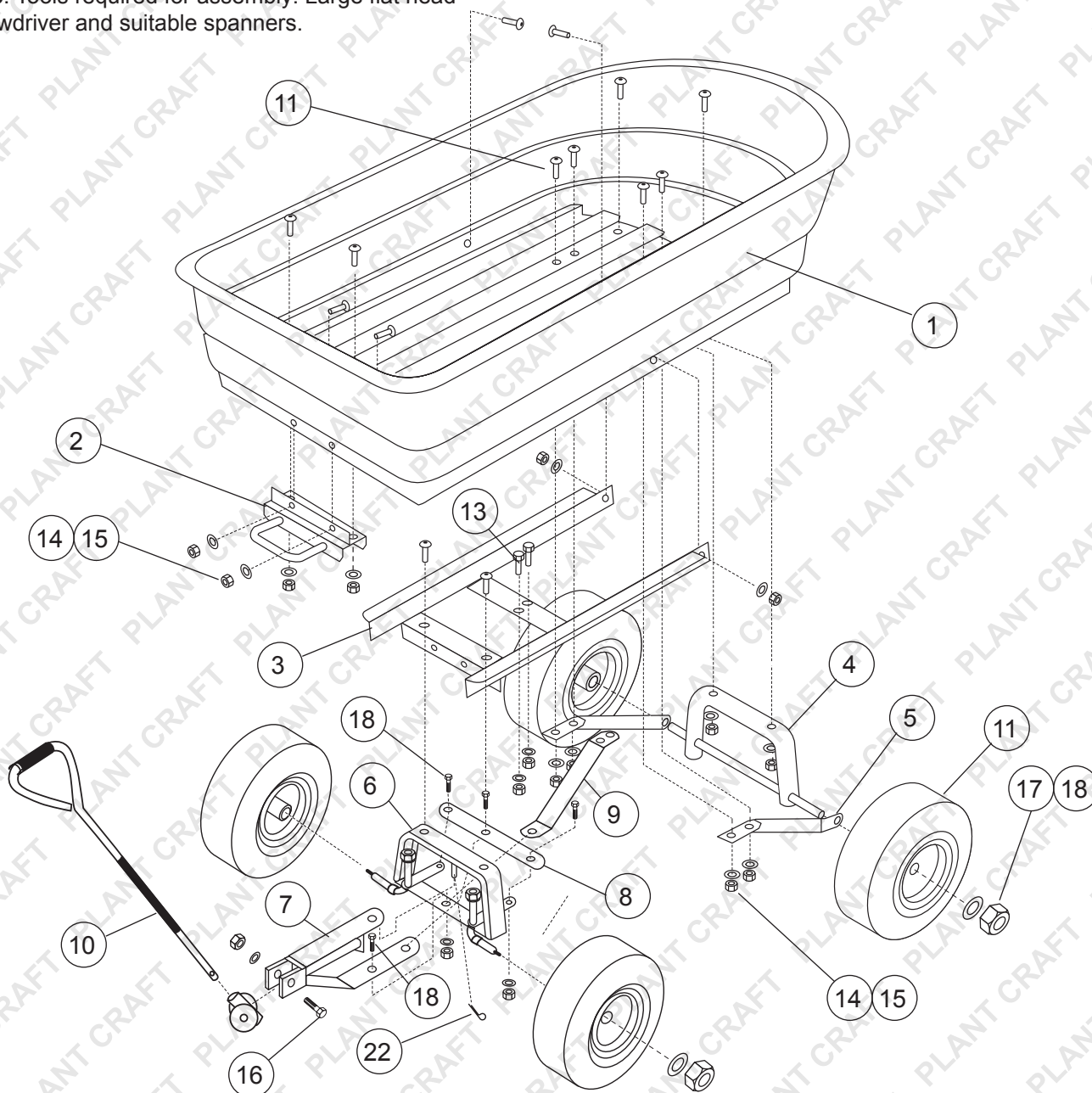

Parts List

- | | |
|--|-----------------------------------|
| 1. Tray (1) | 12. M8x20 Truss Head Screw (14) |
| 2. Latch (1) | 13. M8x20 Hex Head Bolt (2) |
| 3. Tray Frame (1) | 14. M8 Flat Washer (17) |
| 4. Rear Axle (1) | 15. M8 Lock Nut (17) |
| 5. Rear Axle Support (2) | 16. M8x60 Hex Head Bolt (1) |
| 6. Front Axle (1) (includes steering arms) | 17. M12 Lock Nut (4) |
| 7. Front Arm (1) | 18. M12 Flat Washer (4) |
| 8. Steering Link (1) | 19. M6 Hex Head Shoulder Bolt (4) |
| 9. Front Axle Support (1) | 20. M6 Flat Washer (4) |
| 10. Pull Handle (1) | 21. M6 Lock Nut (4) |
| 11. Wheel (4) | 22. Split Pin (1) |

PLANT[®]CRAFT Poly Dump Cart Assembly Guide

1. See *Figure 1*. Install the latch (2) to the tray (1) using 4 screws (12), washers (14) and nuts (15).

2. See *Figure 2*. Install the rear axle (4) to the tray (1) using 2 screws (12), washers (14) and nuts (15).

Install the rear axle supports (5) to the rear axle (4) and tray (1) using 4 screws (12), washers (14) and nuts (15).

3. See *Figure 3*. Assemble the front axle - attach the front axle (6) to the tray frame (3) using 2 screws (12), washers (14) and nuts (15).

Attach the front axle support (9) to the tray frame (3) using 2 bolts (13), washers (20) and nuts (21).

Attach the steering link (8) to the steering arms on the front axle (6) using 2 bolts (19), washers (20) and nuts (21).

Attach the front arm (7) to the front axle (6) - the top part of the front arm (has 1 hole) slips over the downward-facing pin and is secured with split pin (22). The bottom part of the front arm (has 2 holes) and attaches to the front axle (6), front axle support (9) and steering link (8) using 2 bolts (19), washers (20) and nuts (21).

4. See *Figure 4*. Attach the tray (1) to the tray frame (3) using 2 screws (12), washers (14) and nuts (15). Note that it is easier to do this if the tray is held at an angle to the tray frame when attaching it.

5. Attach the wheels (11) using washers (18) and nuts (17).

6. Attach the pull handle (10) to the front arm (7) using 1 bolt (16), washer (14) and nut (15).

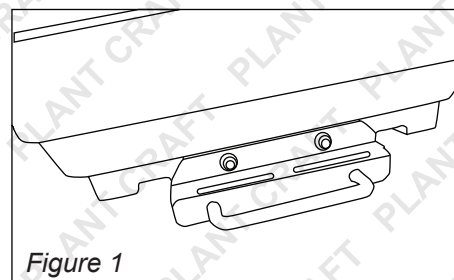

Figure 1

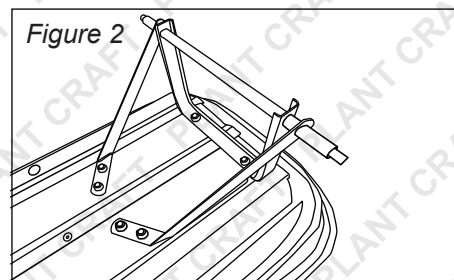

Figure 2

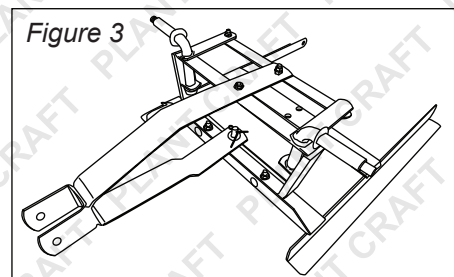

Figure 3

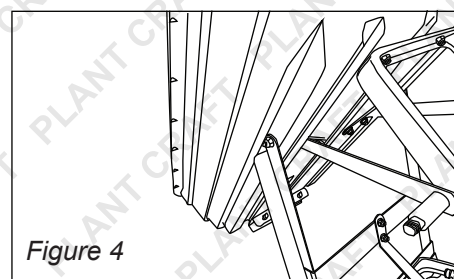
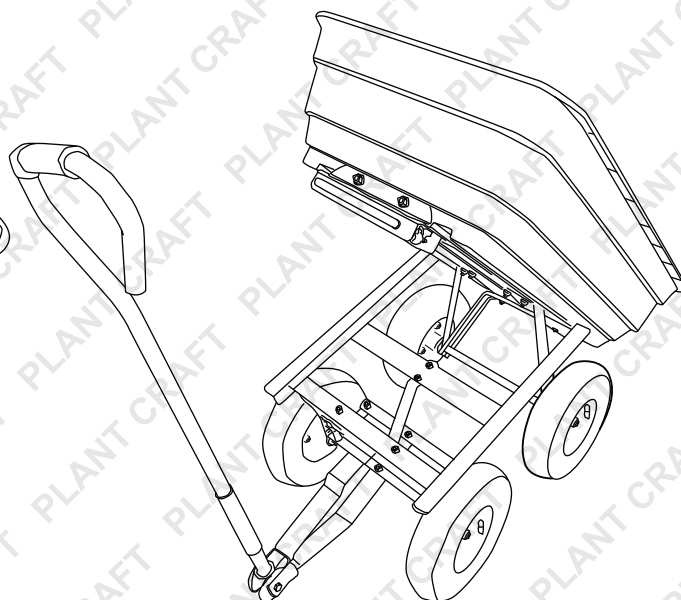
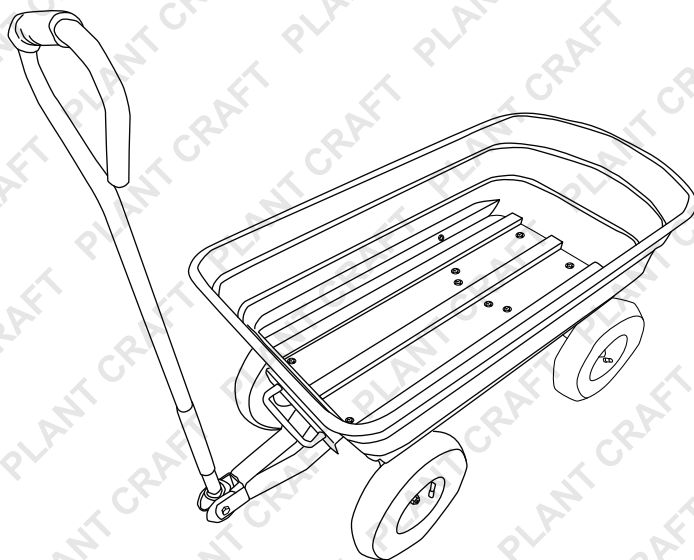

Figure 4





Some experts believe that the incorrect or prolonged use of almost any product may cause serious injury or death. To help reduce your risk of serious injury or death, refer to the information below. For more information, see www.datastreamserver.com/safety

- Consult all documentation, packaging and product labelling before use. Note that some products feature documentation available online. It is recommended to print and retain the documentation.
- Before each use, check the product for loose/broken/damaged/missing parts, wear or leaks (if applicable). Never use a product with loose/broken/damaged/missing parts, wear or leaks.
- Products must be inspected and serviced (if applicable) by a qualified technician every 6 months. This is based on average residential use by persons of average size and strength, and on a property of average metropolitan size. Use beyond these recommendations may require more frequent inspections/servicing.
- Ensure that all users of the product have completed a suitable industry recognised training course before being allowed access to the product.
- If this product has been purchased in error when considering the information presented here, contact the retailer directly for details of their returns policy, if required.
- The product has been supplied by a general merchandise retailer that may not be familiar with your specific application or description of application. Be sure to attain third-party approval from a qualified specialist for your application before use, regardless of any assurances from the retailer or its representatives.
- This product is not intended for use where fail-safe operation is required. As with any product (for example, automobile, computer, toaster), there is the possibility of technical issues that may require the repair or replacement of parts, or the product itself. If the possibility of such failure and the associated time it may take to rectify could in any way inconvenience the user, business or employee, or financially affect the user, business or employee, then the product is not suitable for your requirements. This product is not intended for use where incorrect operation or a failure of any kind, including but not limited to, a condition requiring product return, replacement, parts replacement or service by a technician may cause financial loss, loss of employee time or an inconvenience requiring compensation.

