



# 180kg Capacity Towable Dump Cart

## User Manual

[Revision 1.0 June 2017]

---

READ THIS MANUAL CAREFULLY BEFORE USE – FAILURE TO DO SO MAY RESULT IN INJURY, PROPERTY DAMAGE AND MAY VOID WARRANTY. • KEEP THIS MANUAL FOR FUTURE REFERENCE. • Products covered by this manual may vary in appearance, assembly, inclusions, specifications, description and packaging.

---

# Safety



The warnings, cautions, and instructions outlined in this manual cannot cover all possible conditions or situations that may occur. It must be understood that common sense and caution are factors which cannot be built into this product and must be supplied by the operator. Read and understand this manual completely before assembling or using the equipment.

- All operators must read and understand all safety information, operating, maintenance and storage instructions before using this equipment. Failure to properly operate and maintain the equipment may result in serious injury to the operator or bystanders.
- Do not carry passengers or sit or stand on the equipment.
- Do not allow children to play, stand or climb on the equipment.
- Inspect the equipment and ensure it is in good working condition before each use.
- Replace or repair damaged or worn parts immediately.
- Always check and tighten hardware and assembled parts before operation.
- Do NOT exceed the 180kg maximum load capacity. Note that the heavier the load, the more effort is required to unload it.
- Be careful when operating on the equipment on gradients to prevent tip over.
- Always use caution when loading and unloading the equipment.
- Always keep hands and feet clear from moving parts while operating the equipment.
- Always wear safety gear, eye protection, gloves and work boots when operating the equipment.
- When inflating tyres, do NOT exceed a pressure of 25PSI (1.7 Bar).

## Towing

- The combined weight of the towing vehicle and operator **MUST** exceed the weight of the dump cart and its contents.
- Tow using suitable vehicles only (ATV, tractor etc).
- Ensure that the equipment is hitched securely and correctly to the towing vehicle using the towing arm and hitch. Do NOT use any other method of attachment, such as ropes, chain etc.
- Ensure that the tub is locked in the transport (flat) position before towing. Never tow with the tub up.
- Do not exceed 16km/h (10mph).
- Do not tow on public roads.
- Avoid rough terrain when transporting loads.
- Always slow down before turning and avoid excessively tight turning.
- Reverse with caution – keep the towing vehicle and cart straight to help prevent "jack-knifing" the dump cart.

# Table of Contents

**Safety.....2**

**Parts Identification.....4**

**Assembly .....5**

**Operation .....10**

    Using the Tip Function ..... 10

**Maintenance and Storage .....11**

    Maintenance ..... 11

    Storage ..... 11

**Specifications.....11**

# Parts Identification

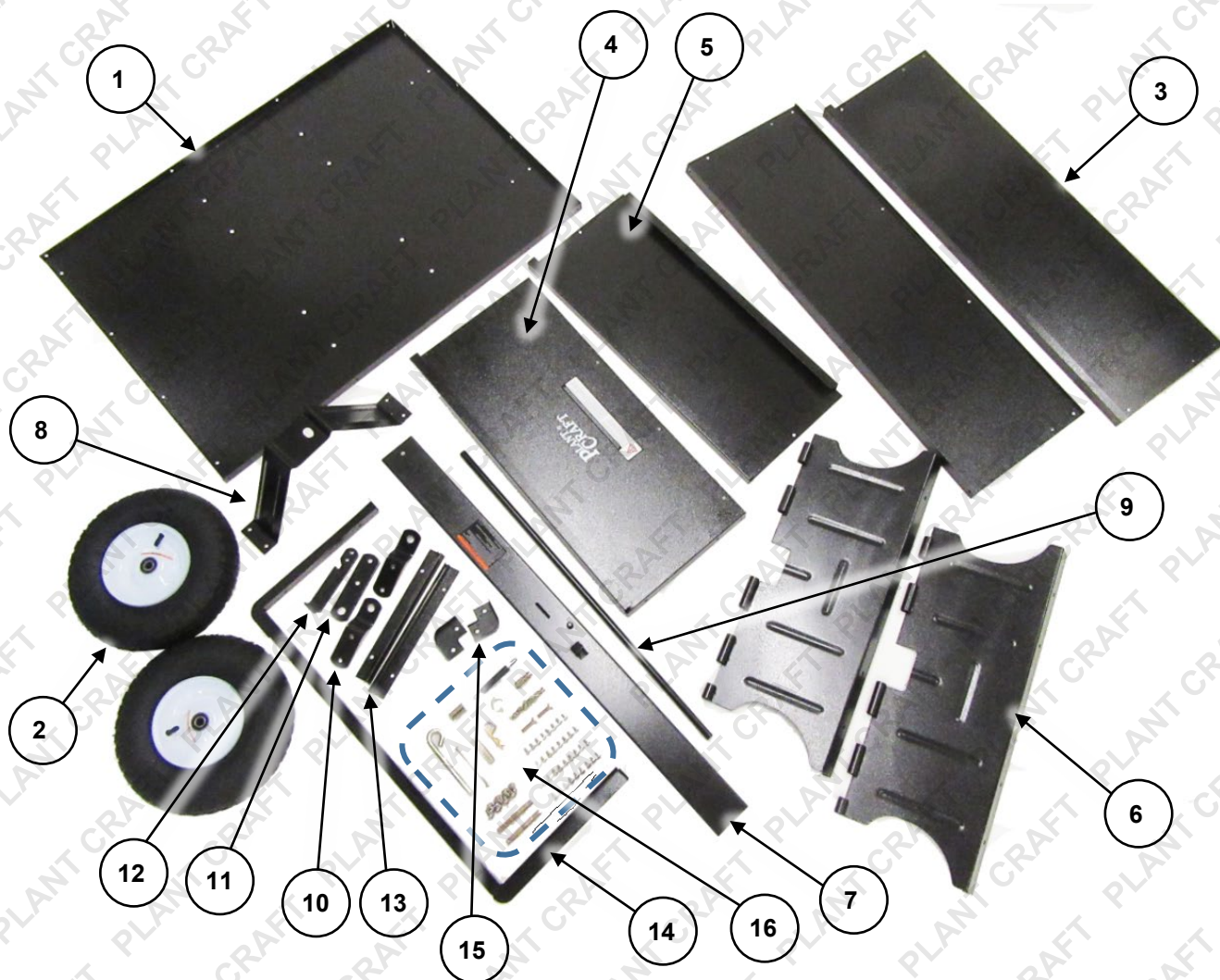

No.	Name	No.	Name
1	Bottom Panel	14	Rear Tray Support
2	Wheel (2)	15	Corner Cover (2)
3	Side Panel (2)	16	Fasteners:
4	Front Panel		Hitch Pin
5	Rear Panel		Latch Spring
6	Axle Plate (2)		R-Clip (4)
7	Tow Arm		Spacer (2)
8	Tow Arm Support		Wheel Washer (4)
9	Axle		M6x90 Bolt (1)
10	Hitch Pin Bracket (2)		M6x12 Screw (34)
11	Connecting Plate		M8x30 Bolt (2)
12	Release Pedal		M8x16 Screw (8)
13	Rear Panel Guide (2)		M6 Nut (34)
			M6 Lock Nut (1)
			M8 Nut (10)
			M6 Spring Washer (34)
			M8 Spring Washer (10)

# Assembly



It is recommended that 2 persons perform the assembly. • Some assemblies are supplied pre-assembled. • Some parts have the necessary fasteners pre-assembled – these will need to be removed during the assembly process. • Suitable tools are required for assembly. • Before assembling the equipment, check that all parts have been supplied.

1. Attach the tow arm support (27) to the underside of the bottom panel (1) using 4 sets of M6x12 screws (3), spring washers (4) and nuts (5).

**Note:** The hole on the tow arm support (27) should be on right side.

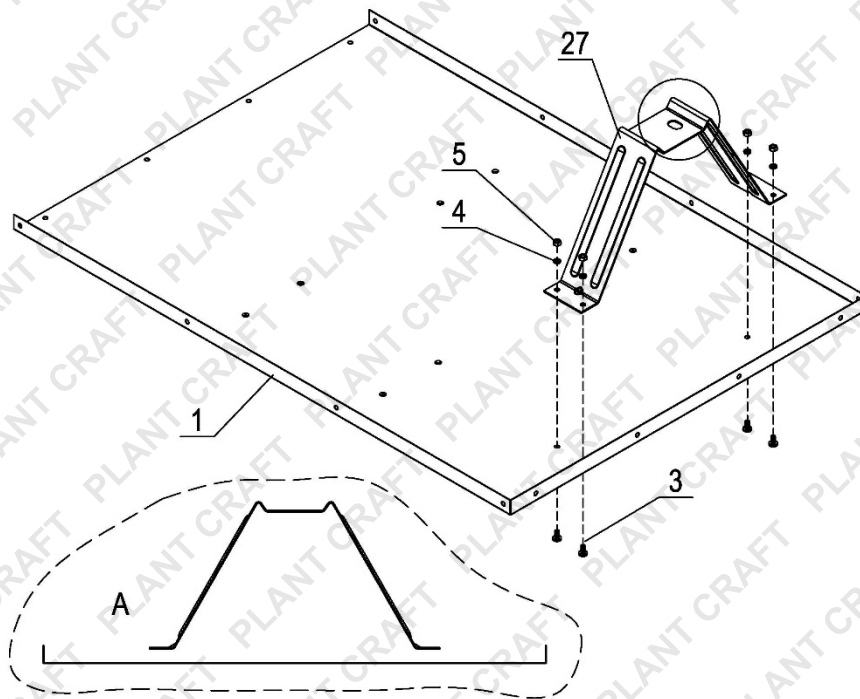

2. Attach the 2 axle plates (10) to the underside of the bottom panel (1) using 8 sets of M8x16 screws (11), spring washers (12) and nuts (13).

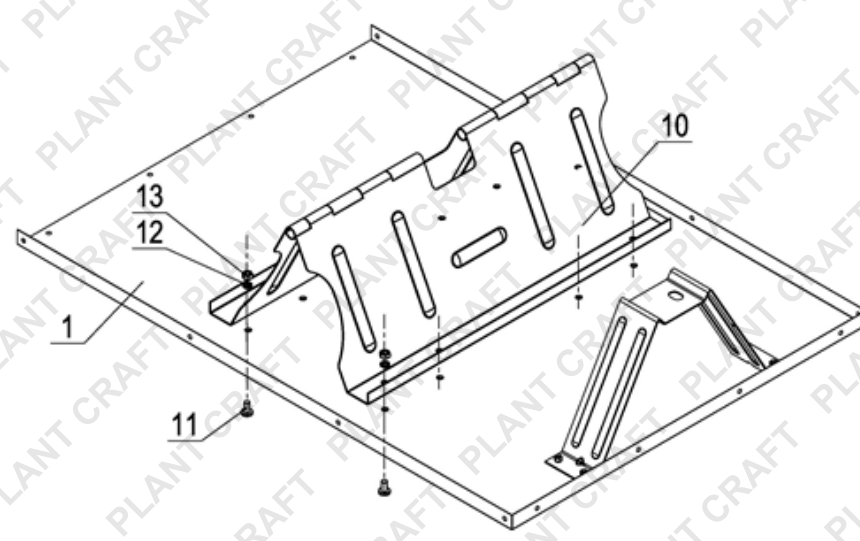

3. Position the tow arm (19) in the slot at the centre of the axle plates (10). Then slide the axle (17) through the axle plates (10) and tow arm (19).



4. Slide a wheel washer (14) onto each end of the axle (17), then place the wheels (15) onto the axle. Secure each wheel with a second wheel washer (14) and R-clip (16).

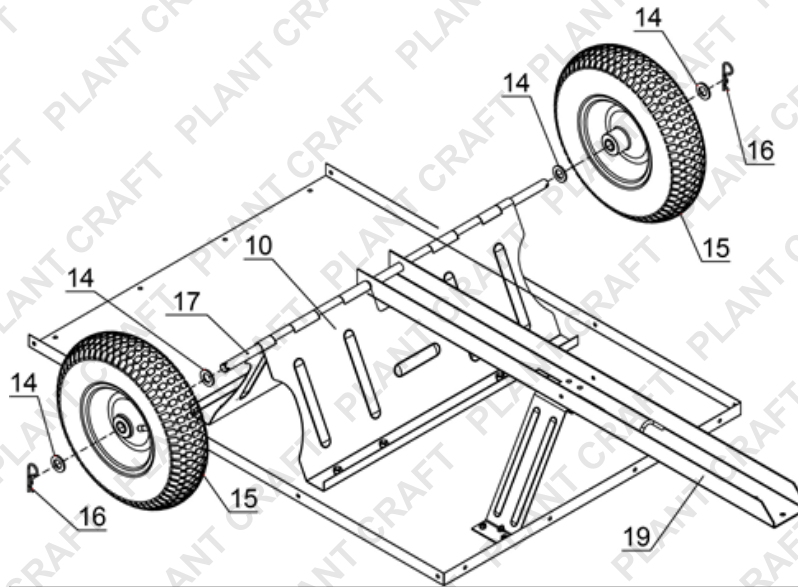

5. Insert the release pedal (21) into the tow arm (19) and secure using M6x90 bolt (25) and lock nut (26). Place a spacer (20) on each side of the release pedal.
6. Hook the latch spring (22) to the bottom hole in the release pedal (21) and the other end to the tow arm (19).

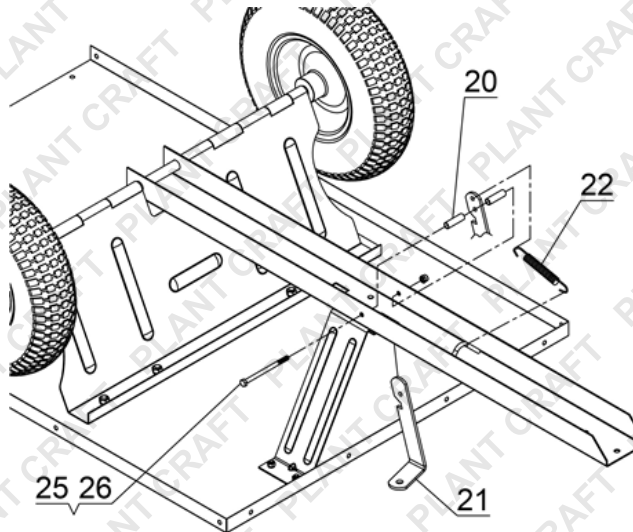

7. Attach the 2 hitch pin brackets (23) and connecting plate (8) to the tow arm (19) using 2 sets of M8x30 bolts (18), spring washers (12) and nuts (13). Insert the hitch pin (24) through the tongue hole and secure it with an R-clip (16).

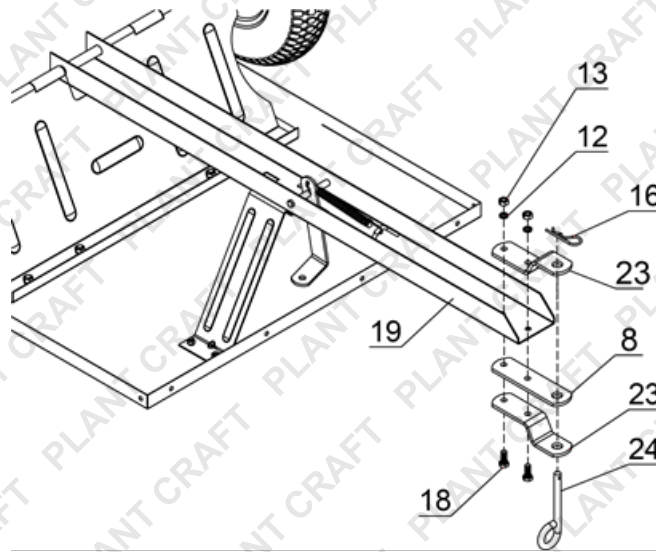

8. Attach the side panels (2) to the bottom panel using 6 sets of M6x12 screws (3), spring washers (4) and nuts (5).

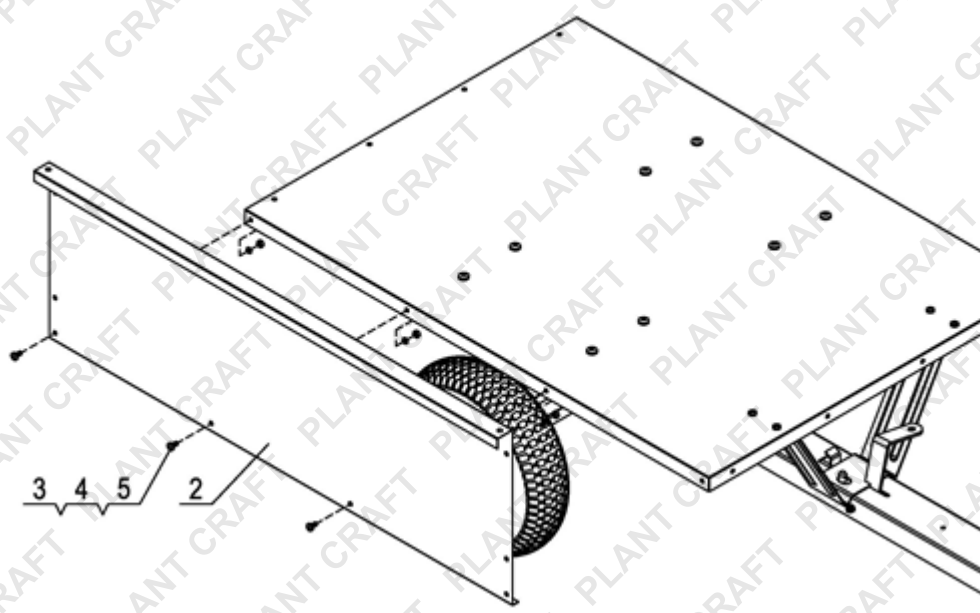

9. Attach the front panel (8) to the bottom panel using 4 sets of M6x12 screws (3), spring washers (4) and nuts (5).

10. Attach the front panel (28) to the side panels using 6 sets of M6x12 screws (3), spring washers (4) and nuts (5).

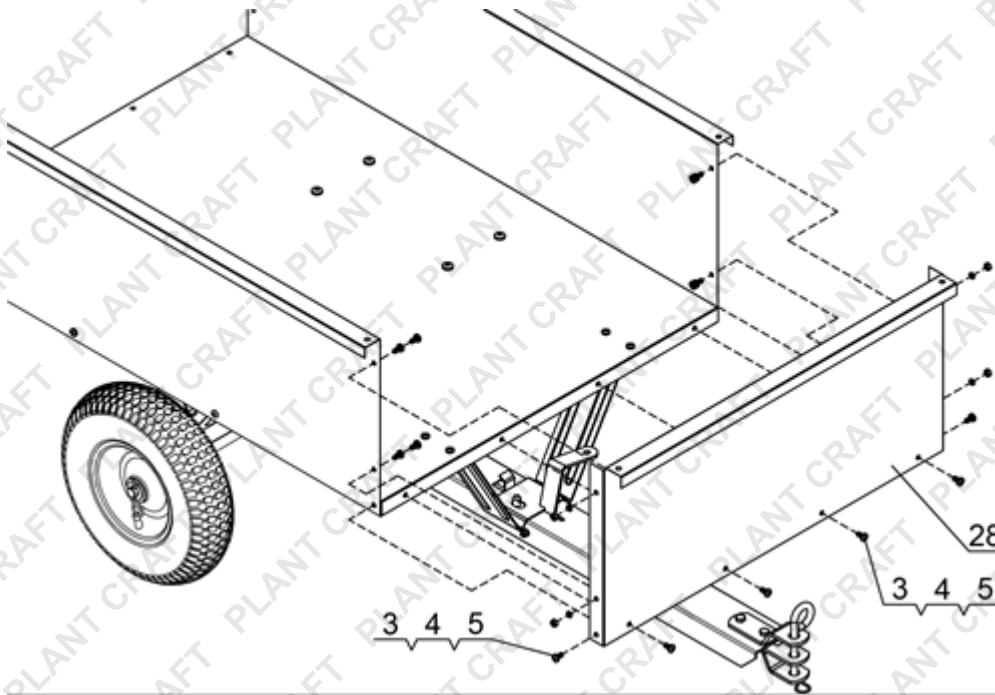

11. Attach the two corner covers (29) to the side panels and front panel using 4 sets of M6x12 screws (3), spring washers (4) and nuts (5).

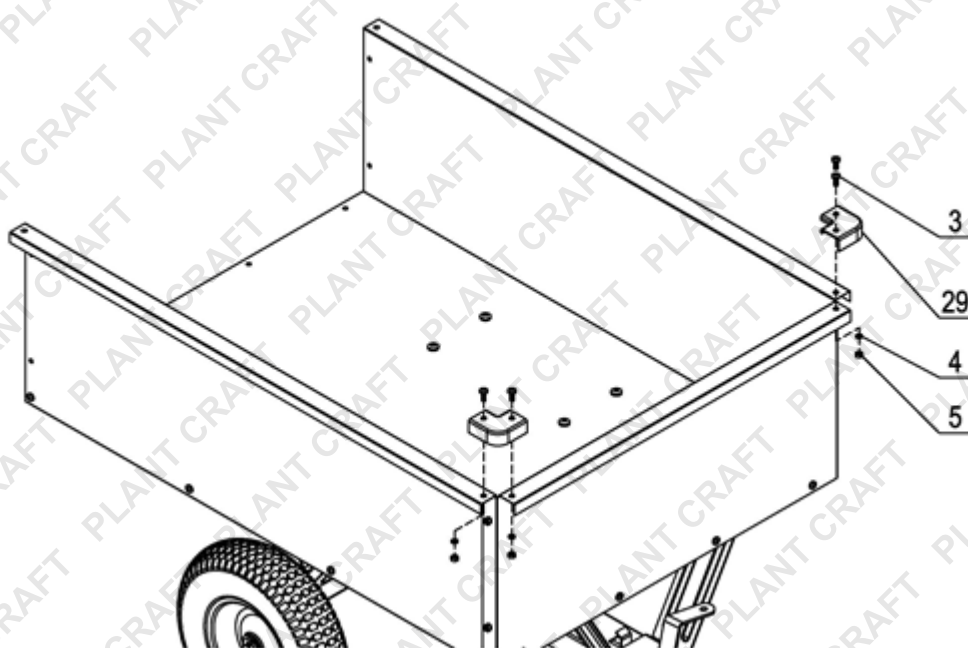

12. Attach the rear tray support (7) to the bottom panel and side panels using 6 sets of M6x12 screws (3), spring washers (4) and nuts (5).



13. Attach the 2 rear panel guides (6) to the rear tray support (7) and both side panels using 4 sets of M6x12 screws (3), spring washers (4) and nuts (5).

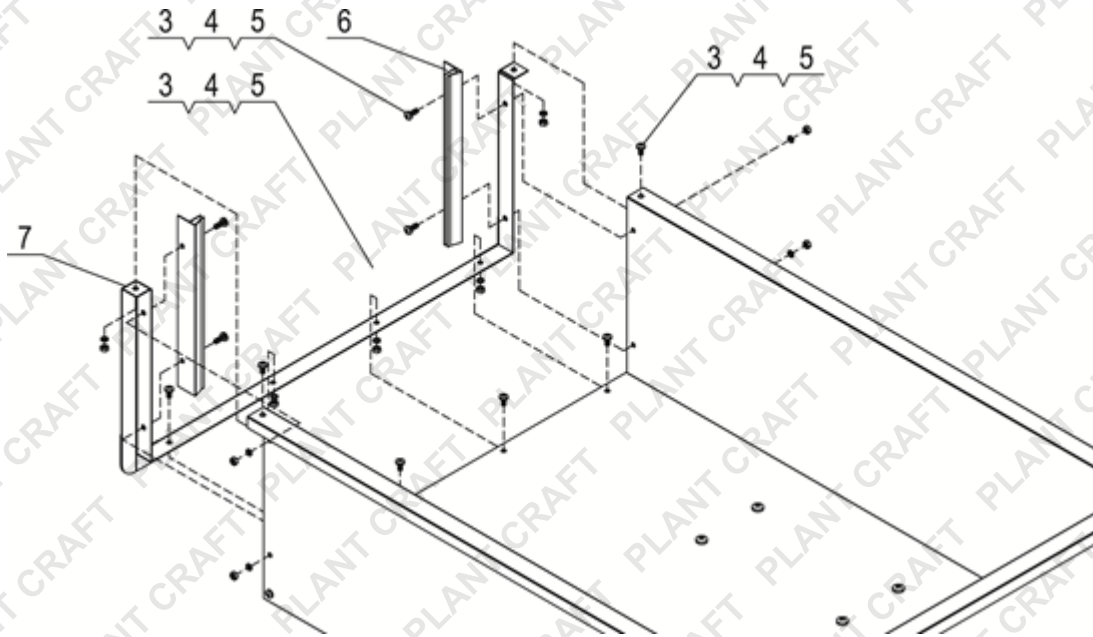

14. Slide the rear panel (9) into the rear panel guide slots.

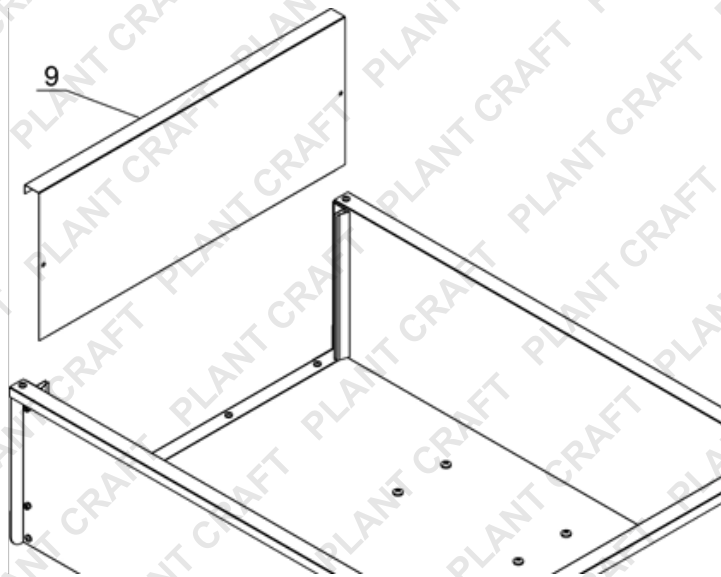

15. Insert an R-clip (16) into the tow arm safety pin.

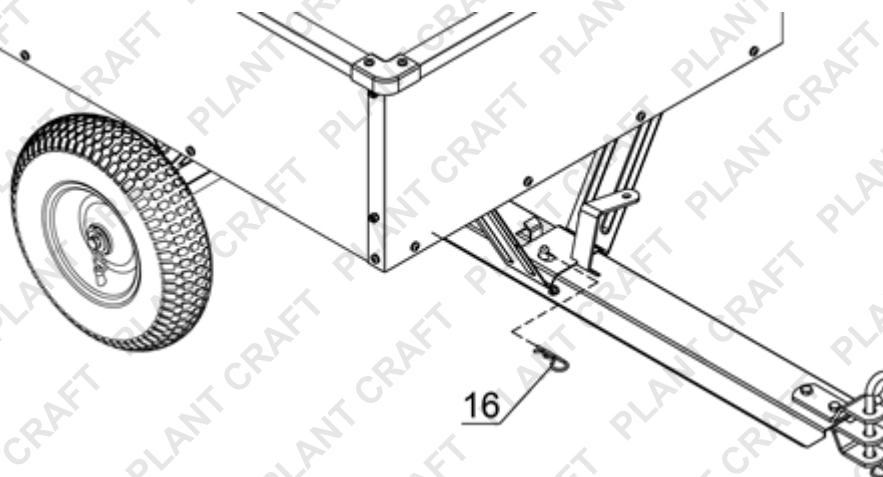

## Operation



Improper use of the equipment may void warranty. • Do not exceed the maximum 450kg rated load.

### Using the Tip Function

The tray can be lifted at the front so the contents are dumped at the rear. To tip the tray:

1. Pull the rear panel out from the rear panel guide slots.
2. Remove the R-clip (A) from the tow arm safety pin to unlock the tray release mechanism.
3. Press the release pedal (B).
4. Lift the front edge of the tray to empty the contents.

When finished, lower the tray, then press down so the latch engages, then place the R-clip into the tow arm safety pin.

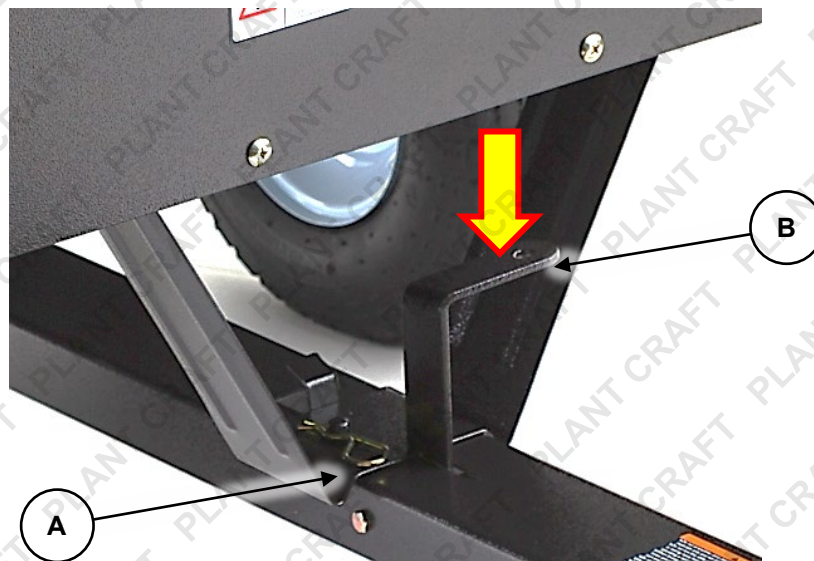

# Maintenance and Storage



Improper maintenance and storage of the equipment may void warranty. • If a part needs replacement, only use parts that meet the manufacturer's specifications. Replacement parts that do not meet specifications may result in a safety hazard or poor operation.

## Maintenance

- After each use, remove all residual material from the tray.
- Ensure that the tyres are inflated to 25PSI (1.7 Bar) before each use.
- Periodically check all fasteners for tightness.
- Lightly lubricate moving parts every 6 months.
- Never exceed the 180kg maximum load capacity as it will damage the unit.

## Storage

- Never allow material to remain in the tray for extended periods of time.
- Before storing make sure the equipment is clean and dry.
- Store in a cool dry place and out of direct sunlight.

# Specifications

<b>Load Capacity</b>	180kg
<b>Tray Material</b>	Steel
<b>Tray Dimensions</b>	96cm x 71cm x 30cm
<b>Overall Dimensions</b>	154cm x 80cm x 68cm
<b>Wheel size</b>	8"
<b>Tyre Pressure (PSI)</b>	25
<b>Tyre Size</b>	13 x 4.00 - 6
<b>Unit Weight</b>	28kg



Some experts believe the incorrect or prolonged use of almost any product could cause serious injury or death. For information that may reduce your risk of serious injury or death, consult the points below and additionally, the information available at [www.datastreamserver.com/safety](http://www.datastreamserver.com/safety)

- |   |  |
|---|--|
| <ul style="list-style-type: none"> <li>• Consult all documentation, packaging and product labelling before use. Note that some products feature online documentation which should be printed and kept with the product.</li> <li>• Check product for loose / broken / damaged / missing parts, wear or leaks (if applicable) before each use. Never use a product with loose / broken / damaged / missing parts, wear or leaks (if applicable).</li> <li>• Products must be inspected and serviced (if applicable) by a qualified specialist every 6 months assuming average residential use by a person of average weight and strength, above average technical aptitude, on a property matching average metropolitan specification. Intended use outside these guidelines could indicate the product is not suitable for intended use or may require more regular inspection or servicing.</li> <li>• Ensure all possible users of the product have completed an industry recognized training course before being given access to the product.</li> </ul> | <ul style="list-style-type: none"> <li>• The product has been supplied by a general merchandise retailer that may not be familiar with your specific application or your description of the application. Be sure to attain third-party approval for your application from a qualified specialist before use regardless of prior assurances by the retailer or its representatives.</li> <li>• This product is not intended for use where fail-safe operation is required. As with any product (take an automobile, aircraft, computer or ball point pen for example), there is always a small chance of technical issues that needs to be repaired or may require replacement of the product or a part. If the possibility of such failure and the associated time it takes to rectify could in any situation inconvenience the user, business or employee then the product is not suitable for your requirements. This product is not for use where incorrect operation or a failure of any kind, including but not limited to a condition requiring product return, replacement, service by a technician or replacement of parts could cause a financial loss, loss of employee time or an inconvenience requiring compensation.</li> <li>• If this item has been purchased in error after considering the points above, simply contact the retailer directly for details of their returns policy, if required.</li> </ul> |
|---|--|



©2017 Plantcraft. All rights reserved. No part of this document, including descriptive content, concepts, ideas, diagrams or images may be reproduced or transmitted in any form or by any means, electronic or mechanical, including photocopying, scanning or recording, or any information storage and retrieval system, without express permission or consent from the publisher.