



# Push/Tow Garden Spreader

## User Manual

[Revision 2.0 December 2016]

RETAIN THIS MANUAL FOR FUTURE REFERENCE  
PLEASE READ THIS MANUAL CAREFULLY BEFORE USE

# Table of Contents

**Safety.....3**

**Introduction and Use .....4**

**Parts Identification.....5**

**Assembly .....6**

    Push Handle Assembly .....8

    Towing Arm Assembly .....9

**Maintenance and Storage .....10**

    Maintenance .....10

    Storage .....10

**Specifications .....10**

# Safety

---

**CAUTION!** The warnings, cautions, and instructions outlined in this instruction manual cannot cover all possible conditions or situations that may occur. It must be understood by the operator that common sense and caution are factors which cannot be built into this product and must be supplied by the operator. Read and understand this manual completely before assembling or using the spreader.

---

- All operators must read and understand all safety information, operating, maintenance and storage instructions before using this equipment. Failure to properly operate and maintain the spreader may result in serious injury to the operator or bystanders.
- Do not carry passengers or sit or stand on the spreader.
- Do not allow children to play, stand or climb on the spreader.
- Inspect the spreader and ensure it is in good working condition before each use.
- Replace or repair damaged or worn parts immediately.
- Always check and tighten hardware and assembled parts before operation.
- Do not exceed the 57kg maximum load capacity.
- Avoid large holes and ditches when transporting loads.
- Be careful when operating on the spreader on gradients to prevent tip over.
- Do not use the spreader near waterways and public roads.
- Do not use the spreader on windy days when spreading grass seed or herbicides.
- Always use caution when loading and unloading the spreader.
- Always keep hands and feet clear from moving parts while operating the equipment.
- Always wear safety gear, eye protection, gloves and work boots when operating the spreader.

## Assembly Required

This product requires adult assembly. Because of the weight and size of the spreader, it is recommended that another adult be present to assist with assembly. Inspect all components closely upon receipt to make sure no parts are missing or damaged.

# Introduction and Use

The PlantCraft push/tow spreader is designed to distribute a wide range of materials, such as fertilizers and seed. For most consistent results, the spreader should be pushed/towed at approximately 5km/h (brisk walking speed). Slower or faster speeds will change the spread pattern and coverage. Wet spreading material will also change the spread pattern and flow rate. Clean the spreader thoroughly after each use, including between the shut-off plate and bottom of the hopper.

The spreader has a unique 2-in-1 design that allows to be assembled as either a push or a pull (tow) spreader. It is possible to change the configuration between push and tow at any time.

- To use the spreader:
- Fill the hopper with the required material.
- Place the control lever in the desired position. This opens the "hatch" at the bottom of the hopper, allowing the material to fall onto the spreader plate. The further the lever is moved from the OFF position, the wider the hatch opening is, increasing the rate of material being spread.
- Move the spreader across the work area. When the spreader is moved, the spreader plate spins, distributing the material.

When finished, place the control lever in the OFF position.

---

**Note:** Materials such as powder, manure, top soil, gravel, and mulch have physical characteristics that are not compatible with the spreader and should not be used. • Never exceed the 57kg load capacity of the spreader.

---

# Parts Identification

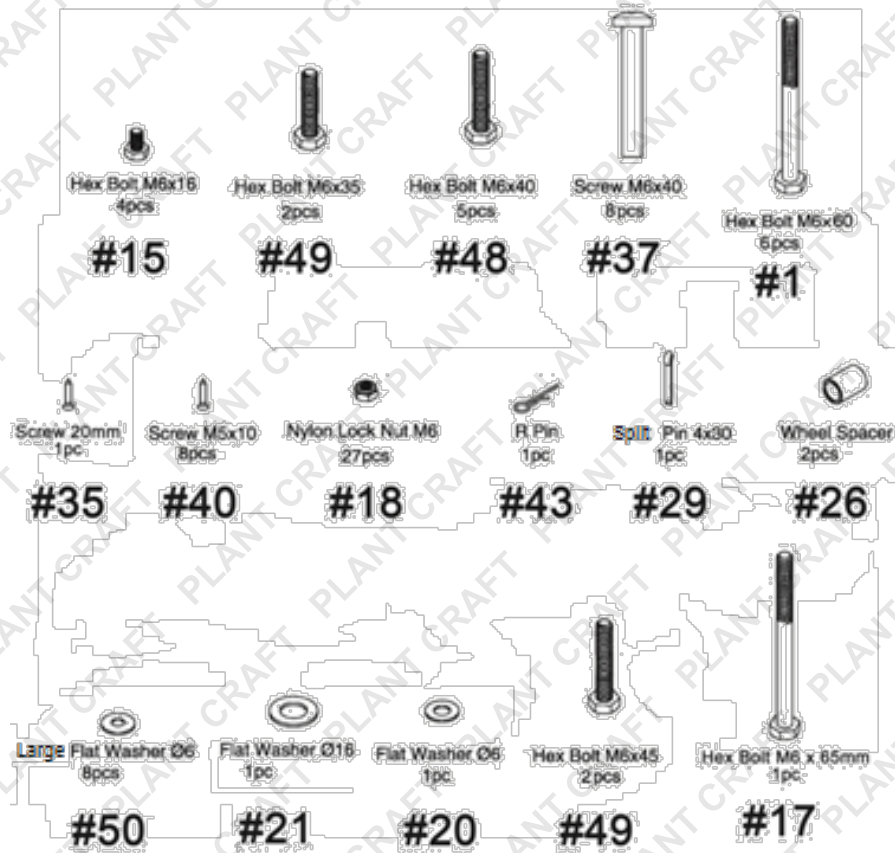

Frame  
1pc

#0



Handle Support  
1pc

#2



Connecting Tube  
1pc

#3



Lower Hopper  
1pc

#4



Upper Hopper  
1pc

#7



Wheel  
2pcs

#11



Spreader Plate  
1pc

#41



Connection Plate  
1pc

#5



Connecting Tube  
1pc

#12



U Tube  
1pc

#58

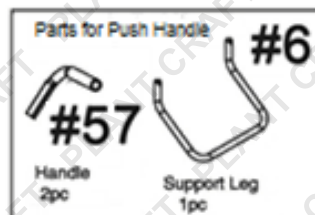
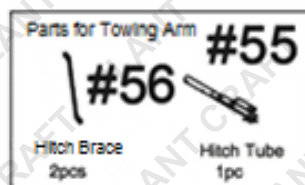



# Assembly

**Note:** The spreader can be assembled with either a push handle or towing arm. The following instructions provide the initial spreader assembly that is always required. Refer to the [push handle assembly](#) or [towing arm assembly](#) as required to complete the assembly. • For clarity some assembled parts may not be shown in the images. • Suitable spanners and pliers are required for assembly.

## Install Wheels

1. Place a wheel spacer (26) on both ends of the frame axle; then slide the wheels (11) onto the axle.
2. On the left side secure the wheel to the axle using 1 M6x60 bolt (1) and M6 nut (18). The bolt must be inserted from one side of the wheel hub and through the hole in the axle.
3. On the right side secure the wheel using 1 M16 washer (21) and split pin (29). After installing the split pin, bend the legs to prevent it falling out.

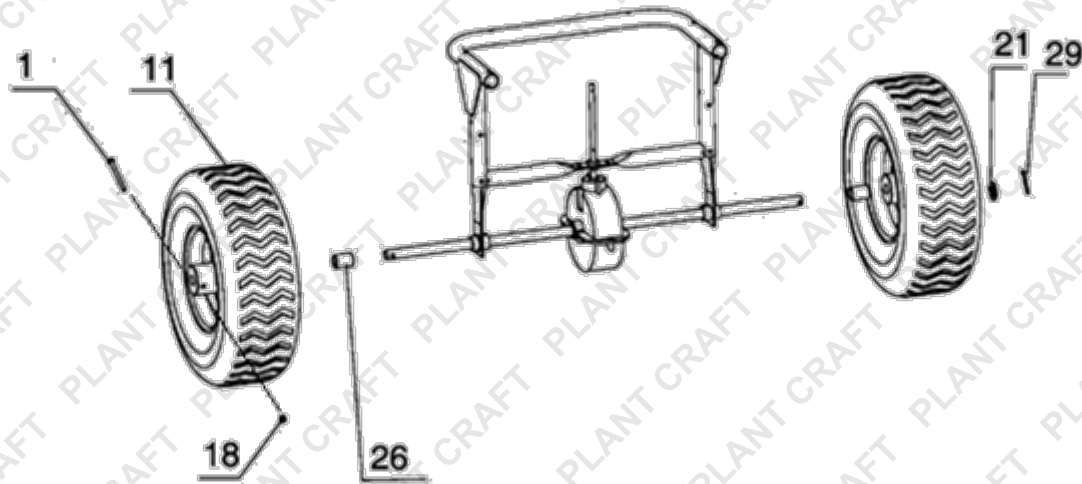

## Install Connecting Plate and Spreader Plate

1. Install the connection plate (5) to the frame using 1 M6x16 bolt (15) and M6 nut (18).
2. Install the spreader plate (41) to the spreader drive shaft using 1 M4x20 screw (35).

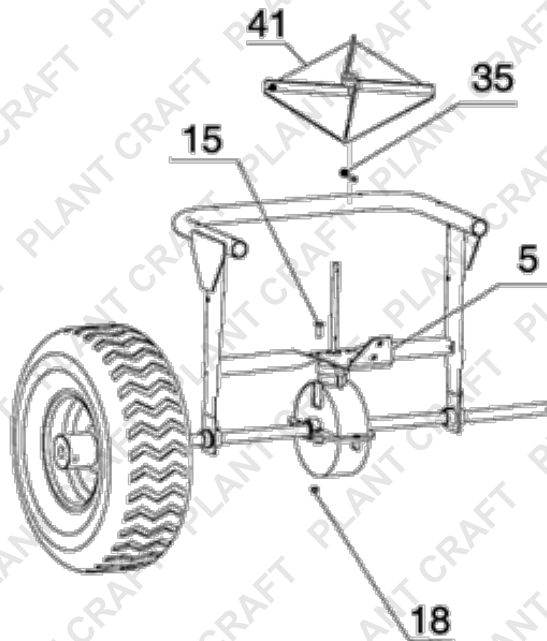

### Assemble Hopper

1. Connect the upper hopper (7) and lower hopper (4) together using 8 M5x10 screws (40).

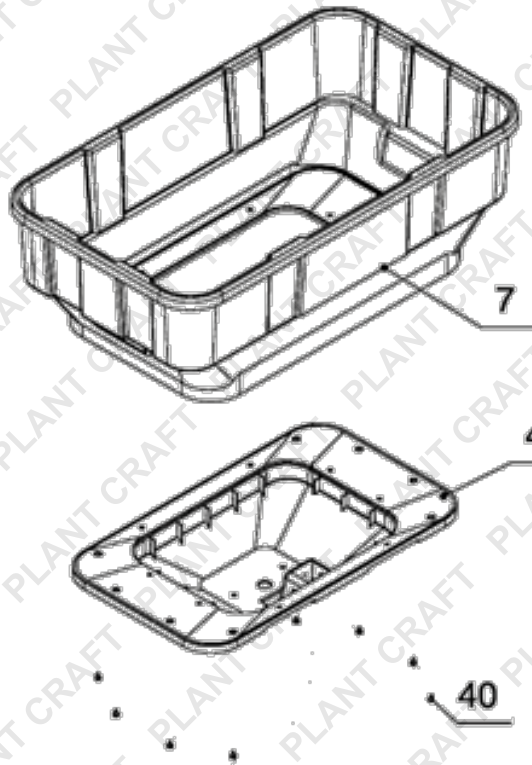

### Attach Hopper to Frame

1. Insert the U tube (2) into the frame tube assembly.
2. Attach the hopper to the frame using 8 large M6 washers (50), M6x40 screws (37) and M6 nuts (18).
3. Inside the hopper insert the R pin (43) into the spreader drive shaft.

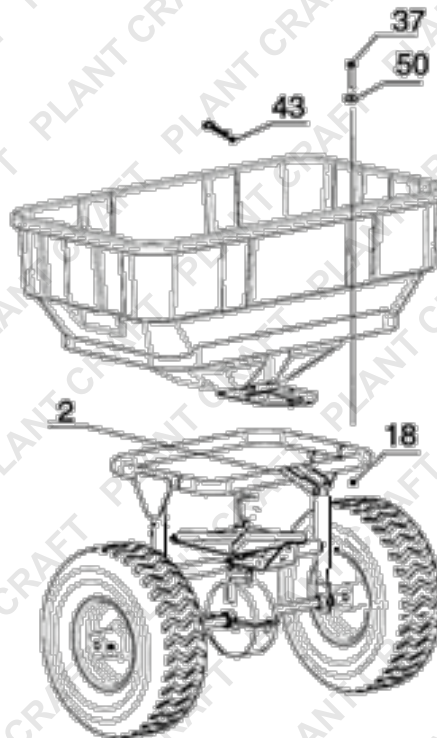

## Push Handle Assembly

The following assembly applies only when using the spreader in "push" configuration.

### Attach Support Leg

1. Install the support leg (6) to the frame using 4 M6x60 bolts (1) and M6 nuts (18).

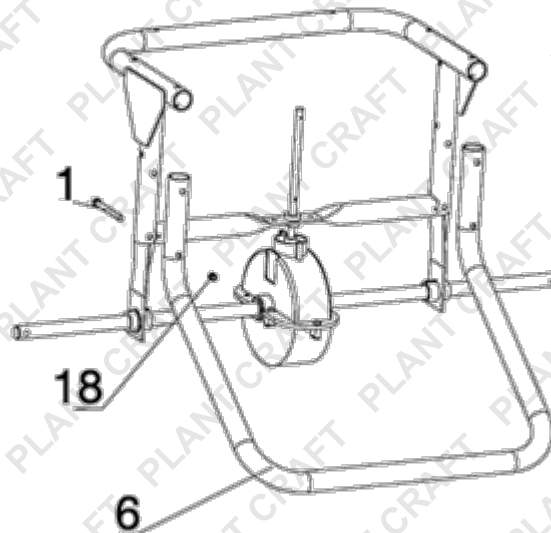

### Attach Push Handle

1. Insert connecting tube A (3) into connecting tube B (12) and secure using 2 M6x35 bolts (49) and M6 nuts (18).
2. Place both handles (57) onto each side of connecting tube B (12) and secure using 2 M6x35 bolts (49) and M6 nuts (18).
3. Attach connecting tube A (3) to the spreader in two places – at the connection plate (5) using 2 M6x16 bolts (15) and M6 nuts (18), and to the U tube (2) using 1 M6x40 bolt (16) and M6 nut (18).
4. Attach the control lever box (1) to connecting tube B (12) using 1 M6x65 bolt (17), M6 washer (20) and M6 nut (18).

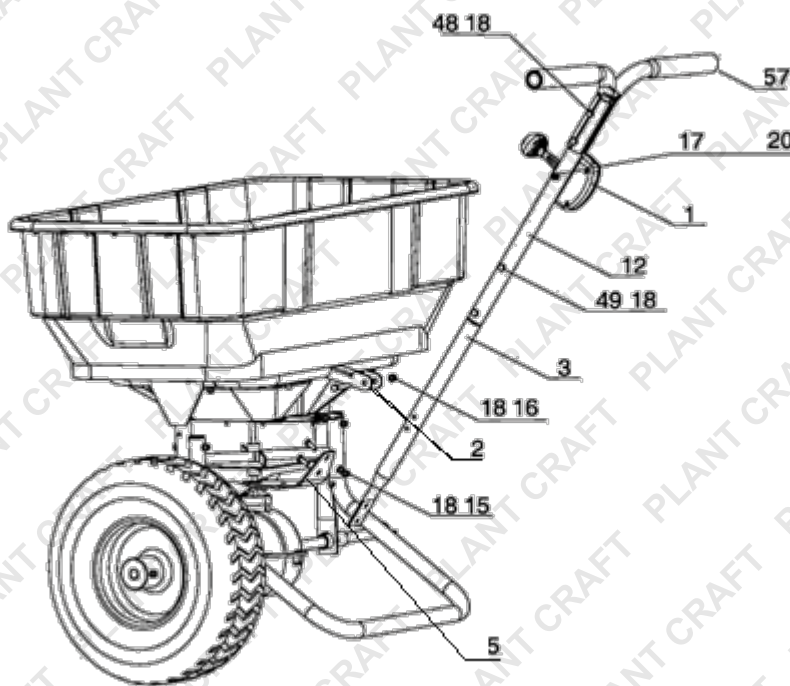



## Towing Arm Assembly

The following assembly applies only when using the spreader in "tow" configuration.

### Attach Hitch Tube

1. Insert connecting tube A (3) into connecting tube B (12) and secure using 2 M6x35 bolts (49) and M6 nuts (18).
2. Attach connecting tube A (3) to the bottom holes of the connection plate (5) using 2 M6x16 bolts (15) and M6 nuts (18). Do not tighten the fasteners at this stage.
3. Attach the two hitch braces (56) on each side of the connecting tube A (3) using 1 M6x40 bolt (16) and M6 nut (18). Tighten the fasteners installed at step 2.
4. Attach the hitch tube (55) to connecting tube B (12) using 2 M6x45 bolts (48) and 2 M6 nuts (18).
5. Attach the U tube (58) to connecting tube B (12) using 2 M6x40 bolts (16) and 2 M6 nuts (18).
6. Fix the control lever box (1) to U tube (58) using 1 M6x65 bolt (17), M6 washer (20) and M6 nut (18).

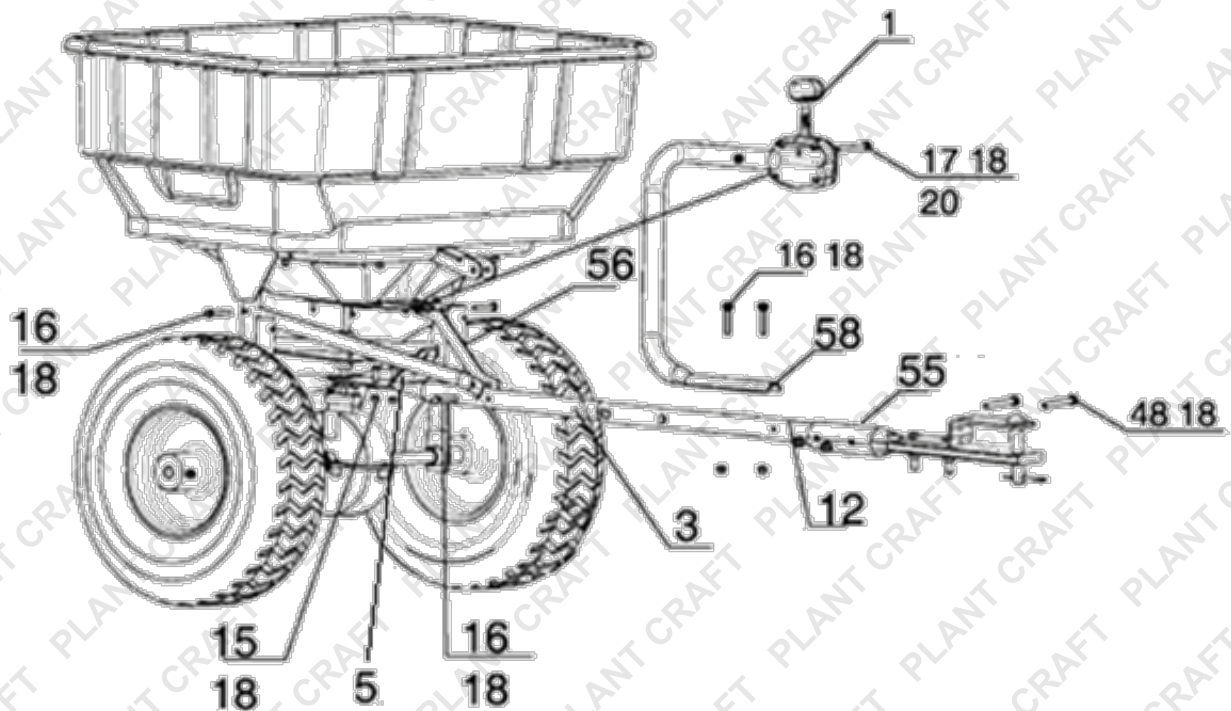

# Maintenance and Storage

**CAUTION!** Improper maintenance and storage of the spreader may void warranty. • If a part needs replacement, only use parts that meet the manufacturer's specifications. Replacement parts that do not meet specifications may result in a safety hazard or poor operation.

## Maintenance

- After each use, remove residual material from the hopper.
- Clean the spreader after each use.
- Ensure that tyres are inflated to 20PSI before each use.
- Periodically check all fasteners for tightness.
- Lightly lubricate moving parts every 6 months.
- Never exceed the 57kg maximum load capacity as it will damage the spreader.

## Storage

- Never allow material to remain in the hopper for extended periods of time.
- Before storing make sure the spreader is clean and dry.
- Store in a cool dry place and out of direct sunlight.

## Specifications

Load Capacity	57kg
Hopper Material	Polypropylene
Hopper Dimensions	77cm x 44cm x 36cm
Push Spreader Overall Dimensions	87cm x 77cm x 105cm
Tow Behind Spreader Overall Dimensions	134cm x 77cm x 74cm
Wheel size	14"
Tyre Pressure (PSI)	20
Unit Weight	19kg



Some experts believe the incorrect or prolonged use of almost any product could cause serious injury or death. For information that may reduce your risk of serious injury or death, consult the points below and additionally, the information available at [www.datastreamserver.com/safety](http://www.datastreamserver.com/safety)

- |   |  |
|---|--|
| <ul style="list-style-type: none"> <li>• Consult all documentation, packaging and product labelling before use. Note that some products feature online documentation which should be printed and kept with the product.</li> <li>• Check product for loose / broken / damaged / missing parts, wear or leaks (if applicable) before each use. Never use a product with loose / broken / damaged / missing parts, wear or leaks (if applicable).</li> <li>• Products must be inspected and serviced (if applicable) by a qualified specialist every 6 months assuming average residential use by a person of average weight and strength, above average technical aptitude, on a property matching average metropolitan specification. Intended use outside these guidelines could indicate the product is not suitable for intended use or may require more regular inspection or servicing.</li> <li>• Ensure all possible users of the product have completed an industry recognized training course before being given access to the product.</li> </ul> | <ul style="list-style-type: none"> <li>• The product has been supplied by a general merchandise retailer that may not be familiar with your specific application or your description of the application. Be sure to attain third-party approval for your application from a qualified specialist before use regardless of prior assurances by the retailer or its representatives.</li> <li>• This product is not intended for use where fail-safe operation is required. As with any product (take an automobile, aircraft, computer or ball point pen for example), there is always a small chance of technical issues that needs to be repaired or may require replacement of the product or a part. If the possibility of such failure and the associated time it takes to rectify could in any situation inconvenience the user, business or employee then the product is not suitable for your requirements. This product is not for use where incorrect operation or a failure of any kind, including but not limited to a condition requiring product return, replacement, service by a technician or replacement of parts could cause a financial loss, loss of employee time or an inconvenience requiring compensation.</li> <li>• If this item has been purchased in error after considering the points above, simply contact the retailer directly for details of their returns policy, if required.</li> </ul> |
|---|--|



©2016 PlantCraft. All rights reserved. No part of this document, including descriptive content, concepts, ideas, diagrams or images may be reproduced or transmitted in any form or by any means, electronic or mechanical, including photocopying, scanning or recording, or any information storage and retrieval system, without express permission or consent from the publisher.