



Towed Dump Cart



Instruction & Assembly

SAVE THESE INSTRUCTIONS FOR FUTURE REFERENCE

Table of Contents

General Warnings and Rules.....	3
Hazard Signal Word Definition.....	4
Controls and Features Identification.....	5
Component & Hardware	6, 7
Assembly Instructions	8, 9 10
Operation Instructions	11
Maintenance and Storage.....	12
Specification	13



GENERAL WARNINGS



READ and UNDERSTAND this manual completely before using Towed Dump Cart.

Operator must read and understand all safety and warning information, operating instructions, maintenance and storage instructions before operating this equipment. Failure to properly operate and maintain the towed dump cart could result in serious injury to the operator or bystanders.

Operation Warnings

- Do not at any time carry passengers sit or stand on the cart.
- Do not allow children to play on, stand upon or climb in the cart.
- Always inspect the cart before using to assure it is in good working condition.
- Replace or repair damaged or worn parts immediately.
- Always check and tighten hardware and assembled parts before operation.
- Do not exceed equipment maximum load capacity of 181kg.
- Avoid large holes and ditches when transporting loads.
- Be careful when operating on steep grades (hill) the cart may tip over.
- Always operate at reduce speed in rough terrain, along creeks, ditches and on hillsides.
- Do not operate close to creeks, ditches and public highways.
- To avoid personal injury and/or equipment damage DO NOT EXCEED 10 MPH.
- Always use caution when loading and unloading the cart.
- Only tow with recommended vehicles (Lawn/Garden Tractors and ATVs).
- Always secure and lock dump cart to the vehicle hitch before operating.

Crush and Cut Hazards

- Always keep hands and feet clear from moving parts while operating the equipment.
- Always clear and keep work area clean when operating.
- Always wear safety gear, eye protection, gloves and work boots when operating the dump cart.







WARNING

The warnings, cautions, and instructions outlined in this instruction manual cannot cover all possible conditions or situations that may occur. It must be understood by the operator that common sense and caution are factors which cannot be built into this product and must be supplied by the operator.

Assembly Is Required

This product requires assembly before use. See "Assembly" section for instructions. Because of the weight and/or size of the towed dump cart, it is recommended that another adult be present to assist with the assembly. **INSPECT ALL COMPONENTS** closely upon receipt to make sure no components are missing or damaged.

Hazard Signal Word Definitions

	<p>This is the safety alert symbol. It is used to alert you to potential personal injury hazards. Obey all safety messages that follow this symbol to avoid possible injury or death.</p>
	<p>DANGER indicates an imminently hazardous situation which, if not avoided, will result in death or serious injury.</p>
	<p>WARNING indicates a potentially hazardous situation which, if not avoided, could result in death or serious injury.</p>
	<p>CAUTION indicates a potentially hazardous situation which, if not avoided, may result in minor or moderate injury.</p>
	<p>CAUTION used without the safety alert symbol indicates a potentially hazardous situation which, if not avoided, may result in property damage.</p>

ABOUT YOUR TOWED DUMP CART

This towed dump cart has a rugged steel construction and is designed to carry a wide range of materials. The dump cart will easily haul up to 181kg of tools, firewood, animal feed, trash, landscaping materials, cement or anything else that needs to be moved. Low profile cart makes loading and un-loading fast and convenient. Never exceed the rated load capacity of 181kg when operating the towed dump cart.

Technical specifications on the towed dump cart are provided in the "Specifications" section of this manual.

Controls and Features Identification

Read this owner's manual before operating the equipment. Familiarize yourself with the location and function of the controls and features. Save this manual for future reference.

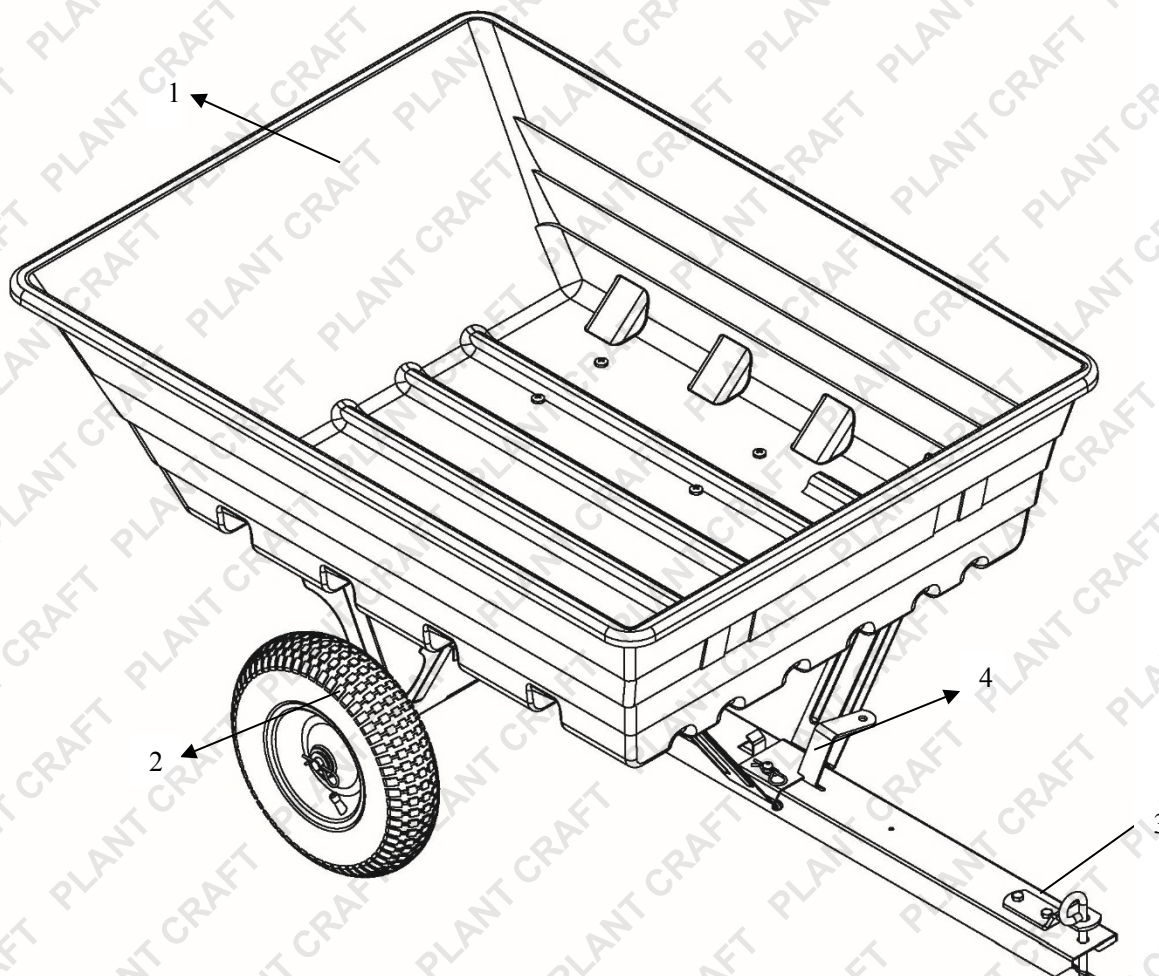

- 1) **Utility Cart Box** – Do not exceed rated load capacity 181kg.
- 2) **Tyres / Wheel** – Do not exceed the recommended rate 25 PSI.
- 3) **Hitch** – Pin-type design use only with approve vehicles.
- 4) **Release Pedal** – Release the cart bed.



CAUTION

Read and follow all instructions for assembly and operation. Failure to properly assemble this equipment could result in serious injury to the user or bystanders, or cause equipment damage.

TOWED DUMP CART COMPONENT PARTS AND ASSEMBLY

Take all parts out of the shipping crate and inspect components to ensure there are no missing pieces before starting to assemble the towed dump cart follow steps 1 through 6.

TOOLS REQUIRED

- Pliers
- Screw Driver
- 10mm & 14mm Wrench
- Wooden hammer

Component Parts



(#17) Wheel Axle 1pc

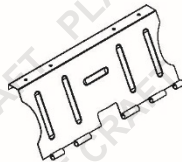

(#18) Wheel Axle Support 2pcs

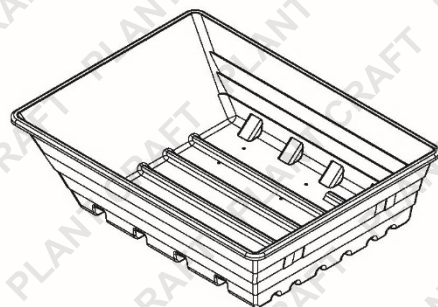

(#19) Poly Tray 1pc

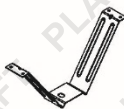

(#13) Tongue Support 1pc



(#14) Latch Stand Plate 1pc

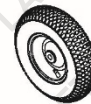

(#16) Wheel Assembly 2pcs



(#2) Hitch Pin Bracket 1pc



(#10) Release Pedal 1pc

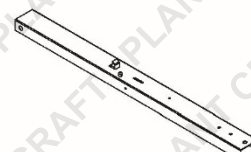

(#12) Hitch Tongue 1pc

Component Parts

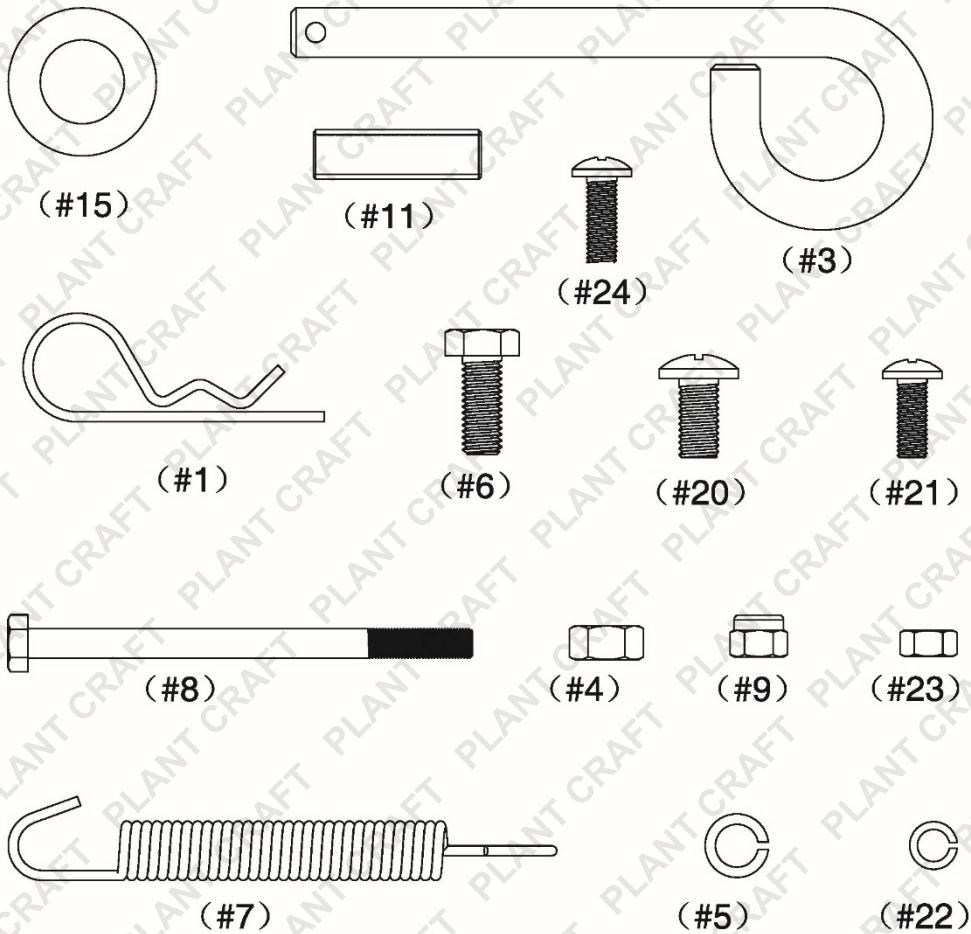

Ref#	Description	Qty
1	R Pin	4
3	Hitch Pin	1
4	Hex Nut M8	10
5	Lock Washer Ø8	10
6	Hex Bolt M8x20	2
7	Latch Spring	1
8	Hex Bolt M6x90	1
9	Nylon Lock Nut M6	1
11	Spacer	2
15	Flat Washer Ø16	4
20	Screw M8x16	8
21	Screw M6x16	4
22	Lock Washer Ø6	8
23	Hex Nut M6	8
24	Screw M6x20	4

Assembly Instructions

STEP 1: Attach Tongue Support

1. Attach the tongue support (#13) and latch stand plate (#14) to the poly tray (#19) using eight sets of M6x16 screws (#21), M6x20 screws (#24), Ø6 lock washers (#22) and M6 hex nuts (#23). **NOTE: THE HOLE ON TONGUE SUPPORT (#13) SHOULD BE ON RIGHT SIDE.**

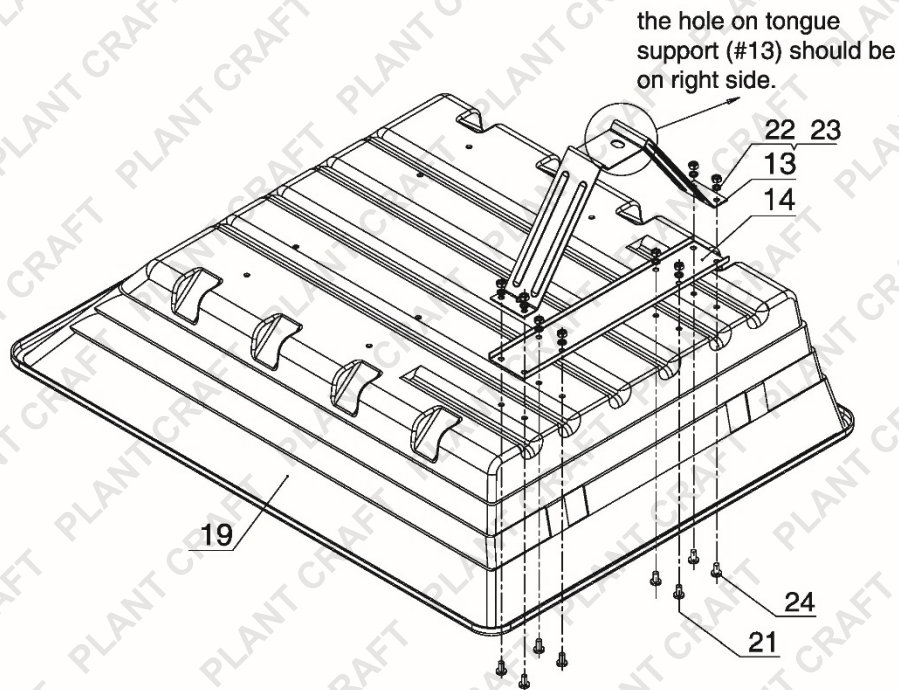

STEP 2: Attach the Wheel Axle Support

1. Attach the wheel axle supports (#18) to the back of poly tray using eight sets of M8x16 screws (#20), Ø8 lock washers (#4) and M8 hex nuts (#5).

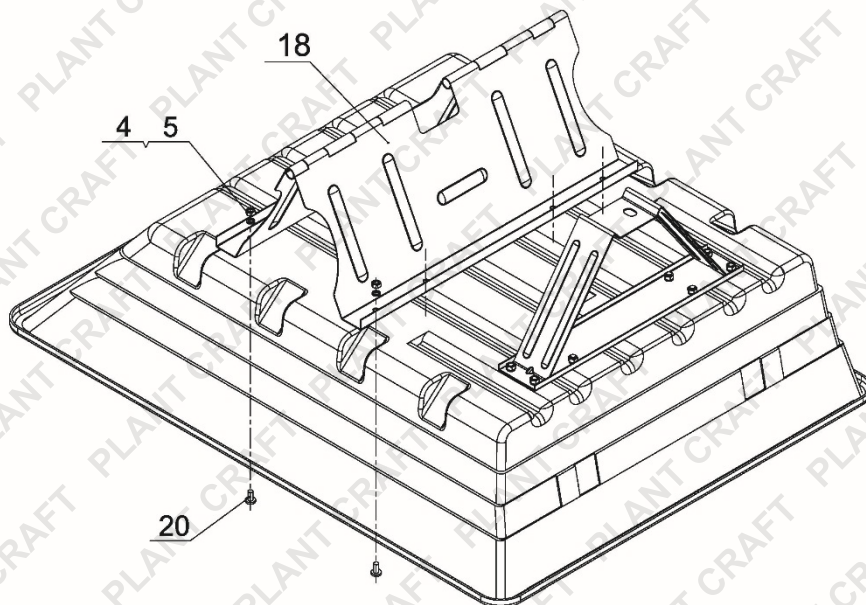

STEP 3: Attach the Wheels

1. Center the hitch tongue assembly (#12) in the wheel axle support (#18). Insert the wheel axle (#17) through the hole and slide it through both the wheel axle support (#18) and the hitch tongue assembly (#12).
2. Put an Ø16 flat washer (#15) on the axle; slide the wheel (#16) over the wheel axle (#17), followed by the second Ø16 flat washer (#15) and secure with Ø3 R pin (#1).

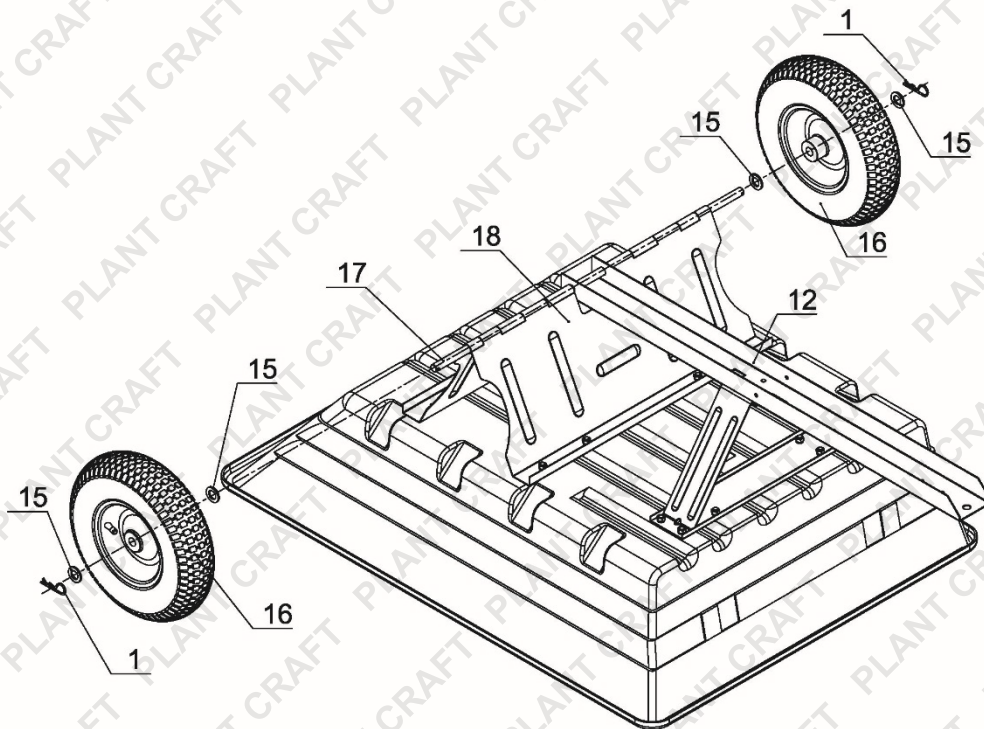

STEP 4: Attach Release Pedal

1. Insert the release pedal (#10) into the hitch tongue (#12) and secure using M6x90 hex bolt (#8) and M6 hex lock nut (#9). Put the two spacers (#11) on each side of the of the release pedal.
2. Attach the latch spring (#7) hook on the bottom hole on the release pedal (#10) and hitch tongue (#12).

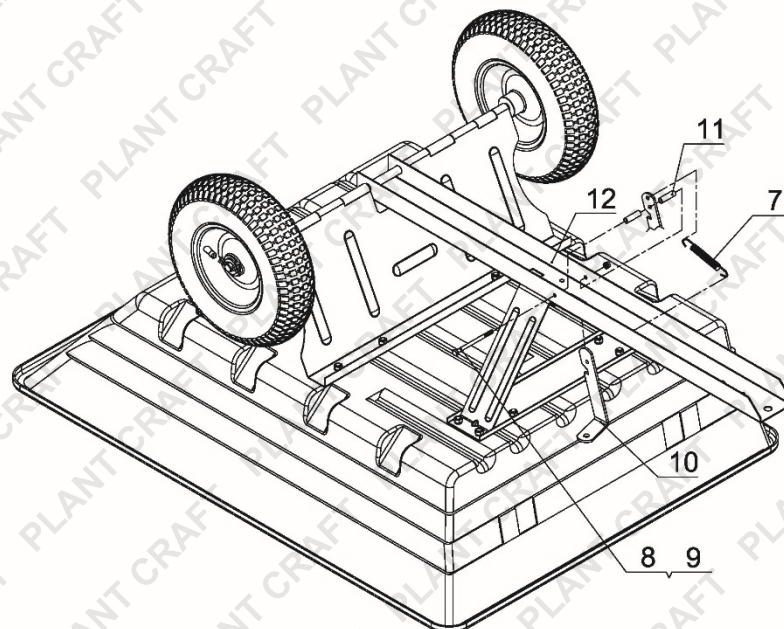

STEP 5: Attach Hitch Pin Bracket

1. Attach the hitch pin bracket (#2) to the hitch tongue (#12) using two sets of M8x20 hex bolts (#6), Ø8 lock washers (#4) and M8 hex nuts (#5), then secure with hitch pin (#3) and Ø3 R Pin (#1)

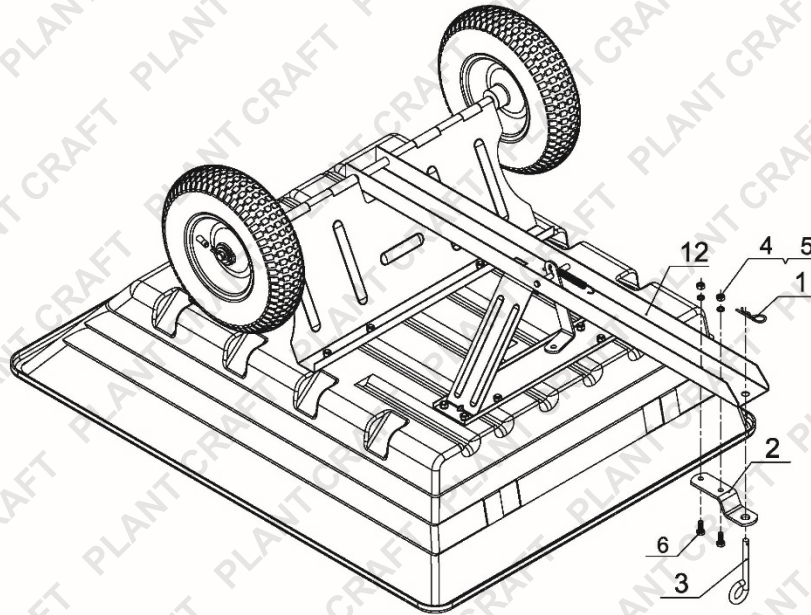

STEP 6: Attach R Pin

1. Insert the Ø3 R Pin (#1) into the safety pin on the hitch tongue.
2. Pull out the Ø3 R Pin (#1) before emptying the bed, then press the release pedal.

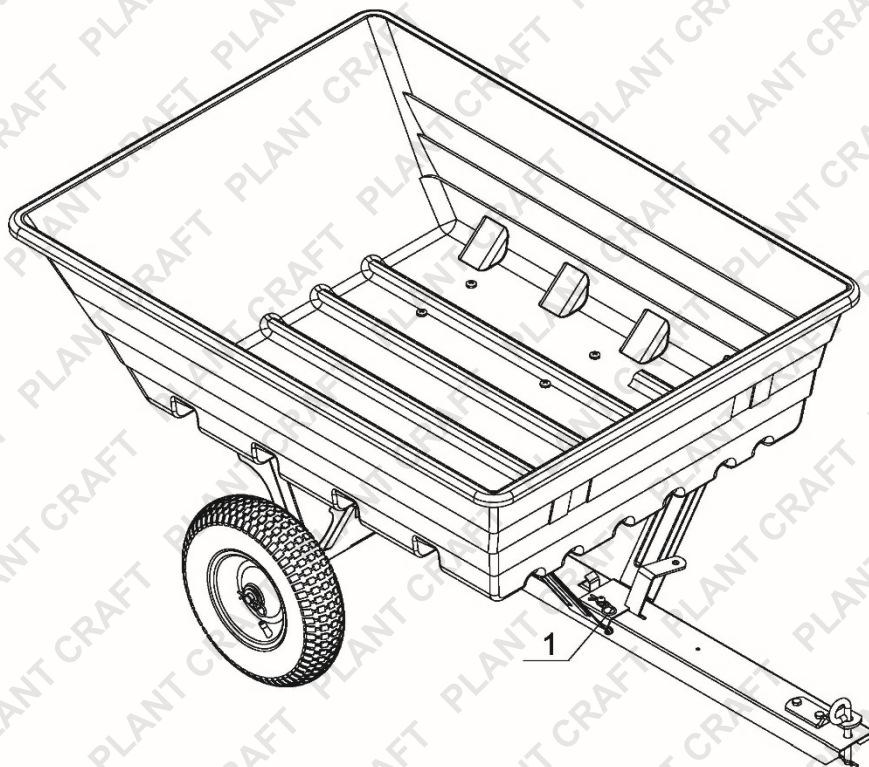

Operation Instructions

WARNING

Before using the towed dump cart, review the instructions below and safety information. Failure to follow these instructions may result in property damage or injury to the operator or bystanders.

USING YOUR TOWED DUMP CART

1. **DO NOT** exceed rated capacity of 181kg.
2. **ALWAYS** secure and lock the towed cart to the vehicle hitch before operating.
3. **ONLY** use approved vehicles when towing the dump cart (Lawn/Garden Tractors and ATVs)
4. **NEVER** tow the towed dump cart with box raised.
5. **DO NOT** over fill the towed dump cart. Over flow loads can cause the cart and towing vehicle to lose traction and skid out of control.
6. **ONLY** fill the dump cart to a comfortable dumping load. Extremely heavy loads will be difficult to operate and dump.
7. **ALWAYS** use the dump cart for its intended purpose.
8. **ALWAYS** make sure that the tow vehicle and the combined weight of the operator MUST BE greater than the load of the cart weight for proper control.
9. **DO NOT** use cart on public highways or roads.
10. **NEVER** exceed 10mph when towing the dump cart.
11. **DO NOT** make sharp turns that may cause the Lawn/Garden Tractor or ATV tyres to rub against the towed dump cart.
12. **ALWAYS** slow down before turning.
13. **ALWAYS** use caution when backing the towed cart. To avoid the cart from "jack-knifing" always back up in a straight line.

Maintenance and Storage



WARNING

Improper maintenance and storage of the towed dump cart may void your warranty.

MAINTENANCE

- After each use clean material out of the cart box.
- Rinse/dry inside and outside of the dump cart after each use.
- Before operating make sure the tyres have the RECOMMENDED TYRE PRESSURE 25 PSI.
- Regularly grease the axle and the wheel bearing area or when needed.
- Periodically check all fasteners for tightness.
- Annually clean and lightly lubricate parts.
- Use a glossy enamel spray paint to touch up scratched or worn painted metal surfaces.
- Never exceed load capacity rating of 181kg it will damage the towed dump cart.

IMPORTANT:

If a part needs replacement, only use parts that meet the manufacturer's specifications. Replacement parts that do not meet specifications may result in a safety hazard or poor operation.

STORAGE

- Never allow material to remain in the towed dump cart for extended periods of time.
- Before storing make sure the cart is clean and dry for years of trouble free service.
- Store indoors or protected area during severe weather and winter months.
- When storing outside always keep the tongue a little higher than the back of the cart to allow the moisture to easily run out the back and will not accumulate in the box.

Specifications

Load Capacity	181kg
Outside Box Dimensions.....	110cm x 84cm x 27cm
Overall Dimensions	150cm x 85cm x 66cm
Axle Dimensions.....	1.5cm x 78cm
Wheel Size	13"
Wheel Type.....	Pneumatic
Hitch Type.....	Pin Style
Tyre Pressure (PSI).....	25
Unit Weight.....	20kg



Some experts believe that the incorrect or prolonged use of almost any product may cause serious injury or death. To help reduce your risk of serious injury or death, refer to the information below. For more information, see www.datastreamserver.com/safety

- Consult all documentation, packaging and product labelling before use. Note that some products feature documentation available online. It is recommended to print and retain the documentation.
- Before each use, check the product for loose/broken/damaged/missing parts, wear or leaks (if applicable). Never use a product with loose/broken/damaged/missing parts, wear or leaks.
- Products must be inspected and serviced (if applicable) by a qualified technician every 6 months. This is based on average residential use by persons of average size and strength, and on a property of average metropolitan size. Use beyond these recommendations may require more frequent inspections/servicing.
- Ensure that all users of the product have completed a suitable industry recognised training course before being allowed access to the product.
- The product has been supplied by a general merchandise retailer that may not be familiar with your specific application or description of application. Be sure to attain third-party approval from a qualified specialist for your application before use, regardless of any assurances from the retailer or its representatives.
- This product is not intended for use where fail-safe operation is required. As with any product (for example, automobile, computer, toaster), there is the possibility of technical issues that may require the repair or replacement of parts, or the product itself. If the possibility of such failure and the associated time it may take to rectify could in any way inconvenience the user, business or employee, or financially affect the user, business or employee, then the product is not suitable for your requirements. This product is not intended for use where incorrect operation or a failure of any kind, including but not limited to, a condition requiring product return, replacement, parts replacement or service by a technician may cause financial loss, loss of employee time or an inconvenience requiring compensation.
- If this product has been purchased in error when considering the information presented here, contact the retailer directly for details of their returns policy, if required.



©2018 PlantCraft. All rights reserved. No part of this document, including descriptive content, concepts, ideas, diagrams or images may be reproduced or transmitted in any form or by any means, electronic or mechanical, including photocopying, scanning or recording, or any information storage and retrieval system, without express permission or consent from the publisher.