



"BMW" Inspired Electric Ride-On Car

User Manual

[Revision 7.0 May 2018]

READ THIS MANUAL CAREFULLY BEFORE USE AND KEEP FOR FUTURE REFERENCE – FAILURE TO DO SO MAY RESULT IN INJURY, PROPERTY DAMAGE AND MAY VOID WARRANTY. • Products covered by this manual may vary in appearance, assembly, inclusions, specifications, description and packaging.

THE BATTERY MAY HAVE SOME CHARGE ON ARRIVAL, IT IS IMPORTANT HOWEVER THAT THE BATTERY IS CHARGED PRIOR TO USE.

Table of Contents

Safety	3
Battery Information	5
Battery Charging	5
Charging the Battery	6
Battery Care and Disposal	6
Battery Care	6
Battery Disposal	6
Parts Identification	7
Assembly	8
Operation	11
Controls	11
Driver Mode Operation	12
Remote Control Mode Operation	12
Pairing	13
Troubleshooting	14
Maintenance	15
Specifications	15

Safety

It is very important to read the instructions here carefully before using the electric ride-on car. The instructions not only specify the assembly process and proper operation, but also help you to avoid injuries or damaging the product due to incorrect operation.

This product can be operated in either driver or remote control modes.

- **WARNING!** Choking hazard – small parts included. Not suitable for children under 3 years of age.
- **CAUTION!** Ride-on car operation must always be under adult supervision. Although most children can master the physical driving skills to control the vehicles, they do not have mature judgment skills. Never let a child drive at any time without adult supervision, and take the time to carefully evaluate child's skill levels and abilities to operate the vehicle safely. Children cannot always recognize hazards even after instruction. So teach appropriate safety rules before allowing any child to operate vehicle.
- **Maximum load capacity = 30kg.**
- This product should be assembled by an adult or checked by an adult to make sure that it is properly assembled.
- An adult should inspect the ride-on car at regular intervals for wear or loose hardware and tighten as required. Do not use the vehicle if abnormal conditions such as cracks or breaks exist.
- Do not operate the ride-on car on public streets or roads, near moving vehicles, steep inclines or steps, near swimming pools, or any other potentially dangerous areas.
- The ride-on car is designed for outdoor use on suitable surfaces and in dry conditions. Do not operate in the dark, on sand or gravel, dirt, grass, uneven or rough ground. Running the car indoors may cause damage to flooring or other items.
- The remote control should only be operated by adults or under adult supervision.
- When the remote control batteries are running low, the effective range of the remote control is reduced. Replace with new batteries.
- This ride-on car must not be overloaded or used to push or pull other objects.
- This ride-on car is suitable for children aged 3 and up.
- Some parts of the ride-on car could be damaged because of improper operation.
- Do not suddenly switch between forward and reverse when the ride-on car is running. Switch between forward and reverse only when the ride-on car is stationary.
- Clean the ride-on car with a clean cloth. Do not spray or immerse the ride-on car with water, which might damage the circuits.
- This product is made of plastics. Keep it away from fire or other sources of heat.
- The electric motors could produce sparks. Do not run the ride-on car in flammable and explosive areas such as a petrol station.
- Do not allow children near or touch moving parts when the car is running. Keep other children away from the ride-on car when it is running.
- The packaging of the ride-on car is not a toy and should be disposed of responsibly.
- Adults are required to read these instructions carefully and give correct guidelines to children on how to safely operate the ride-on car before using it. Instruction should include:
 - Starting, stopping and steering.
 - One rider only at a time, and always sit in the seat.
 - Wear shoes.
 - Do not place hands, feet or any part of the body, clothing or other articles near moving parts while the vehicle is in operation.
- The seat belt is a decoration only to develop a sense of safety in children; it cannot provide any substantial protection.

"BMW" Inspired Electric Ride-On Car

- If the ride-on car malfunctions, do not use it until it is repaired.
- **CAUTION!** When charging or replacing the vehicle battery, pay attention to the following:
 - Failure to follow instructions on correct battery maintenance may permanently damage the battery and will void the warranty.
 - **The vehicle battery must be fully charged before first use - initial battery charge is 10 hours.**
 - **Charge the battery at least once a month, even if the vehicle is not in use.**
 - A damaged battery may leak or produce hazardous substances – use adequate precautions when handling batteries.
 - Never modify the electrical system. Use of the wrong type battery or charger could cause a fire or explosion.
 - The battery charger is not a toy and must be regularly examined for damage to the cord, plug, enclosure and other parts. In the event of damage, the damage or worn part must not be used until replaced.
 - The battery compartment and area under seat are not storage areas. Storing other articles may create a fire hazard.
 - Battery charging should be performed by adults only.
 - Battery replacement should be performed by adults only.
 - Install batteries correctly according to polarity.
 - Keep the supply terminals from short-circuiting.
 - Never attempt to recharge non-rechargeable batteries.
 - Dispose of used batteries in an environmentally responsible manner.
 - Do not expose batteries to excessive heat, flammable or corrosive substances.
 - Take out the batteries if the ride-on car will not be used for an extended period of time. Always remove used batteries.

Battery Information



WARNING!

PREVENT FIRE

- Never modify the electrical system. Alterations could cause a fire resulting in serious injury and could also ruin the electrical system.
- Use of the wrong type battery or charger could cause a fire or explosion resulting in serious injury. Only batteries of the same or equivalent type as recommended are to be used.
- The battery must be handled by adults only. The battery is heavy and contains sulphuric acid (electrolyte). Dropping the battery could result in serious injury.
- Battery charging or replacement must be performed by adults only.
- Never lift or carry the battery by wires or connectors. This can damage the battery and possibly cause a fire. Lift and carry the battery by the case only.
- Read the safety Instructions on the battery.
- Examine the battery, charger and their connectors for excessive wear or damage each time you charge the battery. If damage or excessive wear is detected, do not use the charger or the battery until you have replaced the worn or damaged part.
- Only use the battery charger in dry locations.

Thermal Fuses

The vehicle is equipped with a built-in thermal fuse. The fuse is a self-resetting safety device that shuts down the vehicle if it is overloaded. Once a fuse has tripped it will automatically reset after approximately 10 seconds and allow the vehicle to resume normal operations. To avoid repeated tripping, do not overload the vehicle by exceeding the maximum weight capacity. Avoid inappropriate driving conditions, such as steep slopes or against fixed objects, which can cause the wheels to stop spinning while power is being supplied to the motors.

If a thermal fuse in a battery continually trips under normal operating conditions and loads, have the vehicle inspected by an authorized service center or technician.

IMPORTANT NOTES

- Never recharge non-rechargeable batteries.
- The battery can fall out and cause injury if the vehicle overturns. Always use the battery cover.
- The battery must be charged for 10 hours before using it for the first time.
- You do not need to remove the battery from the vehicle to recharge it.
- The battery must be upright while charging.
- Do not short-circuit the battery or battery supply terminals.
- Before charging the battery, examine the battery case for cracks or other damage which may cause sulphuric acid (electrolyte) to leak during charging. If damage is detected, do not charge the battery or use it. Battery acid is highly corrosive and can cause severe injury to persons and damage to surfaces it contacts.
- Do not charge the battery on a surface that could be damaged by the acid in the battery. Take precautions to protect surfaces where the battery is charged.
- If the battery is old and will not accept a charge, do not leave it in the vehicle. Always remove unserviceable batteries.

Battery Charging



CAUTION!

- Never recharge non-rechargeable batteries.
 - Do not charge the battery for more than 10 hours continuously.
 - Ensure the charger connector matches the vehicle battery charger port connector.
 - Ensure the voltage and frequency of the charger is compatible with mains electrical supply.
 - Do not short-circuit the battery or battery supply terminals.
-

Charging the Battery

NOTE: The first battery charge requires approximately 10 hours. Subsequent charges require 8 to 10 hours.

1. Insert the battery charger connector into the charger port located under the seat.
2. Plug the charger into a standard 240VAC wall socket and switch it ON. The charger may feel warm during charging. This is normal and not a cause for concern.
3. After charging is complete, unplug the charger from the wall outlet and unplug the battery connector from the charger port.



Battery Care and Disposal

NOTE: To prolong battery life and maximize battery performance, you must recharge the battery after each use. You must also charge the battery at least once a month, even when not in use.

Battery Care

- If a battery leak develops, avoid contact with the leaking acid and place the damaged battery in a suitable container for disposal.
- If battery acid comes in contact with skin or eyes, call a physician immediately and flush with cool water for at least 15 minutes.
- If battery acid is ingested, call a physician and give water or milk immediately. Do not induce vomiting.
- Charge new batteries for 10 hours before first use.
- Never charge the batteries longer than 10 hours continuously.
- Over-charging or under-charging the battery may shorten battery life and decrease vehicle running time.
- After the first charge, recharge the batteries for 8 to 10 hours after each use. Charge the batteries after each use, regardless of how long the vehicle was used.
- The vehicle must be upright while charging.
- Do not allow the batteries to discharge completely before charging.
- Charge the batteries before storing the vehicle.
- Leaving the batteries in a discharged condition will destroy them.
- If the vehicle will be stored for more than 2 months, be sure to disconnect the motor harness from the batteries.
- Do not store batteries in temperatures above 40°C (104°F) or below -23°C (-10°F).
- Always secure the battery in the battery compartment using the battery cover and four locating screws. Adequately tighten all screws.
- Examine the batteries, charger and its connector for excessive wear or damage each time you charge the batteries. If damage is detected, do not use the charger or the batteries until you have replaced the worn or damaged parts.
- Always remove an unserviceable batteries from the vehicle.
- Battery leakage can damage the vehicle.

Battery Disposal

- The batteries are a sealed lead-acid type. Recycle or dispose of batteries in an environmentally responsible manner.
- Never dispose of batteries as normal rubbish. The mixing of lead-acid batteries with household rubbish is prohibited in most areas.
- Never burn or dispose of batteries in a fire.

Parts Identification

NOTE: Identify all parts before assembly and save all packaging material until assembly is completed to ensure that no parts are discarded. • Metal parts may be coated with lubricant for protection during shipment. Wipe all metal parts with a paper towel to remove any excess lubricant. • Assemble the vehicle according to instructions. Due to manufacturing techniques it is possible that some parts are over-supplied. • Plastic "socket spanners" for the wheel nuts are supplied, however, screwdrivers and pliers may also be required for assembly.

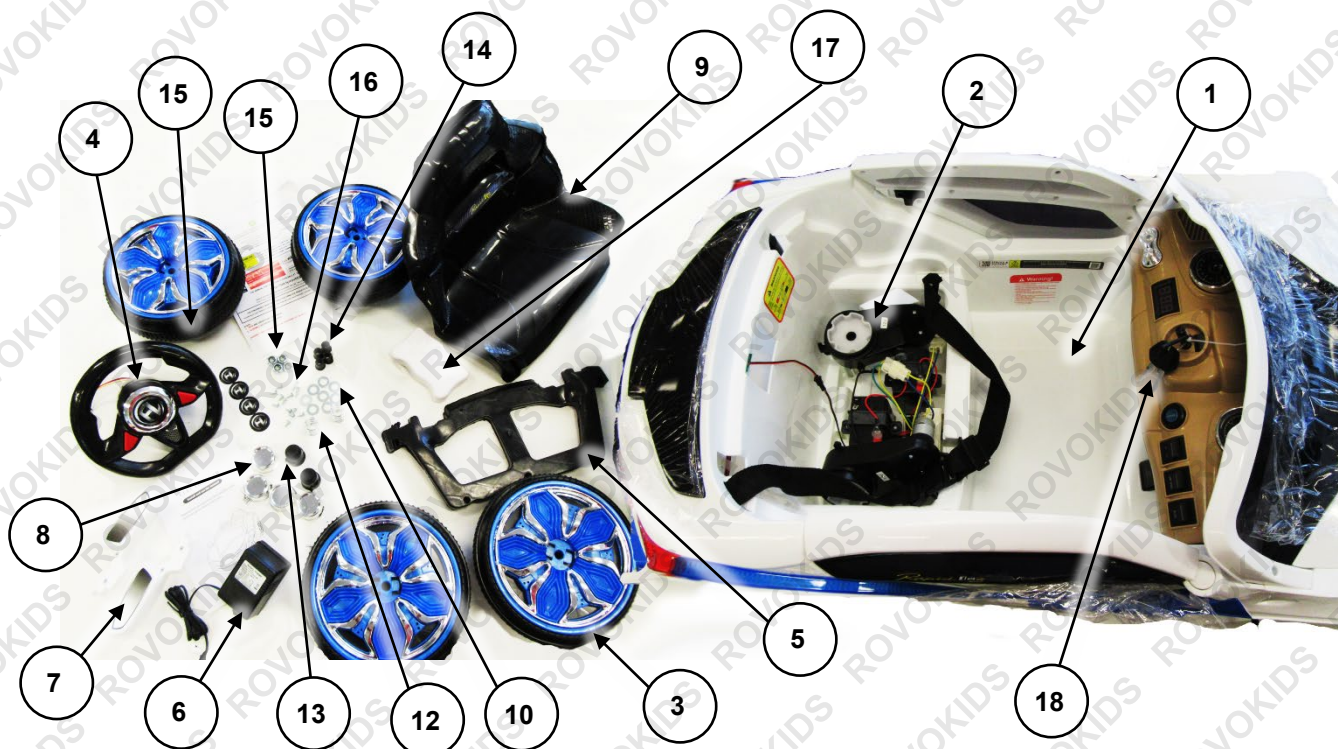

No.	Name	No.	Name
1	Vehicle Body	10	Washer (6)
2	Drive Motor Assembly (2)	11	Rear Axle (not shown)
3	Wheel (4)	12	Rear Suspension Spring (2)
4	Steering Wheel	13	Rear Suspension Mount (2)
5	Rear Body Support	14	Axle Bush (4)
6	Battery Charger	15	Wheel Nut (4)
7	Wing Mirror (2)	16	Self-Tapping Screw (9)
8	Wheel Cap and Stickers (4)	17	Remote Control
9	Seat	18	"Ignition" Keys

Video Tutorial:

[Typical Ride-On Car Assembly](#)



Assembly



CAUTION! Children may be harmed by small parts, sharp edges and points or electrical components when the vehicle is unassembled. Care should be taken to not allow children near parts when unpacking and assembling the vehicle.

1. Disconnect and remove the drive motor assemblies from inside the vehicle, then turn the vehicle over.
2. Install the rear body support to the vehicle body.

- Place the rear body support (A) in position so that it sits beneath the lip at the rear of the vehicle and is aligned with the attachment holes.
- Attach the rear body support to the vehicle at points marked "X" using 7 self-tapping screws. Tighten (rotate right) the screws using a Phillips head screwdriver, however, be careful not to over-tighten the screws as they are screwing into plastic.



3. Install the rear axle, suspension and (driven) wheels.

- Place a rear suspension spring (B) on the end of a rear suspension mount (C) and insert it into the recesses in the vehicle body. Ensure that the holes in the rear suspension mounts face the direction of the axle.
- Slide the rear axle (D) through the slot (E) in the vehicle body and through the suspension mounts. Slide it through so that it is central to the vehicle.
- Place a washer (F) and axle bush (G) onto the ends of the axle, then slide the drive motor assemblies (H) on – ensure that the drive motor passes through the hole in the vehicle body.
- Place each wheel, with drive gear facing inward, onto the axle. Ensure that the drive teeth engage the drive motor assemblies correctly, then place a washer (I) and wheel nut (J) onto the ends of the axle. Tighten (rotate right) both wheel nuts at the same time (plastic "socket spanners" (L) may be supplied for this), however, not so much as to bind the wheels or slow their rotation. Push a wheel cover (K) into the centre of each wheel until it clips into place.

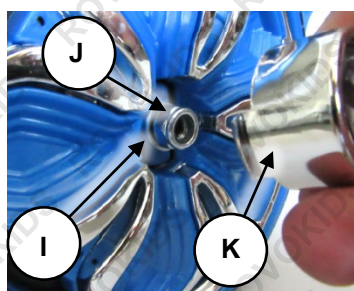
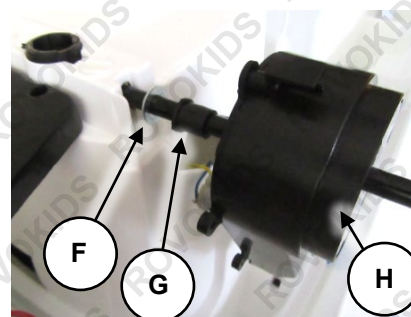
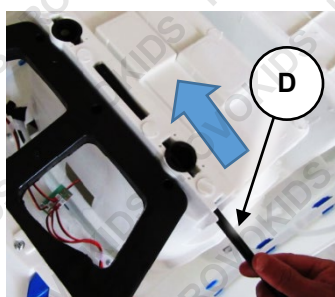
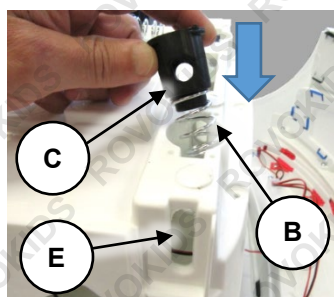

"BMW" Inspired Electric Ride-On Car

4. Install the front wheels.

- Place a washer (**M**) and axle bush (**N**) onto each axle (**O**).
- Place a wheel onto each axle, then secure with a washer and wheel nut. Tighten the nut securely (plastic "sockets" may be supplied for this), however, not so much as to bind the wheels or slow their rotation. Push a wheel cover into the centre of each wheel until it clips into place.

5. Turn the vehicle over so it is sitting on its wheels.

6. Install the steering wheel.

- Remove the screw and nut from the steering wheel stem. Plug the vehicle and steering wheel electrical connectors (**P** and **Q**) together. Feed excess wire into the steering column housing (**S**).
- Ensure the front wheels are straight then slide the steering wheel stem (**T**) onto the steering shaft (**S**) – ensure that the steering wheel stem screw hole aligns with the hole in the shaft.
- Insert the nut (**U**) into the recess in the steering wheel stem. Insert the screw (**V**) from the other side of the steering wheel stem, passing through the steering shaft and into the nut. Adequately tighten the screw with an appropriate screwdriver.

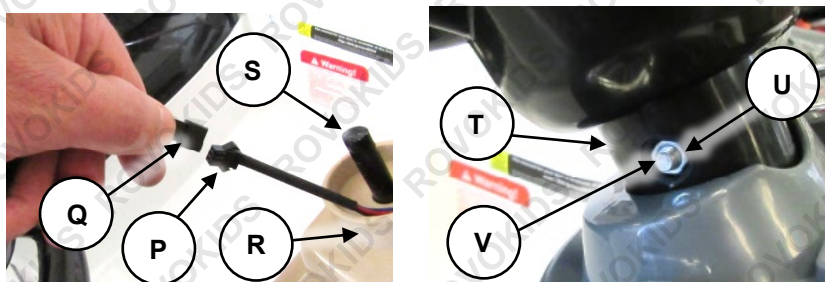
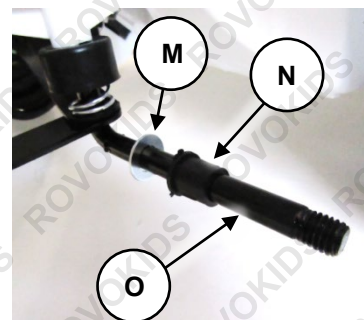

7. Install the wing mirrors.

- Place each wing mirror (**W**) into position and push it into the hole (**X**) until it "clicks" into place.

8. Connect the drive motor assemblies and batteries.

- Align the drive motor assembly and vehicle wiring harness connectors (**Y** and **Z**), then push them together until the connectors "click". Ensure that you connect both drive motor assemblies.
- Firmly push the unconnected battery wire (**AA**) onto the free battery terminal (**AB**). Once connected, the batteries can be charged using the vehicle charging port.

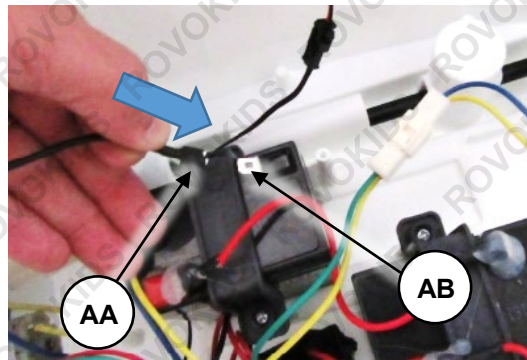
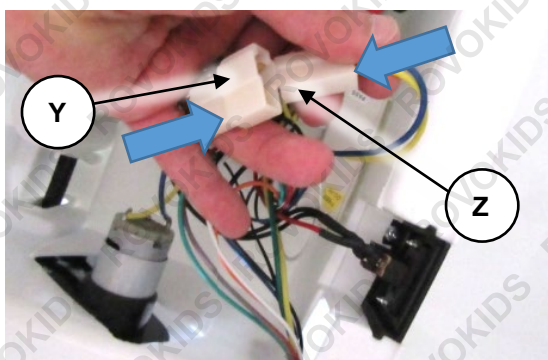
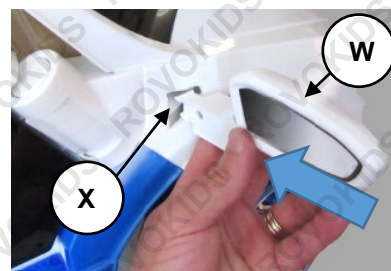

9. Install the seat (this also acts as a battery cover).

- Ensure no wires can be crushed or pinched when the seat is installed. Unbuckle the seat belt if required and move it to the edges of the vehicle.
- Align the tabs (**AD**) at the rear of the seat (**AC**) with the slots in the vehicle body and slot it into position.

- Attach the seat to the vehicle at points marked "X" using 2 self-tapping screws. Tighten (rotate right) the screws using a Phillips head screwdriver, however, be careful not to over-tighten the screws as they are screwing into plastic.

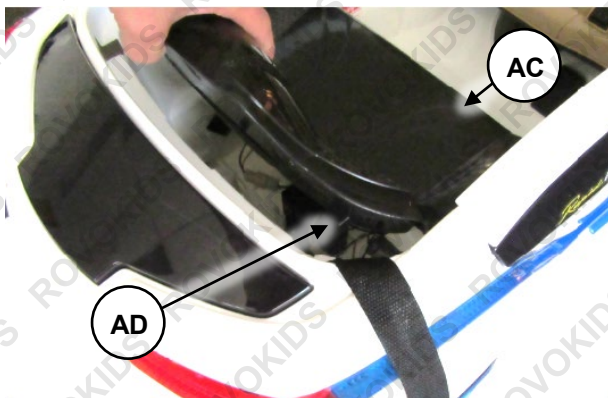

NOTE: Please remove the terminal cover first when assembling the battery (see image below).



Assembly is now complete.

Operation

Controls

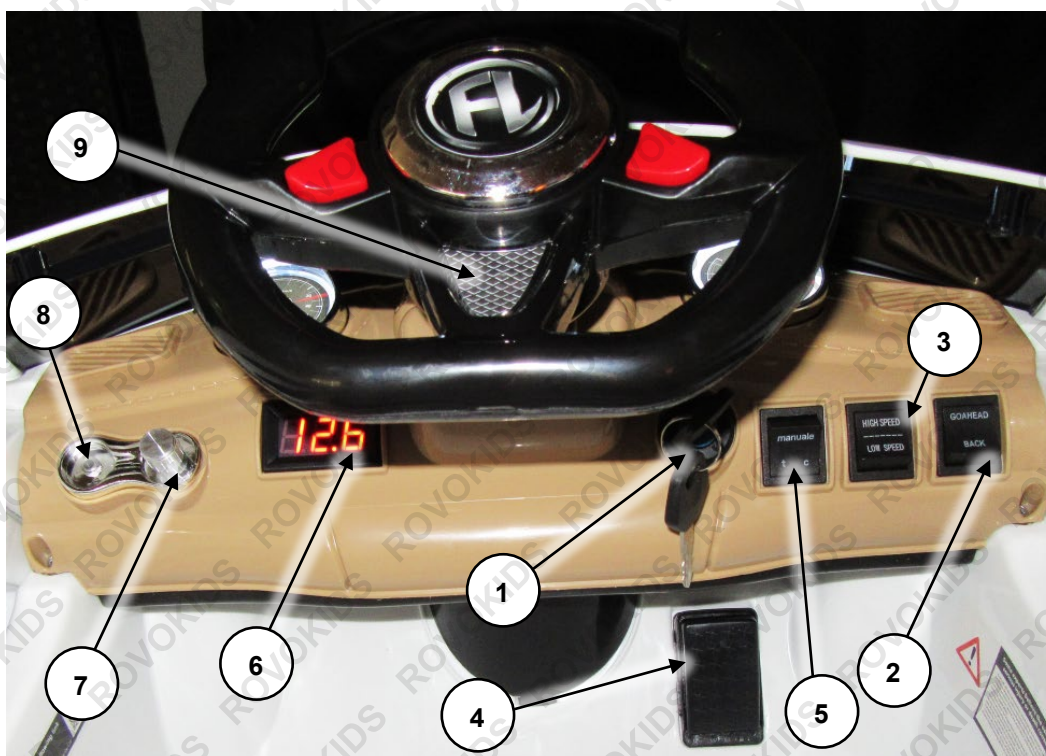

No.	Name	Description
1	ON/OFF "Ignition Key"	Insert key and rotate one stop to the right to "start" the vehicle. When the vehicle has been started, controls illuminate and sounds play. Rotate two stops to the right to "start" the vehicle and also activate all light effects. Rotate left to "stop" the vehicle.
2	Direction Control Switch	Sets the desired direction of travel: Go Ahead – Travel forward. Back – Travel backward. <i>Middle Position</i> – Prevent movement.
3	Speed Control Switch	Controls speed of vehicle travel: High Speed – Travel at maximum speed. Low Speed – Travel at minimum speed. <i>Middle Position</i> – Prevent movement.
4	Accelerator Pedal	Press to travel in the direction set using the direction control (forward or reverse). Release to stop the vehicle.
5	Master Control Switch	Sets how the vehicle operated: Manual – The rider controls the vehicle (the remote control will still over-ride manual control). <i>Middle Position</i> – Prevent movement. <i>Lower Position</i> – The remote control only can be used to control the vehicle.
6	Battery Voltage Indicator	Shows the current battery voltage.
7	Volume Control	Sets vehicle/music volume. Rotate right to increase volume; rotate left to decrease volume
8	Music Player Connector	Connector for attaching an external music player to the vehicle music system.
9	Steering wheel and sound controls	When the vehicle is moving, rotate the steering wheel as required to change direction. Press the buttons to activate various sounds and music play functions.

Driver Mode Operation

1. Ensure the "driver" is correctly and safely seated in the vehicle and the seat belt is buckled.
2. Insert the key and rotate to the right to "start" the vehicle. On starting, the vehicle will play various sounds.
3. Select the direction of travel using the direction control switch.
4. Select the desired speed, activate headlights, music etc.
5. Press the accelerator pedal to begin moving. Release the accelerator to stop.
6. When finished, rotate the key left to switch the vehicle off.

Remote Control Mode Operation

NOTE: Batteries (not included) must be properly installed in the remote control handset. • The remote control must be "paired" with the vehicle for remote control mode operation (see [Pairing](#)).

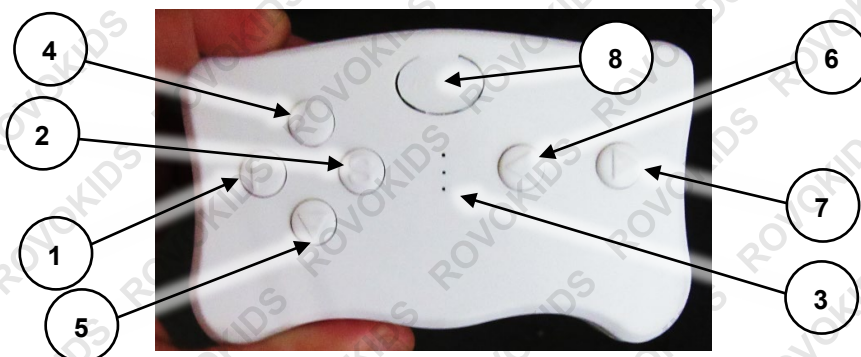

No.	Name	Description
1	P	Used to immediately stop the vehicle, even if the rider is controlling it. The vehicle will remain stopped and the rider will not be able to activate the vehicle again until P is pressed a second time.
2	S	Used to control vehicle speed when under remote control operation. Press repeatedly to step between speeds. There are three possible speeds, each indicated by the speed indicator (3).
3	Speed Indicator	Shows the current speed setting. 1 light = low speed, 2 lights = medium speed, 3 lights = high speed. This is also used when " pairing ".
4	△	Used to move the vehicle in the forward direction. Press and hold as required.
5	▽	Used to move the vehicle in the reverse direction. Press and hold as required.
6	◁	Used to set vehicle direction to the left. Press and hold as required. Note that when the button is released, the vehicle wheels do not automatically return to center.
7	▷	Used to set vehicle direction to the right. Press and hold as required. Note that when the button is released, the vehicle wheels do not automatically return to center.
8	Pairing Button	Used to "pair" the remote control and vehicle.

Pairing

"Pairing" means to set the communications between the remote control and the vehicle so that the vehicle responds to the remote control. If pairing is not carried out, the remote control will not function. Pairing needs to be carried out before first use and also each time the remote control batteries are replaced. It is recommended to have the vehicle and remote control no more than 5m apart when pairing. To pair:

1. Ensure your car is in the off position.
2. On the remote control, press and hold the pairing button for 2-4 seconds. When the low speed indicator light on the remote begins to flash, release the pairing button.
3. Switch the vehicle on. The pairing should now be successful.
4. Check the Master Control Switch is correctly set to allow remote operation (see [Controls](#))

Note: If the pairing fails, remove the batteries from the remote control and then re-install them. Then repeat the pairing procedure.

Remote control operation allows an adult to stop or steer the vehicle when in driver mode. For example, to prevent the vehicle being driven into an obstacle etc.

1. To stop the vehicle, press **P**.
2. To steer the vehicle, use ◀ and ▶.



CAUTION! When stopped using the remote control, the vehicle will immediately become available in driver mode when **P** is released. This means that if the child is still pressing the accelerator, when you release **P**, the car will continue moving. • When using the remote control handset to steer the vehicle, the child may still use the steering wheel to also change direction.

Full remote control is available and is useful for children not able to correctly operate the vehicle. To use full remote control mode:

1. Start the vehicle and set the master control switch to the lowest position.
2. Use the remote control handset to control vehicle movement.

Troubleshooting

Malfunction	Analysis	Solution
<i>Car moves in reverse direction to controls</i>	1. Drive motors connected incorrectly.	1. Swap the vehicle wiring harness to drive motor assembly connections.
<i>Car not running or car was running but suddenly stopped</i>	2. Fuse tripped. 3. Electrical connections not secure. 4. Dead battery. 5. Under-charged battery. 6. Battery charger not working. 7. Main body electrics or switches damaged.	2. Vehicle being overloaded or driven on unsuitable surfaces. Fuse resets after 10 seconds. Unload vehicle (30kg max.) and/or move to suitable surface. 3. Check all wires and connections. Ensure vehicle and battery electrical harness is fully connected. Ensure no motor wires are loose or disconnected. 4. Vehicle battery no longer holding charge or serviceable. Have battery checked by authorized service center or replace. 5. Charge battery and ensure battery charging and care procedures are followed. 6. Have charger professionally checked. If not working – replace. 7. Seek diagnosis and repair from authorized service center.
<i>Short operating time – less than 1 hour per charge</i>	1. Under-charged battery. 2. Over-charged battery. 3. Old or faulty battery will not take full charge.	1. Charge battery and ensure battery charging and care procedures are followed. 2. Vehicle battery no longer holding charge or serviceable. Have battery checked by authorized service center or replace. 3. Expected vehicle battery life is 1 to 3 years depending on care, use and conditions. Have battery checked by authorized service center or replace.
<i>Vehicle sluggish</i>	1. Under-charged battery. 2. Old or faulty battery will not take full charge. 3. Vehicle overloaded.	1. Charge battery and ensure battery charging and care procedures are followed. 2. Expected vehicle battery life is 1 to 3 years depending on care, use and conditions. Have battery checked by authorized service center or replace. 3. Vehicle being overloaded or driven on unsuitable surfaces. Unload vehicle (30kg max.) and/or move to suitable surface.
<i>Intermittent running</i>	1. Electrical connections not secure. 2. Main body electrics or switches damaged.	1. Check all wires and connections. Ensure vehicle and battery electrical harness is fully connected. Ensure no motor wires are loose or disconnected. 2. Seek diagnosis and repair from authorized service center.
<i>Vehicle requires a push to get running</i>	1. Electrical connections not secure. 2. Motor has “dead” spot.	1. Check all wires and connections. Ensure vehicle and battery electrical harness is fully connected. Ensure no motor wires are loose or disconnected. 2. Seek diagnosis and repair from authorized service center.
<i>Gear box noisy</i>	1. Broken or damaged gears.	1. Seek diagnosis and repair from authorized service center.
<i>Battery gets warm during charging</i>	Normal operation.	None required

Malfunction	Analysis	Solution
<i>Faint sounds and heating from battery when charging</i>	Normal chemical reaction.	<i>None required</i>

Maintenance

- If the ride-on car is damaged, do not use it until it is repaired by an authorized service center.
- An adult should inspect the ride-on car at regular intervals for wear or loose hardware and tighten as required. Do not use the vehicle if abnormal conditions such as cracks or breaks exist.
- This product should be assembled by an adult or checked by an adult to make sure that it is properly assembled.
- Clean the ride-on car with a clean cloth. Do not spray or immerse the ride-on car with water, which may damage its electronics.

Specifications

Net Weight	14kg
Battery Type	6V 4.5Ah (2)
Charger Type	12VDC 1000mA (output)
Range	1 to 2 hours (full charge)
Charge Time	8 to 10 hours generally (full charge)
Remote Control Operation	Yes
Remote Control Battery	2 x AA (not included)
Maximum Rider Weight	30kg



Some experts believe the incorrect or prolonged use of almost any product could cause serious injury or death. For information that may reduce your risk of serious injury or death, consult the points below and additionally, the information available at www.datastreamserver.com/safety

- | | |
|--|--|
| <ul style="list-style-type: none">• Consult all documentation, packaging and product labelling before use. Note that some products feature online documentation which should be printed and kept with the product.• Check product for loose / broken / damaged / missing parts, wear or leaks (if applicable) before each use. Never use a product with loose / broken / damaged / missing parts, wear or leaks (if applicable).• Products must be inspected and serviced (if applicable) by a qualified specialist every 6 months assuming average residential use by a person of average weight and strength, above average technical aptitude, on a property matching average metropolitan specification. Intended use outside these guidelines could indicate the product is not suitable for intended use or may require more regular inspection or servicing.• Ensure all possible users of the product have completed an industry recognized training course before being given access to the product. | <ul style="list-style-type: none">• The product has been supplied by a general merchandise retailer that may not be familiar with your specific application or your description of the application. Be sure to attain third-party approval for your application from a qualified specialist before use regardless of prior assurances by the retailer or its representatives.• This product is not intended for use where fail-safe operation is required. As with any product (take an automobile, aircraft, computer or ball point pen for example), there is always a small chance of technical issues that needs to be repaired or may require replacement of the product or a part. If the possibility of such failure and the associated time it takes to rectify could in any situation inconvenience the user, business or employee then the product is not suitable for your requirements. This product is not for use where incorrect operation or a failure of any kind, including but not limited to a condition requiring product return, replacement, service by a technician or replacement of parts could cause a financial loss, loss of employee time or an inconvenience requiring compensation.• If this item has been purchased in error after considering the points above, simply contact the retailer directly for details of their returns policy, if required. |
|--|--|



©2018 Rovo Kids. All rights reserved. No part of this document, including descriptive content, concepts, ideas, diagrams or images may be reproduced or transmitted in any form or by any means, electronic or mechanical, including photocopying, scanning or recording, or any information storage and retrieval system, without express permission or consent from the publisher.