

## ● INSTALLATION AND OPERATION

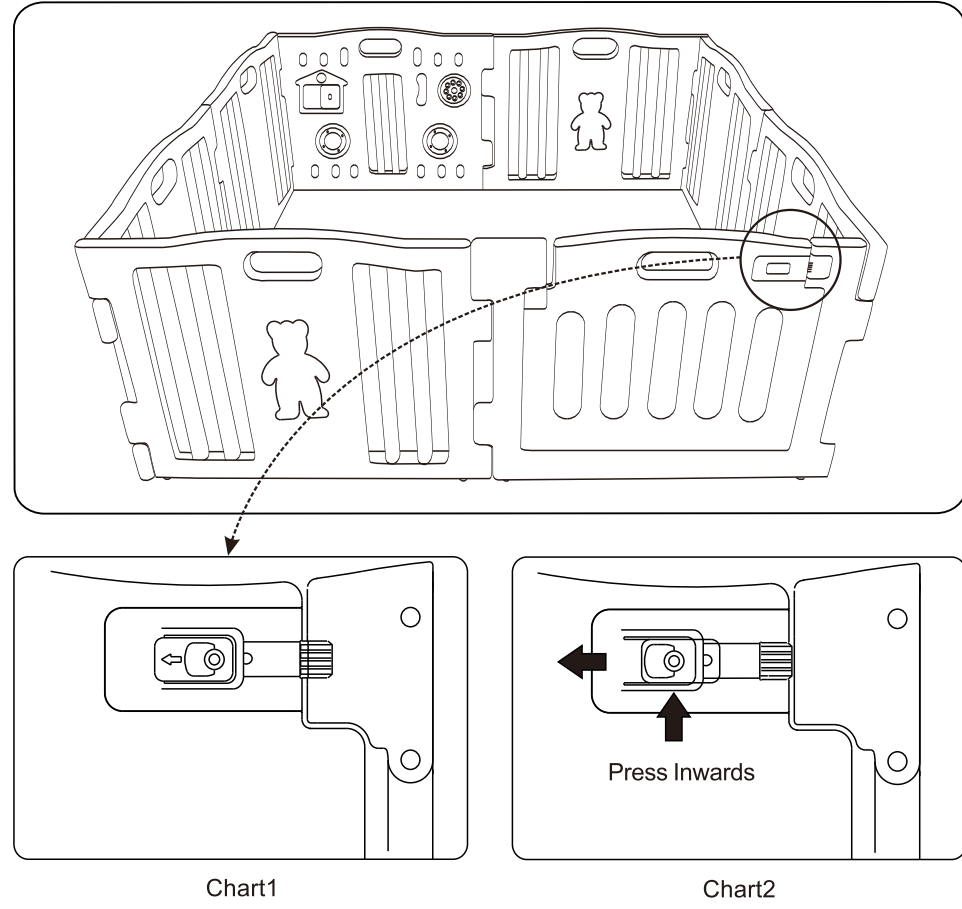
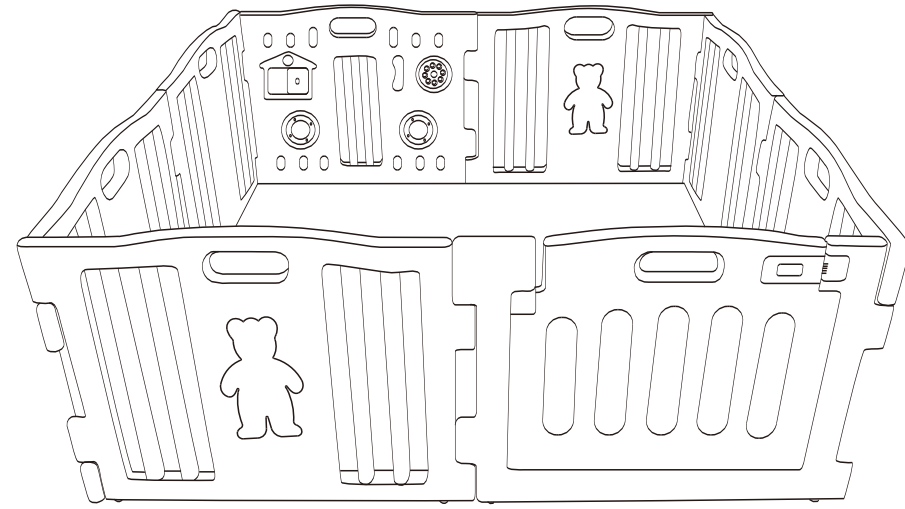

Chart 1, when the gate is closed, ensure the gate is secure by placing the latch in the "lock" position. To open the gate, move the latch to "OPEN". Releasing the switch from the open position will restore the latch to "LOCK" position(chart2)

**WARNING:** When your child is in the playpen. For your child's safety, make sure the locking device is locked.

## SAFETY PLAYPEN USE MANUAL



## SAFETY PLAYPEN USE MANUAL

### ! WARNING:

- Never leave child unattended. This product may not prevent all accidents.
- This product intended for use with children above 6 months.
- Ensure this product is installed on the flat floor. Never install in stairway, kitchen, incline and some dangerous area.
- To prevent serious injury or death securely. Install this product according to manufacturer's instructions.
- Make sure the bottom of the frame is on the same flat surface as the floor.
- Always be sure the product is securely fixed.
- Install this product away from open flames and heat sources.
- Never use with a child able to climb over or open the gate or enclosure.
- The toy is intended to be assembled by adult

## ● INSTALLATION AND OPERATION

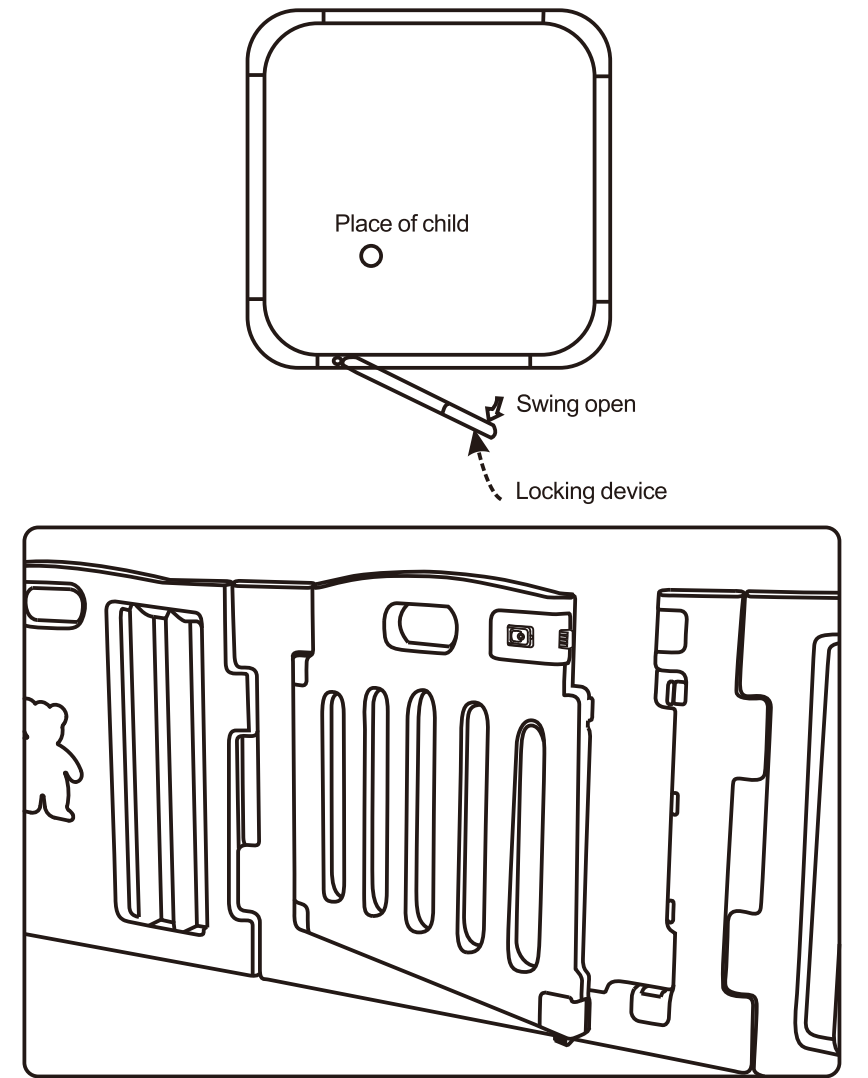

**WARNING:** Make sure the side of gate panel with locking device is on the side away from the child.

-1-

-6-

## SAFETY PLAYPEN USE MANUAL



## SAFETY PLAYPEN USE MANUAL



## ● PLASTIC CONNECTION INSTALLATION

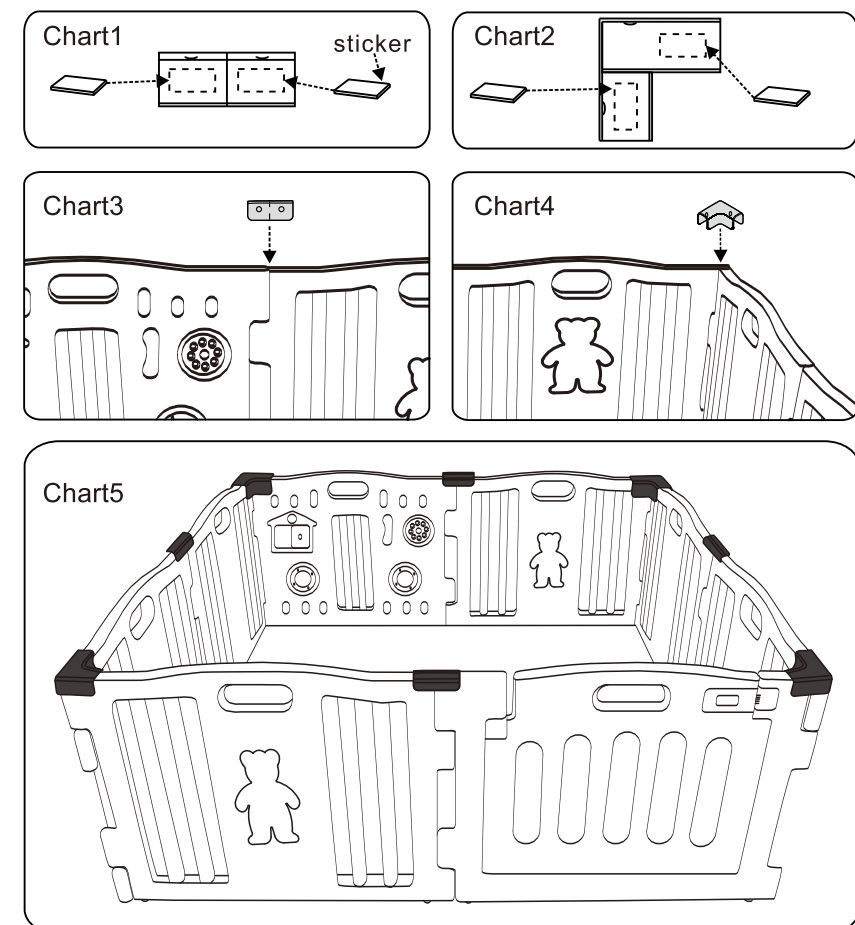

Paste the sticker at the back of plastic connection.(chart 1,chart 2)  
Insert the straight connection between two parallel panels.(chart 3)  
Insert the angle connection into two corner panels.(chart 4)  
Installation is finished.(chart 5)

-5-

## ● PART NAME

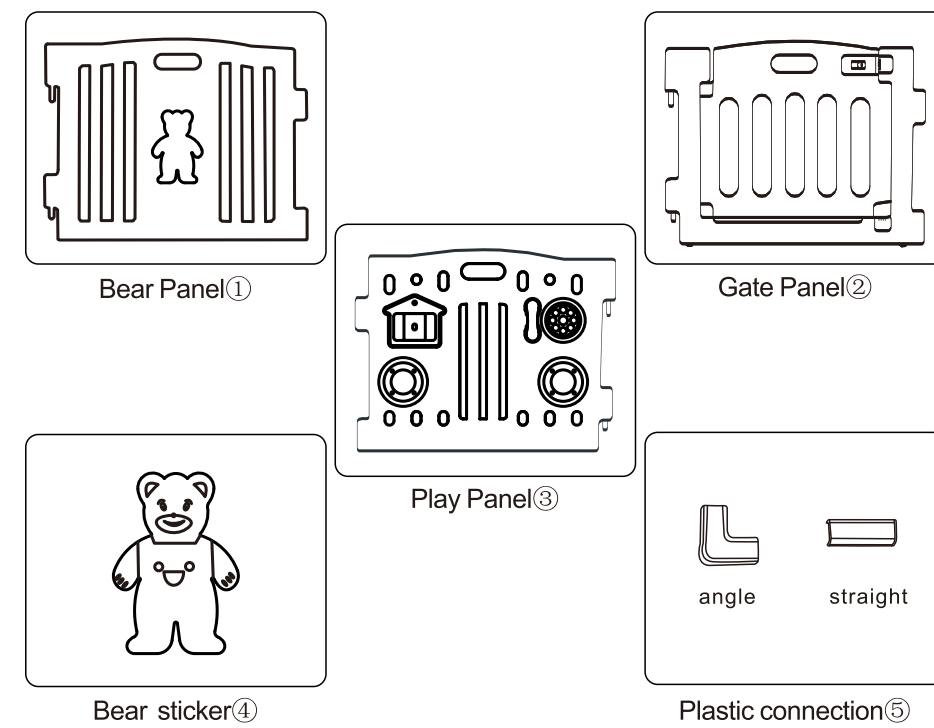

**JBW08D** ① × 6, ② × 1, ③ × 1, ④ × 12, ⑤ ( angle × 4, straight × 4 )

-2-

## ● INSTALLATION AND OPERATION

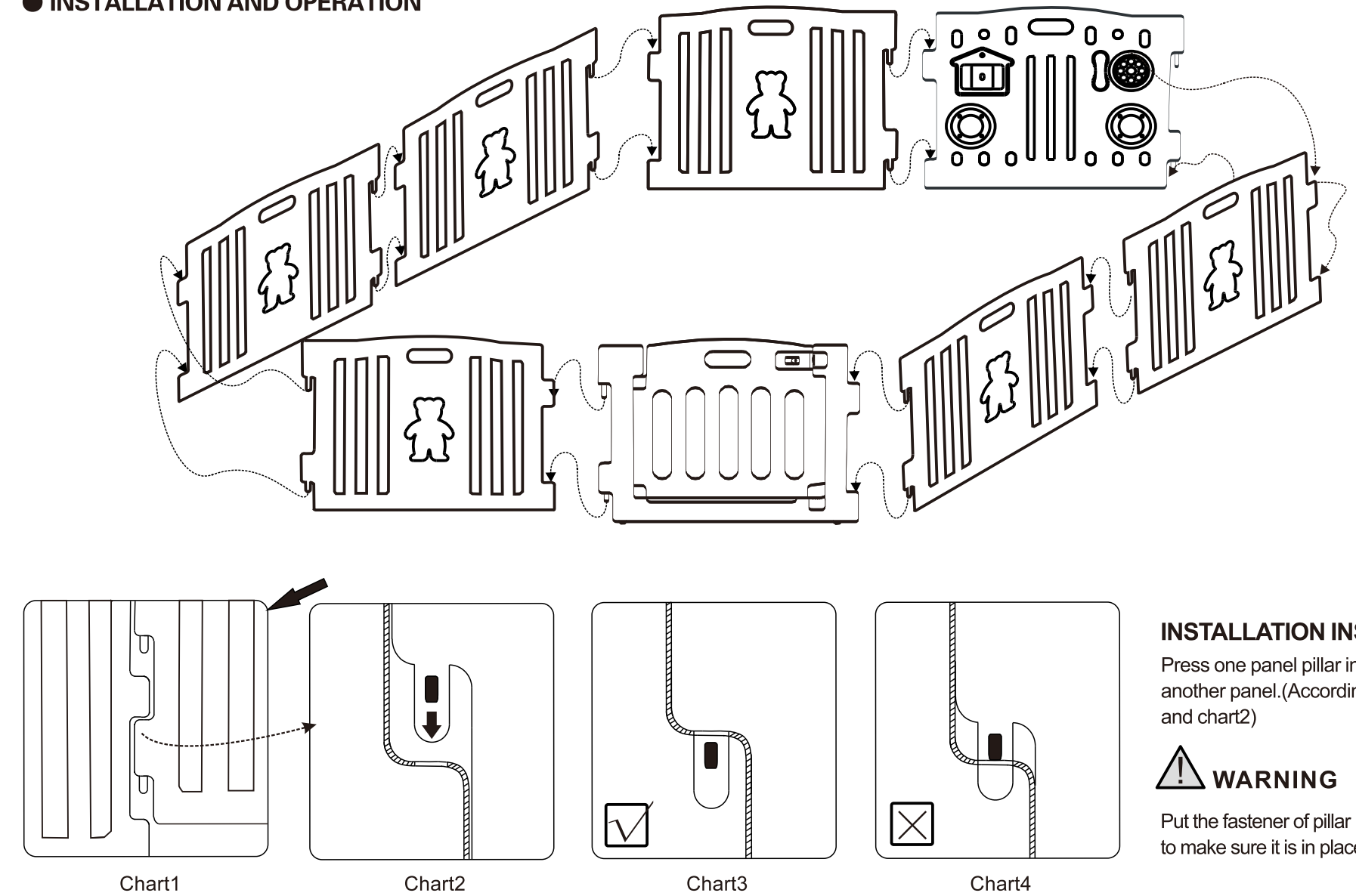

**INSTALLATION INSTRUCTION:**  
Press one panel pillar in the hole of another panel.(According to chart 1 and chart 2)

**WARNING**

Put the fastener of pillar into the hole to make sure it is in place.

-3-

-4-