

Kids Ride-on Bike Licensed MINI Tricycle

User Manual

RETAIN THIS MANUAL FOR FUTURE REFERENCE

PLEASE READ THIS MANUAL CAREFULLY BEFORE USE



Table of Contents

Safety	1
Parts Diagram	1
Included Items	2
Set-Up	3
Rear Wheel Assembly	3
Front Wheel Assembly	3
Handle Bar Assembly	4
Stickers	4

Safety

- This tricycle requires assembly by an adult.
- Adult supervision is required during use.
- To avoid injury, never use near steps, doorways, slopes or uneven ground.
- Never use near sloping driveways, roadways or public roads.
- Not for riders with a body weight above 30kg.
- This tricycle is recommended for children from 2 to 5 years old.
- Before using, please check that everything is properly assembled and securely tightened.
- Never stand on the saddle for fun.
- No pushing allowed when there are others riding.
- Avoid using or storing the tricycle in wet, cold or hot environments. Also, keep it away from fires or other strong, heat sources.
- Assembly parts contain small objects, do not let children play or swallow them.

Parts Diagram

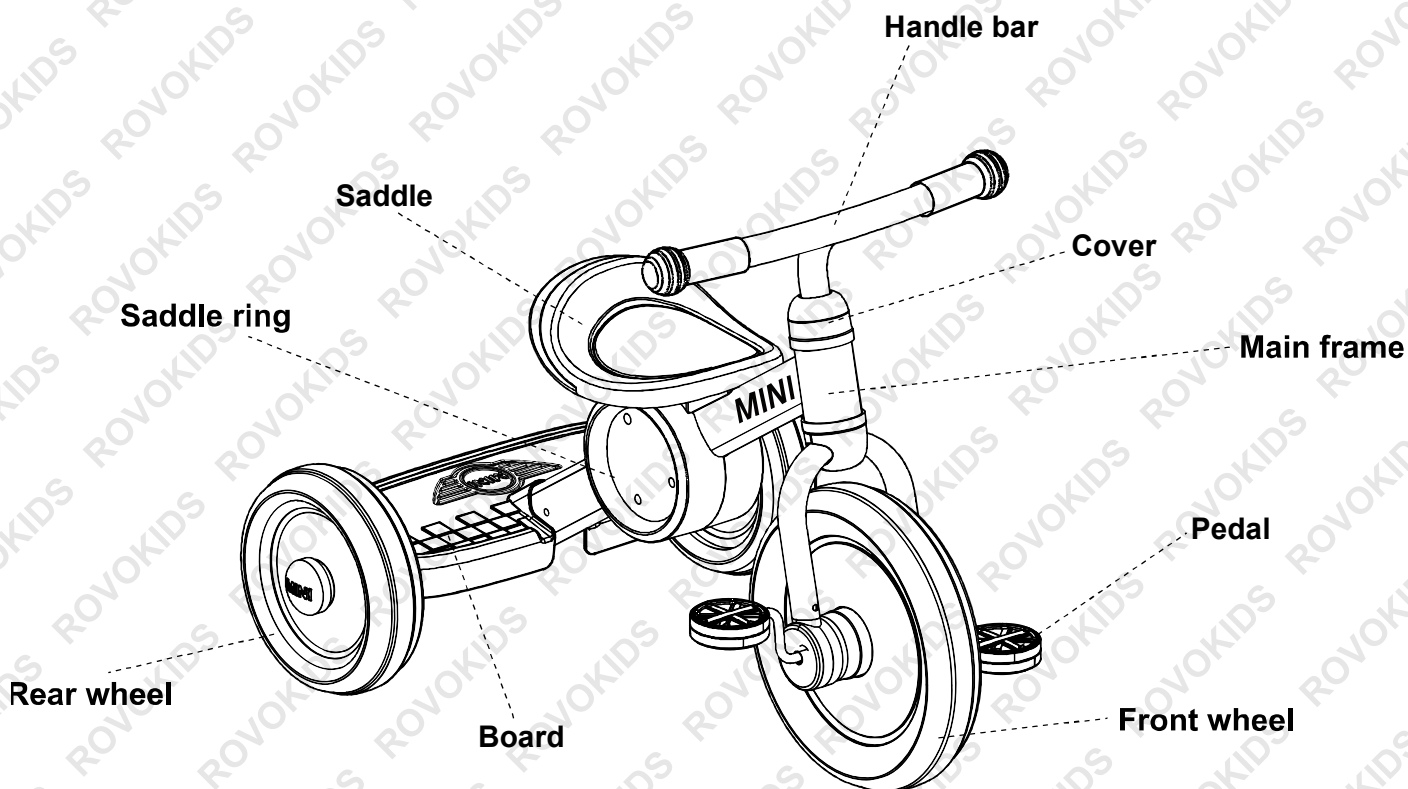



Included Items

Note: While assembling the tricycle, keep small parts away from children in order to avoid them being swallowed.

Item	Quantity	Item	Quantity
 <p>Body component</p>	1	 <p>Front wheel component</p>	1
 <p>Stickers</p>	2	 <p>Wrench</p>	1
 <p>Rear wheel component</p>	1	 <p>Nuts</p>	2 pcs. each
 <p>Handle bar component</p>	1		

Set-Up

Rear Wheel Assembly

Attach the main frame to the rear wheel casing as show in the image below, then tighten the nuts using the wrench supplied (be aware of the assembly sequence of the nuts).

Rear Wheel casing body

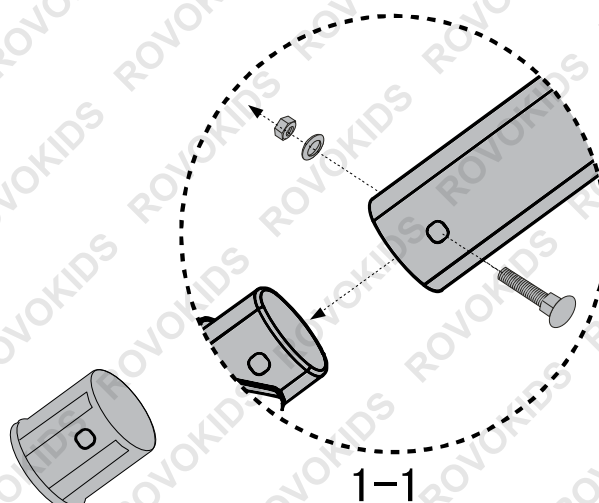
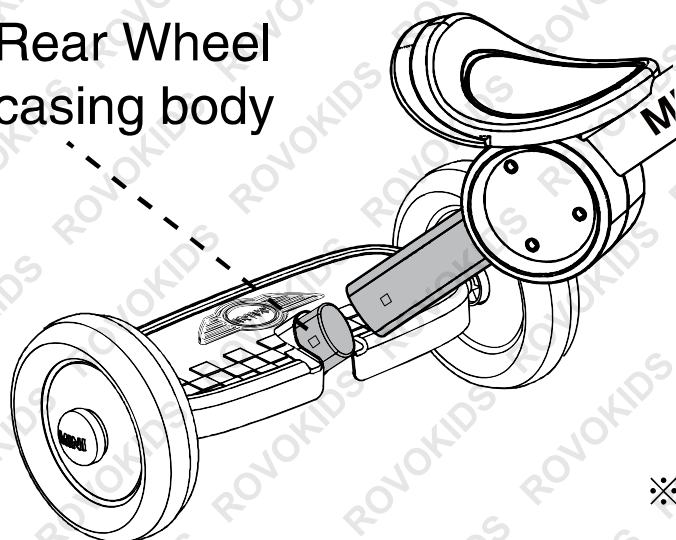

※ When installing don't take rear wheel casing body off.

Front Wheel Assembly

Insert the fork crown into the gram head tube. Ensure that the welded tab on the side of the fork steerer tube are located into the slots of the head tube, as shown in the image below.

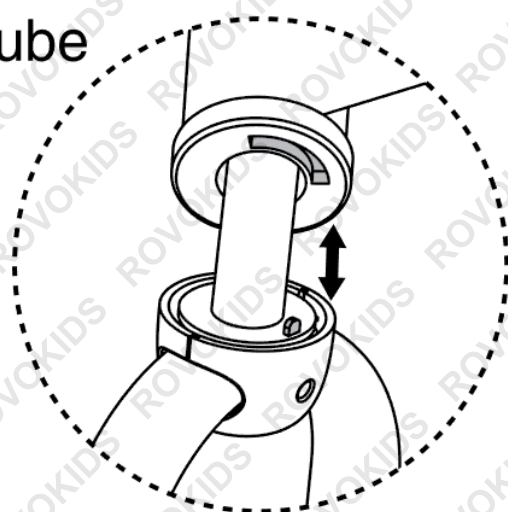
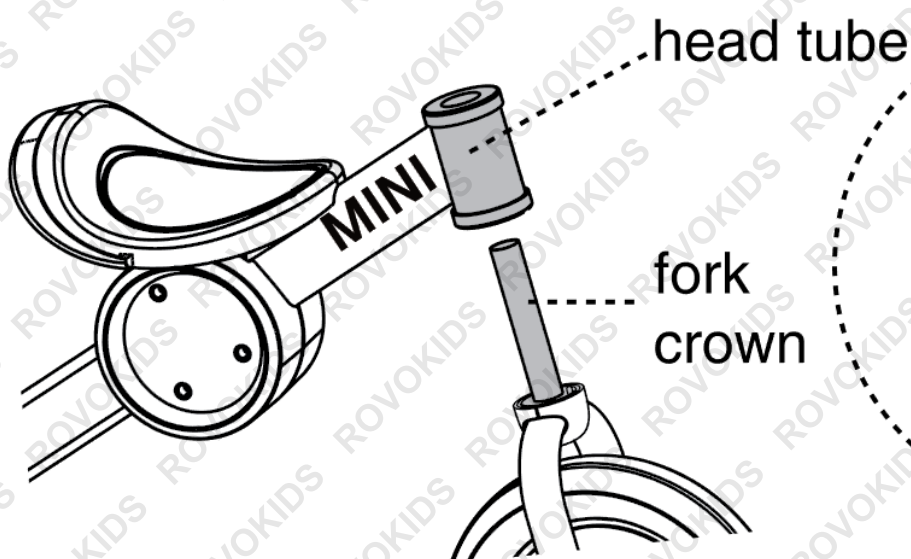

Handle Bar Assembly

Install the handle bar stem onto the frame head tube. Ensure that the handle bar stem matches the fork mounting holes, then tighten the nuts with the wrench (be aware of the assembly sequence of the nuts) as shown in the image below.

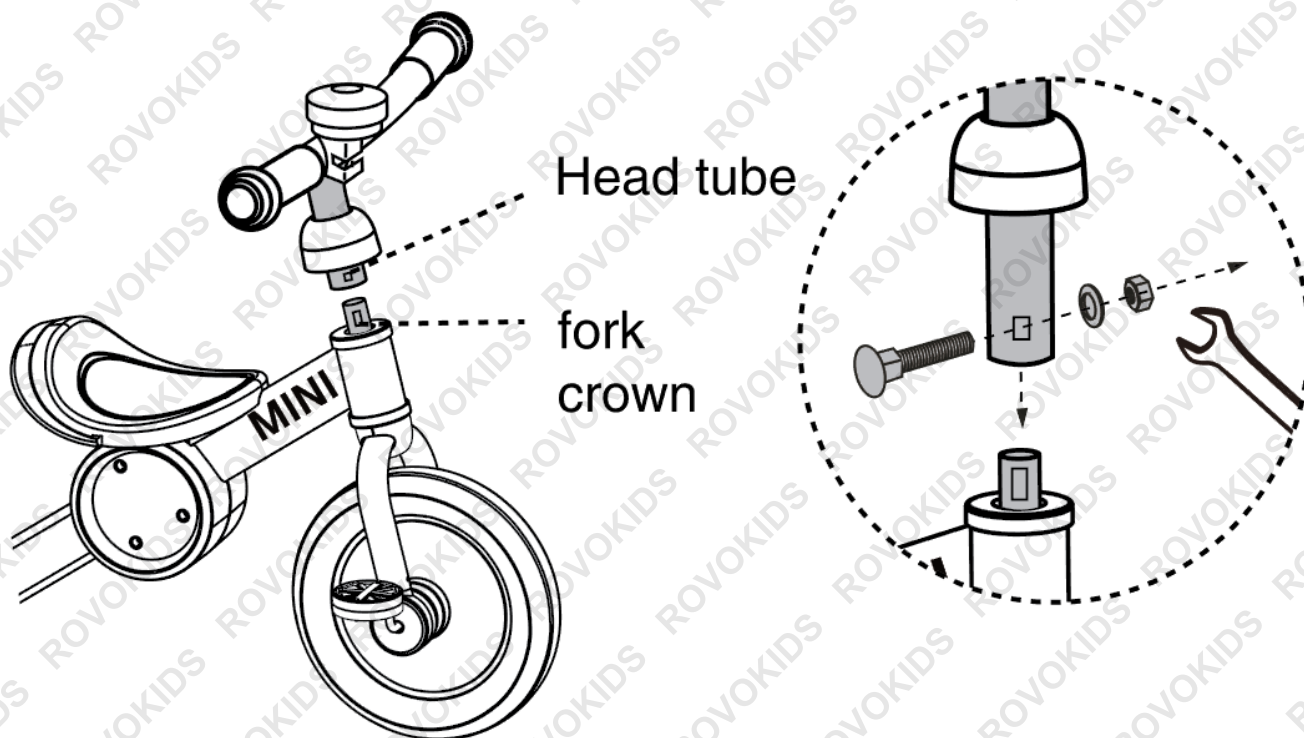

Stickers

As shown in the image below, kids can write their own lucky numbers and signatures on the stickers, then cover the stickers with your designated ones on the saddle ring.

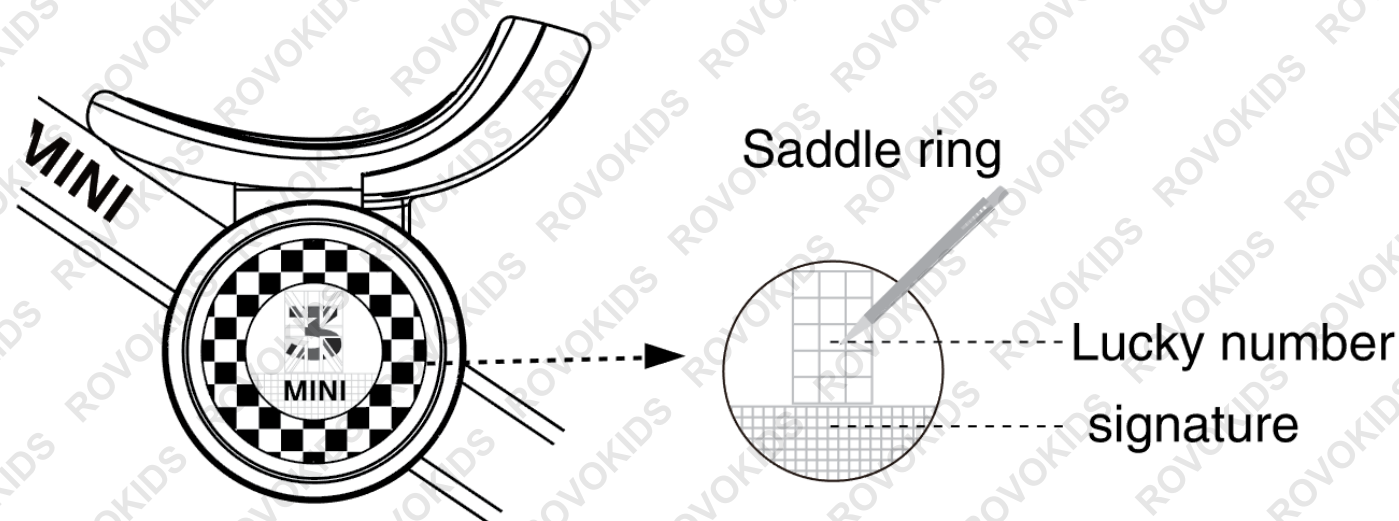



Some experts believe that the incorrect or prolonged use of almost any product may cause serious injury or death. To help reduce your risk of serious injury or death, refer to the information below. For more information, see www.datastreamserver.com/safety

- Consult all documentation, packaging and product labelling before use. Note that some products feature documentation available online. It is recommended to print and retain the documentation.
- Before each use, check the product for loose/broken/damaged/missing parts, wear or leaks (if applicable). Never use a product with loose/broken/damaged/missing parts, wear or leaks.
- Products must be inspected and serviced (if applicable) by a qualified technician every 6 months. This is based on average residential use by persons of average size and strength, and on a property of average metropolitan size. Use beyond these recommendations may require more frequent inspections/servicing.
- Ensure that all users of the product have completed a suitable industry recognised training course before being allowed access to the product.
- The product has been supplied by a general merchandise retailer that may not be familiar with your specific application or description of application. Be sure to attain third-party approval from a qualified specialist for your application before use, regardless of any assurances from the retailer or its representatives.
- This product is not intended for use where fail-safe operation is required. As with any product (for example, automobile, computer, toaster), there is the possibility of technical issues that may require the repair or replacement of parts, or the product itself. If the possibility of such failure and the associated time it may take to rectify could in any way inconvenience the user, business or employee, or financially affect the user, business or employee, then the product is not suitable for your requirements. This product is not intended for use where incorrect operation or a failure of any kind, including but not limited to, a condition requiring product return, replacement, parts replacement or service by a technician may cause financial loss, loss of employee time or an inconvenience requiring compensation.
- If this product has been purchased in error when considering the information presented here, contact the retailer directly for details of their returns policy, if required.

