

POLYCOOL



Ice Maker IM-65L

User Manual

[Revision 3.0 November 2018]

READ THIS MANUAL CAREFULLY BEFORE USE – FAILURE TO DO SO MAY RESULT IN INJURY, PROPERTY DAMAGE AND MAY VOID WARRANTY. • KEEP THIS MANUAL FOR FUTURE REFERENCE. • Products covered by this manual may vary in appearance, assembly, inclusions, specifications, description and packaging.

Safety

When using electrical appliances, basic safety precautions should always be followed, including the following:

- **Electric shock/electrocution hazard** - NEVER immerse the electrical cord or appliance body in water.
- Indoor use only - do not use outdoors.
- The appliance must be used on flat, level surfaces only.
- Some surfaces of the appliance may become hot during use (especially the cooling system components).
- Allow at least 150mm (6") of clearance around the appliance and do not use the appliance near sources of heat (ovens etc).
- Use water that is suitable for drinking only.
- Do NOT allow water to remain in the appliance after use.
- Do NOT use mechanical devices or other means to accelerate the defrosting process.
- Disconnect the appliance from the electrical supply while not in use, when assembling and before cleaning.
- Supervision is necessary when using the appliance near children.
- Do NOT allow children to operate or play with the appliance.
- Do NOT allow the unit to tilt >45° when being moved or transported, otherwise, damage to the compressor may result.
- Do NOT use the unit if it causes a circuit breaker to trip – have it inspected and repaired at an authorised service centre or by a qualified technician. Never try to replace parts or repair the unit by yourself.
- This appliance is not intended for use by persons (including children) with reduced physical, sensory or mental capabilities, or lack of experience and knowledge. All users should have adequate training in safely operating the product or be under supervision of a person responsible for their safety
- Do NOT operate the appliance if the electrical cord or plug is damaged.
- This appliance is for domestic use only.
- The drainage tube MUST empty into a drain or receptacle that is LOWER than the appliance.

Before First Use

- Check that the voltage indicated on the rating label corresponds to the mains voltage.
- Thoroughly clean all parts except the body in warm soapy water, then rinse and dry.
- Place the appliance where it is to be used, open all covers and allow to stand for a minimum of 2 hours before connecting to power

Table of Contents

Safety	2
Before First Use	2
Parts Identification	4
Operation	5
Water Connection	5
Console and Functions	6
Making Ice.....	6
Changing Ice Cube Size	7
Using the Start Delay Timer	7
Using the "Clean" Function	7
Care and Maintenance	8
Troubleshooting	9
Specifications	9

Parts Identification



No.	Name	No.	Name
1	Machine Body	8	Inlet Control Valve
2	Control Panel	9	Scoop
3	Ice Reservoir Cover	10	Water Connection Plug (2)
4	Water Inlet Port	11	Filter Bracket (2) (not used in this configuration)
5	Drain Port	12	Spare locking clips and evaporator drain plug may be included
6	Water Connection Tube (2 x long, 1 x short)		
7	Tap Adaptor		

Operation



Use only water that is suitable for drinking. • It is recommended to have a qualified plumber install the tap connection. • Use Teflon / plumbers tape (not supplied) for all threaded tap water connections. • The length of the water inlet tube is approximately 1m. • Connect to a cold water tap only. • The drainage tube **MUST** empty into a drain or receptacle that is **LOWER** than the appliance. • Ensure that the evaporator drain plug is installed first before using the ice maker.

Water Connection

1. Connect the tap adaptor to a suitable cold water pipe and tap, with the adaptor positioned between the water pipe and tap.
2. Screw the inlet control valve into the tap adaptor and tighten firmly by hand. ensure that the rubber O-ring is in place between the adaptor and valve.
3. Connect the water inlet tube between the inlet control valve and water inlet port on the rear of the appliance. To use the connectors:
 - a. Push the tube (A) into the connector (B) as far as it will go.
 - b. Pull back on the tube slightly, so there is a gap (X) between the connector body and collar (C).
 - c. Place the locking clip (D) into the gap, then push down until it clips around the collar.

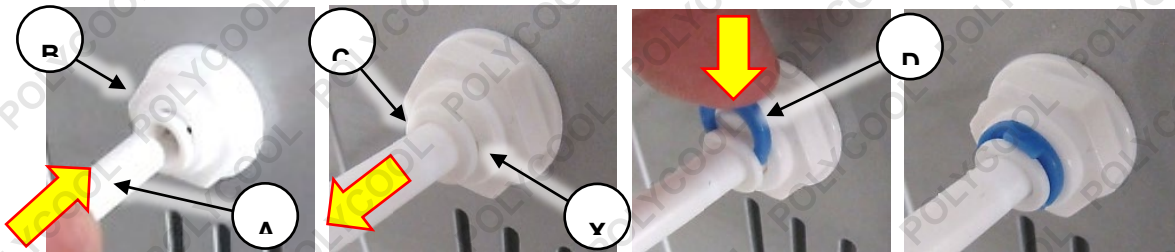
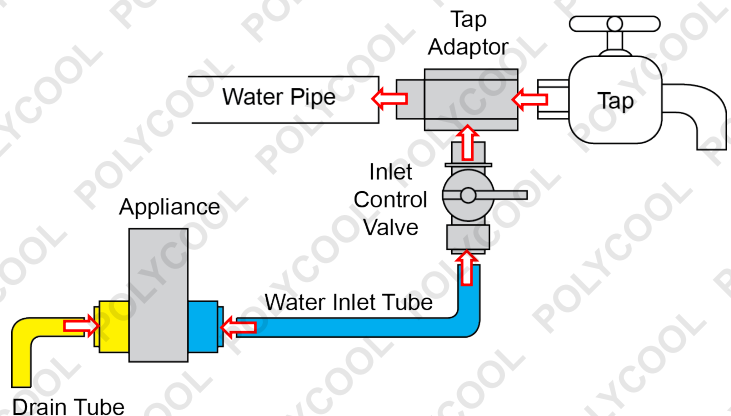

4. Connect the water drain tube to the water drain port on the rear of the appliance, and the free end of the tube empty into a suitable drain. Drainage is gravity fed, therefore, the drain tube **MUST** empty into a drain or suitable receptacle (for example, bucket etc) **LOWER** than the appliance. If using a bucket, be sure to regularly check and empty it.
5. Slowly rotate the inlet control valve to the ON position until an adequate flow is achieved. The appliance has an internal valve to control water into it and prevent flooding.
6. Connect the appliance to the mains electrical supply.

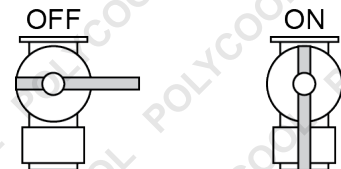

To disconnect the appliance for moving etc, switch the water supply OFF, switch the appliance OFF, pull the locking clip from the hose connector. Push the collar in and maintain pressure on it (red arrow), then pull the tube from the connector.



It is recommended to insert the connection plugs when moving the appliance or when not in use for extended periods to prevent leakage of any residual water in the appliance.

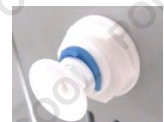

Console and Functions

The appliance features a display that provides you with information, such as function, current internal temperature etc. The console activates as soon as the appliance is connected to the electrical supply.



Control	Description
Add Water	Illuminates if there is no inlet water supply. The machine may also beep.
Timing	Illuminates when the start delay timer function is active.
Ice	Illuminates when the appliance is currently making ice .
Ice Full	Illuminates when the ice reservoir is full. When full, no more ice is produced. Machine may also beep.
Clean	Illuminates when the cleaning function is active.
+	Press to increase the value for ice making time or the start delay timer.
-	Press to decrease the value for ice making time or the start delay timer.
On / Off	Press to switch the appliance ON / OFF.
Timing Clean	Press to activate the start delay timer or cleaning function.
Display	Shows the current temperature in the ice reservoir when making ice, flashes when the final ice making stage begins, or shows the value for ice making time or the start delay timer.

Making Ice



If ice is made and left in the appliance, it may eventually melt – when melted, the water drains. • Ensure that the water supply is adequate when making ice. • It takes several minutes to create each batch of ice cubes, and this is also affected by the ambient temperature – do not expect instant ice to be available. To monitor ice production, view it from the water reservoir cover – do not allow the cover to remain open, and close it as soon as possible in order to retain ice-cold temperatures in the ice reservoir. • Note that the size of the ice cubes may vary for the first few ice making cycles, however, [can also be adjusted](#).

1. Ensure the appliance is connected to the electrical and water supplies.
2. Press **On** to activate the ice making function. When on, the appliance circulates water over the evaporator / ice tray as it cools, creating the ice, then moves the ice into the ice reservoir. Use the supplied scoop to collect the ice.



This image shows water being circulated over the evaporator / ice making tray, forming ice. When the ice cubes are ready, the tray heats slightly so the cubes fall into the ice reservoir.

Changing Ice Cube Size

The machine allows you to customise the size of ice cubes, if required. This is done by either increasing or reducing the last stage of the ice making process (the default is 10 minutes). When the machine reaches the final stage of the ice making process, the display flashes to indicate this. If you need to increase ice cube size, for example, due to how often the ice reservoir cover is being opened, high ambient temperature etc, increase the length of the final ice making stage. It may take several adjustments to reach the optimum value. To adjust the final ice making stage period, make ice as normal, however when the display begins flashing to indicate the final stage:

1. Press **+** / **-** as required to set the change in length from the default 10 minutes – each press is 1 minute. The change in minutes shows on the display. For example, to set the final stage to 12 minutes, press **+** twice. The change will apply from the next cycle.
2. Check the ice cube size after the next cycle. Re-adjust as required.

Using the Start Delay Timer

The appliance can be set up to start ice making up to 23 hours ahead. This is useful for ensuring there is a ready ice supply available at a particular time. For example, if it is currently 8PM and you want the machine to start making ice at 6AM the following morning, set the start delay timer to 10 hours. To set the timer:

1. Ensure the appliance is connected to the electrical and water supplies, however, is currently switched OFF (that is, not making ice).
2. Press **Timing** to activate the function – the **Timing** indicator illuminates.
3. Press **+** / **-** as required to set the required number of hours – the number of hours shows on the display.

Using the "Clean" Function

The appliance includes a rinsing function for the compressor plumbing and evaporator unit. It is recommended to perform a "clean" before each use. To use the clean function:

1. Ensure the appliance is connected to the electrical and water supplies, however, is currently switched OFF (that is, not making ice).
2. Remove the evaporator drain plug.
3. Press and hold **Clean** for several seconds to activate the function – the **Clean** indicator illuminates. The default cleaning time is 30 minutes – remaining cleaning time shows on the display.
4. When cleaning is finished, re-install the evaporator drain plug.



Care and Maintenance

- After use, switch OFF the electrical and water supplies. Remove all remaining ice, then drain the evaporator unit by removing the drain plug at the bottom-left corner until no water remains. Re-install the evaporator drain plug and open the reservoir cover approximately halfway and leave open. This helps thoroughly dry the inside of the appliance and helps prevent corrosion of surfaces.
- After each use, clean the inside of the appliance with a cloth and a solution of water and a small amount of vinegar. Do not use detergents, solvents or chemicals.
- When the appliance is in use, ensure that the reservoir cover is fully closed.
- Regularly remove any accumulated dust from the air vents and cooling holes in the body of the machine.
- If required, clean the appliance body with a damp cloth. Do not use detergents, solvents or chemicals.
- If using a receptacle (for example, a bucket) for drainage, be sure to regularly check and empty it.



Troubleshooting



Some maintenance activities described may be beyond the scope of some users. For procedures that you are not comfortable with or have the tools, knowledge or experience for, have the unit serviced at an authorised service centre or qualified technician.

The following information may assist in identifying a problem and rectifying it.

Ice not being produced.

Possible Fault	Action
No electrical supply	Check that mains electricity is available and the appliance is properly connected to it.
Water supply off, or insufficient pressure	Switch the machine OFF. Ensure that the water supply is connected and the tap is set to provide sufficient pressure. Wait 3 minutes, then restart the ice making function (press ON button).
Ice reservoir full	Remove ice from the reservoir to allow appliance to produce ice.
Air in water system	Remove the drain cap from rear of appliance and allow several drops of water to escape before re-installing the cap.
Ambient temperature too high or too low	If the ambient temperature is high, operate the unit in a cooler area. Ensure that heat sources (ovens etc) are at least 150mm (6") away from the appliance. If the ambient temperature is below 10°C, operate the appliance in a warmer (not hot) area.
Cooling or control unit faulty	Have appliance inspected and repaired by an authorised service centre or technician.

Ice sticking together.

Possible Fault	Action
Ambient temperature too low	Operate in a warmer (not hot) area.

ADD WATER indicator on.

Possible Fault	Action
Water supply off, or insufficient pressure	Switch the machine OFF. Ensure that the water supply is connected and the tap is set to provide sufficient pressure. Wait 3 minutes, then restart the ice making function (press ON button).

Compressor unit noisy / buzzing.

Possible Fault	Action
Input voltage fault	Check input voltage to appliance and ensure it is compatible.

Specifications

Input Voltage	240VAC / 50Hz
Refrigerant Agent	R134a
Dimensions	730mm (h) x 460mm (w) x 430mm (d)
Weight	Approximately 25kg without liquids



Some experts believe the incorrect or prolonged use of almost any product could cause serious injury or death. For information that may reduce your risk of serious injury or death, consult the points below and additionally, the information available at www.datastreamserver.com/safety

- | | |
|---|--|
| <ul style="list-style-type: none"> • Consult all documentation, packaging and product labelling before use. Note that some products feature online documentation which should be printed and kept with the product. • Check product for loose / broken / damaged / missing parts, wear or leaks (if applicable) before each use. Never use a product with loose / broken / damaged / missing parts, wear or leaks (if applicable). • Products must be inspected and serviced (if applicable) by a qualified specialist every 6 months assuming average residential use by a person of average weight and strength, above average technical aptitude, on a property matching average metropolitan specification. Intended use outside these guidelines could indicate the product is not suitable for intended use or may require more regular inspection or servicing. • Ensure all possible users of the product have completed an industry recognized training course before being given access to the product. | <ul style="list-style-type: none"> • The product has been supplied by a general merchandise retailer that may not be familiar with your specific application or your description of the application. Be sure to attain third-party approval for your application from a qualified specialist before use regardless of prior assurances by the retailer or its representatives. • This product is not intended for use where fail-safe operation is required. As with any product (take an automobile, aircraft, computer or ball point pen for example), there is always a small chance of technical issues that needs to be repaired or may require replacement of the product or a part. If the possibility of such failure and the associated time it takes to rectify could in any situation inconvenience the user, business or employee then the product is not suitable for your requirements. This product is not for use where incorrect operation or a failure of any kind, including but not limited to a condition requiring product return, replacement, service by a technician or replacement of parts could cause a financial loss, loss of employee time or an inconvenience requiring compensation. • If this item has been purchased in error after considering the points above, simply contact the retailer directly for details of their returns policy, if required. |
|---|--|



©2018 Polycool. All rights reserved. No part of this document, including descriptive content, concepts, ideas, diagrams or images may be reproduced or transmitted in any form or by any means, electronic or mechanical, including photocopying, scanning or recording, or any information storage and retrieval system, without express permission or consent from the publisher.