

悉尼贸易-澳大利亚668A/668S3
编码：3070500287

数量：120本-新增型号

COOKER HOOD

USER MANUAL

TROUBLE SHOOTINGS

CAUTION: Disconnect the power supply before servicing.

STATUS	CAUSE AND METHOD OF REPAIRING	TOOL
The power supply is damaged	If the power supply is damaged, please call the technicians to repair.	"+" type Screwdriver Sharp Pincers
The motor does not run	A) The motor was broken, replace a new motor assembly. B) The switch control was broken, replace a new motor assembly. C) The capacitance was broken, replace a new motor assembly.	"+" type Screwdriver
The unit body shake	A) The installation is not firm enough. Check it and make sure the hood is firm enough. B) The fan is broken, so it is not balance. Replace a new motor assembly. C) The motor does not firm enough. Check it and install it firmly enough.	"+" type Screwdriver
Big noise	A) Some other things drop to the blower. Check and clean it.	"+" type Screwdriver
Suction not so powerful	A) The distance from the range hood to the gas cooker is too big. Make sure the distance is about 650-700mm. B) There are many windows or doors in the kitchen, the air convection is too big. Close some doors or windows, smaller the air convection. C) There have some other pour wind to the exhaust pipe. Make the exhaust pipe's exit to downwards. D) The run rate of motor decrease obviously. Replace a new motor or capacitance. Because of the Range Hood is set upon the window, the best solution is that put one threeply board on the back of the Range Hood for covering the hollow of window.	"+" type Screwdriver
Bulb does not work	Replace with a new LED lamp assembly.	"+" type Screwdriver

READ AND SAVE THESE INSTRUCTIONS MANUAL

CONTENTS

TECHNICAL CHARACTERISTICS	1
BODY SIZE	1
MAIN PARTS NAME	2
INSTALLATION REQUIREMENT.....	3
INSTALLATION PROCEDURES.....	4-6
OPERATING INSTRUCTION.....	6-7
MAINTENANCE.....	7
REPLACE LIGHT BULB.....	8
IMPORTANT SAFETY INSTRUCTIONS.....	9-10
TROUBLE SHOOTINGS.....	11

Please note that this product is marked with this symbol: 
According to Waste of Electrical and Electronic Equipment (WEEE) directive, WEEE should be separately collected and treated. If at any time in future you need to dispose of this product, Please do NOT dispose of this product with house hold waste. Please send this product to WEEE collecting points where available.

Dear consumer,

Thanks for your purchase of our cooker hood and we hope we can fully satisfy all of your needs. Please read entire instructions carefully before proceeding to obtain the best results of using the cooker hood.

TECHNICAL CHARACTERISTICS

Model NO.: HOOD-EURO-900WALLF; HOOD-EURO-66895WF

Total power: 129W

Speed motor: 125W

Lights: 2x2W

Voltage: 220V~240V

Frequency: 50Hz

Filter: 6-layer filter

Control: push button

BODY SIZE

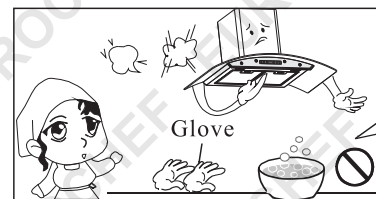
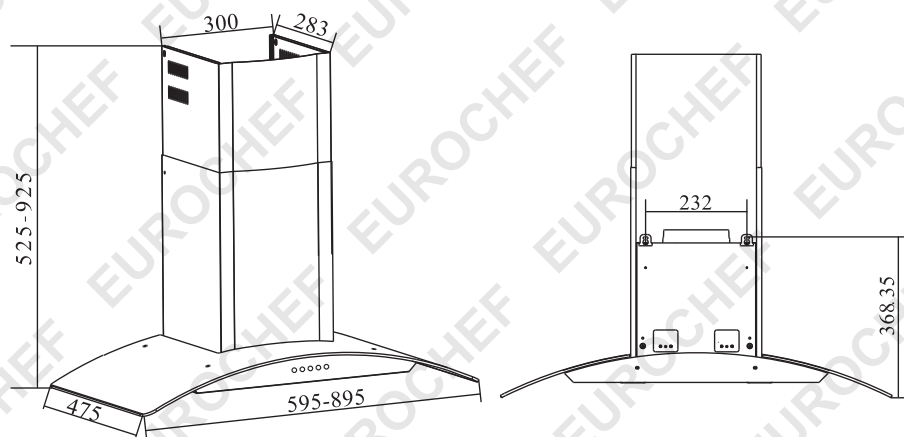

Wear protective glove before you start to clean the hood. Remove the components gently when you clean!



Don't wash the key parts with water or other kind of liquid. For the liquid may inpour the hood body cause electrical problem.

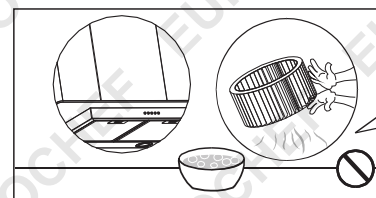

Be more carefully when clean the blower. Don't impact the blower and don't move the blower knob, otherwise it will cause the body shake and big noise.

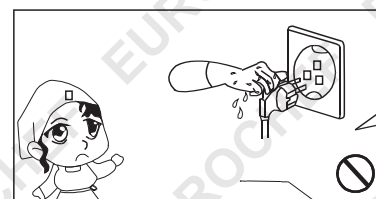

Never pull out the plug by wet hand to avoid the possibility of electric shock.

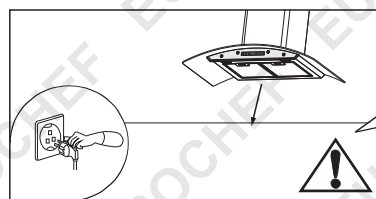

If along time you don't use the appliance, please pull out the plug!

IMPORTANT SAFETY INSTRUCTIONS:

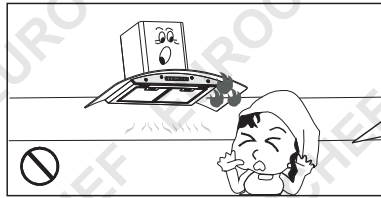

Do not connect the air outlet to other fuel's chimney or combustion gas ducts.

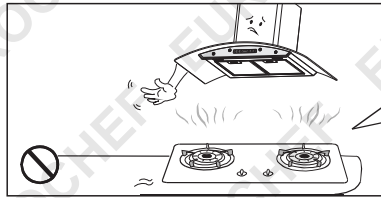

Do not leave naked flames under this hood

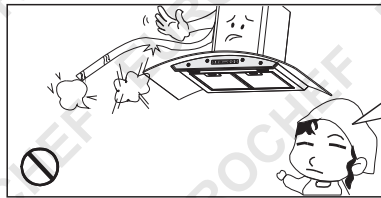

In case of any damage of the power cable, replace the broken cable with a new one by an experienced person.

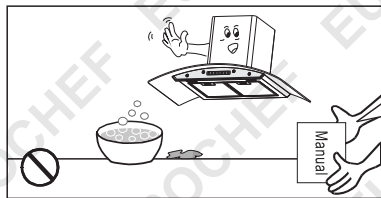

Do clean the hood in according to the instruction stated or it might cause the possibility of fire accident

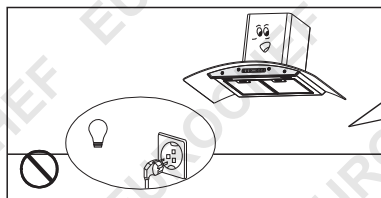

The bulb should be replaced by an experienced person, Halogen bulb no more than 10W, LED bulb no more than 2W.

MAIN PARTS NAME

1. Hook

2. Inner duct

3. Outer duct

4. Exhaust pipe

5. Mounting hook

6. Tempered glass

7. Aluminium Filter

8. Blower Assembly

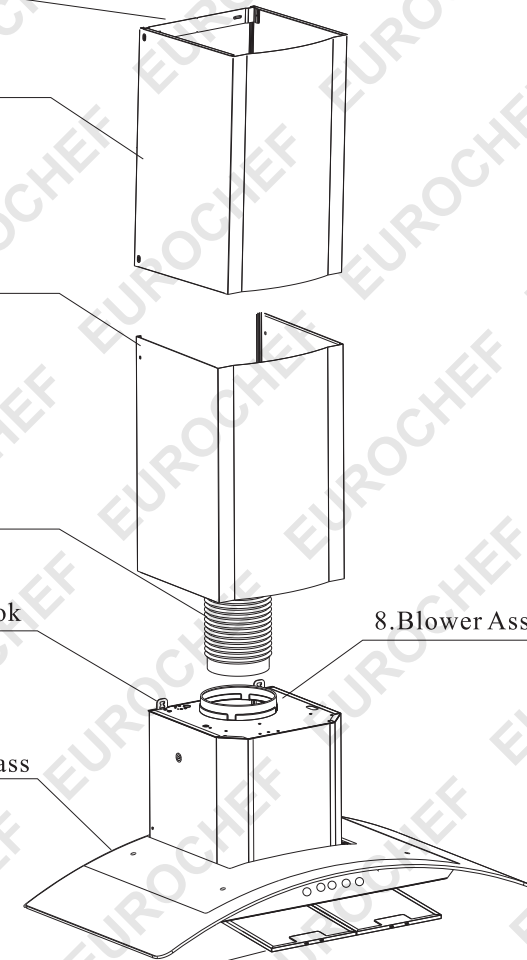

INSTALLATION REQUIREMENT

1. Do not install the cooker hood where there have many doors or windows. For the air convection will effect the exhaust efficiency of the hood.(Fig.1)
2. Install the cooker hood right above the hob.The recommended distance between the hob and the lower edge of the cooker hood is minimum 650 mm and maximum 700mm. (Fig. 2)
3. In order to get the optimum performance, do not elongate the exhaust pipe too long, and try to make the bend of exhaust pipe less and biggest, ensure the connection is airtight.(Fig. 3)
4. After hanging the unit on the wall, ensure the hood is level and vertical. (Fig. 4)
5. The air outlet must not be connected to chimney flues or combustion gas ducts. The air outlet must under no circumstances be connected to ventilation ducts for room in which fuel-burning appliances are installed.

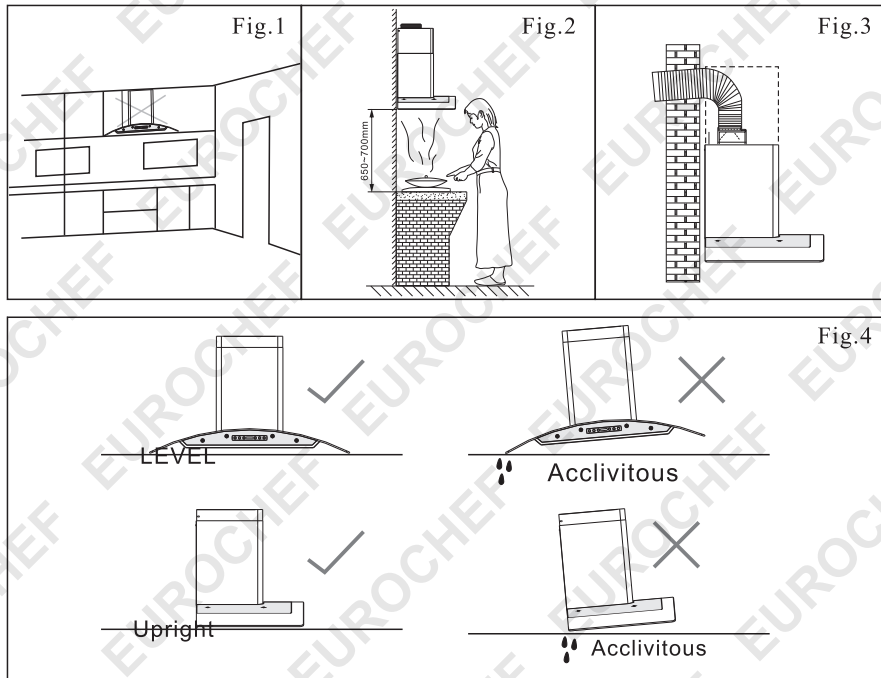

MAINTENANCE

CAUTION: NEVER PUT YOUR HAND INTO THE AREA HOUSING THE FAN WHILE THE FAN IS OPERATING.
FOR THE OPTIMAL LEVEL OF OPERATION, CLEAN THE COOKER HOOD SURFACE, FAN, AND ALUMINIUM FILTER REGULARLY.

1. Use only mild soap or detergent solutions to clean the cooker hood surface. Dry surfaces using soft cloth.
2. Using a stainless steel cleaner to bring the glow back into a stainless steel finish.
3. Clean the aluminium filter once a week or according to use status. Press the clamp of the aluminium filter slightly, take off the aluminium filter and put it into warm soapy water using mild detergent, wipe the aluminium filter with soft brush. Replace the filter after it is dry. Or it can wash in dishwasher.
4. Clean the blower assembly once half an year and use it according to this manual for better effect!.
5. DO NOT clean the motor with water or other liquid.

TO REPLACE LIGHT BULB

CAUTION: LAMP UNIT MAY BE HOT! WAIT UNTIL THE UNIT IS COOL. AND USE THE SAME TYPE LIGHT BULB!

Caution: LED lamp can not replace a new bulb, just can replace a new LED lamp. Make sure all the control switches are off, and the cooker hood is unplugged!

Please follow the below instructions:

1. Take out the filters, and cut off the wire connection of the lamp.
2. Press the spring according to the arrow direction, then you can take off the lamp unit.
3. You can replace a new LED lamp unit no more than rating!
4. Then put the lamp unit to the hood in reverse direction. Connect the wire of the lamp.
5. Fit on the filters.

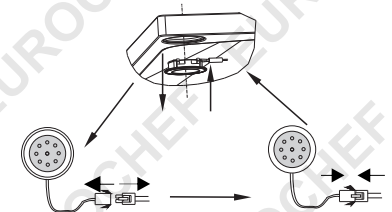

2. How to use the **push button control**

A: Press Button A once, turn on the light. Press it again, turn off the light.

B: Press button B, the fan runs at the boost speed.

C: Press button C, the fan runs at the second speed.

D: Press button D, the fan runs at the low speed.

E: Press button E, the fan turns off.

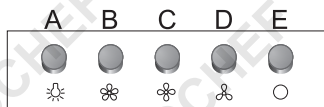

3. How to use the **touch control**

A: Press Button A once, turn on the light. Press it again, turn off the light.

B: Press button B, the fan runs at the boost speed.

C: Press button C, the fan runs at the middle speed.

D: Press button D, the fan runs at the low speed.

E: Press button E, the fan turns off.

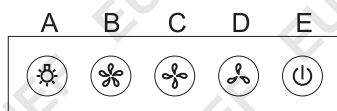

4. How to use the **soft touch control**



A: Touch A, the fan runs at the low speed. Press it again, the fan turns off.

B: Touch B, the fan runs at the mid speed. Press it again, the fan turns off.

C: Touch C, the fan runs at the high speed. Press it again, the fan turns off.

A、B、C three buttons interact.

D: When the hood is OFF, press and hold D for 3 seconds, and then press C (to adjust the minute) and E (to adjust the hour) respectively, G acts like a clock. On the screen, left side is hour and the right side is minute; When the hood is operating, touch D to control working time of hood, 1 minutes per one touch, the longest stay ON time is 1 hour.

E: Press E, turns on the light. Press it again to turn off the light.

F: Delay formation: when the hood is operating press F, the hood will not be OFF at once, it will remain for one minute before it is OFF.

INSTALLATION PROCEDURES

SAFETY WARNING

HOOD MAY HAVE VERY SHARP EDGES; PLEASE WEAR PROTECTIVE GLOVES IF IT IS NECESSARY TO REMOVE ANY PARTS FOR INSTALLING, CLEANING OR SERVICING.

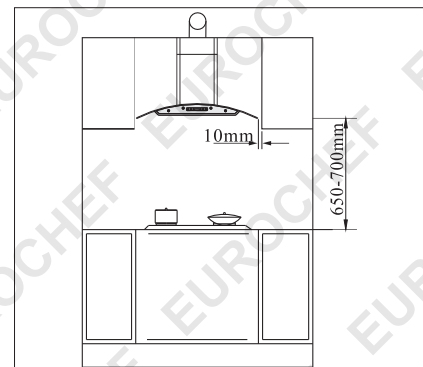

Step 1:

Please put the cooker hood on the wall and mark the position where you want to install. We recommend the height from the hob to the lower edge of the hood should be from 650mm to 700mm.

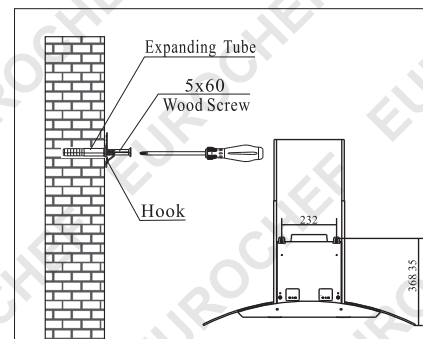

Step 2:

According the space between the hole A&B, drill 2 holes in level on the wall with 8mm in diameter and 60-70mm in depth. Press the 2 expanding tube provided into the holes. Tighten the 2 wood screws of 5x60mm which supplied together with the hood to the expanding tube. Make sure it is fixed enough and cannot be move. Hang the cooker hood on the 2 wood screws, make sure it is to be level and stable.

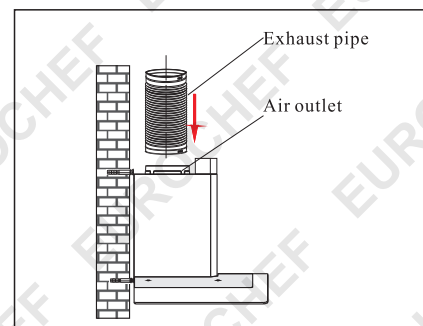

Step 3:

Take out the cooker hood from the carton and put it on a horizontal work table gently. Fix the exhaust pipe into the air outlet of the inner duct, and then fix the exhaust pipe into the top of reducer, make sure it is connected to the reducer tightly.

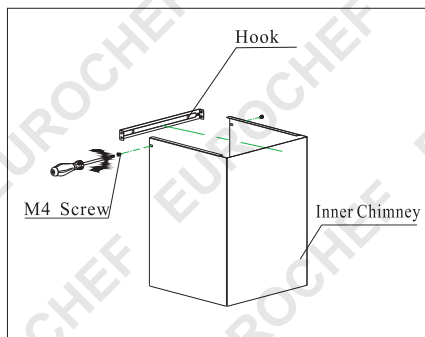

Step 4:
Matching the bracket to the holes of the inner duct cover and fix it well with M4 screws.

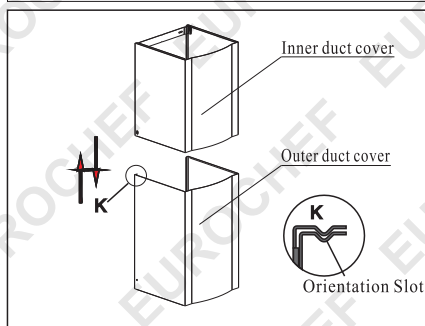

Step 5:
Insert the inner duct cover into the outer duct cover. Please kindly note that the inner duct cover must fix to the outer duct cover's orientation slot.

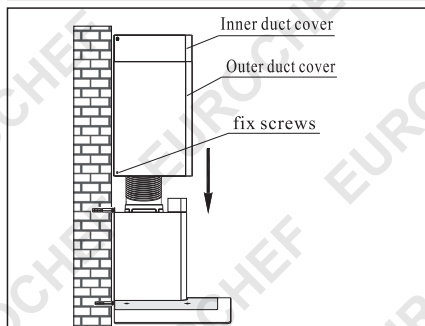

Step 6:
Put the outer duct cover to the unit body, and use two M4x10 screws to fix the outer duct cover to the unit body.

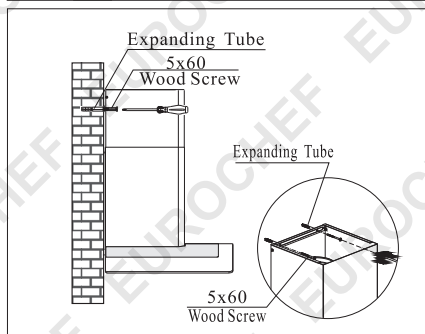

Step 7:

1. Extend the inner chimney to the height which you want. And mark the two holes of the inner chimney's hook on the wall.
2. Put down the inner duct cover gently, using 8mm drill to drill two holes in 60-70 mm depth on the wall which you marked just now.
3. Press the expanding tube into the holes.
4. Extend the inner chimney and tighten it to the expanding tubes with two 5x60 wood screw.

5

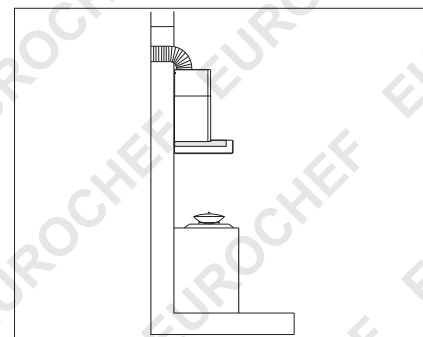

Step 8:
Extend the exhaust pipe to the vent-pipe of your building or to outside. Try to make the bend of the exhaust pipe is more than 120°

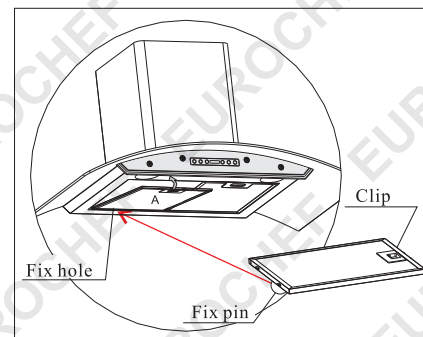

Step 9:
Install filter. Put the fix pin to the fix hole and press down the filter's clip gently as the direction of arrow A.

OPERATING INSTRUCTION

1. How to use the **touch control**

- A: Press controller A once, turn on the light. Press it again, the light turns off.
 B: Press controller B once, the fan runs at the boost speed. Press it again, the fan turns off.
 C: Press controller C, the fan runs at the second speed. Press it again, the fan turns off.
 D: Press controller D, the fan runs at the low speed. Press it again, the fan turns off.

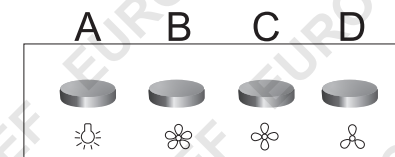

6



Some experts believe the incorrect or prolonged use of almost any product could cause serious injury or death. For information that may reduce your risk of serious injury or death consult the points below and additionally, the information available at www.datastreamserver.com/safety

- Consult all documentation, packaging and product labelling before use. Note that some products feature online documentation which should be printed and kept with the product.
- Check product for loose / broken / damaged / missing parts, wear or leaks (if applicable) before each use. Never use a product with loose / broken / damaged / missing parts, wear or leaks (if applicable).
- Products must be inspected and serviced (if applicable) by a qualified specialist every 6 months assuming average residential use by a person of average weight and strength, above average technical aptitude, on a property matching average metropolitan specification. Intended use outside these guidelines could indicate the product is not suitable for intended use or may require more regular inspection or servicing.
- Ensure all possible users of the product have completed an industry recognised training course before being given access to the product.

- The product has been supplied by a general merchandise retailer that may not be familiar with your specific application or your description of the application. Be sure to attain third party approval for your application from a qualified specialist before use regardless of prior assurances by the retailer or its representatives.
- This product is not intended for use where fail-safe operation is required. As with any product (take an automobile, aircraft, computer or ball point pen for example) there is always a small chance of a technical issue that needs to be repaired or may require replacement of the product or a part. If the possibility of such failure and the associated time it takes to rectify could in any situation inconvenience the user, business or employee or could financially affect the user, business or employee then the product is not suitable for your requirements. This product is not for use where incorrect operation or a failure of any kind, including but not limited to a condition requiring product return, replacement, service by a technician or replacement of parts could cause a financial loss, loss of employee time or an inconvenience requiring compensation.
- If this item has been purchased in error considering the points above simply contact the retailer directly for details of their returns policies if required.

