

# ASSEMBLY INSTRUCTIONS

**Model:Lift  
HED102D**



- Desktop Dimensions: 108-187cm
- 4 Height Position Memory
- Vertical Range: 60 - 125cm



Power Input  
110V-240V



Max.Speed  
25 mm/s



Motion Noise  
< 55dB



Load Capability  
260 lbs / 120 kg

[Revision 5.0 August, 2019]

## ► Screws/Fasteners (bag)

A	M5×16 screw		10pcs
B	M6×12 screw		32pcs
C	Adjustable feet		4pcs
D	M5×12 screw		2pcs
E	S=4mm		1pcs

## ► PARTS INCLUDED

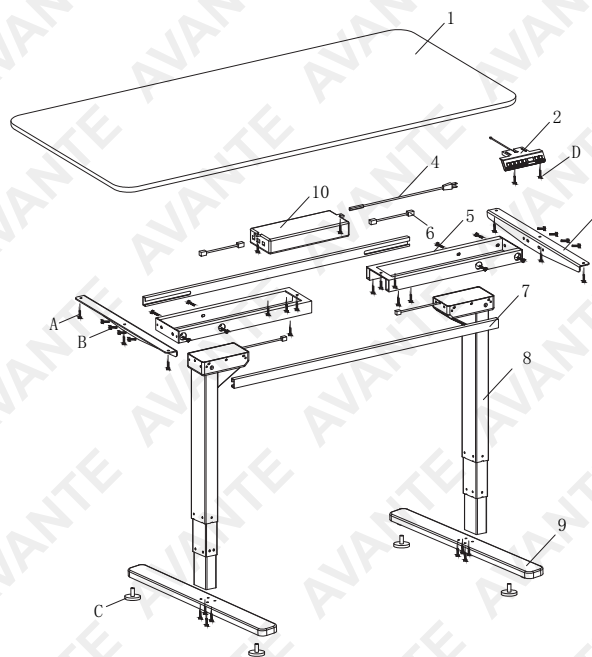

### Desk Parts

1.	Desktop		1pc
2.	Controller panel		1pc
3.	Side plates		2pcs
4.	Power cord		1pc
5.	Frame		2pcs
6.	Connection line		2pcs
7.	Connecting rod		2pcs
8.	Table legs		2pcs
9.	Foot		2pcs
10.	Controller box		1pc

## ► INSTALLATION

- ① Attach the adjusting foot(C) to the foot (9) , connect the table leg (8) to the foot (9), and fasten the screw (B) with the wrench (E).

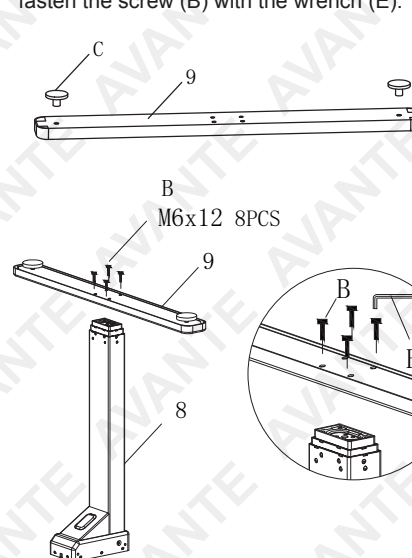

- ② Mount the frame (5) and use the wrench (E) to lock the screw (B)

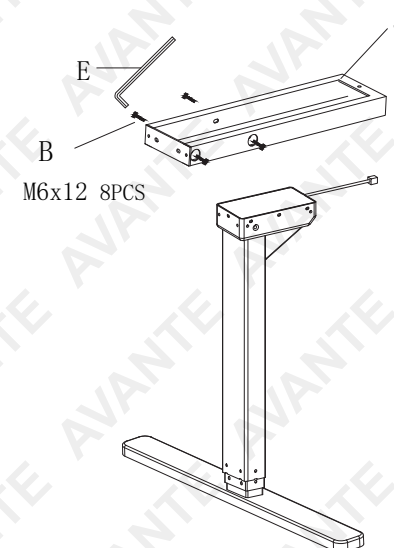

## ► INSTALLATION

- ③ Install the side plate (3) and use the wrench (E) to lock the screw (B)

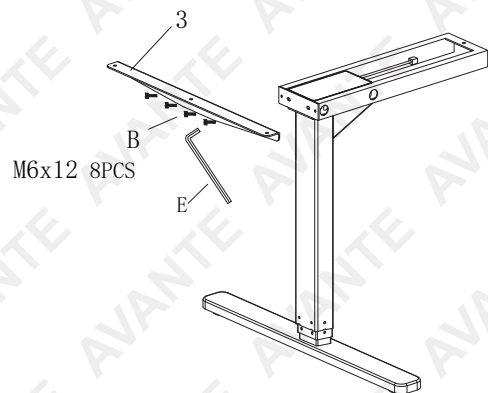

- ④ Insert the connecting rod (7) into the frame (5).

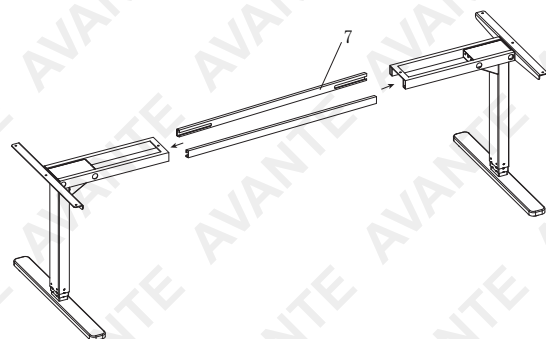

- ⑤ Adjust the distance according to the size of the table, and then tighten the screw (B) with the wrench (E).

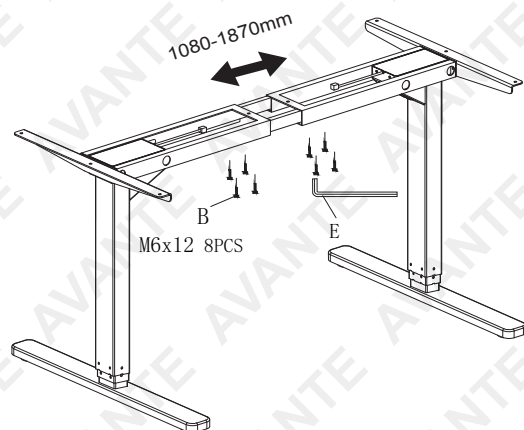

- ⑥ Mount the desktop (1) with screws (A) on the two side plates

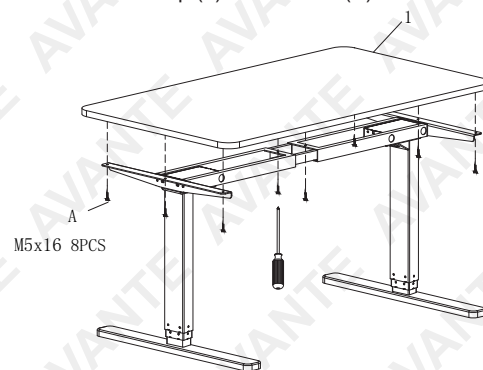

- ⑦ Mount the control box (10) under the desktop (1) with screws (A). Use the screws (D) to install the controller panel (2) under the desktop (the right or left side of the desk can be chosen to mount the control box)

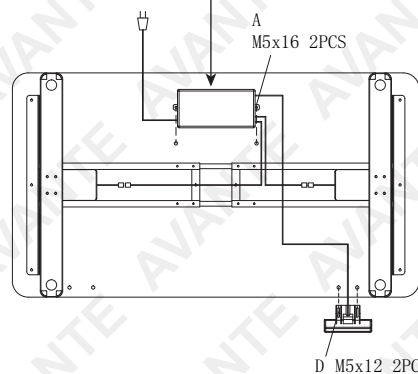
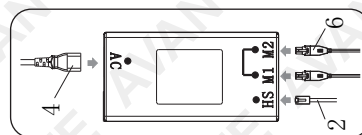

- ⑧

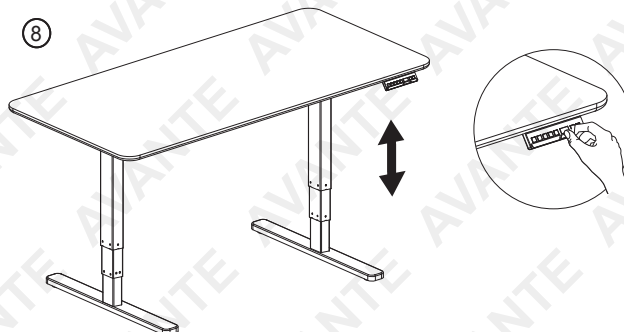

## ► OPERATION

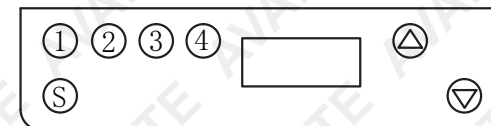

	Press  to display height.
	Press  to display height.
	Press  until display appears. Release the button. Table will move and adjust to corresponding height.
	Press  until display appears. Release the button. Table will move and adjust to corresponding height.
	Press  until display appears. Release the button. Table will move and adjust to corresponding height.
	Press  until display appears. Release the button. Table will move and adjust to corresponding height.
	Function to set new desired height for the desired number button.
Memory Position	After  is pressed, the display flashes, and it sets the new height memory into position. Press  (or any other number) continuously until the [H1] (or H with any corresponding number) appears. Release the button, and it will display the final height of the corresponding number for the table.
Reset	When E2 appears in the display, or simply going to default mode. Press  until it goes to the absolute minimum height, this will eventually to display [RES]. Keep pressing it until [RES] disappears. The reset process is completed.

### Protection Mode: (Auto Lock Screen Mode)

Overheating protection	When the display is showing HOT, it will continuously alert us for 2 minutes. This alert will disappear after 18 minutes of rest.
Sensorless alarm	When the display is showing E10. This indicates when the height value cannot be displayed. Clear it with RESET, or by turning power off & on again
Overload protection	When the display is showing E20. This overload alert occurs when the table motor increasing the height, this will automatically clear after 3 seconds. When the overload alert occurs when the table motor decreasing the height, clear the alert by RESET or turning power off & on again.
Rebound protection	When the display is showing E02. It alarms in reversed compression when running; clear automatically after rebound 4cm; or press any button to clear when rebounding.
Overvoltage alarm	When the display is showing E032. This indicates the voltage is higher than the limit value. This clears automatically when voltage is reduced to below the maximum limit.
Undervoltage alarm	When the display is showing E31. This indicates the voltage is below the limit value. This clears automatically when voltage is increased to above the minimum limit.
Step out alarm	When the display is showing E60. This indicates height difference between the legs. Disconnect the power supply for 1 minute, and then reconnect to remove the warning.
Breaking protection	The table stops and enters a protection mode. This will reset after removing the power supply for 1 minute, and then reconnect them back.
Metric and English unit conversion	Press  for 3 seconds, It will display [---]. Then release . Then, press  until [0] appears in the display. Then, release the button, and it will display current height in Metric unit. Press  for 3 seconds, It will display [---]. Then release . Then, press  until [1] appears in the display. Then, release the button, and it will display current height in English unit.



**Some experts believe that the incorrect or prolonged use of almost any product may cause serious injury or death. To help reduce your risk of serious injury or death, refer to the information below. For more information, see [www.datastreamserver.com/safety](http://www.datastreamserver.com/safety)**

- Consult all documentation, packaging and product labelling before use. Note that some products feature documentation available online. It is recommended to print and retain the documentation.
- Before each use, check the product for loose/broken/damaged/missing parts, wear or leaks (if applicable). Never use a product with loose/broken/damaged/missing parts, wear or leaks.
- Products must be inspected and serviced (if applicable) by a qualified technician every 6 months. This is based on average residential use by persons of average size and strength, and on a property of average metropolitan size. Use beyond these recommendations may require more frequent inspections/servicing.
- Ensure that all users of the product have completed a suitable industry recognised training course before being allowed access to the product.
- If this product has been purchased in error when considering the information presented here, contact the retailer directly for details of their returns policy, if required.
- The product has been supplied by a general merchandise retailer that may not be familiar with your specific application or description of application. Be sure to attain third-party approval from a qualified specialist for your application before use, regardless of any assurances from the retailer or its representatives.
- This product is not intended for use where fail-safe operation is required. As with any product (for example, automobile, computer, toaster), there is the possibility of technical issues that may require the repair or replacement of parts, or the product itself. If the possibility of such failure and the associated time it may take to rectify could in any way inconvenience the user, business or employee, or financially affect the user, business or employee, then the product is not suitable for your requirements. This product is not intended for use where incorrect operation or a failure of any kind, including but not limited to, a condition requiring product return, replacement, parts replacement or service by a technician may cause financial loss, loss of employee time or an inconvenience requiring compensation.

