

PROFLEX



XTR4 II Elliptical Cross Trainer

User Manual

[Revision 2.0 April 2020]

READ THIS MANUAL CAREFULLY BEFORE USE – FAILURE TO DO SO MAY RESULT IN INJURY, PROPERTY DAMAGE AND MAY VOID WARRANTY. • KEEP THIS MANUAL FOR FUTURE REFERENCE. • Products covered by this manual may vary in appearance, assembly, inclusions, specifications, description and packaging.

Safety

Basic precautions, including the following important safety instructions, should always be followed when using this equipment. Read all instructions before use.



Before beginning any exercise program, consult your physician. This is especially important for people over 35 years of age or who have pre-existing health problems. Read all instructions before using any fitness equipment. Do not operate this exercise equipment without properly fitted guards, as the moving parts can present a risk of serious injury if exposed.

- Use this product for its intended use only as described in this user manual. Do not use attachments not supplied or recommended by the manufacturer.
- **Maximum weight capacity = 100 kg.**
- Do not attempt any maintenance or adjustments other than those described in this user manual. Should any problems arise, discontinue use and consult an authorized service centre or personnel.
- Any information or data provided by the equipment is a guide only and is not to be used as medical data or scientific evidence.
- Do not use the unit outdoors.
- Keep children and pets away from the equipment while in use.
- Elderly or disabled users should only use the equipment in the presence of an adult who can provide assistance if required.
- Do not operate where aerosol (spray) products are in use or where adequate oxygen is not available.
- Keep dry – do not operate in wet or moist conditions.
- Keep the unit on a solid, level surface with a minimum safety area clearance of two meters around it. Be sure the area around the equipment remains clear of any obstructions during use.
- The equipment is for domestic household use only.
- One person only should use the equipment at a time.
- Wear comfortable and suitable clothing when using the equipment. Do not use the equipment barefoot or in socks. Always wear appropriate, enclosed athletic footwear. Never wear loose or baggy clothing as it can become caught on the equipment and create a hazard.
- Always hold on to the handrails while using the equipment.
- Do not leave children unsupervised near or on the equipment.
- Children should not be allowed to play or operate the equipment at any time.
- This equipment is not intended for use by persons (including children) with reduced physical, sensory or mental capabilities, or lack of experience and knowledge, unless they have been given supervision or instruction concerning use of the equipment by a person responsible for their safety.
- Keep hands clear of all moving parts. Never place hands or feet off the handles or pedals while the equipment is in use.
- Before using the equipment, check that all visible fasteners are sufficiently tightened and secure.
- Handle or move the equipment with due care to avoid personal injury or damage to the equipment.

Table of Contents

Safety	2
Parts Identification.....	4
Assembly	5
Operation	9
Console and Functions	9
Setting a Pre-Set Session Time / Distance / Calorie / Pulse	9
Adjusting Resistance.....	10
Care, Maintenance and Troubleshooting	11
Cleaning	11
Storage.....	11
Troubleshooting	11
Specifications.....	11
Warm-Up and Cool-Down Routine	12

Parts Identification

The equipment comes partially assembled. The unit comes with the following parts. Ensure that all parts are included before assembly.



No.	Description
1	Main Body (includes flywheel and crank)
2	Front Foot (includes wheels)
3	Rear Foot
4	Centre Brace (includes pedal arm spacers)
5	Pedal Board (2 - left and right)
6	Pedal Arm (2 - left and right)
7	Handlebar (2 - left and right)
8	Stationary Handlebar
9	Console

No.	Description
10	Fasteners / Accessories / Tools: M8x45 Bolt (4) M8x15 Button Head Screw (10) M8x15 Bolt (2) M6x60 Coach Screw (4) M8 Washer (4) M8 Large Washer (2) M8 Curved Washer (14) M8 Acorn Nut (4) M8 Nut (4) Large Wave Washer (2) Pedal Bolt (includes wave washer, washer and nut) (2 - left and right) Nut Cap (2) Spanner Multi-Tool 6 / 8mm Allen Key

Assembly

1. Take all parts out of the carton and place them on a firm, flat surface. Remove all packing materials. Check that all parts have been supplied. Note that some parts may have the necessary fasteners pre-assembled – these will need to be removed during the assembly process.
2. Attach the front foot (has wheels) (2) and rear foot (3) to the main body (1). Attach each foot using 2 M6 coach screws (4), curved washers (5) and acorn nuts (6). Ensure that the screws are inserted from the under side of the feet. Tighten (rotate right) the nuts firmly.

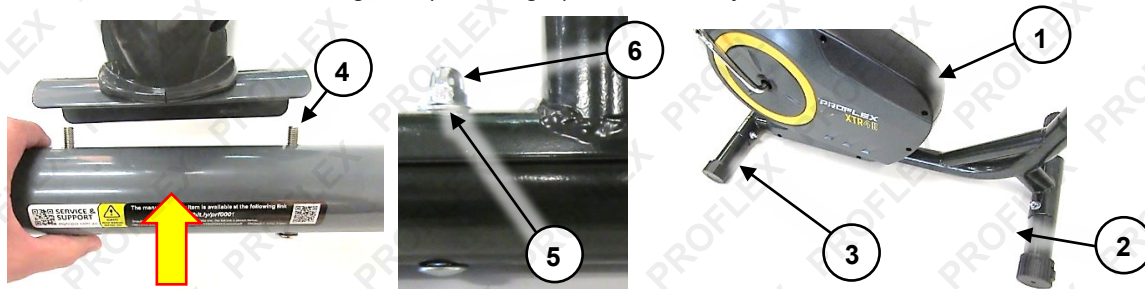

3. Bring the centre brace (7) near its location on the main body and connect the wiring in the main body and centre brace together (A). Do not remove the rubber band holding the wiring at the top of the centre brace (B) at this stage. Additionally, ensure that the tension adjuster is in the "1" setting (C) – the tension cable will be at its longest at this setting.



4. Join the tensioning cables in the centre brace and main body together. The "ball" (D) on the end of the centre brace tensioning cable must sit in the "hook" (E) in the connection bracket on the end of the main body tensioning cable. Once the cable end is hooked into position, pull the cable collar (F) up and over the slot (G) at the top of the cable connection bracket.

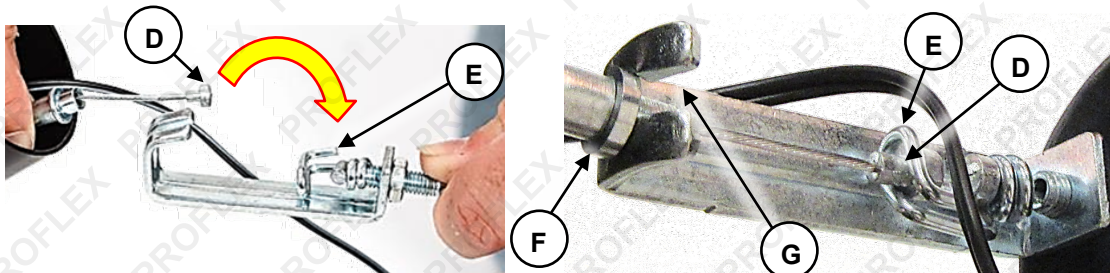

5. Slide the centre brace down over the main body – ensure that not cables or wiring are pinched or caught. Secure the two parts together using 4 M8 button head screws (8) and curved washers (9). Firmly tighten (rotate right) all fasteners using the Allen key.



6. Bring the pedal arms up to the main body in preparation for attachment. Ensure that the pedal arm marked "R" (10) is on the right-hand side of the main body and the pedal arm marked "L" (11) is on the left-hand side when standing behind the main body and looking towards the front. On the centre brace mounting pivots (H) there is a plastic spacer (12), wave washer (13), retaining washer (14), and screw (15). Remove the retaining washer and screw only. Do not remove any grease / lubricant that may be on the mounting pivots.

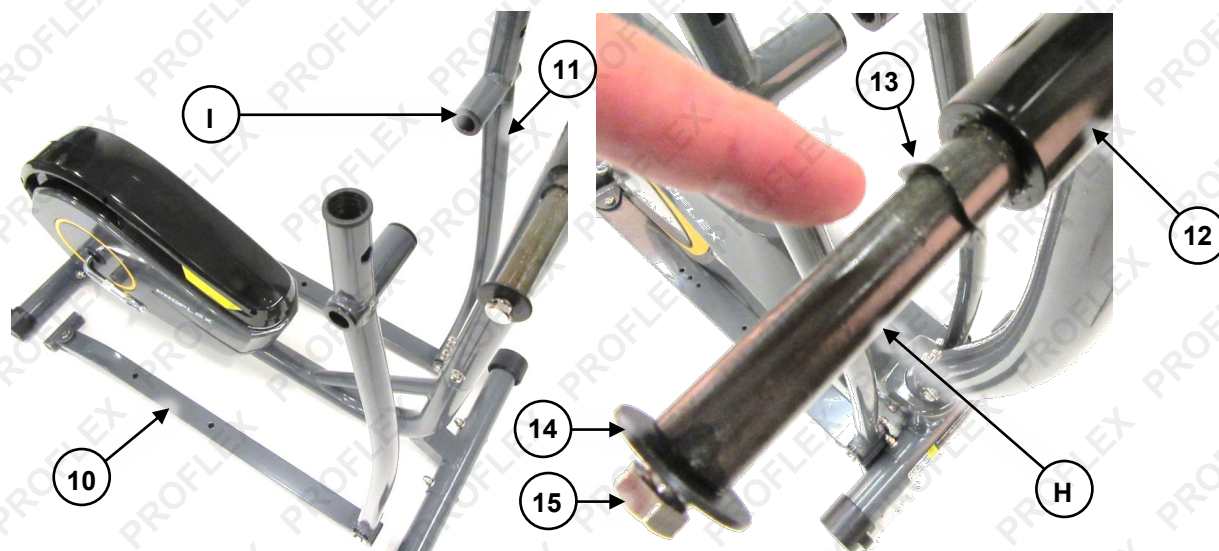

7. Slide each pedal arm sleeve (I) over the mounting pivot – the wave washer should be in-between the pedal arm sleeve and the plastic spacer. Re-install the retaining washer and screw, then tighten the screw (rotate right) using the spanner until the wave washer is starting to compress – do NOT flatten the wave washer as this may cause binding and unnecessary friction.



It is critical that you follow the pedal arm to crank attachment procedure carefully to ensure correct assembly.

• During assembly, do NOT use excessive force to screw the pedal bolts into the crank arms – this may indicate misalignment of the bolts or mis-matched threads. If the bolt does not "feel right" when being screwed in, STOP immediately and check that it is the correct bolt and that it is aligned properly with the crank arm. **Failure to follow the instructions here or take due care may damage the equipment and void any product warranty.**

8. Starting with the right-hand pedal arm, identify the right-hand pedal bolt assembly (16), which is identified by having a right-hand thread (this is the usual type – rotate right / clockwise to tighten) and the nut (17) having a light coloured ring (J). The pedal bolt assembly includes a wave washer (18) and washer (19). Remove the nut and washer only from the pedal bolt. Do not remove any grease / lubricant that may be on the bolt.

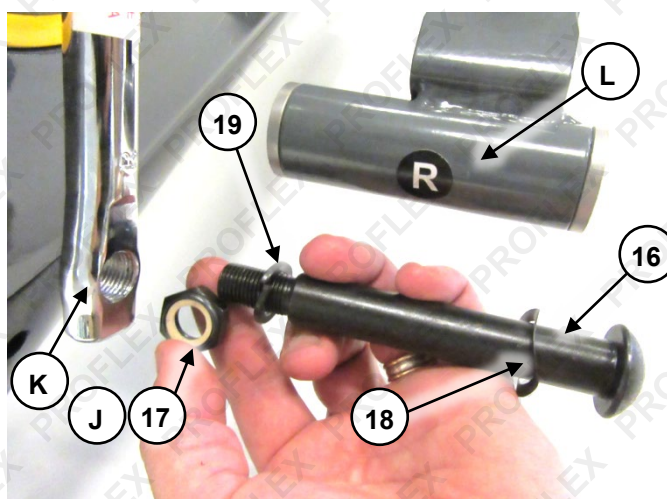

9. It is recommended that before actual assembly, to check that the pedal bolt is correct by screwing it into the crank arm (K) several turns – this should require very little effort. Take extra care when starting the bolt, as the thread is fine. When you are certain the bolt is correct, remove it then continue with the assembly procedure.

10. Insert the pedal bolt through the pedal arm sleeve (L). The wave washer should be in-between the pedal arm sleeve and the head of the pedal bolt. Note that the pedal arm sleeve is able to pivot slightly on the pedal arm – this allows you to rotate it enough so that the sleeve / bolt is at 90° to the crank arm

11. Very carefully begin screwing the pedal bolt into the crank arm (rotate right / clockwise) – it may be necessary to "wiggle" the pedal arm sleeve a little to avoid possibly jamming the bolt and making it difficult to turn. If the bolt does not "feel right" when being screwed in, STOP immediately and check that it is the correct bolt and that it is aligned properly with the crank arm. When the wave washer is just starting to compress (**M**), stop screwing the pedal bolt in – do NOT flatten the wave washer as this may cause binding and unnecessary friction.
12. Insert the washer (**19**) and nut (**17**) onto the end of the pedal bolt. Hold the pedal bolt in position using the Allen key so it does not rotate, then firmly tighten (rotate clockwise) the nut using the spanner.

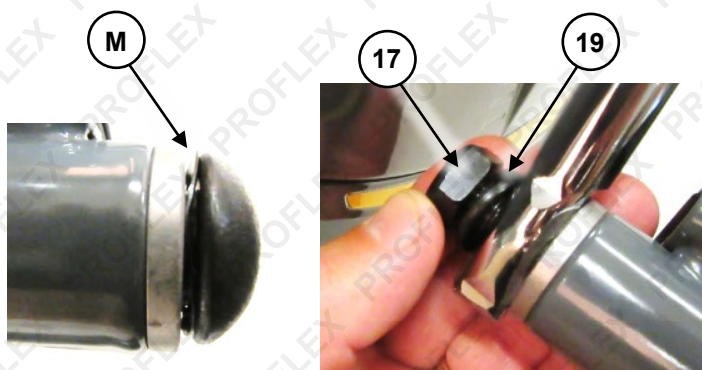

13. Repeat steps 8 to 12 for the left-hand pedal arm, noting that the pedal bolt and crank arm thread is left-hand (rotate left / anti-clockwise to tighten) and that the pedal bolt nut has no particular identifying colour.
14. Attach the pedal boards (**20**) to the applicable pedal arm. Attach each pedal board using 2 M8x45 screws (**21**), inserted from the top, and secure from underneath the pedal arm using 2 M8 washers (**22**) and M8 nuts (**23**). Tighten the nuts (rotate right) using the spanner.

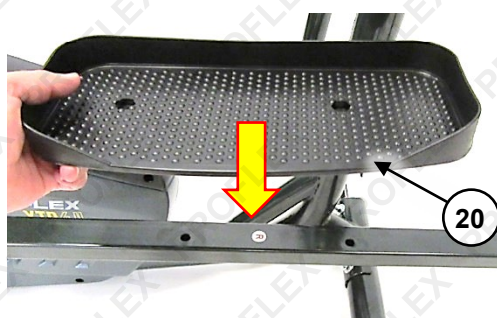

15. Bring the stationary handlebar (**24**) into position against the centre brace so the handlebars are facing up and towards the rear of the machine, and the brackets are aligned. Ensure that the wiring is not caught or pinched by the brackets.
16. Attach the stationary handlebar using 2 M8 button head screws (**8**) and curved washers (**9**) and tighten (rotate right) using the Allen key.

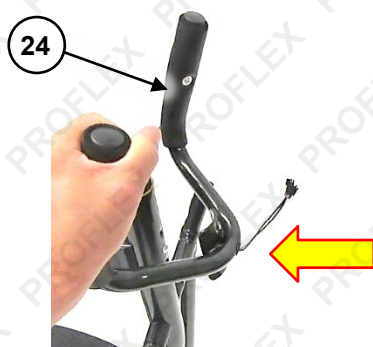

17. Lower the right and left handlebars (**25** and **26** (not shown)) down over the tubes at the top-front of the pedal arms. The handlebars should be positioned so that they extend forward.
18. Attach each handle bar using 2 M8 button head screws (**8**) and curved washers (**9**). Tighten (rotate right) the screws using the Allen key.



19. Remove the pre-assembled screws (**N**) from the rear of the console (**28**), then connect the wiring between the console and centre brace (**O**) (the cables can be connected one way only). Allow any loose cable to sit in the centre brace tube.
20. Attach the console to the top of the centre brace using the 2 screws (**N**) – there are two possible positions – select the one most comfortable for you. Ensure that the pulse sensor cables are not being pinched between the brace and console. Connect the pulse sensor cables from the stationary handle and console (**P**).

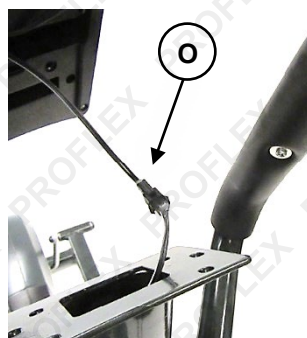
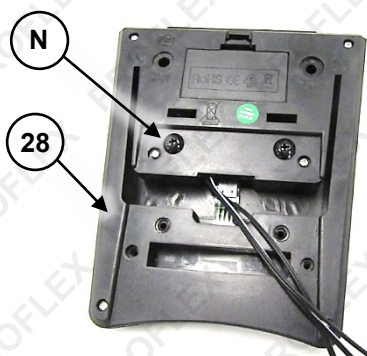

Note: Some units may come with a single 3.5mm jack instead of the dual connectors shown in image above.

Push the plastic nut caps on to the tops of the fasteners identified by , below (on both sides). When correctly assembled, the machine should resemble the image below and is ready for use.

Moving

The unit can be tilted onto its front foot wheels for easy moving and storage. Firmly grasp the stationary handlebar with both hands. Next, carefully tilt the equipment forward until it rolls freely on the wheels.



Operation

Console and Functions

The equipment features a computerized display that provides you with workout information, such as duration, speed, distance travelled, pulse etc. The console activates as soon as a key is pressed or the pedals are moved. When the machine is not being used, the console switches off automatically after 4 minutes.

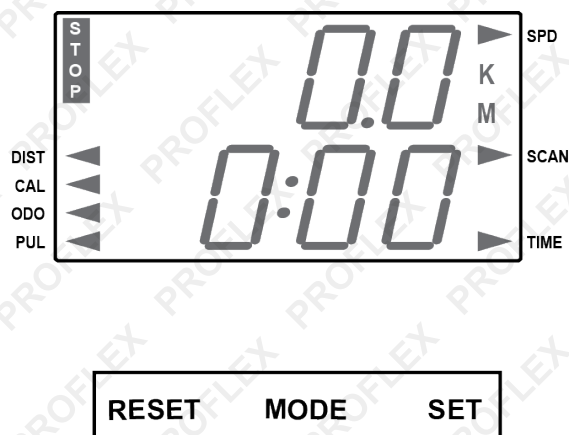

Control	Description
Display	Shows various information depending on current function. For example, current speed, used calories, current pulse etc. Note: When displaying pulse, you must have both hands on the metal sensors on the stationary handlebar. If no pulse is detected, "P" may be displayed and some functions are unavailable • To approximately convert calories to kilojoules, multiply the number of calories by 4.
MODE	Press to switch between available functions. The current function is indicated by having an arrow shown next to it: DIST - When in "setting" mode, program a target distance (range = 0 to 999.9 km). When exercising, shows the current distance travelled for the session. CAL - When in "setting" mode, program a target calorie amount (range = 10 to 9999 cal). When exercising, shows the current calories used for the session. ODO - When exercising, shows the current distance travelled for all sessions combined (returns to zero if the batteries are removed). PUL - When in "setting" mode, program a target heart rate (range = 80 to 180 bpm). When exercising, shows your current heart rate. TIME - When in "setting" mode, program a target session duration (range = 0 to 99 minutes and 59 seconds). When exercising, shows the current time elapsed for the session. SCAN - When exercising, automatically steps the display between each function every 4 seconds.
SET	Press to activate "setting" mode and to increase the current value when setting target values (for example, time, distance etc).
RESET	When in "setting" mode, press to return the current value to zero "0".

Setting a Pre-Set Session Time / Distance / Calorie / Pulse

When training to pre-set session values, the console beeps once you have achieved each target value. For example, setting a time of 5 minutes, distance of 3km, calories used of 50, and pulse of 110 will cause the

console to beep if your pulse reaches 110, beep again if you use 50 calories, beep again if you travel 3km and beep again after 5 minutes. You can set targets for all values, or whichever ones you want.

1. Press **MODE** as required until the arrow is shown next to the required function (distance, calories, pulse or time).
2. Press **SET** to enter "setting" mode and apply a target value. Press again to increase the value or hold down to more quickly increase the target value.
3. Press **MODE** to step to the next function you want to set a target value for, then use **SET** to enter the value and so on. Repeat this process as required, then begin your workout.

To cancel the target value and start again, press **RESET** (any other currently set values will remain unchanged).

Adjusting Resistance

The resistance of the crank to being rotated can be adjusted. Increased resistance requires more effort and, therefore, uses more energy. To adjust crank resistance, rotate the knob on the central brace – 1 = least resistance, 8 = greatest resistance.



Care, Maintenance and Troubleshooting



Some maintenance activities described may be beyond the scope of some users. For procedures that you are not comfortable with or have the tools or experience for, have the unit serviced by a service centre or qualified technician.

Cleaning

The equipment can be cleaned with a soft cloth and mild detergent. Do not use abrasives, solvents or harsh chemicals. Be careful not to get excessive moisture on the display panel as this may damage it.

After each use, wipe the unit of any sweat, dirt or liquids. Keep the equipment, especially the display console, out of direct sunlight to prevent damage to the screen.

Storage

Store the equipment in a clean and dry indoor environment. Never leave or use the unit outdoors.

Troubleshooting

The following information may assist in identifying a problem and rectifying it.

Problem	Potential Reason	Correction
<i>Pedals or handles tight or making noise.</i>	A. Pedal bolts or retaining screws too tight. B. Pivots require lubricating.	A. Loosen fasteners so that wave washers are not compressed flat. For pedal bolts, hold bolts in positions when tightening nuts. B. Disassemble pivots, clean components, then smear with grease before reassembling.
<i>Console not working.</i>	A. Batteries no longer serviceable. B. Connection problem. C. Console problem.	A. Replace batteries. B. Check all connections are secure and wiring is not pinched or damaged. Replace is necessary. C. Replace console.

When to Call for Help

This equipment is designed with user safety as a priority. In the event of equipment failure, call an authorized service centre or technician for servicing.

Specifications

Weight Capacity

100kg

Warm-Up and Cool-Down Routine

The *warm-up* routine is an important part of any workout. The purpose of warming up is to prepare your body for exercise and to minimize injuries. Warm up for two to five minutes before aerobic exercising. It should begin every session to prepare your body for more strenuous exercise by heating up and stretching your muscles, increasing your circulation and pulse rate, and delivering more oxygen to your muscles.

Always perform a *cool-down* routine after your workout, repeat these exercises to reduce soreness in tired muscles. The purpose of cooling down is to return the body to its resting state at the end of each exercise session. A proper cool-down slowly lowers your heart rate and allows blood to return to the heart.

- A. Head Roll** - Rotate your head to the right for one second, you should feel a stretching sensation up the left side of your neck. Then rotate your head back for one second, stretching your chin to the ceiling and letting your mouth open. Rotate your head to the left for one second, then drop your head to your chest for one second.
- B. Shoulder Lift** - Lift your right shoulder toward your ear for one second. Then lift your left shoulder up for one second as you lower your right shoulder.
- C. Side Stretch** - Open your arms to the side and lift them until they are over your head. Reach your right arm as far toward the ceiling as you can for one second. Repeat this action with your left arm.
- D. Quadricep Stretch** - With one hand against a wall for balance, reach behind you and pull your right foot up. Bring your heel as close to your buttocks as possible. Hold for 15 seconds and repeat with left foot.
- E. Inner Thigh Stretch** - Sit with the soles of your feet together and your knees pointing outward. Pull your feet as close to your groin as possible, then gently push your knees toward the floor. Hold for 15 seconds.
- F. Toe Touch** - Slowly bend forward from your waist, letting your back and shoulders relax as you stretch toward your toes. Reach as far as you can and hold for 15 seconds.
- G. Hamstring Stretch** - Extend your right leg. Rest the sole of your left foot against your right inner thigh. Stretch toward your toe as far as possible. Hold for 15 seconds. Relax and then repeat with left leg.
- H. Calf/Achilles Stretch** - Lean against a wall with your right leg in front of the left and your arms forward. Keep your left leg straight and the right foot on the floor; then bend the right leg and lean forward by moving your hips toward the wall. Hold, then repeat on the other side for 15 seconds.

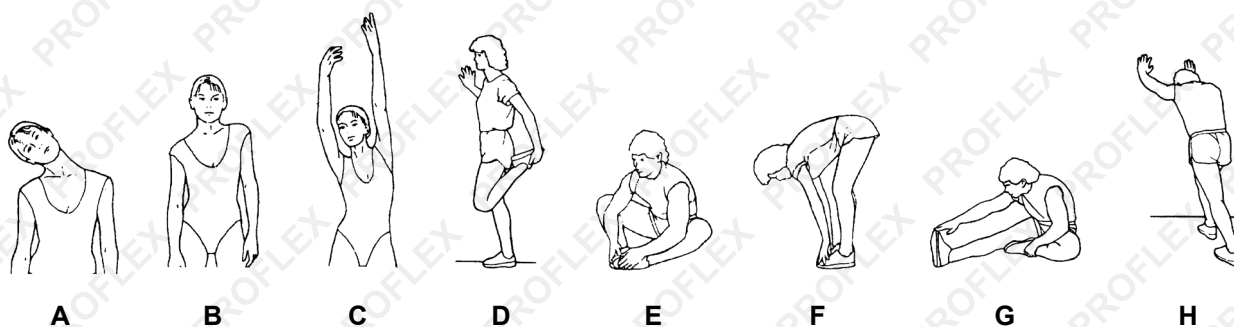



Some experts believe the incorrect or prolonged use of almost any product could cause serious injury or death. For information that may reduce your risk of serious injury or death, consult the points below and additionally, the information available at www.datastreamserver.com/safety

- Consult all documentation, packaging and product labelling before use. Note that some products feature online documentation which should be printed and kept with the product.
- Check product for loose / broken / damaged / missing parts, wear or leaks (if applicable) before each use. Never use a product with loose / broken / damaged / missing parts, wear or leaks (if applicable).
- Products must be inspected and serviced (if applicable) by a qualified specialist every 6 months assuming average residential use by a person of average weight and strength, above average technical aptitude, on a property matching average metropolitan specification. Intended use outside these guidelines could indicate the product is not suitable for intended use or may require more regular inspection or servicing.
- Ensure all possible users of the product have completed an industry recognized training course before being given access to the product.
- The product has been supplied by a general merchandise retailer that may not be familiar with your specific application or your description of the application. Be sure to attain third-party approval for your application from a qualified specialist before use regardless of prior assurances by the retailer or its representatives.
- This product is not intended for use where fail-safe operation is required. As with any product (take an automobile, aircraft, computer or ball point pen for example), there is always a small chance of technical issues that needs to be repaired or may require replacement of the product or a part. If the possibility of such failure and the associated time it takes to rectify could in any situation inconvenience the user, business or employee then the product is not suitable for your requirements. This product is not for use where incorrect operation or a failure of any kind, including but not limited to a condition requiring product return, replacement, service by a technician or replacement of parts could cause a financial loss, loss of employee time or an inconvenience requiring compensation.
- If this item has been purchased in error after considering the points above, simply contact the retailer directly for details of their returns policy, if required.

