



30L Wet/Dry Vacuum Cleaner and Drywall Sander

User Manual

[Revision 1.0 July 2018]

READ THIS MANUAL CAREFULLY BEFORE USE – FAILURE TO DO SO MAY RESULT IN INJURY, PROPERTY DAMAGE AND MAY VOID WARRANTY. • KEEP THIS MANUAL FOR FUTURE REFERENCE. • Products covered by this manual may vary in appearance, assembly, inclusions, specifications, description and packaging.

Safety

Electrocution / Shock Hazards

- Before use, ensure that the electrical supply voltage is the same as specified on the rating label.
- NEVER immerse the motor housing in water or any other liquid.
- When vacuuming liquids, if liquid overflows from the air outlet, switch the machine OFF and disconnect it from the electrical supply, then remove the motor housing and empty the barrel before continuing.
- If the supply cord is damaged, it must be replaced by the manufacturer or its service agent to a similarly qualified person in order to avoid a hazard.

General Safety

- Do not use the machine in the presence of combustible or explosive substances, as the electric motor may present an ignition source.
- Do not vacuum up combustible or explosive objects such as cigarettes, petrol etc.
- Do not run the machine if the suction hose is blocked, as this may over-heat and damage the motor. Always ensure the suction hose is not blocked.
- Do not vacuum up sharp objects that may damage the filter or hoses, such as glass etc.
- Do not vacuum up objects that may attach and block the filter, such as concrete dust etc, as this may over-heat and damage the motor.
- The machine is intended for competent adult use only.
- When vacuuming stairways, take extra precautions to prevent machine instability, falls etc.
- Switch the machine OFF and disconnect it from the electrical supply after use, when storing or when cleaning.
- Avoid storing the machine in direct sunlight or near heat sources as this may damage some machine surfaces.
- Do not use the electrical cord or hoses to pull or lift the machine. Avoid kinking, pinching or crushing cords and hoses.
- This appliance is not intended for use by persons(including children) with reduced physical,sensory or mental capabilities,or lack of experience and knowledge,unless they have been given supervision or instruction or instruction concerning use of the appliance by a person responsible for their safety

Warranty Information

- The product is warranted for a limited period against faulty materials and workmanship.
- Warranty claims and repairs must be carried out through an authorized service centre or agent.

Warranty does not cover:

- Normal wear and tear.
- Incorrect use or improper care or maintenance.
- Not following instructions for use and maintenance or safety related information contained in this manual.
- Using non-approved accessories or modification to any part of the machine.

Features and Accessories

- Wet and dry use.
- High power section.
- On-board accessory holders.
- Hinged stainless steel barrel for easy emptying.
- High performance, easy-clean filter.
- Includes slim nozzle for narrow areas and corners, brush for delicate surfaces and wide attachment for flooring, carpet etc.

Operation

1. Insert the suction hose into the connector on the barrel as shown. Rotate the hose fitting right to lock it.
2. Connect the required accessory to the free end of the suction hose, as shown.
3. Connect the machine to the electrical supply.
4. Switch the machine ON.

Dry Use

- Ensure the filter is installed.

Wet Use

- Ensure the filter is NOT installed.
- Empty the barrel before use.

Note: During wet use, if the barrel fills to its allowable maximum with liquid, the machine will automatically bypass suction and the motor will noticeably increase in speed as there is no load on it. You must empty the barrel before continuing use.

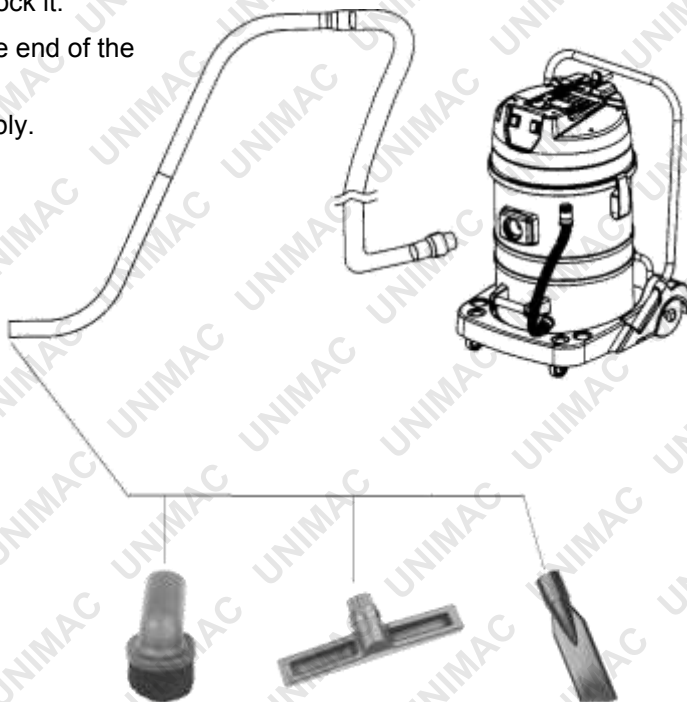

Cleaning and Maintenance

The machine has a large capacity barrel and high-performance filter. However, when the filter becomes excessively dirty or the barrel becomes full, machine suction will reduce. For best performance and longest service life, it is essential to regularly empty the barrel and clean the filter.

To empty the barrel:

1. Switch the machine OFF and disconnect it from the electrical supply.
2. Unclip the motor housing latches and lift the motor housing off the barrel.
3. Carefully remove the filter from the barrel.
4. If required, disconnect the suction hose from the barrel.
5. Empty the barrel by either lifting it from the base or using the tilt function.

To clean the filter:

1. Remove the filter from the machine.
2. Wash the filter in warm, clean water and rinse well. Compressed air may also be used to blow dust and other particles from the filter fibres.
3. Allow the filter to dry before using again. Do not wring.

Drywall Sander

DMJ-800B

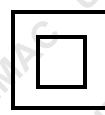

WARNING! Please read all safety instructions and advises to lower the risk of injuries.





Technical Specifications

Model	DMJ-800B	
Rated power:	800W	
Rated voltage / current:	240V~50Hz	
Protection class :	II	
Sound pressure level:	79.9dB(A)	K=1.5 dB
Sound power level:	90.9dB(A)	K=1.5dB
Hand-arm vibration:	2.254m/s ²	K=1.5 m/s ²

General safety regulations

WARNING: Please read all safety instructions and advises.

Failure in abiding the safety instructions may lead to electric shock, fire and/or serious injury.

The term "electric tool" used in the safety instructions means line-powered electric tools (with power wire) and battery powered electric tools (without power wire).

KEEP THESE SAFETY INSTRUCTIONS WELL.

1) Working place

a) Keep your working place clean and well lit.

Disordered and dark working places may lead to accidents.

b) Do not work with the electric tool in an explosive surrounding where there are combustible liquids, gases and dusts.

Electric tools cause sparks which can inflame the dust or the damps.

c) Keep away from children and other persons when working with the electric tool.

In case of distraction, you might lose control over the device.

2) Electric safety

a) The power plug of the tool has to fit into the socket. The plug must not be modified in any way. Never use adaptor plugs together with earthed electric tools.

Unmodified plugs and fitting sockets lower the risk of electric shock.

b) Avoid body contact with earthed surfaces like pipes, heaters, cookers and fridges.

It is a higher risk of electric shock if your body is earthed.

c) Keep tool away from rain and wet.

Penetration of water into an electric tool raises the risk of electric shock.

d) Do not divert the cable from its intended use to carry the tool, hang it or to pull the plug from the socket. Keep the cable away from heat, oil, sharp edges and moving parts.

Damaged or ensnared cables raise the risk of electric shock.

e) If you work with your electric tool outside, only use extended wires being suitable for outside use.

Usage of extended wires, being suitable for outside use, can lower the risk of electric shock.

f) If you cannot avoid using the tool in a humid environment, use a suitable fuse protection.

Using a suitable fuse protection lowers the risk of electric shock.

3) Personal safety

a) Be attentive, watch what you are doing and do your work with the electric tool with sanity. Do not use any electric tool if you are tired, under drugs, alcohol or medicaments.

One moment of carelessness when using an electric tool can cause serious injuries.

b) Always wear personal protective equipment and always protection glasses.

Wearing of personal protective equipment like dust mask, anti-slip safety shoes, protection helmet or ear protection, according to the kind of use of the electric tool, lowers the risk of injury.

c) Avoid accidental start-up. Make sure that electric tool is switched off before connecting it to power supply, battery, lifting up or carrying.

Keep the finger on the switch when carrying the tool or connecting the tool to the power supply while turned on can cause accidents.

d) Remove adjusting tools or wrenches before turning on the machine.

A tool or wrench, being in a moving part of the machine can cause injuries.

e) Avoid abnormal posture.

Stand safe and always keep the balance.

Thus you can better control the tool in unexpected situations.

f) Wear suitable clothing. Do not wear loose clothing or jewelry. Keep hair, clothes and gloves away from movable parts.

Loose clothes, jewelry or long hair could be caught by movable parts.

g) When dust vacuum- and collection devices can be assembled, make sure that they are connected and used properly.

Using a dust vacuum device can lower danger from dust.

4) Careful handling and use of electric tools

a) Do not overload the machine. Always use the electric tool being suitable for your work.

With the suitable tool you work safer and better in the given power range.

b) Do not use electric tools with a defect switch.

An electric tool which you cannot turn on or off is dangerous and must be repaired.

c) Pull the plug from the socket and/or remove the battery before you adjust the device, change equipment or store the tool.

This will avoid accidental start-up of the electric tool.

d) Keep away unused electric tools from children. Do not let persons use the tool, which are not used to it or never read this instruction.

Electric tools are dangerous when used by inexperienced persons.

e) Maintain the electric tool with care. Check if movable parts run properly and don't trap, if parts are broken or damaged and that the function of the tool is not affected. Repair damaged parts before using the tool.

The cause of many accidents is bad maintained electric tools.

f) Keep cutting tools sharp and clean.

Well maintained cutting tools with sharp knife edges trap less and are easier to use.

g) Use electric tool, auxiliary, additional tools according to these instructions. Consider working conditions and the work task. The use of electric tools for different purposes than intended can cause dangerous situations.

5) Service

a) **Let your electric tool only repair by qualified personnel and with original spare parts.** *This will ensure, that the safety of the device will be kept.*

Additional safety regulations



WARNING! Read all safety regulations and instructions to lower the risk of injuries.

WARNING! The dusts, emerging while working with the tool, can be dangerous for health:

- Always wear a mask and protection glasses when working with grinding tools.
- Never work with asbestos-containing materials. Asbestos causes cancer.
- Special caution with grinding lead-containing materials:
 - All persons working with the device or accessing the working place, have to wear a special mask to protect from lead paint and –damp.
 - No access to the work place for children and pregnant women.
 - Do not eat, drink or smoke at the working place.
- Contact with grinding dust or inhaling it (e.g. of lead-containing paints) can cause health damages to the user or other present persons. Always wear suitable personal protection equipment e.g. dust mask and use the dust bag when grinding.
- Always keep away the power cable from movable parts of the device.
- Wear protection glasses, esp. when grinding over head.

ELECTRIC SAFETY

- The current on the label have to comply with the power supply.
- If the power cord of the device is damaged, it has to be replaced by the manufacturer or his customer service or similar qualified persons, to avoid dangers.
- Immediately throw away the old cord or plug after replacing it. Plugging in a loose cord into the socket is dangerous.
- Only use approved extension cords which are suitable for the power input of the machine. The conductors must have a cross-section of min. 1.5 mm². Always completely release cord when using a cable drum.
- Do not wind the cord and avoid body contact with it.

USE OF THE SANDER

DUST COLLECTING

The sander can be fitted with a dust bag (sold separately) to keep the working area clean. The dust bag has to be attached to the opening at the rear of the device. Frequently empty dust bag for optimal function.

FOR THAT PURPOSE, DO AS FOLLOWING:

- Lightly turn dust bag and pull out of the dust bag holder.
- Empty dust bag at a suitable point.
- Press dust bag on dust bag holder until latching.

Attention: Dust exhaustion only works with use of perforated sanding disk.

CONNECT DRYWALL SANDER TO VACUUM CLEANER

The following items are furnished with the Drywall Sander.

- One vacuum hose: 4m long (includes a standard 38mm vacuum cleaner connector on end and a special swivel connector on the Sander end)., with a static dissipating feature to dissipate static electrical charges that are sometimes experienced when recovering drywall dust.
- One 38mm to 47mm adapter (adapts the 38mm hose connector to fit a 47mm vacuum cleaner).

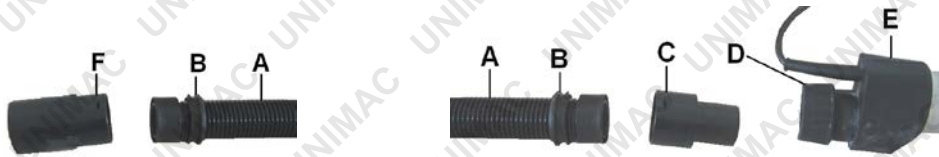

CHANGE SANDING DISK

Pull out power plug before assembling the sanding disk.



The Velcro fastener for the sanding disk simplifies the change of the sanding disk.

Simply strip the sanding disk.

Put the new sanding disk onto the center of the grinding plate and press. With a rough sanding disk (graining 50) generally the largest part of the material will be discharged. Use a precise sanding disk (graining 20) for precise grinding.

CHANGE GRINDING PLATE

When Velcro fastener is worn out, change the grinding plate.

Pull off the power plug before changing the grinding plate.

- Remove the sanding disk from the grinding plate.
- Loosen the bolts attaching the grinding plate to the device.
- Take off the grinding plate.
- Attach the new grinding plate to the device.
- Tighten the bolts.

TURN ON AND OFF

Move the main switch forward to start the device. Set it back to turn it off.

Care and maintenance



Keep the ventilating holes clean to guarantee the cooling of the machine.

Pull out the power plug of the power socket before maintenance and repair the device.

The device is equipped with carbon brushes. The device turns off when abrasion of the carbon brushes reaches a certain limit.

Let the carbon brushes change only by qualified customer service.

Repairs have to be done by qualified customer service only. Only use original spare parts.

If the **power cord** of the device is damaged, it has to be replaced by the manufacturer or his customer service or similar qualified persons, to avoid dangers.

Guaranty

Guaranty is handled according to law regulations.

Guaranty expires when repair was done by third party. In case of damage you can send back the device to the manufacturer. To claim the guaranty demand, device must not be opened.

Environmental protection

Dispose the device, auxiliaries and package environmentally friendly.



Do not dispose electric devices with household garbage.

According to European law 2002/96/EG for old electric devices, implemented into national

regulations, used-up electric devices have to be collected separately and conducted to environmentally friendly recycling.

Recycling-alternative to return consignment: The owner of the electric device, alternatively to return consignment is committed to cooperate at proper recycling in case of relinquishment of ownership. The old device can be disposed at any redemption point, which executes the disposal according to relevant recycling regulations.

This does not apply for attached auxiliaries and utilities without electric parts.

How to Install Hose - Drywall Sander

1. Loosen large locking nut on the end of the drywall sander, where the hose will connect to.



2. The unit comes with 2 adapters, use the smaller of the 2 . Line up the windows on the adapter with the clips from the hose and apply pressure with the 2 pieces together to lock them into place.



3. Once the adapter is connected to the hose, insert the adapter into the drywall sander and tighten the large locking nut to ensure the hose doesn't come loose.



Connecting the Drywall Sander to the Vacuum

1. Remove hose that is supplied with vacuum.



2. Remove the adapter connected to the vacuums hose.
 - a. Use a flathead screwdriver to push the hose clips through the adapters windows. You will need to do this to both clips to free the adapter.

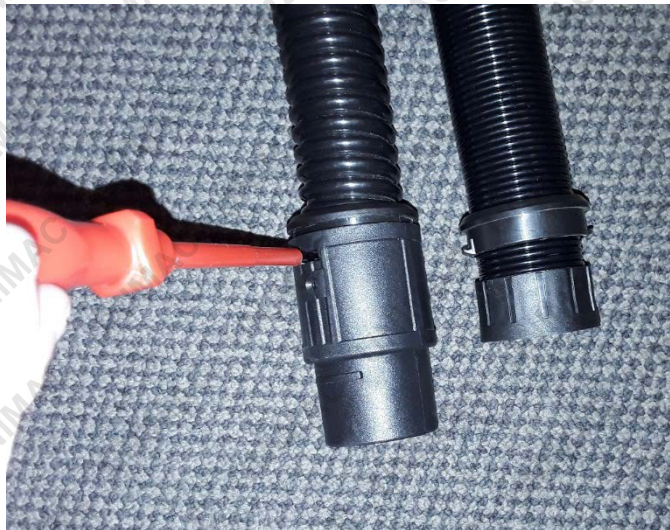

3. Connect adapter from the vacuum to the opposite end of the drywall sanders' hose. Line up the windows from the adapter with the clips from the hose and apply pressure with the 2 pieces together to lock them into place.



4. Insert adapter into vacuum, twist to lock into place.



Plug drywall sanders' power cable into supplied power point on vacuum.



Once ready, use switch 2 on vacuum. The vacuum will auto-engage and disengage after a few seconds when the drywall sander is in the corresponding on or off position.



Some experts believe that the incorrect or prolonged use of almost any product may cause serious injury or death. To help reduce your risk of serious injury or death, refer to the information below. For more information, see www.datastreamserver.com/safety

- Consult all documentation, packaging and product labelling before use. Note that some products feature documentation available online. It is recommended to print and retain the documentation.
 - Before each use, check the product for loose/broken/damaged/missing parts, wear or leaks (if applicable). Never use a product with loose/broken/damaged/missing parts, wear or leaks.
 - Products must be inspected and serviced (if applicable) by a qualified technician every 6 months. This is based on average residential use by persons of average size and strength, and on a property of average metropolitan size. Use beyond these recommendations may require more frequent inspections/servicing.
 - Ensure that all users of the product have completed a suitable industry recognised training course before being allowed access to the product.
 - If this product has been purchased in error when considering the information presented here, contact the retailer directly for details of their returns policy, if required.
- The product has been supplied by a general merchandise retailer that may not be familiar with your specific application or description of application. Be sure to attain third-party approval from a qualified specialist for your application before use, regardless of any assurances from the retailer or its representatives.
 - This product is not intended for use where fail-safe operation is required. As with any product (for example, automobile, computer, toaster), there is the possibility of technical issues that may require the repair or replacement of parts, or the product itself. If the possibility of such failure and the associated time it may take to rectify could in any way inconvenience the user, business or employee, or financially affect the user, business or employee, then the product is not suitable for your requirements. This product is not intended for use where incorrect operation or a failure of any kind, including but not limited to, a condition requiring product return, replacement, parts replacement or service by a technician may cause financial loss, loss of employee time or an inconvenience requiring compensation.



©2018 Unimac. All rights reserved. No part of this document, including descriptive content, concepts, ideas, diagrams or images may be reproduced or transmitted in any form or by any means, electronic or mechanical, including photocopying, scanning or recording, or any information storage and retrieval system, without express permission or consent from the publisher.