



Click to Watch:

[Starting a 4-Stroke](#)



## Trowelling Machine

### User Manual

[Revision 5.0 October 2018]

---

READ THIS MANUAL CAREFULLY BEFORE USE – FAILURE TO DO SO MAY RESULT IN INJURY, PROPERTY DAMAGE AND MAY VOID WARRANTY. • KEEP THIS MANUAL FOR FUTURE REFERENCE. • Products covered by this manual may vary in appearance, assembly, inclusions, specifications, description and packaging.



The product is NOT supplied with engine oil, although traces of oil from the manufacturing process may be present. It is essential to add adequate engine oil of the correct type to the engine before use. **Failure to add engine oil will void the product warranty.**

---

# Table of Contents

<b>Safety.....</b>	<b>1</b>
<b>Operation .....</b>	<b>3</b>
Technique.....	3
Trowelling .....	3
<b>Quick Start Guide.....</b>	<b>6</b>
<b>Maintenance .....</b>	<b>7</b>
Spark Plug.....	7
Air Filter .....	7
Oil .....	7
<b>Specifications.....</b>	<b>8</b>

# Safety

## Hazards and Risks

- Never allow an untrained person to operate machine without adequate instruction.
- Ensure all users read, understand and follow the operating instructions.
- Serious injury may result from improper or careless use of this machine.
- Power trowels are heavy units and require a multiple person lift, using correct lifting techniques and people of appropriate strength. Where provided, use the lifting eye for mechanical lifts using approved lifting devices.

## Mechanical Hazards

- DO NOT operate the machine unless all protective guards are in place.
- Ensure that the motor operation switch is in the OFF position and the spark plug ignition lead is disconnected before removing the guards or making adjustments.
- DO NOT increase the governed no-load motor speed above 3,500RPM. Any increase may result in personal injury and damage to the machine.
- Be sure the runaway protection switch provided is working properly so that if the handle should slip away from your control, the ignition supply will be cut off. However momentum may allow the handle to rotate one full turn before stopping the machine. Step away from the machine if control is lost.
- Take care not to come in contact with the muffler when the engine is hot, since it may result in severe burns.
- Keep hands and feet clear of rotating or moving parts as they will cause injury if contact is made.
- It is important that the operator retains a firm grip with the left hand at some point on the handle when starting the engine, preferably close to throttle control.
- When starting the trowel do not exceed ¼ throttle setting. A higher setting could engage the centrifugal clutch causing the handle to rotate.
- Be careful with the trowel around pipes sticking out of the floor or other obstacles. Should the trowel blades catch on these, serious damage to the machine or harm to the operator may result.
- Ensure that repairs to the motor and machine are carried out by qualified personnel.

## Fire & Explosion Hazards

- PETROL is extremely flammable and explosive under some conditions.
- ENSURE that petrol is only stored in an approved storage container.
- DO NOT refuel the motor while it is in operation or hot.
- DO NOT refuel the motor in the vicinity of sparks, naked flames or a person smoking.
- DO NOT overfill the fuel tank and avoid spilling petrol when refuelling. Spilled petrol or petrol vapour may ignite. If spillage occurs, ensure that the machine is dry before starting the motor.
- Ensure that the fuel tank cap is securely fitted after refuelling.

## Chemical Hazards

- DO NOT operate or refuel a petrol motor in a confined space without adequate ventilation.
- Carbon monoxide exhaust gases from internal combustion motor driven units can cause death in confined spaces.

**Noise Hazards**

- Excessive noise can lead to temporary or permanent loss of hearing.
- Wear an approved hearing protection device to limit noise exposure, as required by Occupational Health and Safety regulations.

**Protective Clothing**

- Wear protective goggles, clothing and footwear while operating the machine.

**Additional Hazards**

- Slips/trips/falls are major causes of serious injury or death. Beware of obstacles or water left on the walking or work surface.
- Exercise caution and ensure that the perimeter of elevated formwork or platforms is protected.
- Always maintain good footing so that you do not slip and lose control of the handle when starting or operating the trowel.
- Always ensure that the operators have been properly trained prior to using the equipment.
- Children and small animals should NEVER be present in the work area during operation of the trowelling machine.
- ALWAYS check your trowelling machine for loose or missing nuts and bolts before starting. Tighten any loose fasteners and replace missing or broken parts.
- Perform all routine maintenance as described within this manual. Failure to do so will void your warranty and will eventually result in premature equipment failure.
- NEVER perform maintenance on a running piece of equipment. Shut down the engine and allow it to cool before servicing the trowelling machine, including mechanical work or lubrication.
- ALWAYS replace missing, damaged or unclear safety labels to ensure operator awareness and safety.
- NEVER operate the trowelling machine with missing or damaged safety guards. Replace immediately with appropriate Nexus parts.
- NEVER put hands, feet, or other appendages inside the guard ring or belt guard while the engine is running, even at idle or with protective clothing, as serious injury may result.
- NEVER wear loose fitting clothing or jewellery around rotating equipment such as the trowelling machine as it may become entangled in the machinery, resulting in serious injury.
- NEVER fuel the trowelling machine while the engine is running. Ensure the engine has cooled sufficiently before refuelling to avoid igniting gasoline fumes.
- ALWAYS refuel the trowelling machine in a well-ventilated area, away from ignition sources such as sparks, flames, and lit cigarettes. Smoking while fuelling the equipment may result in explosion.
- NEVER operate the trowelling machine in explosive environments such as those where paint fumes, methane, natural gas, fine particulate, aerosol propellant, or solvent fumes are present.
- NEVER smoke near the trowelling machine as stray gasoline fumes may ignite. Operating the trowelling machine around an open flame may also result in explosion.
- ALWAYS shut down the engine and allow it to cool off before lifting or transporting the trowelling machine.



# Operation

## Technique

The easiest direction to pull the trowelling machine is backward. Pulling gently on the handle while holding it with both hands will cause it to float toward you.



**The handle will try to rotate away from you while the engine is running, so hold it firmly to keep it steady.**

If the entire trowel is pulling to the right or left, balance it by lifting up or pressing down on the handle. Do not try to stop the sideways motion of the trowel with direct sideways force, balance it by lifting or pressing down on the handle. Practice holding the trowel steady in one place for a few minutes at a time.

To move sideways it is always best to let the trowel do the work. The rotating blades create a sideways force when the trowel is leaned forward or backward. Lift up on the handle to make the machine go left, or press downward on the handle to make the trowel go to the right. The best way to remember this is "Lift to go Left". Never press or lift with enough force to make the blades edges dig into the concrete.

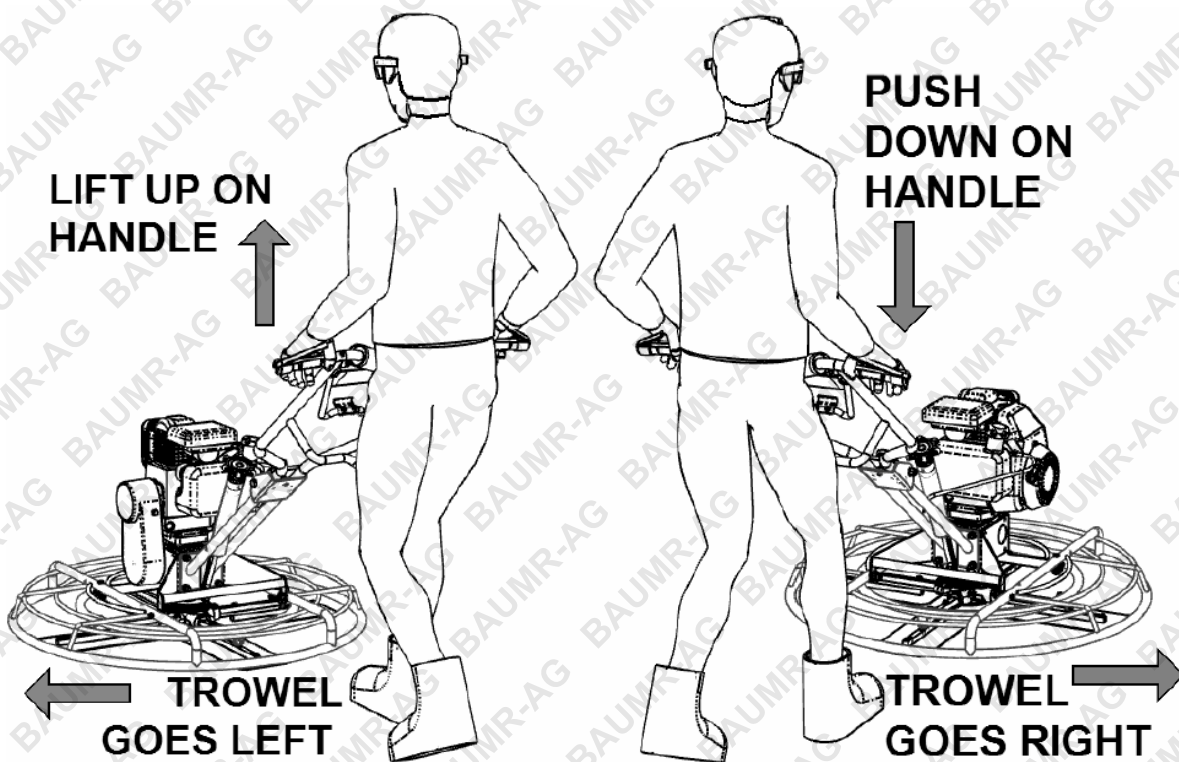

## Trowelling

Trowelling the concrete surface eliminates large aggregates near the surface, levels bumps and depressions, and consolidates the surface to make it stronger. The surface must first be sufficiently cured to support the weight of the trowel. The surface should first be levelled using a float or vibratory screed. To use the standard finish blades, the concrete should be cured enough that the operator does not leave a footprint deeper than about 3mm (1/8 inch).

The ideal way to trowel is to work backward, traveling up and down the slab pulling the trowelling machine towards you and making elongated, overlapping sweeps (see image below).

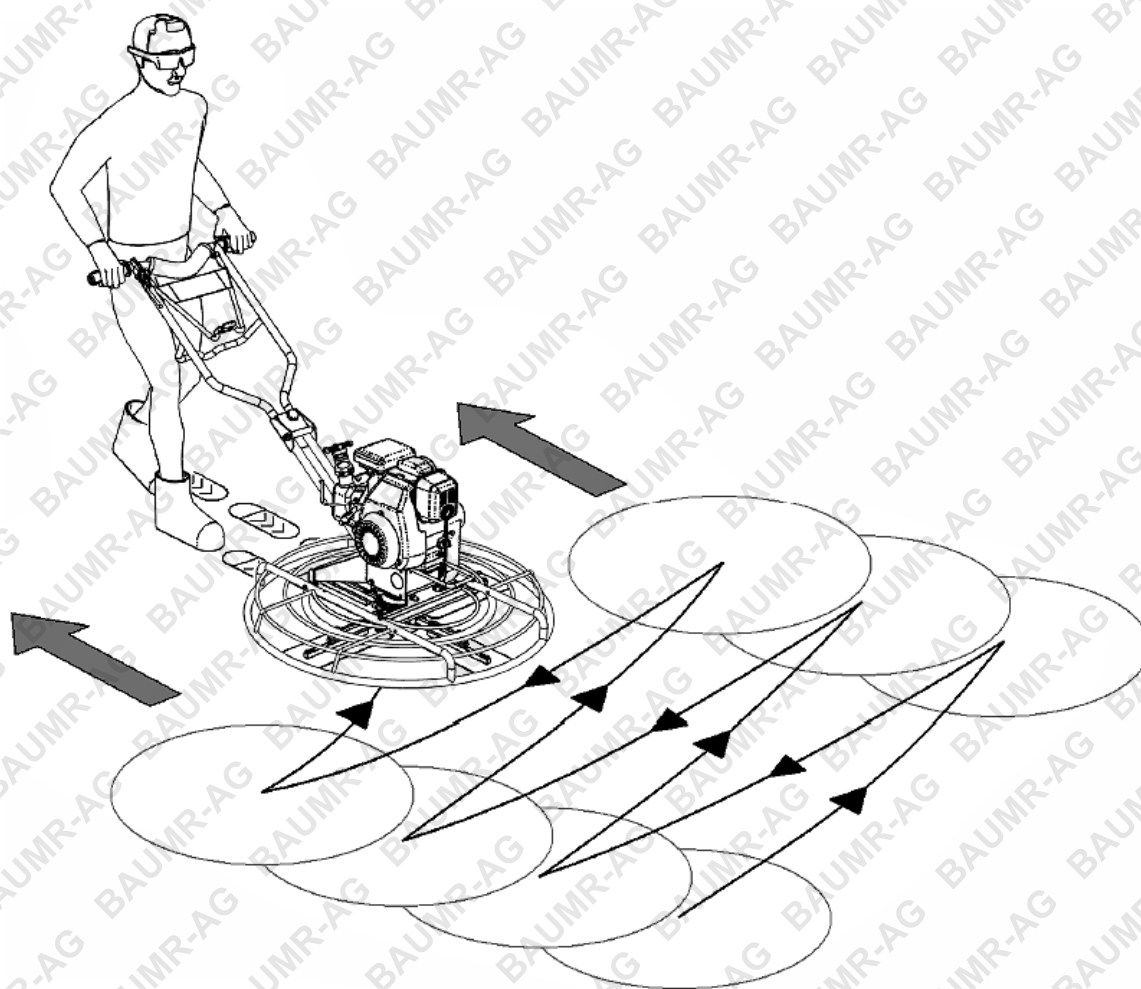
**Ideal trowelling motion**

This allows you to thoroughly cover your footprints in the concrete as you walk. Work steadily and patiently, going too fast will result in poor consolidation and an unattractive finish. Each pass should be made in a perpendicular direction to the previous one (see image on the next page).



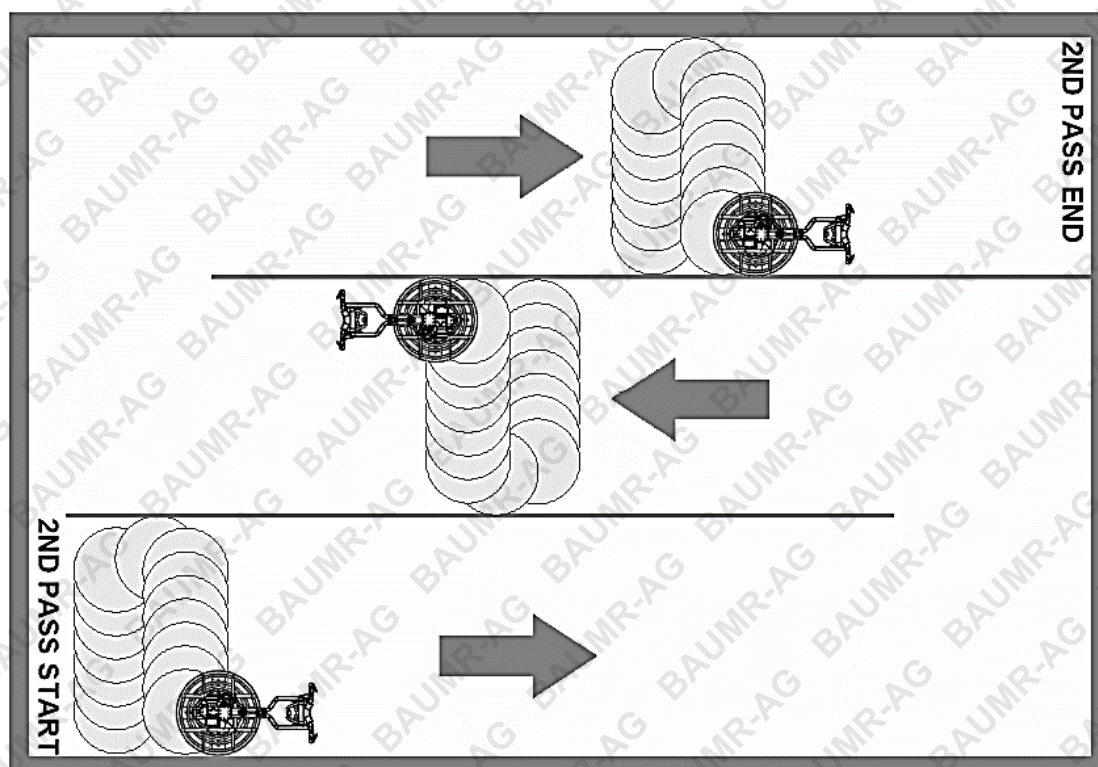
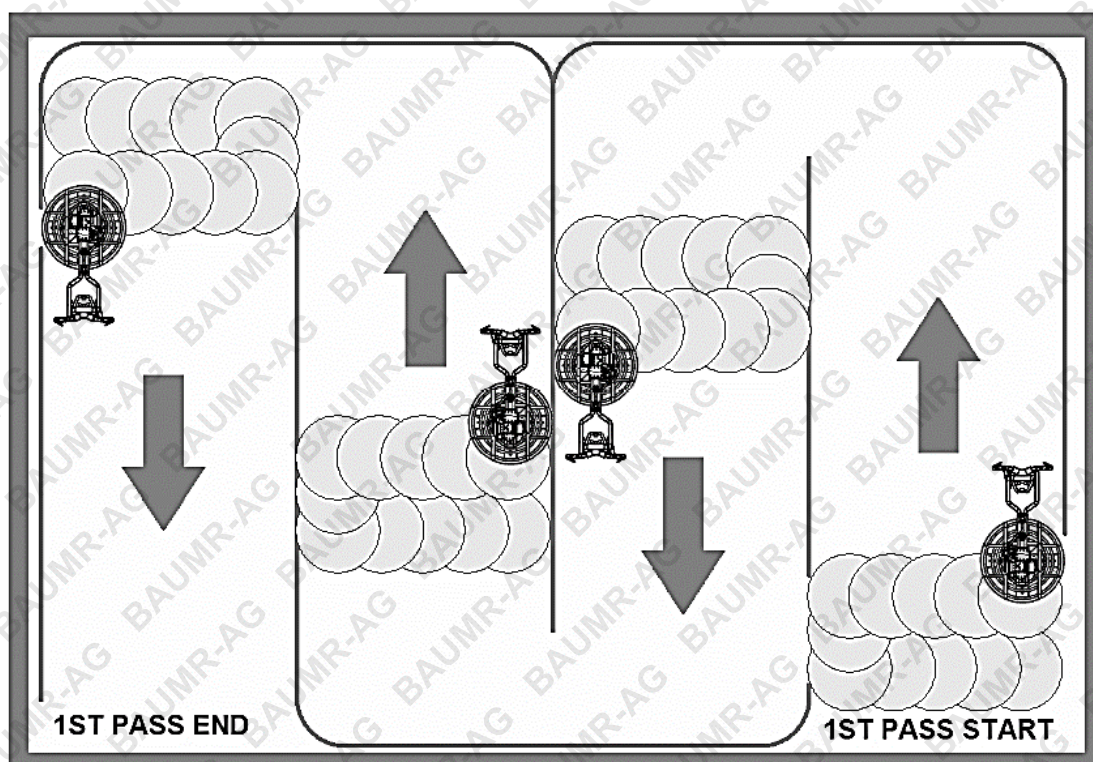

Trowelling pass direction



**ALWAYS** look where you are going. Be aware of any pipes or other protrusions from the concrete to avoid tripping or striking the blades. Striking the blades can bend the trowel arms or damage the drivetrain.

# Quick Start Guide

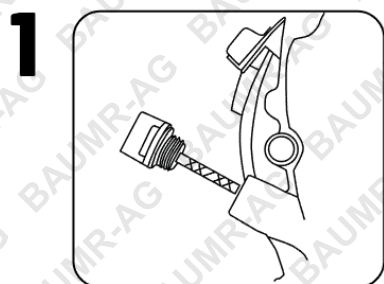

1 Remove oil dipstick (or cap) and ensure enough engine oil (500ml 10W30 recommended)

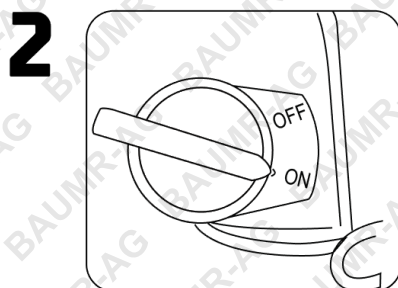

2 Locate ON/OFF switch and turn on

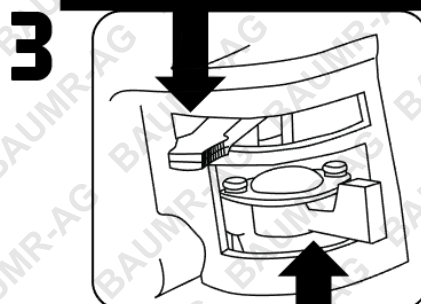

**CHOKE – COLD POSITION**

**FUEL LEVER – ON POSITION**

Turn fuel lever ON and choke to cold

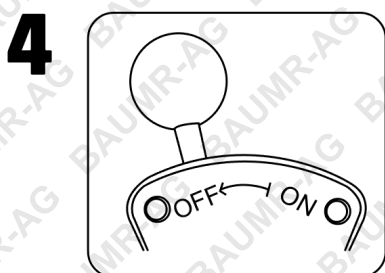

4 Ensure clutch is OFF

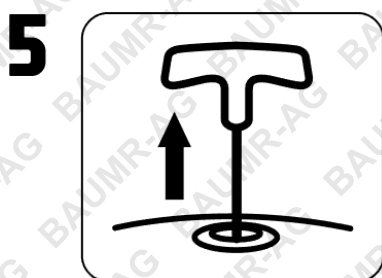

5 Pull starter cord until it kicks (about 3 – 4 times, more if cold weather)

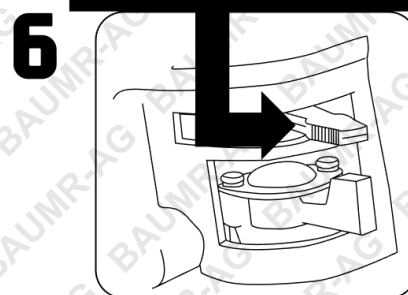

**CHOKE – RUN POSITION**

Turn choke to run

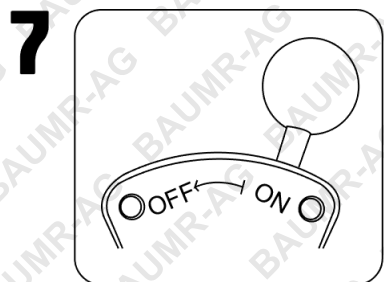

7 Once engine is running, push clutch to ON to turn blades

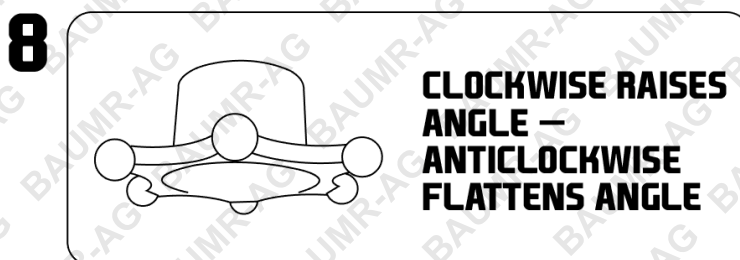

**CLOCKWISE RAISES ANGLE –  
ANTICLOCKWISE  
FLATTENS ANGLE**

Turn handle to adjust blade angle

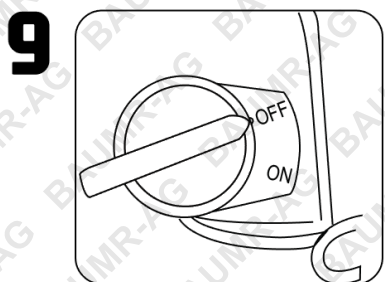

9 When finished, turn clutch off and turn engine off

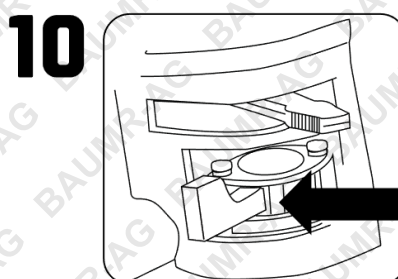

**FUEL LEVER – OFF POSITION**

Turn fuel lever OFF when stored



# Maintenance

## Spark Plug

Clean or replace the spark plug as needed to ensure proper operation.

Refer to the table below for frequency.

The spark plug becomes very hot during operation and remains hot for a while after stopping the engine. Do not touch the spark plug while it is hot.

Note: Refer to the Technical Data for the recommended spark plug type and the electrode gap setting.

- Remove the spark plug and inspect it.
- Replace the spark plug if the insulator is cracked or chipped.
- Clean the spark plug electrodes with a wire brush.
- Set the electrode gap (a) 0.6 – 0.7 mm
- Tighten the spark plug securely.

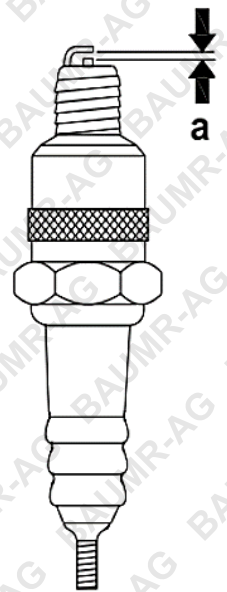

## Air Filter

**NOTE:** NEVER run the engine without the air cleaner. Severe engine damage will occur.

The engine is equipped with a dual-element air cleaner.

Under normal operating conditions, the elements should be cleaned once every week. Under severe, dry and dusty conditions, the elements should be maintained daily. Replace an element when it is saturated with dirt that cannot be removed.

- Remove the air cleaner cover (a). Remove the filter assembly by pulling it straight up. Inspect both elements for holes or tears. Replace damaged elements.
- Wash the foam element (b) in a solution of mild detergent and warm water. Rinse it thoroughly in clean water. Allow the element to dry thoroughly.
- Tap the paper element (c) lightly to remove excess dirt or blow compressed air through the filter from the inside out. Replace the paper element if it appears heavily soiled.

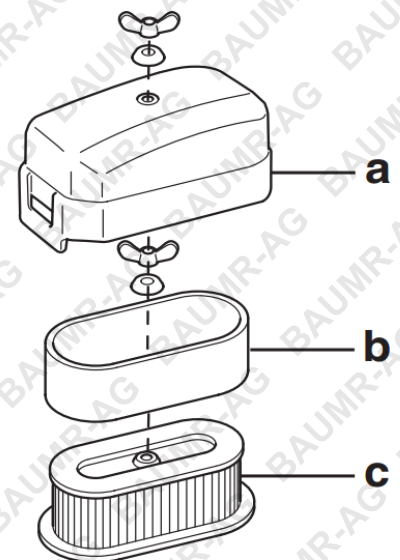

## Oil

Please check oil before every use. To drain the oil, remove the drain plug with a **10mm** socket.

**Be careful! Ensure there is a proper draining bowl for the old oil. Trowelling machine may need to be slightly tilted.**

Once drained, fasten the screw plug back in. Refill with 600ml of 10W30 (recommended) engine oil by removing the dipstick (circled in red) and pouring into cavity.

Check oil by removing dipstick and wiping it clean. Dip it back into its cavity without fully screwing it back in.



- LOW** Needs refilling or more added
- LOW-OK** Enough but will need refilling soon
- OK** Enough

Consider replacing oil if in far right condition.

## Specifications

<b>Weight</b>	100kg
<b>Engine Type</b>	Single-Cylinder, 4-Stroke, Air-Cooled, OHV horizontal shaft Honda GX160
<b>Engine Displacement</b>	163CC
<b>Engine Max. Output</b>	5.5hp/3600rpm
<b>Fuel Type</b>	Regular Unleaded 95+RON
<b>Fuel Tank Capacity</b>	3.6L
<b>Rated Continuous Operation</b>	2-3 hours (Load Dependent)
<b>Oil Type</b>	SAE 10W30
<b>Oil Capacity</b>	0.6L
<b>Noise Level at 7m</b>	74db
<b>Trowel Diameter</b>	915mm/36 inch
<b>Guard Diameter</b>	960mm/38 inch
<b>Number of Blades</b>	4
<b>Speed Range</b>	55-90rpm (optimal-limited)
<b>Pitch Range</b>	0-15 degrees
<b>Gearbox Oil Capacity</b>	1.18L



**Some experts believe that the incorrect or prolonged use of almost any product may cause serious injury or death. To help reduce your risk of serious injury or death, refer to the information below. For more information, see [www.datastreamserver.com/safety](http://www.datastreamserver.com/safety)**

- |   |   |
|---|---|
| <ul style="list-style-type: none"> <li>▪ Consult all documentation, packaging and product labelling before use. Note that some products feature documentation available online. It is recommended to print and retain the documentation.</li> <li>▪ Before each use, check the product for loose/broken/damaged/missing parts, wear or leaks (if applicable). Never use a product with loose/broken/damaged/missing parts, wear or leaks.</li> <li>▪ Products must be inspected and serviced (if applicable) by a qualified technician every 6 months. This is based on average residential use by persons of average size and strength, and on a property of average metropolitan size. Use beyond these recommendations may require more frequent inspections/servicing.</li> <li>▪ Ensure that all users of the product have completed a suitable industry recognised training course before being allowed access to the product.</li> </ul> | <ul style="list-style-type: none"> <li>▪ The product has been supplied by a general merchandise retailer that may not be familiar with your specific application or description of application. Be sure to attain third-party approval from a qualified specialist for your application before use, regardless of any assurances from the retailer or its representatives.</li> <li>▪ This product is not intended for use where fail-safe operation is required. As with any product (for example, automobile, computer, toaster), there is the possibility of technical issues that may require the repair or replacement of parts, or the product itself. If the possibility of such failure and the associated time it may take to rectify could in any way inconvenience the user, business or employee, or financially affect the user, business or employee, then the product is not suitable for your requirements. This product is not intended for use where incorrect operation or a failure of any kind, including but not limited to, a condition requiring product return, replacement, parts replacement or service by a technician may cause financial loss, loss of employee time or an inconvenience requiring compensation.</li> <li>▪ If this product has been purchased in error when considering the information presented here, contact the retailer directly for details of their returns policy, if required.</li> </ul> |
|---|---|

**Bäumr-AG®**  
.com.au

©2018 Baumr-AG. All rights reserved. No part of this document, including descriptive content, concepts, ideas, diagrams or images may be reproduced or transmitted in any form or by any means, electronic or mechanical, including photocopying, scanning or recording, or any information storage and retrieval system, without express permission or consent from the publisher.