

Bäumr-AG®



120L Concrete Mixer

User Manual

[Revision 1.0 September 2017]

READ THIS MANUAL CAREFULLY BEFORE USE – FAILURE TO DO SO MAY RESULT IN INJURY, PROPERTY DAMAGE AND MAY VOID WARRANTY. • KEEP THIS MANUAL FOR FUTURE REFERENCE.

- Products covered by this manual may vary in appearance, assembly, inclusions, specifications, description and packaging.

Safety

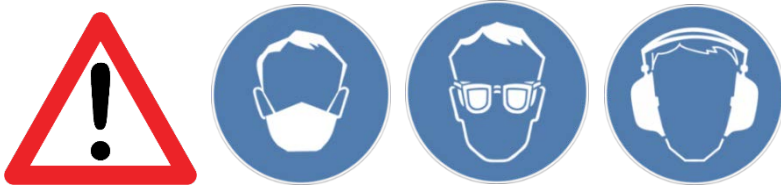

Always wear a dust mask to filter any micro-particles that may spread when opening materials. Wear protective eyewear/goggles to prevent materials hitting or entering eyes. Wear hearing protection.

Understand Your Mixer

Read and understand the owner's manual and labels affixed to the mixer. Learn its application and limitations as well as the specific potential hazards peculiar to it. Become familiar with the controls before operating the equipment.

Be Aware of Surroundings

Do not operate the mixer while under the influence of drugs, alcohol, or medication that could affect your ability to use it properly. Be alert at all times.

Avoid Dangerous Conditions

Make sure the work area is a suitable size. Keep the work area clean and well lit. Keep area around the mixer clear of obstructions, grease, oil, rubbish and other debris. Only use or operate the mixer on solid, flat, level ground that can support the weight of the mixer and its load. Do not attempt to move the mixer when loaded and/or in operation. This mixer is intended for mixing concrete, mortar and plaster – it is not suitable for mixing flammable or explosive substances. Do not use it in areas where fumes from paint, solvents or flammable liquids are present.

Be Aware of Product Limitations

Always use the equipment within its rated capacity. Do NOT start the motor with the drum loaded. Do NOT switch the mixer off while the drum is loaded. Do NOT use the mixer for purposes for which it was not intended. The mixer is not to be towed behind a vehicle.

Maintain Your Mixer

Clean the mixer immediately after use. Keep the mixer clean for best and safest performance. When maintaining the mixer, only the manufacturer's original replacement parts may be used.

Protect the Environment

Take left over materials to an authorized collection point or follow the stipulations in the country where the mixer is used. Do not discharge waste materials into drains, soil or water.

General Safety

- Seek medical advice if you have any medical condition that may be affected by the operation and manual handling of the concrete mixer and/or equipment.
- Ensure that the equipment is suitable for your needs and working environment.
- Ensure that the equipment is assembled and used according to instructions.
- Check controls and any safety devices for proper response.
- Wear appropriate personal protective equipment, and ensure it is compliant with applicable standards.
- Tie back long hair or wear appropriate headwear to prevent hair becoming tangled in moving parts.
- Always operate in a clear hazard free work area.
- Keep all children and animals away from the equipment at ALL times.
- Ensure that you have clear access and egress to the work area whilst on the job.
- Ensure the work environment is well lit with all aspects of the job easily seen and discernible.
- Make sure equipment is operated on level ground.

- Maintain proper footing and balance at all times and avoid damp, wet or slippery surfaces.
- Check tyre pressure (applicable models). Tyres may appear to be sufficiently inflated while empty, but when bowl is full, under-inflated tyres make emptying into a barrow difficult and dangerous.
- Avoid twisting your torso when shovelling material into the bowl (turn with your feet).
- Do not over exert when lifting and transferring material into the bowl.
- Take care to immediately wash off concrete that comes into contact with skin.
- Do NOT operate equipment without safety guards correctly fitted.
- Do NOT operate equipment if under the influence of alcohol or drugs, which may cause loss of concentration
- Do NOT wear loose clothing, neckties, rings, bracelets or other jewellery which may get caught in the moving parts
- Do NOT place tools or hands inside the rotating bowl.
- Do NOT leave the equipment running whilst unattended.
- Do NOT work alone.

Electrical Safety

- Always use earth leakage protection such as a Residual Current Device (RCD).
- Make sure extension leads to electric units are placed clear of water and other conductive or hazardous materials. Keep cord away from heat, oil and sharp edges.
- Ensure that when using extension cords, they are knotted at the connectors (so they do not unexpectedly cut power) and ensure ground lying or hanging cables are well signed.
- Ensure that electrical rating of all equipment is compatible; that is, 10A plugs for 10A outlets etc.
- Ensure that the electric mixer unit is turned "off" at the power supply outlet before disconnecting or connecting cables.
- Do NOT use the unit if the cord and/or extension cord insulation is cut, cracked, worn or damaged.
- Do NOT lock switches in "on" position with tape, wire or by any other means.
- Do NOT attempt to move or lift the unit by the electrical cord, or yank the cord to disconnect it.
- Do NOT operate electric units in rain or wet conditions.

Table of Contents

Safety.....2

Assembly5

Operation7

 Mixing.....7

 Cleaning.....7

Maintenance8

Wiring Diagram.....8

Assembly

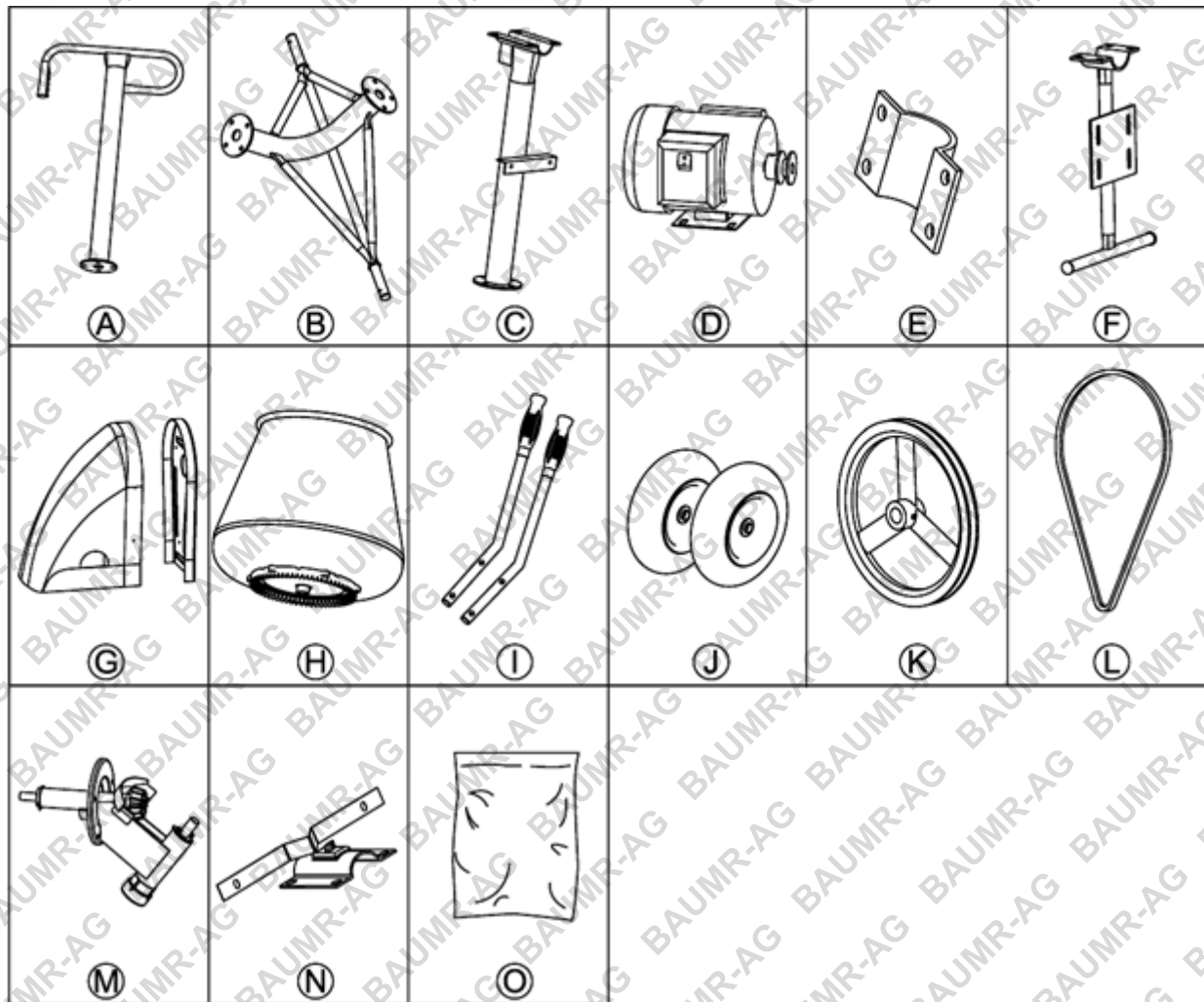

A Main Frame I1 pc
B Main Frame II1 pc
C Main Frame III1 pc
D Motor with Drive Pulley1 set
E Motor Mount Cover1 pc
F Motor Mount1 pc
G Motor Housing1 set
H Drum1 pc
I Tilting Handles1 pair
J Wheel1 pair
K Idle Pulley1 pc
L Belt1 pc
M V Shape Bracket1 pc
N Mounting Cover1 pc
O Loose Part Bag1 pc

Loose Parts

Split Pin (2)
 Wheel Washer (2)
 Self-Tapping Screw (4)
 M6x15 Bolt / Nut / Washers (4)
 M8x20 Bolt / Nut / Washers (4)
 M10x25 Bolt / Nut / Washers (12)
 M10x35 Bolt / Lock Nut / Washer (4)
 M10x45 Bolt / Nut / Washers (4)
 5mm Allen Key

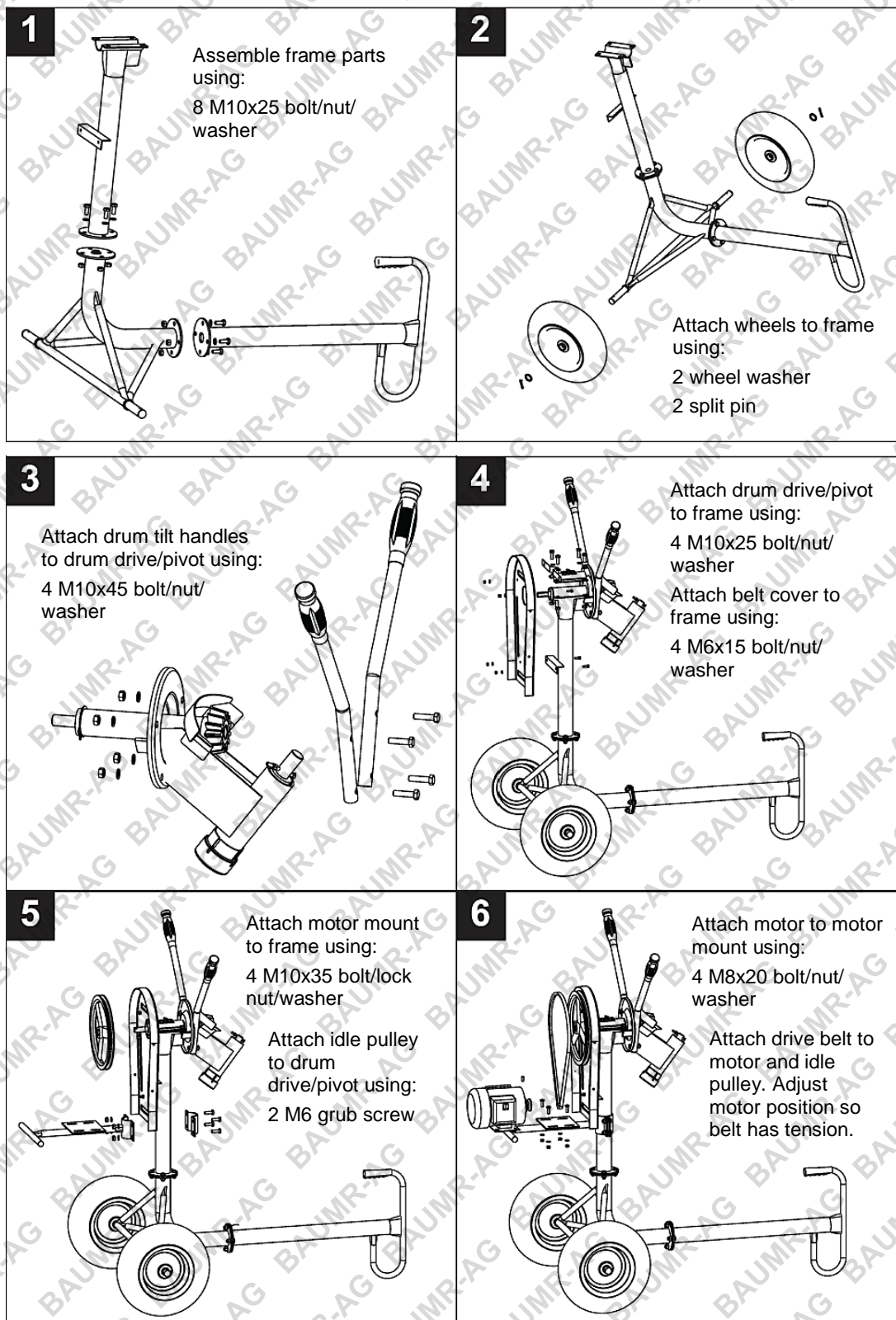

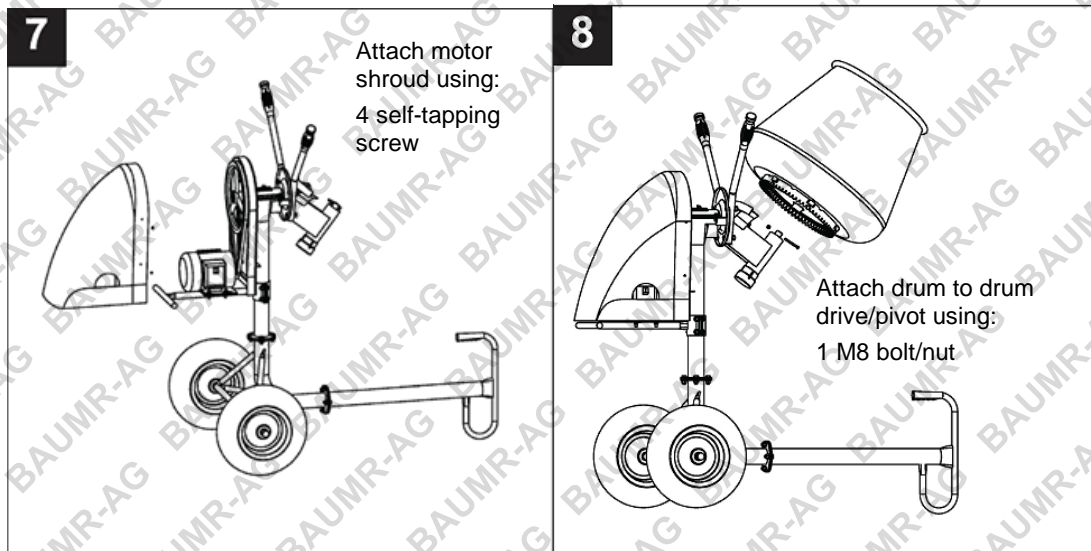

Operation

Mixing



Do NOT overload the machine. • Do NOT load or unload the drum when it is not rotating. • Attempting to start rotating the drum when the drum is loaded can permanently damage the motor.

• **Failure to use the machine within its capacity or to operate the machine as described may permanently damage the machine and will void any warranty.**

Understand the "wet mix" capacity of the concrete mixer. The drum volume is the total amount of water that the drum can hold. Water weighs 1kg per litre. The "wet mix" is the sand, cement, gravel (or pre-mix) and water combined. "Wet mix" weighs approximately 2.5kg per litre. This creates a "wet mix" capacity of 35 to 45% of the drum volume in kg. For example, a 100 litre drum has a maximum capacity of approximately 45kg (45% of 100kg) of "wet mix" (in this case, possibly 2 x 20kg bags of pre-mix concrete and 5 litres of water).

1. Switch the machine ON – the drum MUST be rotating before adding anything to it.
2. Add the required amount of sand, cement and gravel (or pre-mix) into the drum – do this gradually.
3. Add the required amount of water into the drum – do this gradually.
4. When properly mixed, empty the drum – the drum MUST be rotating when it is being emptied.

Cleaning



Never put hands inside the drum while the drum is rotating. • Do not pour or spray water directly over the motor cover, especially the openings in it. • Wipe off any dirt from the motor cover – do NOT use petrol, solvents, dry cleaning fluids or similar products as these may damage some materials.

Thoroughly clean the mixer at the end of each use. The slightest trace of material left in the drum will harden and attract more each time you use it. Dried cement should be scraped out of the drum. Do not throw bricks into mixer drum to clean it out. Do not hit the drum with a shovel, hammer or other tools to break up accumulations of dried cement mix, as damage to the mixer may result. The drum may be scoured for approximate 2 minutes, using 25mm / 1" gravel and water mixture. Then discharge the gravel/water mixture and hose down the drum assembly inside and out. The IP44D protection class construction of the concrete mixer enables you to hose down the drum assembly safely.

Maintenance



Ensure the extension cord is always unplugged before the motor cover is removed. • The wiring diagram in this manual is for reference only. Neither the manufacturer nor distributor makes any representation or warranty of any kind to the buyer that he or she is qualified to make any repairs to the product or that he or she is qualified to replace any parts of the product. Only qualified technicians should repair the mixer. Any maintenance and repairs carried out, to any of the electric components must be undertaken by a qualified electrician. • Circled components should be fitted by qualified electricians only.

The mixer is fitted with a pre-tensioned belt. No adjustment apart from a touch of grease on the spindle. Drum bearings are sealed for life.

Wiring Diagram

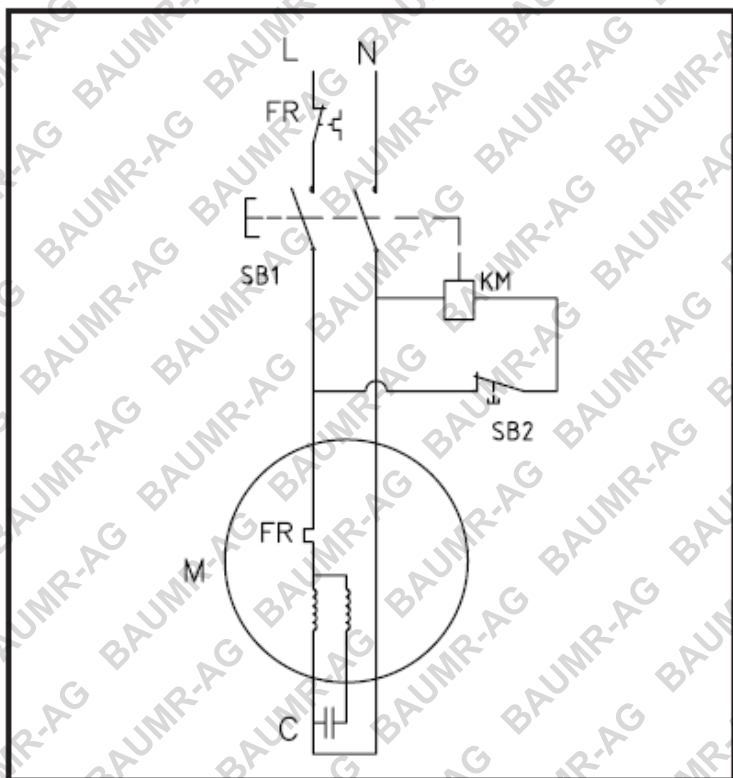



Some experts believe the incorrect or prolonged use of almost any product could cause serious injury or death. For information that may reduce your risk of serious injury or death, consult the points below and additionally, the information available at www.datastreamserver.com/safety

- | | |
|---|--|
| <ul style="list-style-type: none"> • Consult all documentation, packaging and product labelling before use. Note that some products feature online documentation which should be printed and kept with the product. • Check product for loose / broken / damaged / missing parts, wear or leaks (if applicable) before each use. Never use a product with loose / broken / damaged / missing parts, wear or leaks (if applicable). • Products must be inspected and serviced (if applicable) by a qualified specialist every 6 months assuming average residential use by a person of average weight and strength, above average technical aptitude, on a property matching average metropolitan specification. Intended use outside these guidelines could indicate the product is not suitable for intended use or may require more regular inspection or servicing. • Ensure all possible users of the product have completed an industry recognized training course before being given access to the product. | <ul style="list-style-type: none"> • The product has been supplied by a general merchandise retailer that may not be familiar with your specific application or your description of the application. Be sure to attain third-party approval for your application from a qualified specialist before use regardless of prior assurances by the retailer or its representatives. • This product is not intended for use where fail-safe operation is required. As with any product (take an automobile, aircraft, computer or ball point pen for example), there is always a small chance of technical issues that needs to be repaired or may require replacement of the product or a part. If the possibility of such failure and the associated time it takes to rectify could in any situation inconvenience the user, business or employee then the product is not suitable for your requirements. This product is not for use where incorrect operation or a failure of any kind, including but not limited to a condition requiring product return, replacement, service by a technician or replacement of parts could cause a financial loss, loss of employee time or an inconvenience requiring compensation. • If this item has been purchased in error after considering the points above, simply contact the retailer directly for details of their returns policy, if required. |
|---|--|

Bäumr-AG®
.com.au

©2017 Bäumr-AG. All rights reserved. No part of this document, including descriptive content, concepts, ideas, diagrams or images may be reproduced or transmitted in any form or by any means, electronic or mechanical, including photocopying, scanning or recording, or any information storage and retrieval system, without express permission or consent from the publisher.