



EUROGRILLE

# 1500mm Wall Mount Range Hood

## User Manual

[Revision 3.0 February 2020]

---

READ THIS MANUAL CAREFULLY BEFORE USE – FAILURE TO DO SO MAY RESULT IN INJURY, PROPERTY DAMAGE AND MAY VOID WARRANTY. • KEEP THIS MANUAL FOR FUTURE REFERENCE. • Products covered by this manual may vary in appearance, assembly, inclusions, specifications, description and packaging.

---

# Safety

- Before installing and using your range hood, be sure to read this user's manual carefully. It contains general instructions for installation, use and maintenance of the product.
- Installation and maintenance should be performed by qualified persons only, whom are aware of installation regulations.
- Failure to install the range hood properly or without due care may void any warranty.
- Before installing, ensure that the appliance is correctly pre-set for local conditions (voltage and plug type).
- After removing the appliance from its packaging, check for any damage. If damage is found, contact the retailer.
- The packing materials (plastic bags, polystyrene foam, nails, metal strips, etc.) represent choking or suffocation hazards and must be kept away from children.
- Do not attempt to alter the appliance.
- The manufacturer is not responsible for any injuries to persons or animals or property damage that may be caused by the incorrect installation or use of this product.

# Table of Contents

<b>Safety .....</b>	<b>2</b>
<b>Parts Identification.....</b>	<b>4</b>
Included Items.....	4
<b>Installation .....</b>	<b>5</b>
<b>Using the Range Hood .....</b>	<b>9</b>
Setting the Clock .....	9
Using the Fan Timer.....	10
<b>Maintenance .....</b>	<b>10</b>
<b>Specifications.....</b>	<b>10</b>

# Parts Identification



## Included Items

- Exhaust Unit (includes control panel, motors, filters and hood) (1)
- Exhaust Valve (2)
- Flue Cover (1)
- Extension Flue Cover (1)
- Vent Pipe (2)
- Mounting Bracket (1)
- Flue Support Bracket (1)
- Flue Bracket (1)
- M4 x 20 Screw (4)
- M4 x 10 Screw (8)
- #8 Self Tapping Screw / Wall Anchor (12)
- #6 Self Tapping Screw (4)



# Installation



**Ensure that the mounting surface is capable of holding at least 40kg weight.** • The height between the top of the cooktop and the bottom of the range hood should be between 650 and 700mm in order for the range hood to perform effectively. • Ensure that the range hood flue has enough length (470 to 950mm) to reach the ceiling before proceeding with the installation. • Installation requires 2 or more people.

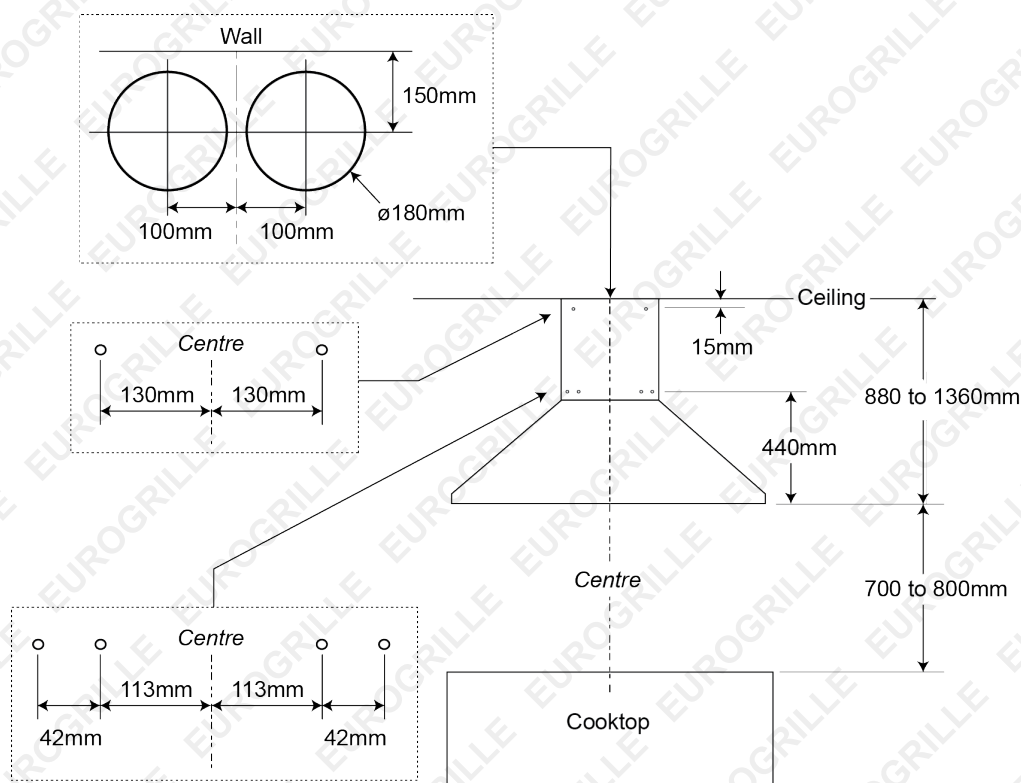

Figure 1

1. Refer to *Figure 1*. Using a pencil or other erasable marker, lightly mark out the vertical centre line of where the range hood is to be installed – this is generally central to the cooktop. Then, mark a horizontal line that is to be where the bottom of the range hood will be. Ensure that the line is level.
2. From the first horizontal line, mark a second horizontal line 440mm (17.5") up - this is for the range hood mounting bracket. At the intersection of the second horizontal line and the centre line, mark out the 4 hole positions for the bracket.
3. Mark a third horizontal line 15mm below the ceiling – this is the for the flue extension mounting bracket. At the intersection of the third horizontal line and the centre line, mark out the 2 hole positions for the bracket.

**Note:** If the wall is gyprock or drywall, and the mounting bracket screws are to screw into the wooden frame behind the wall, make sure that the holes align with the wooden frame, or there is a suitable material behind the wall to accept the screws directly.

4. Refer to *Figure 2*. Drill the range hood mounting bracket (1) holes, then secure the bracket to the wall using 4 mounting screws (2), making sure that the tabs (A) protruding from the bracket are opposite the wall and facing upward – the range hood hooks on to these tabs. Ensure that the bracket is level before tightening the screws – be careful not to over-tighten the screws and strip them or cause the wall plugs to spin.

- If the wall is brick, cement or masonry (B), use the wall plugs (3) – drill 5/16" (approximately 8mm) to a depth of 50mm (2"), then tap the wall plugs into the holes.
- If the screws are to be installed directly to a non-masonry wall or suitable material behind the wall (C), drill a 3mm (1/8") "pilot" hole to a depth of 20mm (3/4") to enable the screw to "dig in" easily.

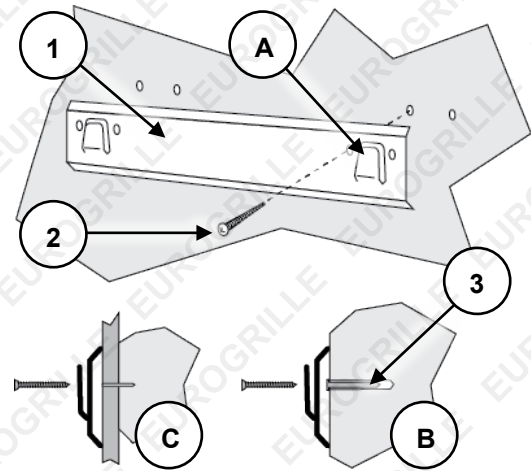

Figure 2

5. Refer to *Figure 3*. Drill the flue extension mounting bracket (4) holes, then secure the bracket to the wall using 2 mounting screws (2), making sure that the tabs with the screw holes (D) are up against the ceiling – the flue extension screws to these tabs. Tighten the screws – be careful not to over-tighten the screws and strip them or cause the wall plugs to spin.

- If the wall is brick, cement or masonry (E), use the wall plugs (3) – drill 5/16" (approximately 8mm) to a depth of 50mm (2"), then tap the wall plugs into the holes.
- If the screws are to be installed directly to a non-masonry wall or suitable material behind the wall (F), drill a 3mm (1/8") "pilot" hole to a depth of 20mm (3/4") to enable the screw to "dig in" easily.

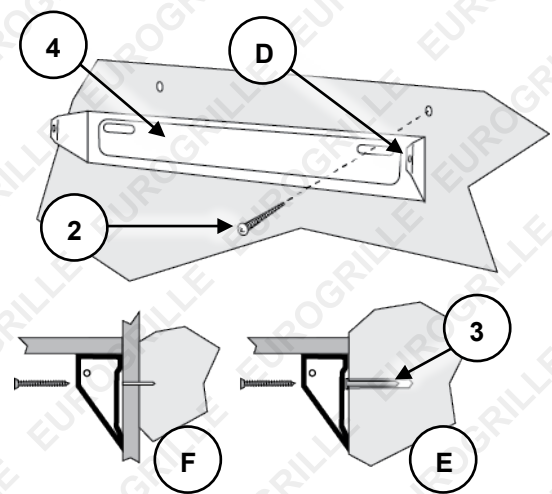

Figure 3

6. Refer to *Figure 1*. Make 2 180mm diameter holes for the vent pipes in the ceiling at approximately 150mm out from the wall and 100mm either side of the range hood centre-line. The hole positions are not critical as long as they will be fully shrouded by the flue (flue dimensions are approximately 420mm wide and 300mm deep). The vent holes can also be made in the wall instead of the ceiling.
7. Refer to *Figure 4*. Remove the 4 screws holding each rubber exhaust seal in position on the exhaust unit (4). Place the exhaust valves (5) in position over the seals and secure them using the removed screws.

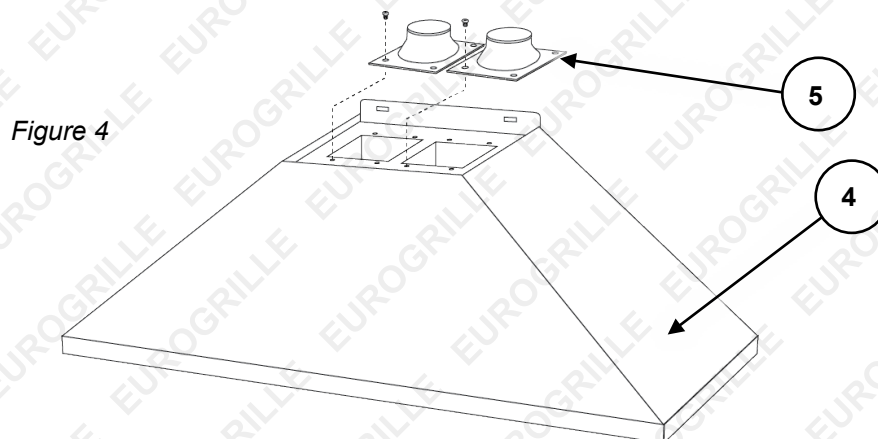
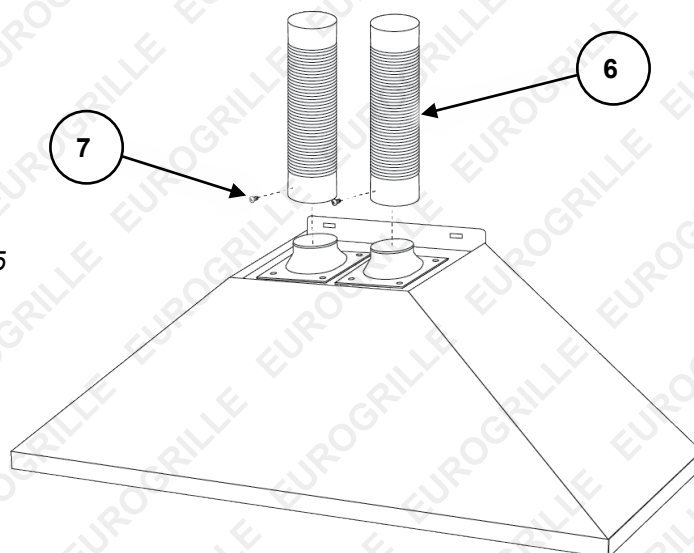

Figure 4

8. Refer to *Figure 5*. Place the end of the vent pipes (6) over the exhaust valves and secure them with 4 #6 self-tapping screws (7).

Figure 5



9. Refer to *Figure 6*. Lower the flue cover (8) on to the top of the exhaust unit so it is sitting in the recess at the top of the exhaust unit, then secure it from the rear using 2 M4x10 screws (9).
10. Gently lower the flue extension (10) into the flue cover. If you are not using the flue extension, install the flue support bracket (11) on the inside of the flue cover and secure it from rear using 2 M4x10 screws (9) (if the flue support bracket is installed, it may not be possible to slide the flue extension upwards).

Figure 6

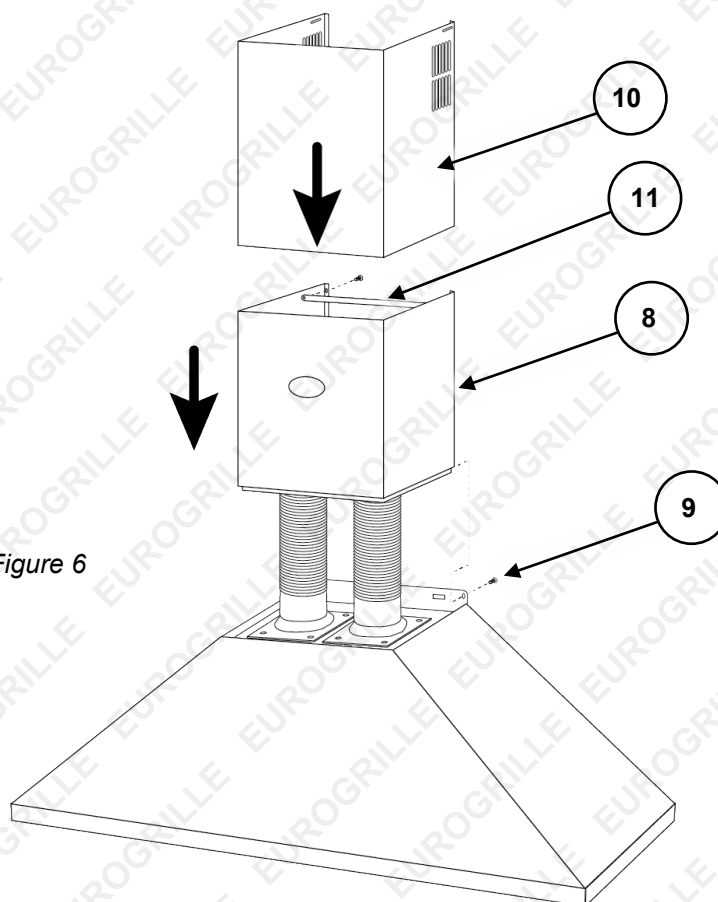

11. Refer to *Figure 7*. Bring the range hood up to the mounting bracket and carefully hook the slots on the rear of the range hood over the mounting brackets tabs, then allow the range hood to rest against the wall.

12. Extend the vent pipes up and through the holes in the ceiling or wall. Once in the ceiling or through the wall, connect the vent pipe to a suitable vent tube, and pass the range hood power cord up through the vent pipe hole.

Figure 7

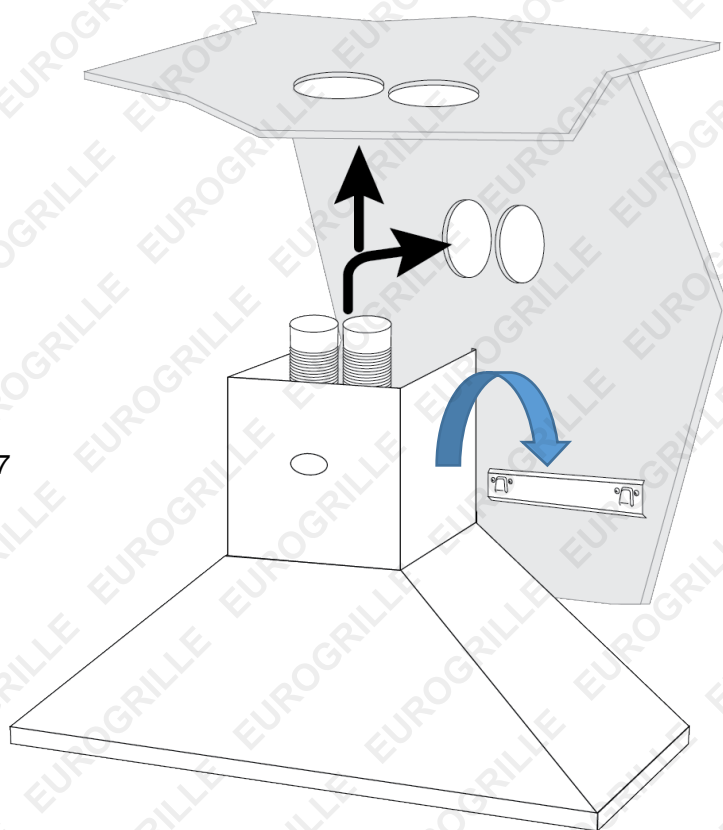

13. Refer to *Figure 8*. Gently pull the flue extension (10) up from inside the range hood flue (8) until it reaches the ceiling. Secure it to the flue extension mounting bracket using 2 M4 x 20 screws (12).

Figure 8

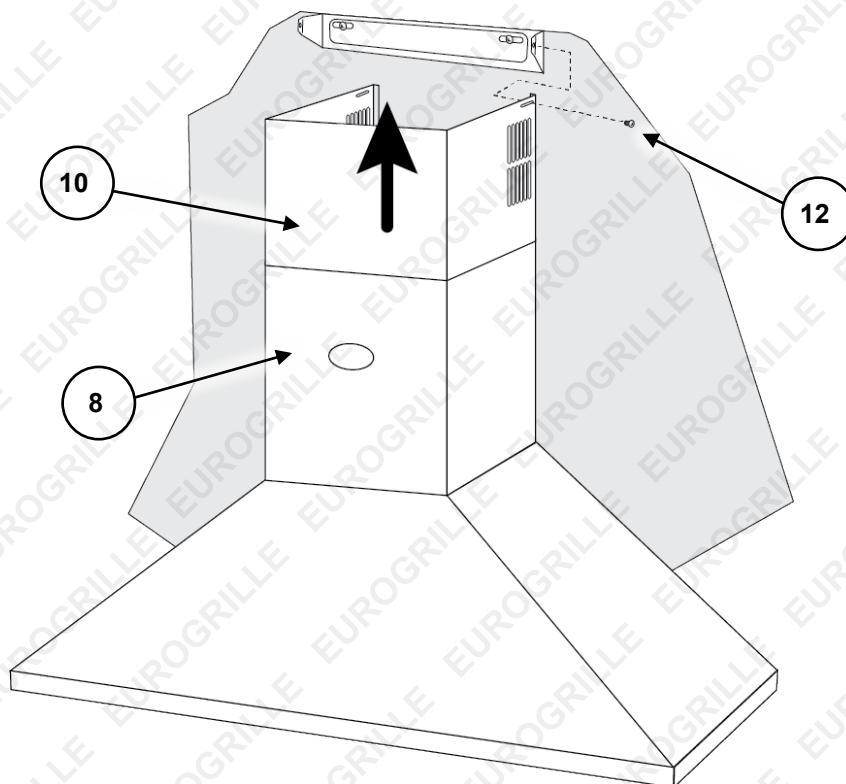

14. Connect the range hood to an electrical supply. It is now ready for use.









# Using the Range Hood

Once the range hood is correctly installed and connected to the electrical supply, it may be used. For appliances equipped with remote control, the remote control has similar function buttons. Basic function are:

- **Air Extraction** – Remove cooking odours and steam etc by activating the exhaust fan. Three speeds are available.
- **Lighting** – Illuminate the cooking area.
- **Additional Features** – The range hood features a clock and fan auto-off timer functions (described below).



Control	Description
<b>LCD Display</b>	Shows current range hood functions, such as time, fan speed, fan timer etc.
	<b>ON / OFF</b> – Press to switch the range hood ON, and activate the display. If the clock has been set, the time will display. Press again to switch OFF and cancel any function.
	<b>Lights</b> - Switch the range hood lights on and off. Lights can be operated independently of any other function.
	<b>Slow</b> - Activate low speed exhaust fan operation.
	<b>Medium</b> - Activate medium speed exhaust fan operation. When setting the clock, press to increment minutes. When setting the fan timer, press to reduce the time.
	<b>Fast</b> - Activate fast speed exhaust fan operation. When setting the clock, press to increment hours. When setting the fan timer, press to increase the time.
	<b>Timer</b> - Activate exhaust fan timer operation. When the range hood is OFF, press to activate clock setting functions (described below).

## Setting the Clock

The range hood has a clock. The time shows when the range hood is "on" [that is, the **ON / OFF** button has been pressed to activate the display].

1. Ensure the range hood is OFF [the display is not illuminated but can still be seen].
2. Press the **Timer** button – the range hood enters clock setting mode and the hour part of the time flashes.
3. Set the hour by pressing the **Slow** fan speed button to decrease the value, or **Medium** fan speed to increase the value.
4. Press the **Timer** button – the minutes part of the time flashes – set the value using the **Slow** and **Medium** fan speed buttons.
5. Press the **Timer** button to save the setting and exit clock setting mode.

## Using the Fan Timer

The range hood has a timer function that will automatically stop the fan after 3 minutes.

1. Switch the range hood ON [the display illuminates].
2. Press the required fan speed button (**Fast**, **Medium** or **Slow**).
3. Press the **Timer** button to activate the timer mode – the timer defaults to 3 minutes and begins flashing.
4. The fan will run until the timer reaches "zero".

## Maintenance

**NOTE:** The LED lamps are designed and made from components that last many thousands of hours use. As a result, the lamps are not designed to be replaced.

- Clean all surfaces with suitable household cleaners and a soft, damp cloth. Avoid abrasives and solvents and flammable substances.
- Clean the filters regularly. Remove the filter, soak it in warm water and mild detergent. Use a soft brush to clean it.
- Empty and clean the oil catcher regularly. To access it, remove the filters.
- Do not directly splash the range hood with water.
- If the product malfunctions, contact an authorised service centre.

## Specifications

Electrical	240VAC / 50Hz
Vent Tube Diameter	160mm
Lamps	4 x 1.5W LED
Fan Speeds	3
Filters	Aluminium, multi-layer
Vent Tube Length	1.5m
Power Cord Length	1.1m



**Some experts believe the incorrect or prolonged use of almost any product could cause serious injury or death. For information that may reduce your risk of serious injury or death, consult the points below and additionally, the information available at [www.datastreamserver.com/safety](http://www.datastreamserver.com/safety)**

- Consult all documentation, packaging and product labelling before use. Note that some products feature online documentation which should be printed and kept with the product.
- Check product for loose / broken / damaged / missing parts, wear or leaks (if applicable) before each use. Never use a product with loose / broken / damaged / missing parts, wear or leaks (if applicable).
- Products must be inspected and serviced (if applicable) by a qualified specialist every 6 months assuming average residential use by a person of average weight and strength, above average technical aptitude, on a property matching average metropolitan specification. Intended use outside these guidelines could indicate the product is not suitable for intended use or may require more regular inspection or servicing.
- Ensure all possible users of the product have completed an industry recognized training course before being given access to the product.
- The product has been supplied by a general merchandise retailer that may not be familiar with your specific application or your description of the application. Be sure to attain third-party approval for your application from a qualified specialist before use regardless of prior assurances by the retailer or its representatives.
- This product is not intended for use where fail-safe operation is required. As with any product (take an automobile, aircraft, computer or ball point pen for example), there is always a small chance of technical issues that needs to be repaired or may require replacement of the product or a part. If the possibility of such failure and the associated time it takes to rectify could in any situation inconvenience the user, business or employee then the product is not suitable for your requirements. This product is not for use where incorrect operation or a failure of any kind, including but not limited to a condition requiring product return, replacement, service by a technician or replacement of parts could cause a financial loss, loss of employee time or an inconvenience requiring compensation.
- If this item has been purchased in error after considering the points above, simply contact the retailer directly for details of their returns policy, if required.

