



1000mm Island Style Range Hood

User Manual

[Revision 4.0 October 2018]

READ THIS MANUAL CAREFULLY BEFORE USE – FAILURE TO DO SO MAY RESULT IN INJURY, PROPERTY DAMAGE AND MAY VOID WARRANTY. • KEEP THIS MANUAL FOR FUTURE REFERENCE. • Products covered by this manual may vary in appearance, assembly, inclusions, specifications, description and packaging.

Safety

- Before installing and using your range hood, be sure to read this user's manual carefully. It contains general instructions for installation, use and maintenance of the product.
- Installation and maintenance should be performed by qualified persons only, whom are aware of installation regulations.
- Failure to install the range hood properly or without due care may void any warranty.
- Before installing, ensure that the appliance is correctly pre-set for local conditions (voltage and plug type).
- After removing the appliance from its packaging, check for any damage. If damage is found, contact the retailer.
- The packing materials (plastic bags, polystyrene foam, nails, metal strips, etc.) represent choking or suffocation hazards and must be kept away from children.
- Do not attempt to alter the appliance.
- The manufacturer is not responsible for any injuries to persons or animals or property damage that may be caused by the incorrect installation or use of this product.

Table of Contents

Safety	2
Table of Contents	3
Parts Identification	4
Included Items	4
Installation	5
Using the Range Hood	8
Setting the Clock	8
Using the Fan Timer	9
Maintenance	9
Specifications	9

Parts Identification



Included Items

- Exhaust Unit (includes control panel, motor, filters and hood) (1)
- Remote Control Unit (1)
- Exhaust Valve (1)
- Mounting Rail (2)
- Flue Cover (2)
- Extension Flue Cover (2)
- Vent Pipe (1)
- Ceiling Mounting Bracket (1)
- Flue Support Bracket (1)
- Long Hanging Bracket (4)
- Short Hanging Bracket (4)
- M8 x 50 Bolt (4)
- M8 Flat Washer (4)
- M8 Lock Washer (4)
- M8 Nut (4)
- M5 x 12 Screw (4)
- M5 x 8 Screw (16)
- #8 Self Tapping Screw (12)
- #6 Self Tapping Screw (2)

Installation



Ensure that the ceiling is capable of taking at least 35kg weight. • The height between the top of the cooktop and the bottom of the range hood should be between 650 and 700mm in order for the range hood to perform effectively. • Ensure that the range hood flue has enough length (640 to 1160mm) to reach the ceiling before proceeding with the installation.

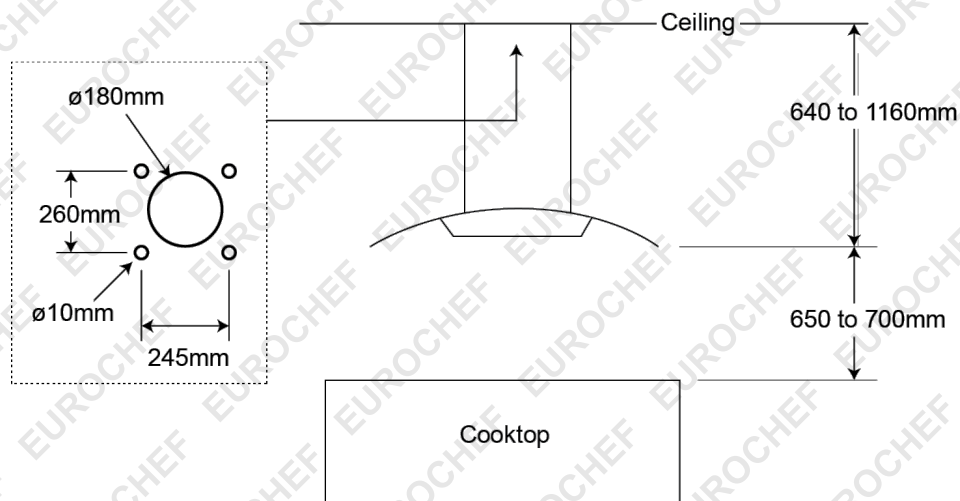

Figure 1

1. Drill 4 10mm diameter holes in the ceiling in a "rectangular" pattern, with holes 245mm apart along the front of the range hood, and 260mm apart along the side. Ensure the centre of the hole pattern is aligned to the centre of the cooktop (refer to *Figure 1*).
2. Make a hole in the ceiling at the centre of the mounting hole pattern that is large enough to allow the vent pipe to pass through it (approximately 180mm).
3. Refer to *Figure 2*. Remove the 4 screws holding the rubber exhaust seal in position on the exhaust unit (1). Place the exhaust valve (5) in position over the seal and secure it using the removed screws.
4. Refer to *Figure 2*. Attach the 4 short hanging brackets (2) to the top of the exhaust unit (1) using 8 M5x8 screws (3).
5. Refer to *Figure 2*. Attach the flue support bracket (4) to the top of the short hanging brackets using 4 M5x8 screws. The flue support bracket sits on the inside of the hanging brackets.

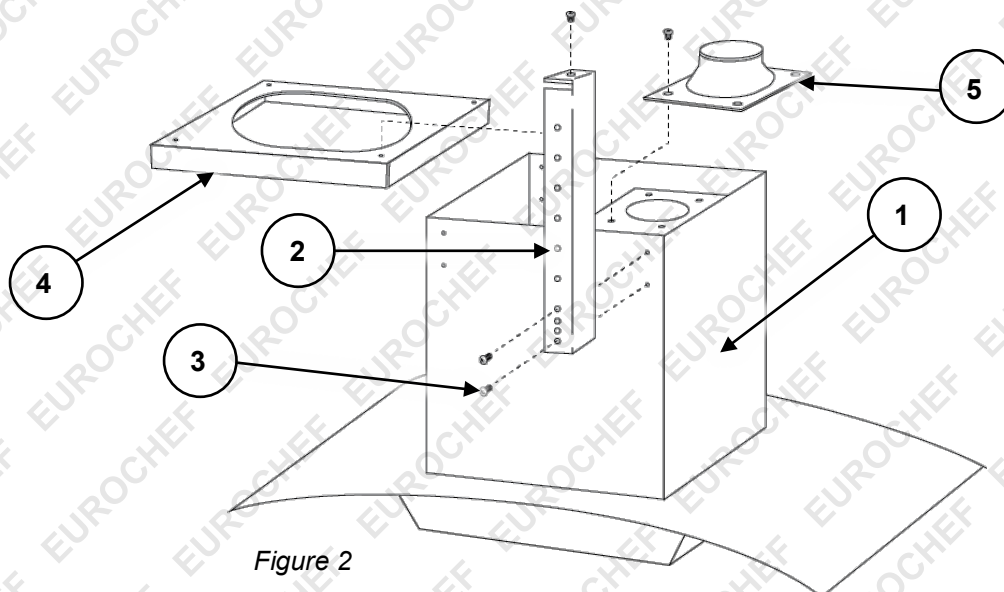

Figure 2

6. Refer to *Figure 3*. Attach the 4 long hanging brackets (6) to the hanging brackets assembled in step 5 using 4 M5x12 screws (7) and nuts (8). Position the long hanging brackets so that the overall length of the flue provides the correct distance between the cooktop and range hood.
7. Attach the ceiling mounting bracket (9) to the top of the long hanging brackets using 4 M5x8 screws (3). The ceiling mounting bracket sits on the inside of the hanging brackets.
8. Refer to *Figure 4*. Attach the partly assembled range hood to the ceiling. Use the supplied mounting rails (10) or some other method that is capable of holding at least 35kg in weight. If using the mounting rails, drill 2 8mm holes for the mounting bolts, then place the range hood up against the ceiling and secure it with 4 M8x50 bolts (11), flat washers (12), lock washers (13) and nuts (14).

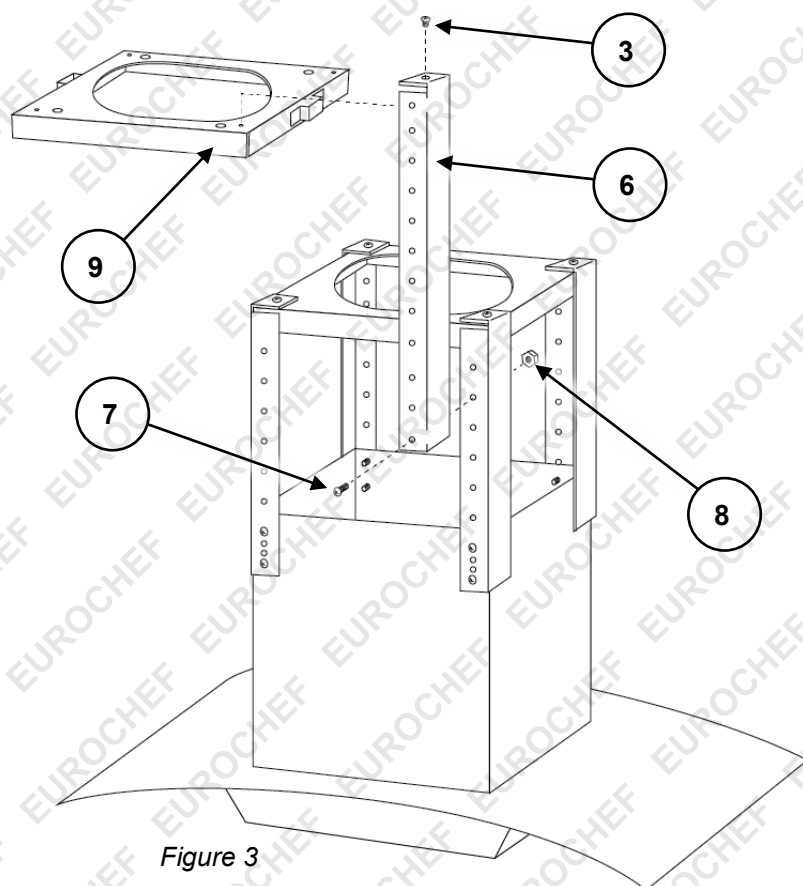

Figure 3

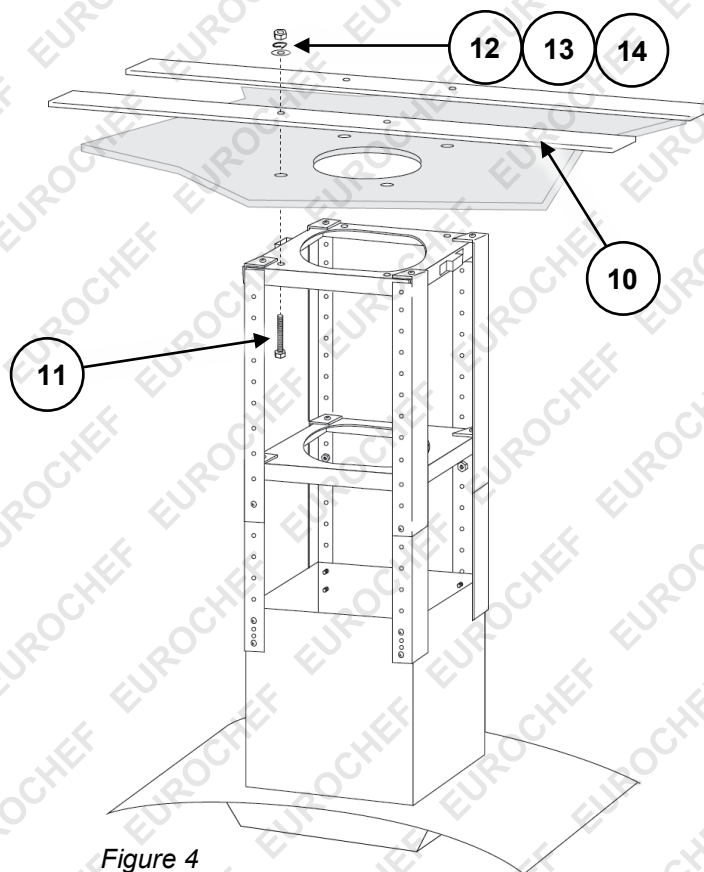

Figure 4

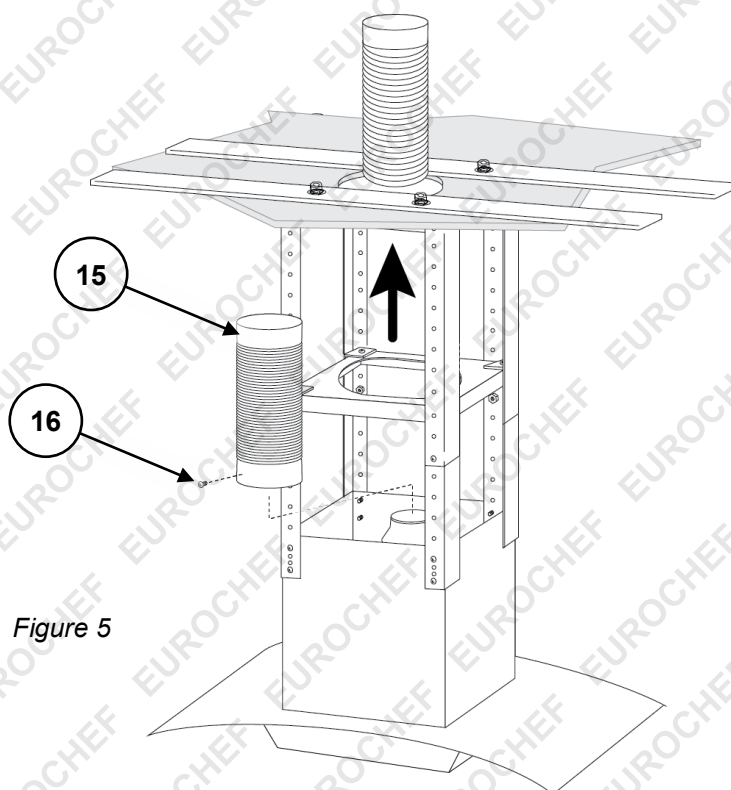

Figure 5

9. Refer to *Figure 5*. Place the end of the vent pipe (15) over the exhaust valve and secure with 2 #6 self tapping screws (16). Then, extend the vent pipe up and through the hole in the ceiling. Once in the ceiling, connect the vent pipe to a suitable vent tube, and pass the range hood power cord up through the ceiling hole.



When installing the flue covers, take great care to ensure that the internal range hood wiring is not pinched or cut into by the flue covers when they are being installed.

10. Refer to *Figure 6*. Place the flue extension cover pieces (18) inside the flue cover pieces (17) – these are left loose so they can be pulled up and into position later.
11. Install the flue cover (17) by placing each piece on either side of the flue frame. The bottom edges of the flue cover fit into the space around the hood of the exhaust unit. Screw the flue cover pieces to the flue support bracket using 4 #8 self-tapping screws (19).
12. Gently pull the extension flue cover pieces up from the flue cover until they reach the ceiling. Secure them to the ceiling mounting bracket using 4 #8 self tapping screws (19).
13. Connect the range hood to an electrical supply. It is now ready for use.

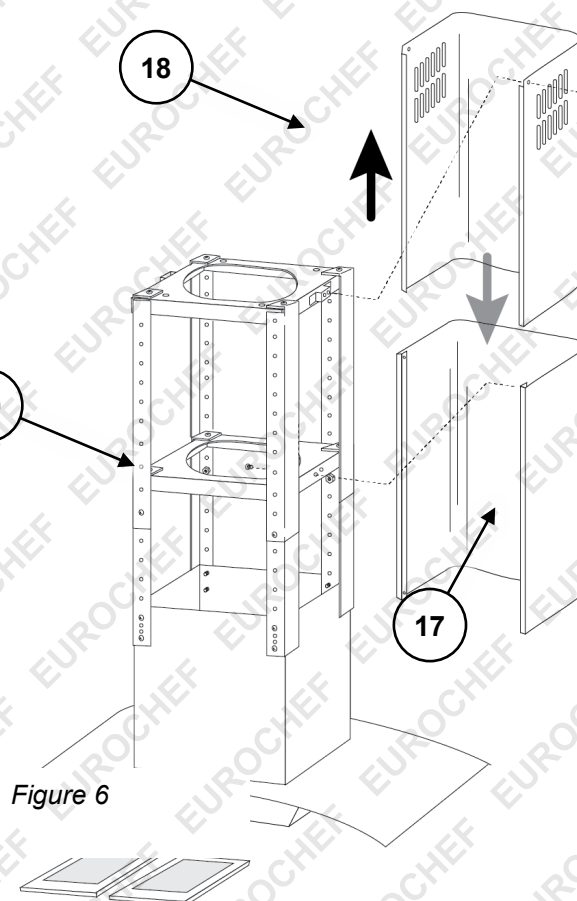







Figure 6

Using the Range Hood

Once the range hood is correctly installed and connected to the electrical supply, it may be used. For appliances equipped with remote control, the remote control has similar function buttons. Basic function are:

- **Air Extraction** – Remove cooking odours and steam etc by activating the exhaust fan. Three speeds are available.
- **Lighting** – Illuminate the cooking area.
- **Additional Features** – The range hood features a clock and fan auto-off timer functions (described below).



Control	Description
LCD Display	Shows current range hood functions, such as time, fan speed, fan timer etc.
	Display – press to activate the display. If the clock has been set, the time will display. Press and hold to activate timer and clock setting functions (described below).
	Lights - Switch the range hood lights on and off. Lights can be operated independently of any other function.
	Slow - Activate low speed exhaust fan operation.
	Medium - Activate medium speed exhaust fan operation. When setting the clock, press to increment minutes. When setting the fan timer, press to reduce the time.
	Fast - Activate fast speed exhaust fan operation. When setting the clock, press to increment hours. When setting the fan timer, press to increase the time.
	Not used.

Setting the Clock

The range hood has a clock. The time shows when the display is “on” [that is, the **Display** button has been pressed to activate the display].

1. Press the **Display** button – the display activates.
2. Press and hold the **Display** button until the display begins flashing, then release the button.
3. Set the hour by pressing the **Fast** fan speed button.
4. Set the minute by pressing the **Medium** fan speed button.
5. Press the **Power** button.

Using the Fan Timer

The range hood has a timer function that will automatically stop the fan after a set time. The timer range is 1 to 15 minutes.

1. Press the **Display** button – the display activates.
2. Press the required fan speed button (**Fast**, **Medium** or **Slow**).
3. Press the **Display** button to activate the timer mode – the timer defaults to 3 minutes and begins flashing.
4. Increase the timer length by pressing the **Fast** fan speed button.
5. Decrease the timer length by pressing the **Medium** fan speed button.
6. Once you have set the timer, the fan will run until it reaches “zero”.

Maintenance

- Clean all surfaces with suitable household cleaners and a soft, damp cloth. Avoid abrasives and solvents and flammable substances.
- Clean the filters regularly. Remove the filter, soak it in warm water and mild detergent. Use a soft brush to clean it.
- Empty and clean the oil catcher regularly. To access it, remove the filters.
- To replace a lamp [**Note:** Use genuine replacement lamps only.]:
 - a. Rotate the lamp slowly until the "legs" of the lamp assembly align with the slots in the range hood, then lower the lamp and carefully disconnect its wiring loom from the range hood wiring.
 - b. Connect the wiring loom of the replacement lamp to the range hood wiring (the connectors will fit one way only). Align the "legs" of the lamp assembly with the slots in the range hood and insert the lamp, then rotate it so the legs are away from the slots and holding the lamp in position.
- Do not directly splash the range hood with water.
- If the product malfunctions, contact an authorised service centre.

Specifications

Electrical	240VAC / 50Hz
Vent Tube Diameter	160mm
Fan Speeds	3
Filters	Aluminium, multi-layer
Vent Tube Length	1.5m
Power Cord Length	1.4m



Some experts believe the incorrect or prolonged use of almost any product could cause serious injury or death. For information that may reduce your risk of serious injury or death, consult the points below and additionally, the information available at www.datastreamserver.com/safety

- Consult all documentation, packaging and product labelling before use. Note that some products feature online documentation which should be printed and kept with the product.
- Check product for loose / broken / damaged / missing parts, wear or leaks (if applicable) before each use. Never use a product with loose / broken / damaged / missing parts, wear or leaks (if applicable).
- Products must be inspected and serviced (if applicable) by a qualified specialist every 6 months assuming average residential use by a person of average weight and strength, above average technical aptitude, on a property matching average metropolitan specification. Intended use outside these guidelines could indicate the product is not suitable for intended use or may require more regular inspection or servicing.
- Ensure all possible users of the product have completed an industry recognized training course before being given access to the product.
- The product has been supplied by a general merchandise retailer that may not be familiar with your specific application or your description of the application. Be sure to attain third-party approval for your application from a qualified specialist before use regardless of prior assurances by the retailer or its representatives.
- This product is not intended for use where fail-safe operation is required. As with any product (take an automobile, aircraft, computer or ball point pen for example), there is always a small chance of technical issues that needs to be repaired or may require replacement of the product or a part. If the possibility of such failure and the associated time it takes to rectify could in any situation inconvenience the user, business or employee then the product is not suitable for your requirements. This product is not for use where incorrect operation or a failure of any kind, including but not limited to a condition requiring product return, replacement, service by a technician or replacement of parts could cause a financial loss, loss of employee time or an inconvenience requiring compensation.
- If this item has been purchased in error after considering the points above, simply contact the retailer directly for details of their returns policy, if required.



©2018 Eurochef. All rights reserved. No part of this document, including descriptive content, concepts, ideas, diagrams or images may be reproduced or transmitted in any form or by any means, electronic or mechanical, including photocopying, scanning or recording, or any information storage and retrieval system, without express permission or consent from the publisher.