

## Portable Stainless Steel Folding BBQ Grill User Manual

[Revision 2.0 July 2018]

---

READ THIS MANUAL CAREFULLY BEFORE USE – FAILURE TO DO SO MAY RESULT IN INJURY, PROPERTY DAMAGE AND MAY VOID WARRANTY. • KEEP THIS MANUAL FOR FUTURE REFERENCE. • Products covered by this manual may vary in appearance, assembly, inclusions, specifications, description and packaging.

---

## Safety

- DO NOT use near flammable objects.
- DO NOT allow flammable liquids to contact the grill when it is hot.
- DO NOT leave a lit grill unsupervised.
- The grill is for outdoor use only.
- Clean the grill before each use.
- Use the grill on a flat, level surface.
- Use charcoal fires only.
- After use, ensure all fire debris/hot material is extinguished.
- Ensure that the grill is cool and all fire debris is removed before packing and storing.
- Use appropriate gloves and utensils when using the grill.
- Do not allow pets or children near a lit grill.
- Do not move a lit grill.
- Always have water nearby for emergency use.

## Included Items

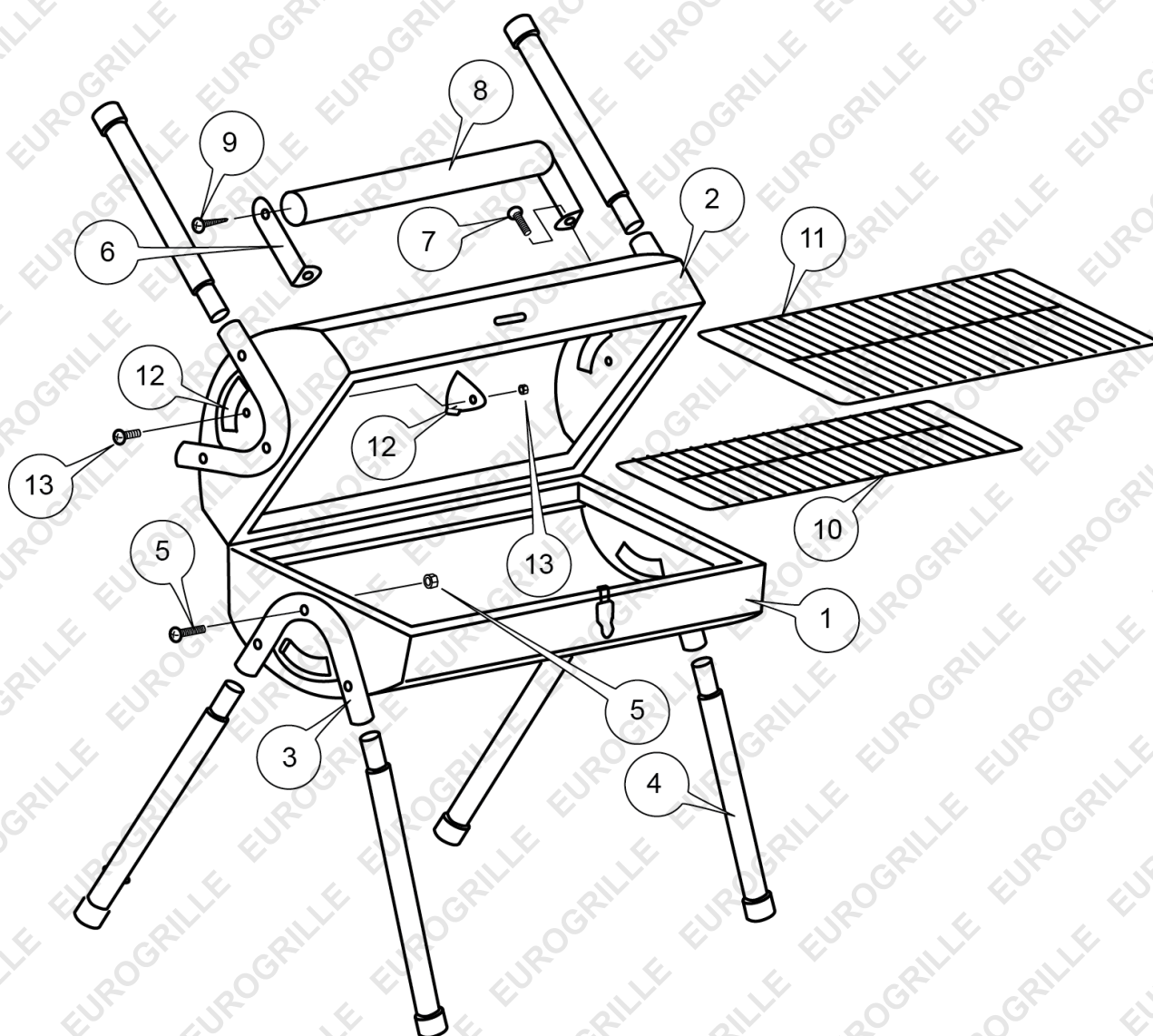

No.	Name	Qty.
1	Lower Grill Body	1
2	Grill Cover/Secondary Grill Body	1
3	Leg Mount	4
4	Grill Leg	6
5	M5x30 Screw/Nut	12
6	Handle Bracket	2
13	M3x10 Screw/Nut	4

No.	Name	Qty.
7	M5x8 Screw/Nut	2
8	Handle	1
9	Wood Screw	2
10	Lower Grill	2
11	Upper Grill	2
12	Ventilation Control	2

## Assembly

1. Attach the handle brackets (6) to the handle (8) with screws (9).
2. Mount the handle assembly to the grill cover (2) with screws/nuts (7).
3. Install the four ventilation controls (12) on the inside ends of each grill body with screws/nuts (13).
4. Attach the leg mounts (3) to the outside ends of each grill with screws/nuts (5).

## Set-Up

1. Attach the legs (4) to the leg mounts (4) by sliding the leg tube onto the leg mount tube.
2. Insert the lower and upper grills (10, 11) as needed.
3. If using the grill cover (2) as a secondary grill:
  - a. Rotate the grill cover so it upside-down.
  - b. Attach the remaining legs to the grill cover leg mounts tubes to support it.
  - c. Insert the lower and upper grills (10, 11) as needed.

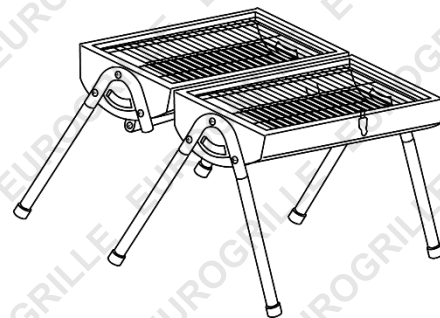

## Ignition Guide

1. Remove cooking grates and open grill vents
2. Pour enough charcoal on the base of the grill to form an even layer
3. Pile charcoal into a mound for greater coal-to-coal contact
4. Pour a generous amount of lighter fluid on the UNLIT coals
5. Light the coals carefully with a long match or long lighter
6. Once the coal is a white-grey colour with a glowing red centre, deconstruct the mound of charcoal and spread evenly.
7. Replace the cooking grates and begin cooking.



**Some experts believe that the incorrect or prolonged use of almost any product may cause serious injury or death. To help reduce your risk of serious injury or death, refer to the information below. For more information, see [www.datastreamserver.com/safety](http://www.datastreamserver.com/safety)**

- Consult all documentation, packaging and product labelling before use. Note that some products feature documentation available online. It is recommended to print and retain the documentation.
- Before each use, check the product for loose/broken/damaged/missing parts, wear or leaks (if applicable). Never use a product with loose/broken/damaged/missing parts, wear or leaks.
- Products must be inspected and serviced (if applicable) by a qualified technician every 6 months. This is based on average residential use by persons of average size and strength, and on a property of average metropolitan size. Use beyond these recommendations may require more frequent inspections/servicing.
- Ensure that all users of the product have completed a suitable industry recognised training course before being allowed access to the product.
- The product has been supplied by a general merchandise retailer that may not be familiar with your specific application or description of application. Be sure to attain third-party approval from a qualified specialist for your application before use, regardless of any assurances from the retailer or its representatives.
- This product is not intended for use where fail-safe operation is required. As with any product (for example, automobile, computer, toaster), there is the possibility of technical issues that may require the repair or replacement of parts, or the product itself. If the possibility of such failure and the associated time it may take to rectify could in any way inconvenience the user, business or employee, or financially affect the user, business or employee, then the product is not suitable for your requirements. This product is not intended for use where incorrect operation or a failure of any kind, including but not limited to, a condition requiring product return, replacement, parts replacement or service by a technician may cause financial loss, loss of employee time or an inconvenience requiring compensation.
- If this product has been purchased in error when considering the information presented here, contact the retailer directly for details of their returns policy, if required.

