



Instruction manual

Leaf Blower

SKU# BLWHND02CMTMADJE



[Revision 3.0 June 2019]



The information in this manual must be read and understood by the operator before use the unit.

SAFETY RULES FOR PETROL BLOWERS

TRAINING

- Read the instructions carefully. Get familiar with the controls and proper use of the equipment.
- Only use the blower for the purpose for which it was designed, i.e. blowing garden debris. Any other use can be hazardous, causing damage to the machine.
- Never allow children or people unfamiliar with these instructions to use the blower. Local regulations may restrict the age of the operator.
- Never use the blower:
 - When people, especially children, or pets are nearby.
 - If the operator has taken medicine or substances that can affect his ability to react and concentrate.
- Remember that the operator or user is responsible for accidents or hazards occurring to other people or their property.
- Do not use the unit around people with long hair.

PREPARATION

WARNING! Dress appropriately

- Do not operate with loose clothing or long hair. These can be sucked into the air intake of the blower.
- While blowing, always wear sturdy footwear and long trousers. Do not operate the equipment with bare feet or open sandals.

DANGER! Fuel for the engine is highly flammable.

- Store fuel in containers specifically designed for this purpose.
- Refuel using a funnel and outdoors only. Do not smoke while re-fuelling or whenever handling the fuel.
- Add fuel before starting the engine. Never remove the cap of the fuel tank or add fuel while the engine is running or when the engine is hot.
- If fuel is spilled, do not attempt to start the engine but move the machine away from the area of spillage and avoid creating any source of ignition until the fuel has evaporated and the vapour dispersed.
- Fit all tanks and containers fuel caps securely.
- Before use, always inspect the machine and check for screws that are not loose or worn.
- Wear suitable eye and ear protection when operating the blower.

MAINTENANCE AND STORAGE

WARNING! Do not use the equipment with worn or damaged parts.

- Parts are to be replaced and not repaired. Parts that are not of the same quality can damage the equipment and be dangerous for your safety.
- Keep all nuts, bolts and screws tight to be sure the equipment is in safe working condition. Regular maintenance is essential for safety and performance.
- Never store the equipment with fuel in the tank inside a building where vapour may reach a flame, a spark or a source of extreme heat.
- Allow the engine to cool before storing in an enclosed space.
- To reduce the fire hazard, keep the engine, muffler, and fuel storage area free of grass, leaves, or excessive grease.
- If the fuel tank has to be drained, this should be done outdoors and when the engine is cool.
- Fuel goes stale quickly. If you find your blower does not start, 1st change the fuel in the tank with newly purchased fuel.

SERVICE

- Have your power tool serviced by a qualified repair personnel using only identical replacement parts. This will ensure that the safety of the power tool is maintained.

OPERATION SAFETY INSTRUCTIONS WARNING!

Stop the engine and unplug the spark plug before any repairs or maintenance operations.

- Check that all nuts, bolts and screws are well tightened before every use.
- Do not run the engine in an enclosed and/or poorly ventilated area. The exhaust gas from the engine contains carbon monoxide, which is dangerous.
- Work only when there is sufficient light.
- Do not use the blower when it is raining or when the grass is wet.
- Caution must be taken while blowing on slopes.
- Turn off the engine if you must leave the blower unattended.
- Never change the rated speed of the engine in any way.
- Stop the engine and remove the spark plug cover in these cases:
 - Before any maintenance, repairing or checking operations.
 - If you leave the blower unattended.
 - if the blower vibrates in an abnormal way, take the blower to an authorised service centre.

WARNING! Fuel is highly flammable.

- Keep fuel in a suitable container specially made for this purpose.
- Fill the fuel tank with a funnel and outside. Do not smoke or use a mobile phone.
- Fill with fuel and oil before starting the engine.
- Never open the cap of the fuel tank to add fuel while the engine is running or still hot.
- Do not start the engine if there is spilt fuel on the blower or in the area surrounding. Take the blower away from the area where fuel has been split and avoid any contact from a heat source as long as the spilt fuel is completely evaporated.
- Tighten the fuel tank cap and fuel container cap tightly.

ADDITIONAL SAFETY RULES FOR PETROL BLOWERS

WARNING! Dress appropriately

- Do not operate with loose clothing or long hair. These can be sucked into the air intake of the blower.
- While blowing, always wear sturdy footwear and long trousers. Do not operate the equipment with bare feet or open sandals.
- Do not operate in a hazardous location. Such areas include where there is a risk of explosion of fumes, leaking gas or explosive dust.
- Do not operate in a confined area. Exhaust gases, smoke or fumes could reach dangerous concentrations.
- Protect your blower. This blower is NOT WEATHERPROOF and should not be exposed to direct sunlight, high ambient temperature and damp, wet or high humidity conditions.
- Do not smoke or use a mobile phone while refuelling. This is potentially dangerous as it may ignite the fuel and cause an explosion.
- Take care not to spill fuel. When refuelling the blower ensure that the motor has been switched off. Prevent the spilling of fuel as this may also ignite with the hot motor. Never refuel whilst the engine running.
- Be careful where you store the blower. Store the blower in a dry area away from flammable liquids.
- Keep your distance. The blower emits exhaust fumes. Ensure bystanders keep a safe distance.
- Ensure you use fuel oil mix. Ensure that you mix 30 parts unleaded fuel to 1 part two stroke oil. If not, the engine will overheat and cause damage to your blower.
- Never fill fuel tank indoors. Never fill fuel tank when engine is running or hot. Stop the engine before re-fuelling.
- Stop the engine and disconnect the spark plug wire If the blower starts to vibrate abnormally (find and remove the cause of the vibration immediately).
- Reduce the throttle before turning off the engine and turn the fuel off when you have finished blowing.
- The user is responsible for the safety of other people, animals and objects in the working area. Keep children and domestic animals at a safe distance while the blower is in use.

IMPORTANT NOTE !!!!!

This blower has 2 safety interlocks fitted.

If the Blower tubes or the side grill are not correctly fitted then the **BLOWER WILL NOT START**

PARTS IDENTIFICATION

1. Throttle trigger
2. Hand grip
3. Motor
4. Straight tube
5. Nozzle tube
6. Recoil starter
7. Petrol cap
8. Spark plug
9. Primer bulb
10. Air filter cover
11. Outlet exhaust
12. ignition SWITCH
13. Tube locking screw
14. Fuel tank
15. Choke

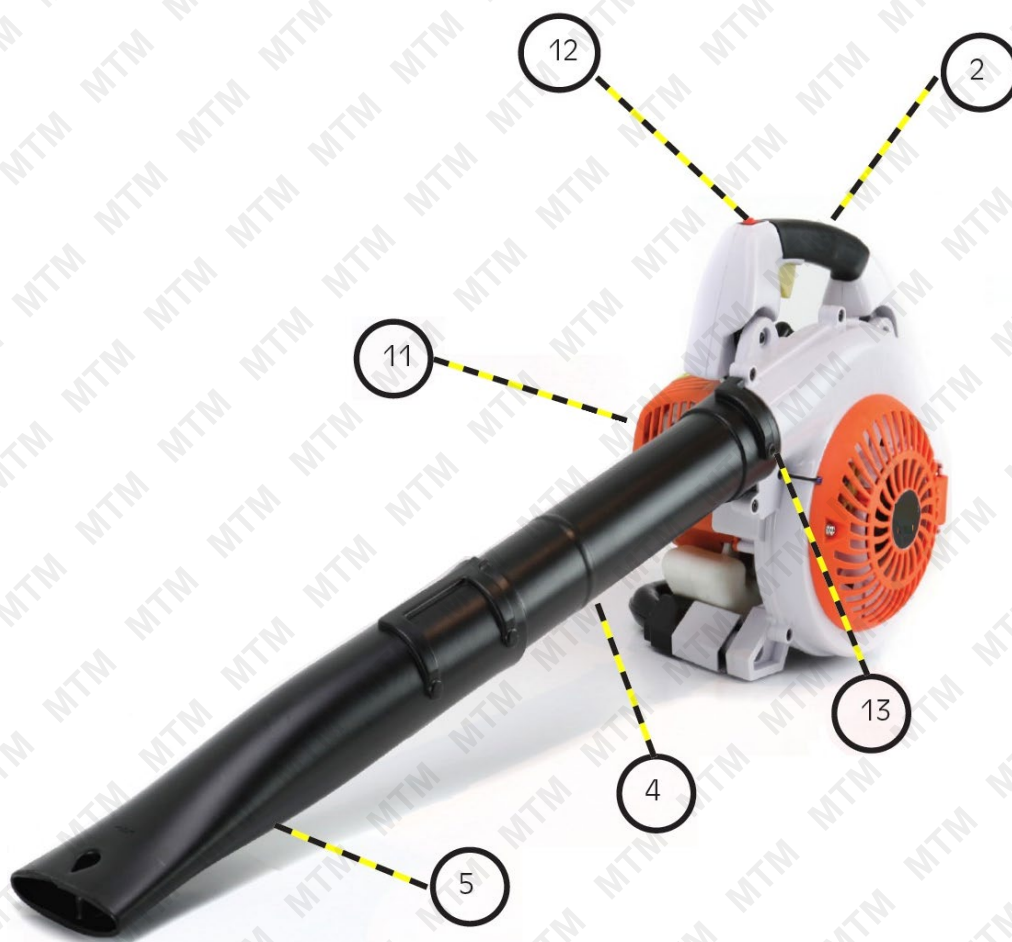
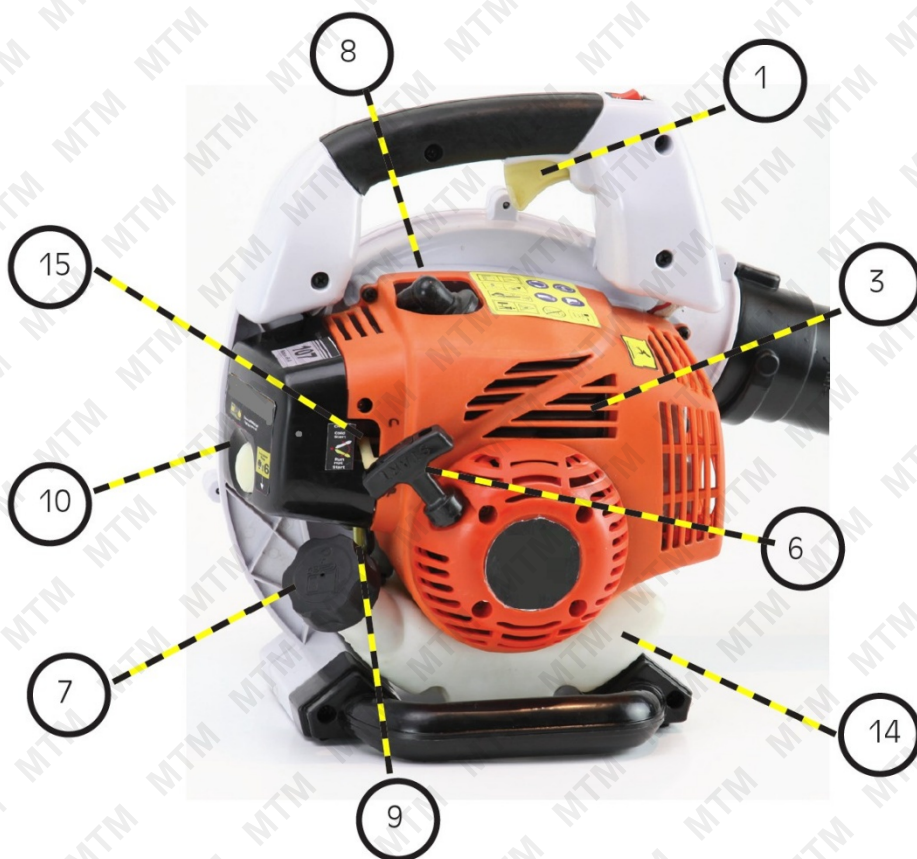

ASSEMBLY

WARNING! Danger from rotating impeller! Stop the engine before installing or removing the blower tubes. Never perform any maintenance or assembly procedures on this machine while the engine is running.

NOTE: This blower has 2 safety interlocks fitted. If the Blower tubes or the side grill are not correctly fitted then the **BLOWER WILL NOT START**

1. Place the blower upright on the ground or on a sturdy work surface.
2. Push the nozzle tube (5) over the straight tube (4) lining up the locking pins.
3. Rotate the nozzle tube clockwise locking it into place.
4. Lock the tubes together.
5. Push the assembled blower tube over the discharge port and rotate until locks in place and the screw hole can be seen.
6. Rotate the tube to the desired position.
7. Screw the tubes using the screw provided.



MIXING THE FUEL

ENGINE FUEL: FUEL TO OIL RATIO 30:1

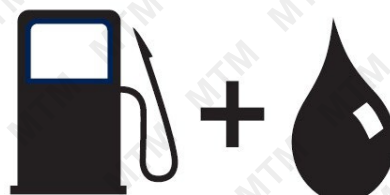

IMPORTANT! Use good quality air cooled 2-stroke engine oil.

This product is powered by a 2-stroke engine and requires pre-mixing fuel with 2-stroke oil.

1. Use fresh unleaded petrol. You must use 100% synthetic oil specifically made for heavily stressed two-stroke engines.

WARNING! do not use “E10” ethanol fuel blends.

2. Mix the unleaded petrol and oil in an approved container. Never mix fuel directly in the blower fuel tank.

WARNING! Never use any type of pre-mixed fuel/oil direct from fuel stations. This may include special blends intended for use in mopeds, motorcycles, etc.

3. Mix the fuel thoroughly and also each time before fuelling.

4. Always pre-mix in small quantities. Never mix quantities larger than what will be used in a 30 day period.

NOTE! Do not store petrol in plastic containers.

WARNING! Keep fuel out of the reach of children.

FILLING THE FUEL TANK

WARNING. Always shut off the engine before fuelling.

Never add fuel to a machine with a running or hot engine. Move at least 3 metres (10ft) away from the re-fuelling site before starting engine. Do not smoke or use a mobile phone when re-fuelling or operating the blower.

WARNING. Do not use fuel that is more than 2-3 months old. Empty the tank during longer breaks and fill it up again as soon you wish to use the blower again.

NOTE. It is normal for smoke to be emitted from a new engine during and after first use.

1. Place the blower upright on the ground or on a sturdy bench and wipe any debris from around the fuel cap.
2. Unscrew the fuel tank cap (7) and pour the mixture into the tank using a funnel (not supplied).
3. Be careful not to spill any mixture. If this happens, wipe the spill with a clean rag.
4. Start the engine at least three meters away from the area where the fuel tank has been filled up in order to avoid any risk of fire.

- Danger of fire and burn injuries.
- Always use extreme care when handling fuel! Fuel is highly flammable
- Never attempt to fuel the blower if the fuel system components are damaged or are leaking.
- Never attempt to refuel the engine while it is running or still warm, allow it to cool before fuelling.
- Never smoke or light any fires near the blower or fuels.
- Always transport and store fuels in an approved container.
- Never place flammable material close to the engine muffler.
- Do not use petrol which contains ethanol or methanol as it may damage the fuel lines and other engine parts.
- Mix only enough fuel for your immediate needs. If fuel must be stored longer than 30 days, it should first be treated with a stabilizer or similar product.



Fuel Cap

OPERATION

CHOKE CONTROL

If the engine is cold you will need to use the choke control.

Start position (choke ON).

Run position (choke OFF).



STARTING THE BLOWER

NOTE: This blower has 2 safety interlocks fitted. If the Blower tubes or the side grill are not correctly fitted then **the BLOWER WILL NOT START**

To start the engine, proceed as follows:

1. Set the ignition switch (12) to the ON position "I".
2. Press the primer (9) 6 times or until there are no air bubbles visible in the fuel discharge line.

NOTE. This is not necessary if the engine is warm.

3. If the engine is cold, move the choke (15) lever upwards to the ON position

NOTE. Again this is not necessary if the engine is warm.

4. Place the blower on the ground, and hold the blower handle firmly with your left hand.
5. Pull the starter cord slowly until you feel the starter engage, then....
6. Start the blower by pulling the starter cord upward rapidly. If necessary, repeat Step 5 two or three times until the engine starts.
7. Run the engine at idle speed until operating temperature is reached (2 ~ 3 minutes).
8. As the engine warms open the choke gradually by slowly pushing the choke control down to the OFF position.
9. The blower should now be ready for use.



PRIMER BULB

STOPPING THE BLOWER

Stop the engine by setting the ignition switch to the "STOP" position "O".

BLOWING

Start the blower engine. Hold the blower firmly about 10 - 20 cm from the ground and move it in a sweeping motion from left to right, directing the debris to the desired location.

- Use low throttle settings when clearing lightweight materials from around lawns or shrubbery.
- Use medium to higher throttle settings to move lightweight grass or leaves from driveways or paths.
- Use full throttle when moving heavy loads.

IMPORTANT. Blower noise increases at higher throttle settings. Always use the lowest throttle setting required to get the job done.

MAINTENANCE

BEFORE EACH USE:

- Remove dirt and debris from the blower exterior.
- Inspect the engine, tank and hoses for possible fuel leaks, and repair as necessary.
- Inspect the engine cooling fins for accumulations of dirt or debris, and clean as necessary.

EVERY 10~15 HOURS OF USE

- 1, Loosen the air cleaner cover retaining screw, and remove the cover and filter element.
- 2, Inspect the element. If the element is distorted or damaged, replace it with a new one.
- 3, Wash the element in clean fuel, and squeeze or blow dry. Wash the air cleaner cover in clean fuel, and wipe or blow dry.
- 4, Install the element and cover, and then tighten the cover retaining screw.
- 5, Use the spark plug wrench to remove the spark plug (turn counter-clockwise to remove)
- 6, Clean and adjust the spark plug gap to 0.6-0.7 mm. Replace any damaged or visibly worn plug with a L8RCT or equivalent
- 7, Install the spark plug finger-tight in the cylinder head, then tighten it firmly with the spark plug wrench.

EVERY 50 HOURS OF USE

- **INSPECTION** Inspect the entire blower and tubes for damage, including loose or missing component, and repair as necessary.
- **SPARK PLUG** Replace the spark plug with a L8RTC, gapped to (0.6-0.7) mm.
- **FUEL FILTER** Use a wire hook to extract the fuel filter from inside the fuel tank, and then remove and wash the filter element in clean fuel. Before reinstalling the filter, inspect the condition of the fuel line. If damage or deterioration is noted, the blower should be removed from service until it can be inspected by a trained service technician.

ADJUSTING ENGINE IDLE SPEED

From time to time it may be necessary to adjust the idle speed of the motor for smooth running.

1. Start the engine.
2. Run the engine at idle speed until operating temperature is reached usually (2-3 minutes)
3. Use a screwdriver to adjust the engine idle speed to (2800-3000) rpm.



NOTE

- Turn the idle screw clockwise to increase engine idle speed.
- Turn the idle screw counterclockwise to decrease engine idle speed.

IMPORTANT Blower tubes and intake cover must be installed while adjusting engine idle! Engine idle speed will also be affected if the intake cover or blower tubes are blocked, damaged or incorrectly fitted.

TROUBLE SHOOTING

Power loss or sudden stopping of the engine

- Check whether the fuel tank is empty.
- There is water in the mixture. Drain and rinse the fuel system with petrol.
- The air filter is dirty. Clean the air filter.

Starting a flooded engine

- Disconnect the spark plug lead, and use the plug wrench to remove the spark plug in a counter clockwise direction.
- If the spark plug is fouled or is soaked with fuel, clean or replace the plug as required.
- Clean excess fuel from the combustion chamber by cranking the engine several times while the spark plug is removed.
- Install the spark plug and firmly tighten it with the spark plug wrench.
- Repeat the starting procedure as if the blower was already warm.

STORAGE (30 DAYS OR LONGER)

- **CLEANING** - Thoroughly clean the blower exterior.
- **INSPECTION** - Inspect the entire blower and tubes for damage, including loose or missing components, and repair as necessary.
- **FUEL** - Drain the fuel tank, and then clear the carburettor and lines by running the blower until it stops from lack of fuel.
- **LUBRICATION** - Remove the spark plug, and then pour approximately Tea spoon of 2 stroke oil into the cylinder through the spark plug hole. Before reinstalling the spark plug, pull the recoil starter 2 or 3 times to distribute the oil over the cylinder walls.
- **AIR CLEANER** - Remove, clean, and reinstall the filter element as described under "BEFORE EACH USE"
- **STORAGE** - Store the blower in a clean, dry, dust-free environment.

SPECIFICATIONS

SKU#	BLWHND02CMTMADJE
Engine Type.....	2 cycle air cooled gas engine, vertical cylinder
Bore & Stroke.....	34 x 28 mm
Displacement/Power	26 cc/750W
Fuel.....	Unleaded fuel/oil mixture (30):1
Carburettor.....	Diaphragm-type with primer pump
Ignition	All transistor electronic ignition system
Spark plug.....	L8RTC or Equivalent
Fuel Tank Capacity.....	0.65L
Air Cleaner Type.....	Semi-wet
Weight (dry with blower tubes)	4.8kg



Some experts believe that the incorrect or prolonged use of almost any product may cause serious injury or death. To help reduce your risk of serious injury or death, refer to the information below. For more information, see www.datastreamserver.com/safety

- Consult all documentation, packaging and product labelling before use. Note that some products feature documentation available online. It is recommended to print and retain the documentation.
 - Before each use, check the product for loose/broken/damaged/missing parts, wear or leaks (if applicable). Never use a product with loose/broken/damaged/missing parts, wear or leaks.
 - Products must be inspected and serviced (if applicable) by a qualified technician every 6 months. This is based on average residential use by persons of average size and strength, and on a property of average metropolitan size. Use beyond these recommendations may require more frequent inspections/servicing.
 - Ensure that all users of the product have completed a suitable industry recognised training course before being allowed access to the product.
 - If this product has been purchased in error when considering the information presented here, contact the retailer directly for details of their returns policy, if required.
- The product has been supplied by a general merchandise retailer that may not be familiar with your specific application or description of application. Be sure to attain third-party approval from a qualified specialist for your application before use, regardless of any assurances from the retailer or its representatives.
 - This product is not intended for use where fail-safe operation is required. As with any product (for example, automobile, computer, toaster), there is the possibility of technical issues that may require the repair or replacement of parts, or the product itself. If the possibility of such failure and the associated time it may take to rectify could in any way inconvenience the user, business or employee, or financially affect the user, business or employee, then the product is not suitable for your requirements. This product is not intended for use where incorrect operation or a failure of any kind, including but not limited to, a condition requiring product return, replacement, parts replacement or service by a technician may cause financial loss, loss of employee time or an inconvenience requiring compensation.



©2019 MTM. All rights reserved. No part of this document, including descriptive content, concepts, ideas, diagrams or images may be reproduced or transmitted in any form or by any means, electronic or mechanical, including photocopying, scanning or recording, or any information storage and retrieval system, without express permission or consent from the publisher.