

Cordless Multi-Purpose Air Compressor OTB300

User Guide

[Revision 4.0 May 2020]

Safety

Read and understand this user guide before using the equipment. Retain the user guide for future reference.

Any damage or equipment failure due to incorrect usage is not covered by warranty.

- Always wear ANSI approved safety goggles when working with tools and equipment.
- When inflating tyres etc, do not exceed the pressures recommended by the manufacturer.
- Do not submerge the device as damage to the unit may occur.
- Always monitor inflation to avoid over-inflation or bursting of the inflated item.
- If inflation time exceeds 3 minutes be aware that some parts of the device may become hot.

Overview and Controls

The OTB300 is designed for general domestic inflation tasks, and includes additional functions:

- Standard vehicle 12VDC charging (charging cable / adaptor included).
- Programmable inflation pressure - automatically stops when required pressure is reached (Schrader type plus 3 additional valve adaptors included).
- Charging/powering USB devices.
- Battery charge indicator.
- Torch function.

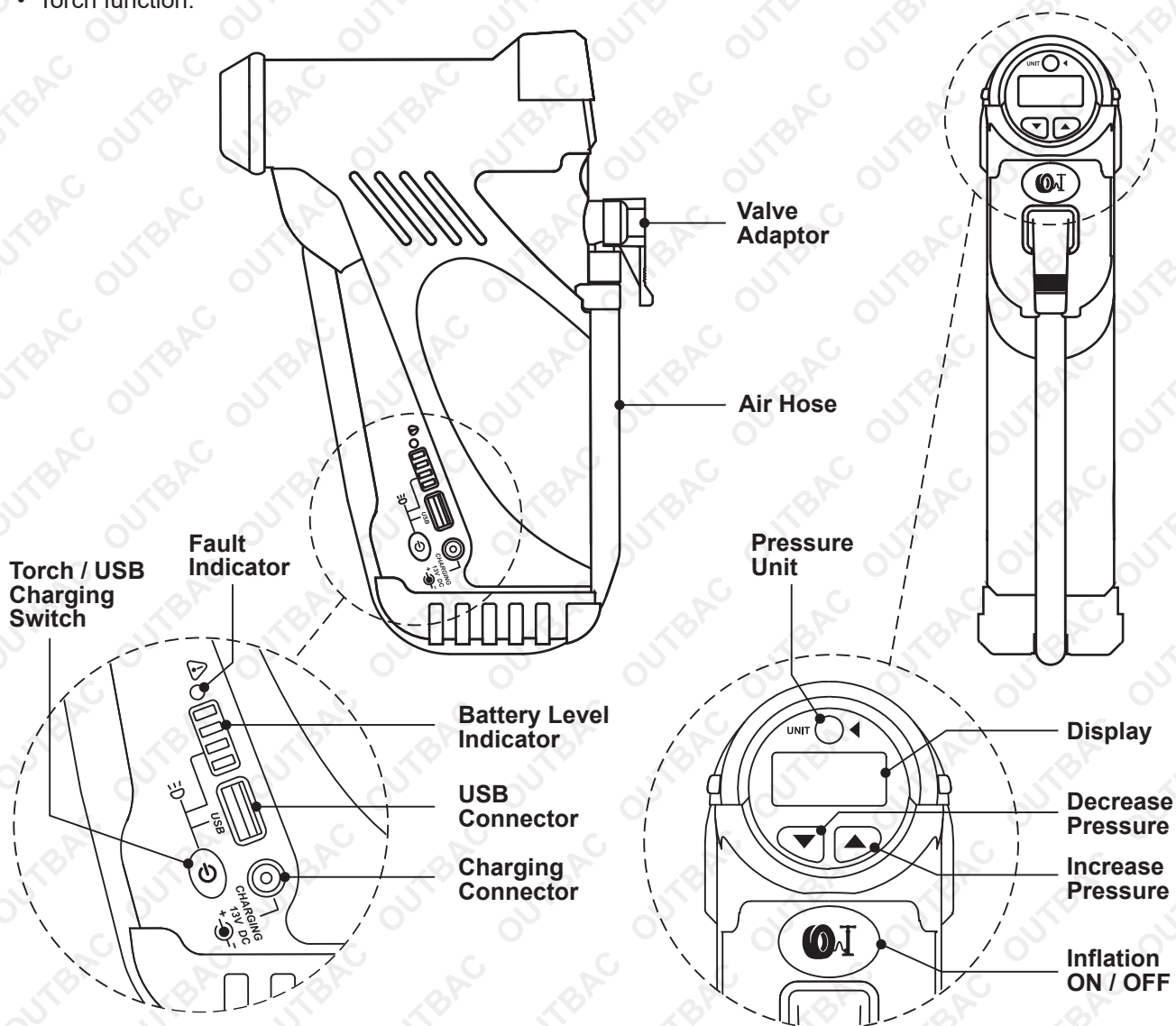

Operation

Note: Before use, ensure that all parts have been supplied and the battery is fully charged. Initial charge may take up to 48 hours.

Charging the Battery

1. Connect the supplied charging cable to a standard 12VDC vehicle socket.
NOTE: Please charge battery under ignition state, and voltage of car battery should be more than 13V.
2. Connect the other end of the cable to the compressor **Charging Connector**.
3. When charging, the **Battery Level Indicator** flashes.
4. When fully charged, all 4 indicator lights will illuminate and remain on.

Note: For the compressor to reach full charge (4 Bars) the car engine needs to be running. With the car engine turned off there will only be 12.8v running through the unit's charger, once the car engine is started the charge rate will increase to around 14v and the battery will charge up to 4 bars.

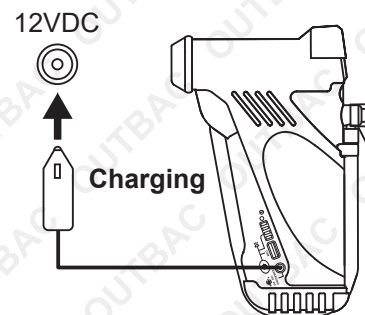

Using the Compressor for Inflation

1. Unclip the **Air Hose** from the unit. Unlock and securely connect the **Valve Adaptor** to the valve of the item to be inflated (X), then lock the adaptor. If required, attach the necessary adaptor into the **Valve Adaptor**.
2. Press the **Inflation ON / OFF** button to turn the unit on - the compressor may activate for a short period. If no other buttons are pressed, the unit will switch off after several seconds.
3. Press the **Increase Pressure / Decrease Pressure** buttons as required until the desired pressure is shown in the **Display**. If required, press the **Pressure Unit** button to change the unit of measurement between PSI, Bar, KPa and kgf.
4. Press the **Increase Pressure / Decrease Pressure** buttons simultaneously to save the pressure setting. If no pressure setting is saved, the previously saved setting is applied.
5. Press the **Inflation ON / OFF** button to turn the compressor on. When the pressure is reached, the compressor automatically stops. Disconnect the **Valve Adaptor** quickly from the inflated item to avoid pressure loss. The unit will switch off automatically after several seconds.

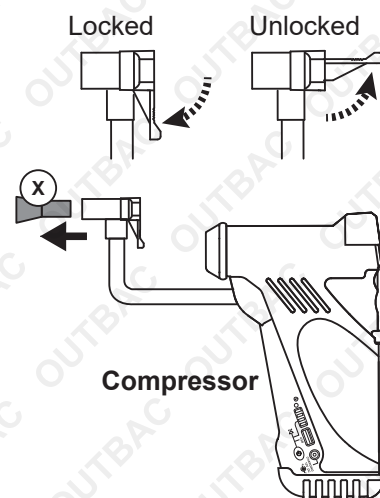

Using the Torch / Flashlight

1. Press and hold the **Torch / USB Charging** button for 3 seconds to activate the torch.
2. When finished, press the **Torch / USB Charging** button once to deactivate the torch.

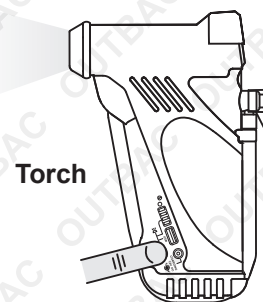

Using the USB Charger

1. Connect the USB device to the **USB Connector** using a standard USB cable (not supplied). The battery must be charged to use this function.
2. Press the **Torch / USB Charging** button once to switch the USB charging function on. If the unit has been used within the last 48 hours, USB charging is automatic on connection of the cable - no need to press the **Torch / USB Charging** button.
3. When finished, disconnect the USB cable from the **USB Connector**.

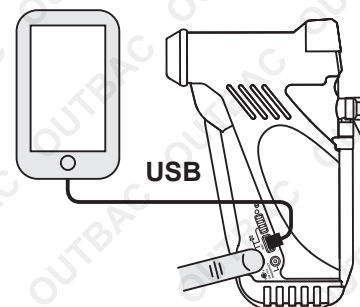

Fault Indicator

The **Fault Indicator** may illuminate if the unit reaches an over-temperature or over-current state. When in a fault state all functions are not available. When the indicator is off, the unit can be used again.

Specifications

Charging Voltage	13 to 30VDC
USB Output	5VDC 2A
Maximum Inflation Pressure	150PSI
Battery Capacity	11.1V 2000mAh
Maximum Discharge Capacity	<10A
Certification	FCC, CE (EMC and LVD), IC, RoHS



Some experts believe that the incorrect or prolonged use of almost any product may cause serious injury or death. To help reduce your risk of serious injury or death, refer to the information below. For more information, see www.datastreamserver.com/safety

- Consult all documentation, packaging and product labelling before use. Note that some products feature documentation available online. It is recommended to print and retain the documentation.
 - Before each use, check the product for loose/broken/damaged/missing parts, wear or leaks (if applicable). Never use a product with loose/broken/damaged/missing parts, wear or leaks.
 - Products must be inspected and serviced (if applicable) by a qualified technician every 6 months. This is based on average residential use by persons of average size and strength, and on a property of average metropolitan size. Use beyond these recommendations may require more frequent inspections/servicing.
 - Ensure that all users of the product have completed a suitable industry recognised training course before being allowed access to the product.
 - If this product has been purchased in error when considering the information presented here, contact the retailer directly for details of their returns policy, if required.
- The product has been supplied by a general merchandise retailer that may not be familiar with your specific application or description of application. Be sure to attain third-party approval from a qualified specialist for your application before use, regardless of any assurances from the retailer or its representatives.
 - This product is not intended for use where fail-safe operation is required. As with any product (for example, automobile, computer, toaster), there is the possibility of technical issues that may require the repair or replacement of parts, or the product itself. If the possibility of such failure and the associated time it may take to rectify could in any way inconvenience the user, business or employee, or financially affect the user, business or employee, then the product is not suitable for your requirements. This product is not intended for use where incorrect operation or a failure of any kind, including but not limited to, a condition requiring product return, replacement, parts replacement or service by a technician may cause financial loss, loss of employee time or an inconvenience requiring compensation.

