

BULLET

OFF ROAD



4WD Awning



User Manual

[Revision 2.0 October 2018]

READ THIS MANUAL CAREFULLY BEFORE USE – FAILURE TO DO SO MAY RESULT IN INJURY, PROPERTY DAMAGE AND MAY VOID WARRANTY. • Keep this manual for future reference. • Products covered by this manual may vary in appearance, assembly, inclusions, specifications, description and packaging.

Safety

Safety messages are designed to alert you to possible dangers or hazards that could cause death, injury or equipment or property damage if not understood or followed. Safety messages have the following symbols:

 <p>You WILL be KILLED or SERIOUSLY INJURED if you do not follow instructions.</p>	 <p>You CAN be KILLED or SERIOUSLY INJURED if you do not follow instructions.</p>	 <p>You CAN be INJURED if you do not follow instructions or equipment damage may occur.</p>
--	---	---

It is important that you read and understand the instruction manual before use and keep the manual in a safe place for future reference. Safety information presented here is generic in nature – some advice may not be applicable to every piece of equipment.

All safety precautions must be observed to reduce the risk of personal injury when operating the equipment.

The term “equipment” refers to your product, be it electrical mains, battery or petrol engine powered.

IMPORTANT – Handle the equipment safely and carefully.

BEFORE USE - If you are not familiar with the safe operation/handling of this equipment, or are in any way unsure of any aspect of suitability or correct use it for your application, you should complete training conducted by a person or organization qualified in safe use and operation of this equipment, including fuel/electrical handling and safety.

WARNINGS

- Read all safety warnings and all instructions. Failure to follow warnings and instructions may result in electric shock, fire and/or serious injury.
- Never run a petrol engine in confined areas.
- Do not operate the equipment in flammable or explosive environments, such as in the presence of flammable liquids, gases or dust. Engine and equipment may create sparks or heat that may ignite vapors, dust etc
- Keep clear of moving parts.
- This equipment may be a potential source of electric shock if misused.
- Do not operate the equipment if it is damaged, malfunctioning or is in an excessively worn state.
- Do not allow others to use the equipment unless they have read this manual and are adequately trained.
- When using the equipment, basic safety precautions detailed here must always be followed to reduce the risk of fire, electric shock, personal injury and material damage.
- When wiring electrically powered equipment, follow all electrical and safety codes.
- Ensure all power sources conform to equipment voltage requirements and are disconnected before connecting equipment.

General Work Area Safety

Work areas should be clean and well lit.

Do not operate the equipment if bystanders, animals etc are within operating range of the equipment or the general work area.

Personal Safety

Keep packaging away from children - risk of suffocation! Operators must use the equipment correctly. When using the equipment, consider conditions and pay due care to persons and property.

Prevent unintentional starting of the equipment - ensure equipment and power source switches are in the OFF position before connecting or moving the equipment. Do not carry equipment with hands/fingers touching any controls. Remove any tools or other items that are not a part of the equipment from it before starting or switching on.

Stay alert and use common sense when operating equipment. Do not overreach. Keep proper footing and balance at all times. Do not use equipment when tired or under the influence of drugs, alcohol or medication. This equipment is not intended for use by persons with reduced physical, sensory or mental capabilities.

You must wear appropriate protective equipment when operating, servicing, or when in the operating area of the equipment to help protect from serious injury, including eye injury, inhalation of toxic fumes, burns, and hearing loss. Always wear eye protection. Protective equipment such as respirators, non-skid safety shoes, hard hat, hearing protection etc should be used for appropriate conditions. Other people nearby should also wear appropriate personal protective equipment. Do not wear loose clothing or jewellery, which can be caught in moving parts. Keep hair and clothing away from the equipment.

If devices are provided for the connection of dust extraction and collection facilities, ensure these are connected and properly used. Use of dust collection can reduce dust-related hazards.

General Equipment Use and Care

Do not force the equipment. Use the correct equipment for your application. The correct equipment will perform better and be safer within its design parameters. Do not use the equipment if the ON/OFF switch malfunctions – any equipment that cannot be controlled with the ON/OFF switch is dangerous and must be repaired.

Use the equipment and accessories etc. in accordance with these instructions, taking into account working conditions and the work to be performed. Using the equipment for operations different from those intended could result in hazardous situations.

Before use, inspect the equipment for misalignment or binding of moving parts, loose components, damage or any other condition that may affect its operation. If damaged, have the equipment repaired by an authorized service center or technician before use.

Always keep the equipment and accessories (cutting tools, nozzles, bits etc) properly maintained. Keep the equipment, controls and handles dry and free from dirt, oil and grease.

Store the equipment out of reach of children or untrained persons. To avoid burns or fire hazards, let the equipment cool completely before transporting or storing. Never place the equipment in places where there are flammable materials, combustible gases or combustible liquids etc.

The equipment is not weatherproof, and should not be stored in direct sunlight, at high ambient temperatures or locations that are damp or very humid.

Product Use and Care

RECOMMENDATIONS

- After installation, drive the vehicle for a distance, then check that all brackets and fasteners and the roof racks are secure. It is advised to regularly check brackets and fasteners, especially when travelling over rough terrain.
- Use non-stretch fastening ropes or straps.
- Do not use automatic car washes with the awning installed on the vehicle.
- Loads - be aware of the load capacity of the vehicle roof racks/rails and that the weight of the awning (approximately 10kg) and its leverage effect is taken into consideration. Ensure that when fully loaded, the roof racks/rails are not operated over 70% of the maximum load rating, particularly in rough terrain. If in any doubt, contact a suitably qualified person for advice.

Table of Contents

Safety.....2

Parts Identification.....4

Installation5

Opening and Setting-Up the Awning6

 Setting-Up the Awning Extension.....7

Closing and Storing the Awning8

Parts Identification

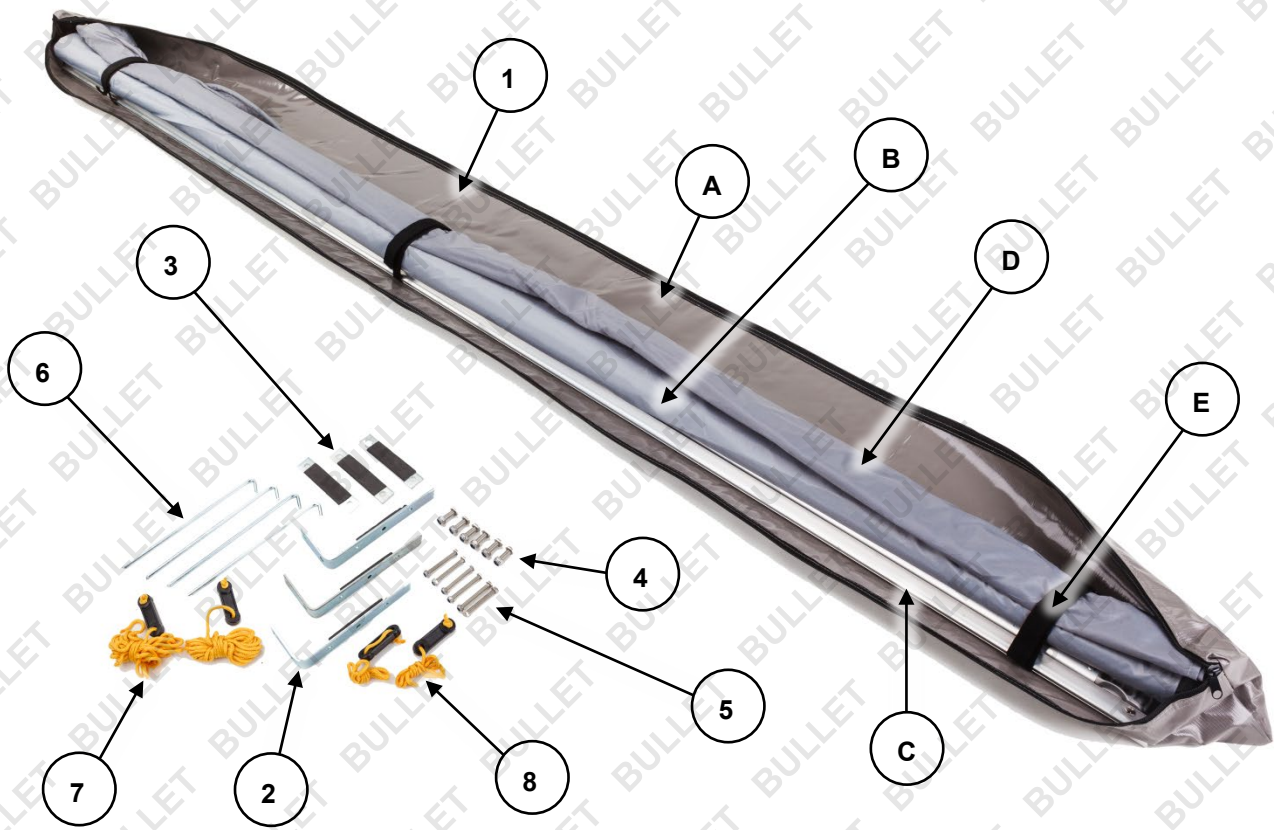

No.	Name	Qty.
1	4WD Awning (includes A, B, C, D and E)	1
2	Mounting Bracket	3
3	Mounting Bracket Clamp	3
4	M8 Bolt / Nut	6
5	M6 Bolt / Nut	6
6	Guy Rope Peg	2 / 4*
7	Guy Rope	2
8	Guy Rope - Short	2*
A	Awning Cover (with zip)	1
B	Awning Canvas and Outer Rail (not shown)	1
C	Awning Rail	1
D	Awning Extension	1*
E	Velcro Straps (not all shown)	-

* Included with the awning extension.

Installation



Installation requires 2 or more people []. • The roof rack / rails must be of a suitable type that runs along the length of the vehicle or provides suitable mounting points. The mountings must be capable of supporting the weight of the awning. If you have any doubt, consult a suitably qualified person for advice. • Before installation, check that awning and brackets can be mounted without any interference with the structure of the vehicle – that is, doors can open and awning parts are not touching the vehicle. • Use all 3 mounting brackets, if possible. • It is recommended to clean the vehicle roof rack rail prior to fitment. • Appropriate spanners are required for correct installation. Other tools may also be required. • The installation procedure below is based on mounting the awning to a rail that runs along the length of the vehicle.

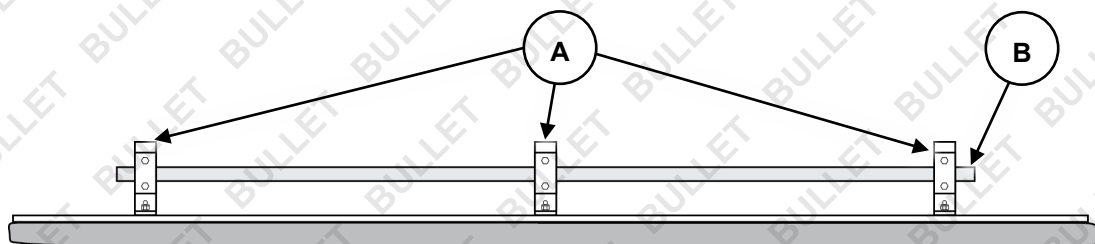

1. Using a pencil etc, mark the positions of the mounting brackets (A) on the roof rack rail (B). The middle bracket should be at the centre of the rail. The outer brackets, if possible, should be close to the ends of the roof rack rails and as near the roof rack rails mountings as possible.
2. Place a bracket in position, with the "L" shaped part under the rail and the vertical section facing up – the rubber sections should be against the roof rack rail. It is also possible to have the vertical section facing down, as long as no part of the awning interferes with the vehicle. Fix the brackets in position using the clamp (C) and M6 bolts and nuts (D), however, do not fully tighten the fasteners at this stage. If the bolts are long enough to touch the roof of the vehicle, reverse them so the nut is fitted from the top.
3. Slide 3 M8 bolts (E) into each slot in the awning rail (F) and roughly align them with the brackets.
4. With the awning cover zip facing downward, bring the awning rail up to the brackets and pass the bolts through the bracket holes and secure with the M8 nuts, however, do not fully tighten the fasteners at this stage.
5. Double-check that the positions of the brackets and the awning is correct in terms of the vehicle roof and doors etc, and adjust as required before firmly tightening all fasteners – it is recommended to have the position of the awning as close to the vehicle as possible. Check that the awning is secure and there is no movement in the awning brackets.

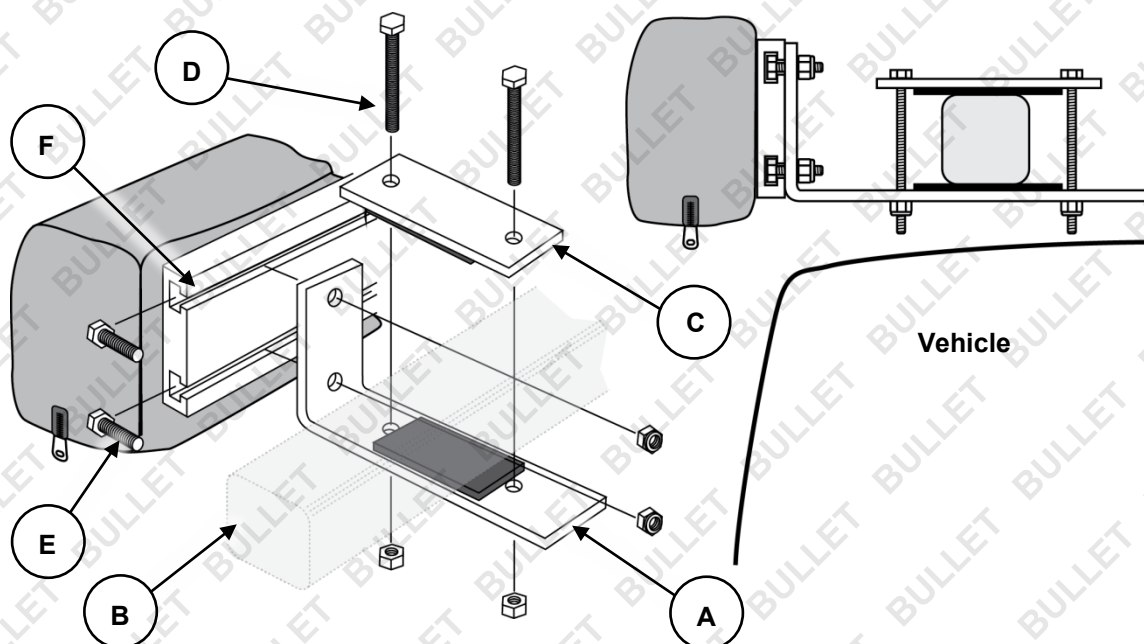

Opening and Setting-Up the Awning

1. Unzip the awning cover and fold it up and out of the way of the enclosed awning.
2. Undo the Velcro straps and gently roll out the awning (A). If the awning includes an extension canvas, remove the extension.
3. When the awning is fully rolled out, swing the leg (B) on either side down from inside the outer rail of the awning (C). To extend the leg, hold the upper tube then rotate the lower tube left (anti-clockwise) until it is loose, then slide the lower tube down to the desired position.

To lock the leg, hold the upper tube then rotate the lower tube right (clockwise) until it is locked.

Note: It is advisable to have the height of the awning at the outer edge a little lower than the height at the vehicle so that in the event of rain, water runs off the awning.

4. Swing the support arms (D) outward from the awning rail and extend them fully so the pin on the end enters the hole in the outer rail. Adjust the length of the support arms by rotating the smaller tube to the right to loosen it, then pull the tube out to extend it. When in position, lock the support arms by rotating the smaller tube. The awning should be fairly taught.
5. Secure the sides of the awning to the support arms using the Velcro straps.
6. Attach a guy rope (E) to each end of the outer rail by inserting the free end of the rope through the hole in the outer rail and tying a suitable knot. Place a guy rope peg (F) into the ground as shown, then place the looped end of the guy rope over the peg hook and slide the tensioner (G) up the guy rope until taught.

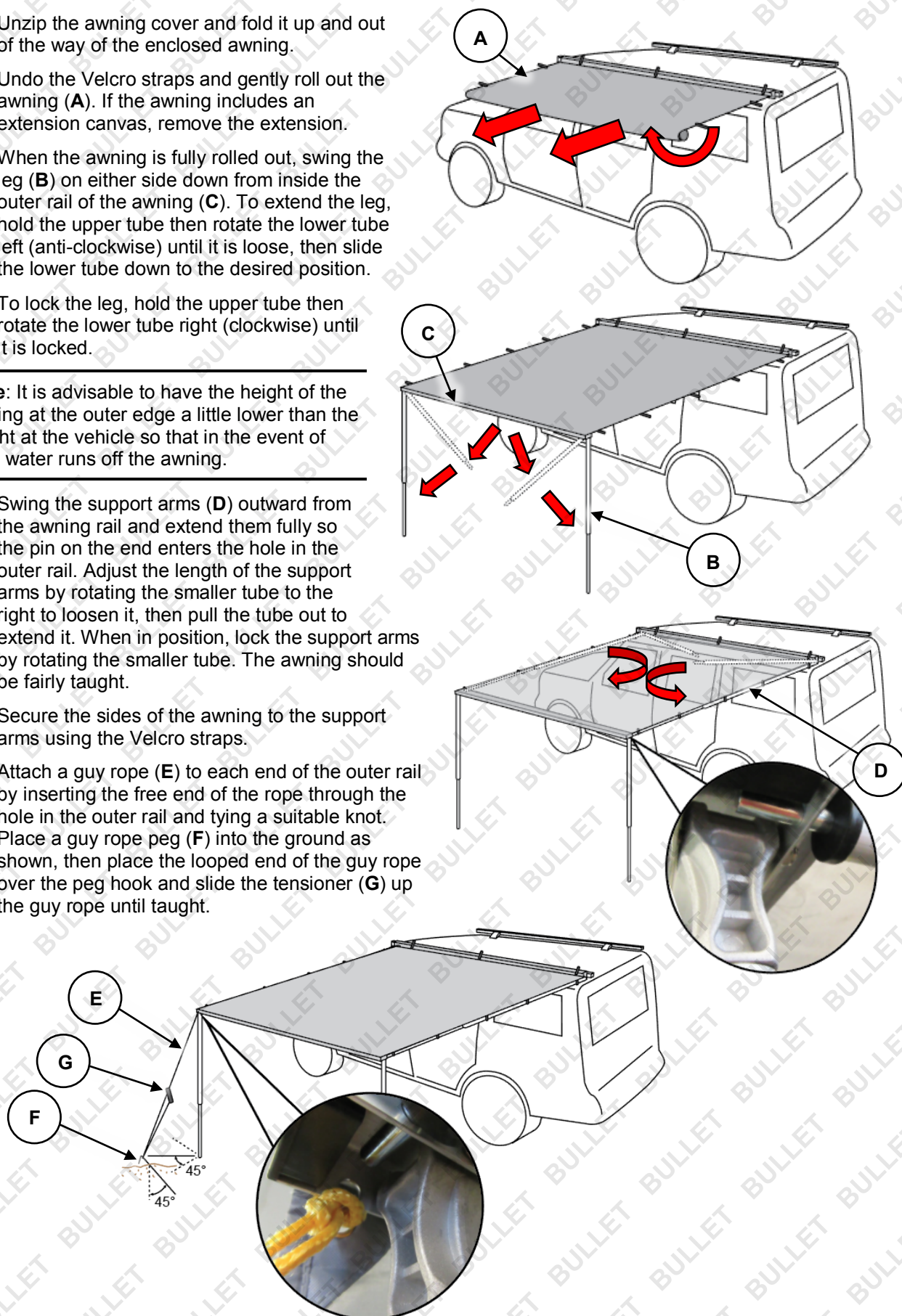

Setting-Up the Awning Extension

The awning extension can be attached to the long edge (A) of the awning to extend the awning width, or to the outer rail (B) to extend the awning length.

To attach it to the long edge – roll out the awning extension and attach the side with the Velcro straps to the support arm. To attach it to the outer rail, slip the end of the extension with the tube sewn into the edge (C) into and along the groove (D) in the outer rail (E). The free end of the extension can be attached to the ground or other object using the additional [short] guy ropes and pegs.

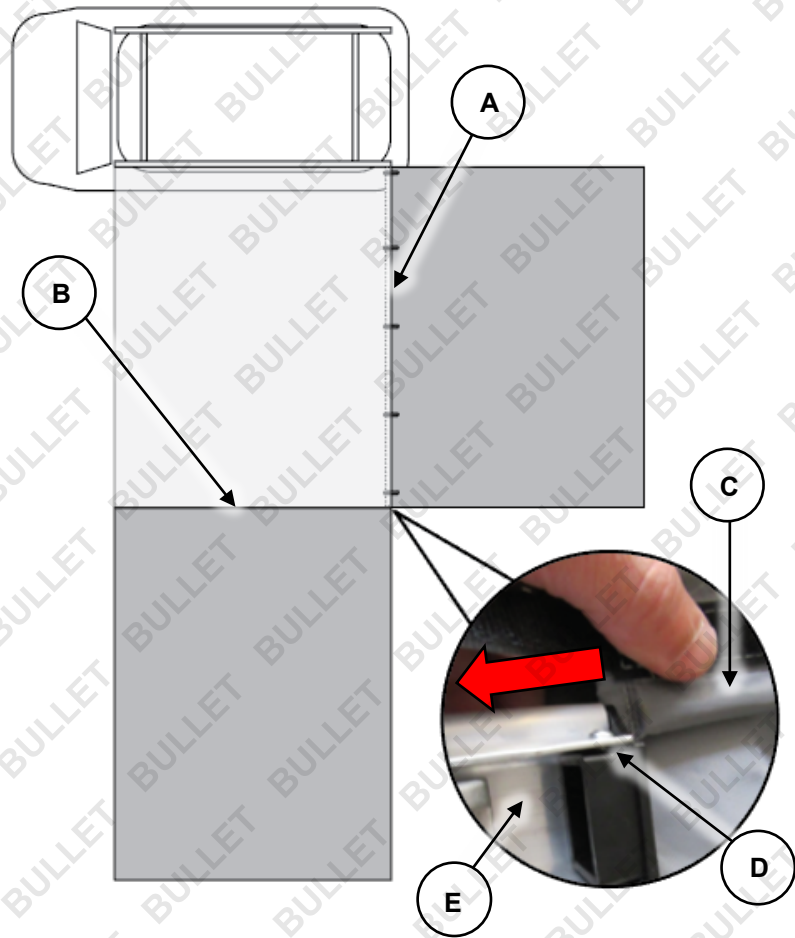

Closing and Storing the Awning

1. Remove the guy ropes and pegs from the awning and extension (if applicable) and store them in the supplied bag.

Note: If the extension is in use, remove it from the awning – it is either attached to a support arm using Velcro straps, or must be slid from the groove in the outer rail. Roll up the extension and use the Velcro straps to keep it from unrolling.

2. Undo the Velcro straps securing the awning to the support arms (A). Retract the support arms then swing them back into the awning rail.
3. Hold the end of the awning, then retract the leg (B) on either side and swing it up and into the outer rail (C).
4. Proceed to roll the awning (D) up as shown. When completely folded, use the Velcro straps to secure it (and the extension, if applicable) to the awning rail.
5. Place the awning cover in position, place the peg and rope bag inside and fully zip the cover closed.

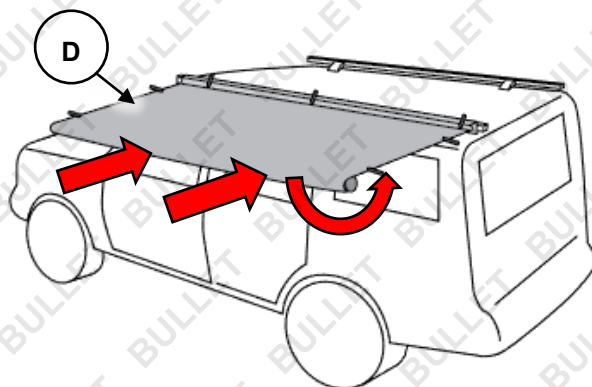
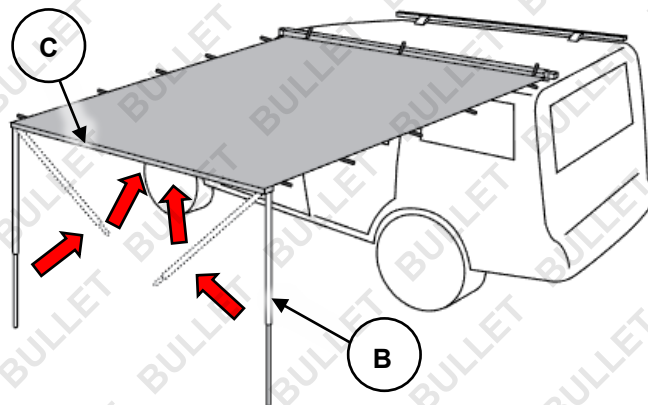
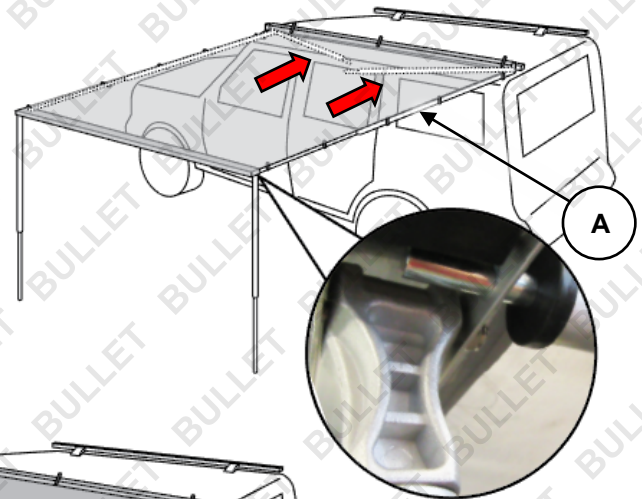



Some experts believe that the incorrect or prolonged use of almost any product may cause serious injury or death. To help reduce your risk of serious injury or death, refer to the information below. For more information, see www.datastreamserver.com/safety

- | | |
|---|---|
| <ul style="list-style-type: none"> ▪ Consult all documentation, packaging and product labelling before use. Note that some products feature documentation available online. It is recommended to print and retain the documentation. ▪ Before each use, check the product for loose/broken/damaged/missing parts, wear or leaks (if applicable). Never use a product with loose/broken/damaged/missing parts, wear or leaks. ▪ Products must be inspected and serviced (if applicable) by a qualified technician every 6 months. This is based on average residential use by persons of average size and strength, and on a property of average metropolitan size. Use beyond these recommendations may require more frequent inspections/servicing. ▪ Ensure that all users of the product have completed a suitable industry recognised training course before being allowed access to the product. | <ul style="list-style-type: none"> ▪ The product has been supplied by a general merchandise retailer that may not be familiar with your specific application or description of application. Be sure to attain third-party approval from a qualified specialist for your application before use, regardless of any assurances from the retailer or its representatives. ▪ This product is not intended for use where fail-safe operation is required. As with any product (for example, automobile, computer, toaster), there is the possibility of technical issues that may require the repair or replacement of parts, or the product itself. If the possibility of such failure and the associated time it may take to rectify could in any way inconvenience the user, business or employee, or financially affect the user, business or employee, then the product is not suitable for your requirements. This product is not intended for use where incorrect operation or a failure of any kind, including but not limited to, a condition requiring product return, replacement, parts replacement or service by a technician may cause financial loss, loss of employee time or an inconvenience requiring compensation. ▪ If this product has been purchased in error when considering the information presented here, contact the retailer directly for details of their returns policy, if required. |
|---|---|



©2018 Bullet. All rights reserved. No part of this document, including descriptive content, concepts, ideas, diagrams or images may be reproduced or transmitted in any form or by any means, electronic or mechanical, including photocopying, scanning or recording, or any information storage and retrieval system, without express permission or consent from the publisher.