

Adjustable Over-Bed Table

User Manual

[Revision 2.0 October 2018]

RETAIN THIS MANUAL FOR FUTURE REFERENCE

PLEASE READ THIS MANUAL CAREFULLY BEFORE USE

Table of Contents

Introduction 1

Safety 1

Included Items 2

Set-Up 3

Operation..... 5

Adjusting the Angle of the Main Table 5

Adjusting the Height of the Table 6

Maintenance..... 6

Specifications 6

Introduction

The Twin Top over-bed table can be used in conjunction with a bed or a chair, and is ideal of reading, writing, using a laptop computer, etc.

It has two height adjustable tabletops, the larger of which is angle-adjustable and has two lips to help prevent items slipping off of the table.

The table is also highly portable, with a lightweight yet sturdy steel frame and four braked castors. Some of the table features are shown on the photo below:

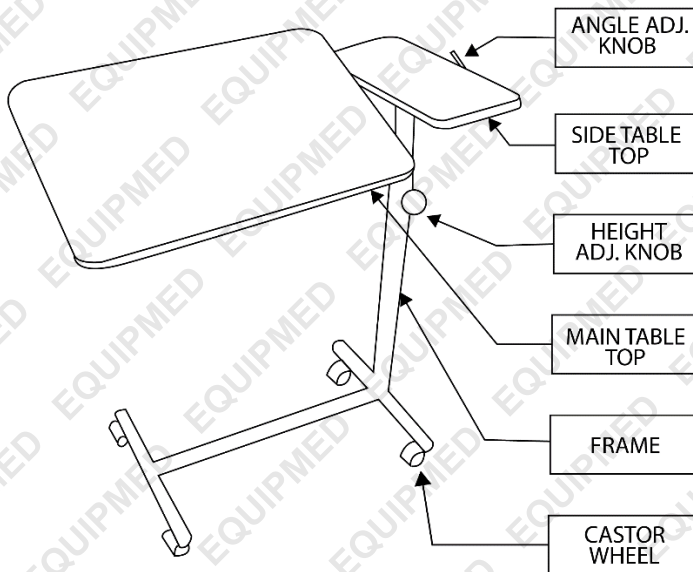

Safety

1. When assembling, the two halves of the table may be awkward to handle. Seek assistance if required.
2. The maximum advised height of the table is 90cm. Do not exceed this.
3. When adjusting the table height, the table will drop unless supported.
4. It is not advised to use the table for items over 15kg (33lb).
5. For maximum stability, always try to keep heavy items near the centre of the table tops.
6. The table is not suitable for leaning on, standing on, sitting on or any other similar load-bearing function.

Included Items

The over-bed table parts are shown below:

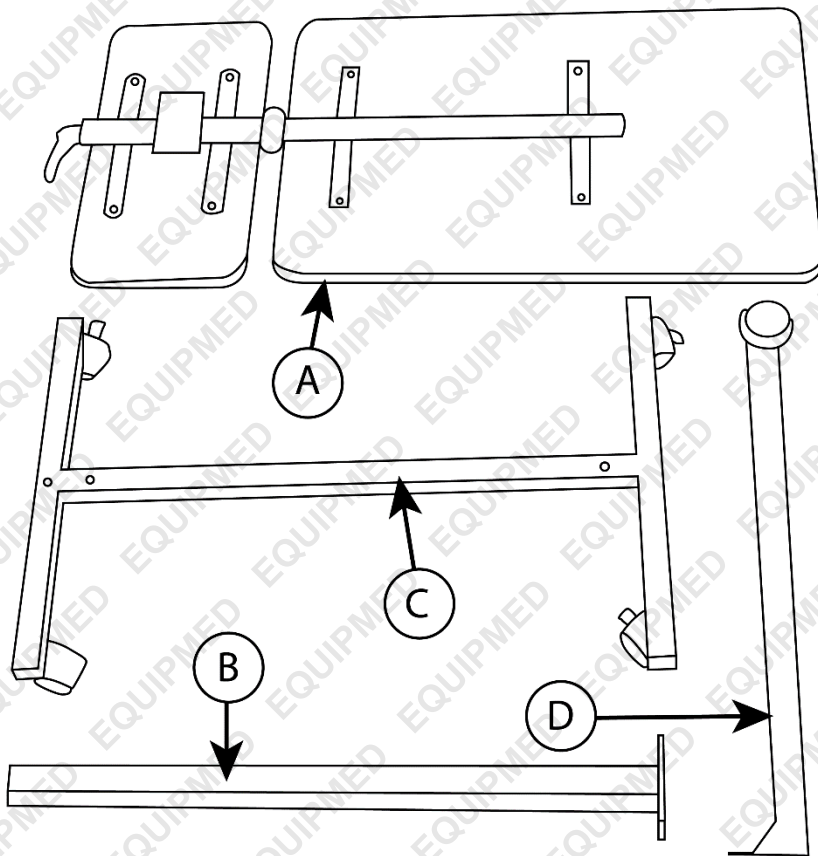

Part A: Table tops

Part B: Table leg (inner post)

Part C: Table 'H' frame

Part D: Table leg (outer post)

Note: The castor wheels are not supplied unattached to the frame. Please attach the wheels to the frame prior to assembly using the tools provided.

Set-Up

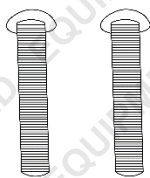

Screw Kit contains:

2x long screw

1x large washer

1x large nut

4x short screw

4x small nut

(Also contains large Allen key, small Allen key and spanner – not shown)

Step 1: Connect Part A and Part B together. Secure with the 4 short screws and 4 small nuts, using the allen key and spanner provided.

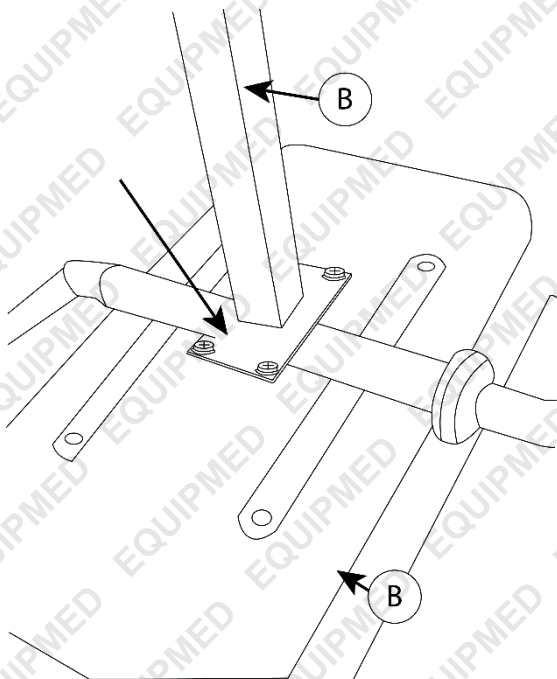

Step 2: Connect Parts C and D together. Use the large Allen key and screw to fasten into the threaded hole in Part D.

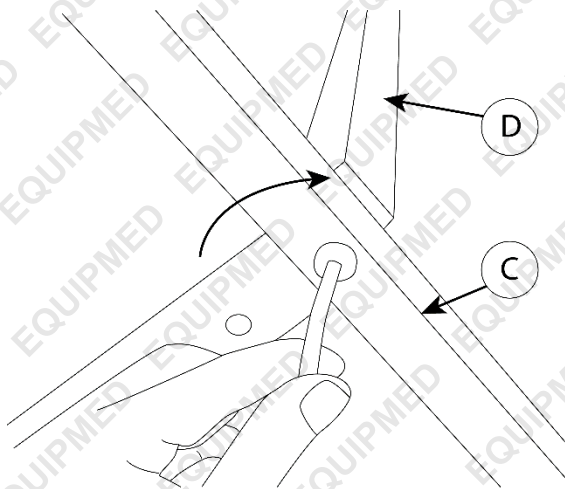

Step 3: Secure Parts C and D by attaching the large nut, bolt and washer through the second hole. Use the spanner and large Allen key provided.

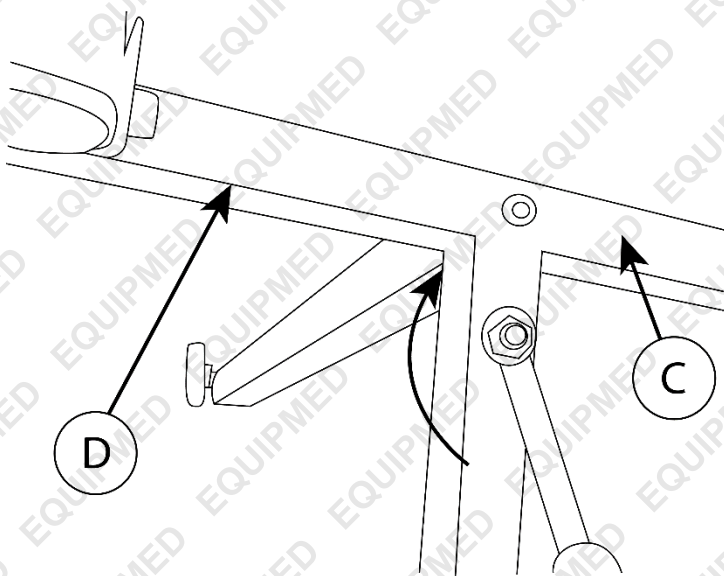

Step 4: Attach the two halves of the table together by sliding Part B into Part D. Set the table to the correct height and secure by turning the height adjustment knob clockwise.

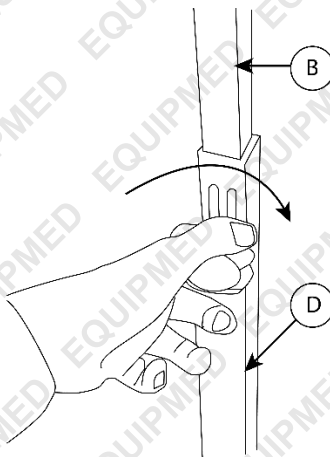

CAUTION!

The two halves of the table may be awkward to handle. Seek assistance if required

Operation

Adjusting the Angle of the Main Table

Turn the angle adjustment knob anticlockwise to release the table. Set the table to the required angle and then turn the knob clockwise to lock and secure the table.

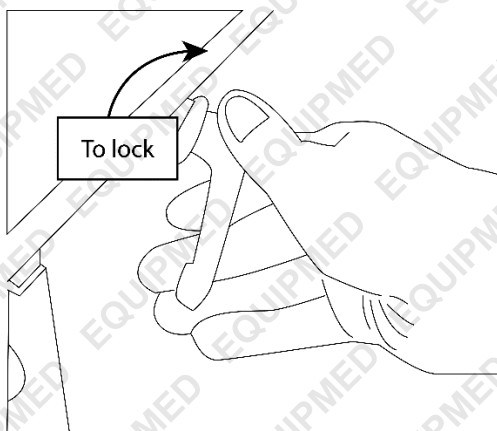

Adjusting the Height of the Table

Turn the height adjustment knob anticlockwise to release the table top. Adjust to the required height and secure by turning the knob clockwise.

CAUTION!

1. The maximum advised height of the table is 90cm (35½"). Do not exceed this height.
2. When releasing the table, the table will drop unless it is supported.

The castors also have brakes. To apply the brakes, push down on the plastic tabs on the castors. To release, lift the tabs up.

Maintenance

The table can be wiped down with a warm damp cloth of mild disinfectant. Do not use hot water or abrasive cleaners as these can damage the table.

Specifications

Dimensions (L x W x H)	40cm x 82cm x 74cm – 90cm
Height of Castors/Frame	7.5cm
Maximum Weight	15kg



Some experts believe that the incorrect or prolonged use of almost any product may cause serious injury or death. To help reduce your risk of serious injury or death, refer to the information below. For more information, see www.datastreamserver.com/safety

- Consult all documentation, packaging and product labelling before use. Note that some products feature documentation available online. It is recommended to print and retain the documentation.
- Before each use, check the product for loose/broken/damaged/missing parts, wear or leaks (if applicable). Never use a product with loose/broken/damaged/missing parts, wear or leaks.
- Products must be inspected and serviced (if applicable) by a qualified technician every 6 months. This is based on average residential use by persons of average size and strength, and on a property of average metropolitan size. Use beyond these recommendations may require more frequent inspections/servicing.
- Ensure that all users of the product have completed a suitable industry recognised training course before being allowed access to the product.
- If this product has been purchased in error when considering the information presented here, contact the retailer directly for details of their returns policy, if required.
- The product has been supplied by a general merchandise retailer that may not be familiar with your specific application or description of application. Be sure to attain third-party approval from a qualified specialist for your application before use, regardless of any assurances from the retailer or its representatives.
- This product is not intended for use where fail-safe operation is required. As with any product (for example, automobile, computer, toaster), there is the possibility of technical issues that may require the repair or replacement of parts, or the product itself. If the possibility of such failure and the associated time it may take to rectify could in any way inconvenience the user, business or employee, or financially affect the user, business or employee, then the product is not suitable for your requirements. This product is not intended for use where incorrect operation or a failure of any kind, including but not limited to, a condition requiring product return, replacement, parts replacement or service by a technician may cause financial loss, loss of employee time or an inconvenience requiring compensation.

